

# CLINTON SERVICE GUIDE

## MODEL 115VS-FOTA-KS

### FOR

## SINGER 261

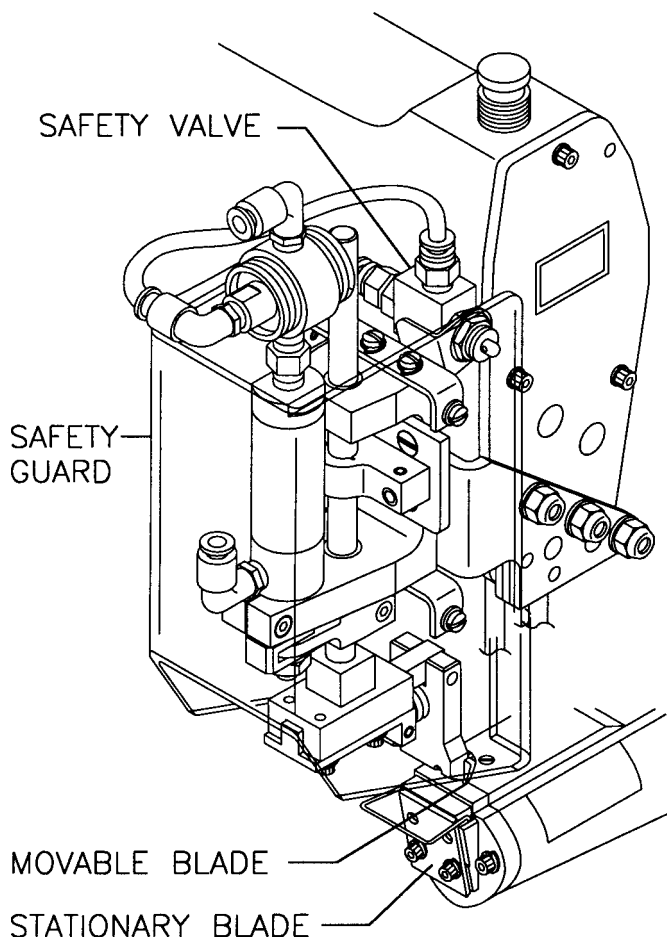

### CUTTER ASSEMBLY

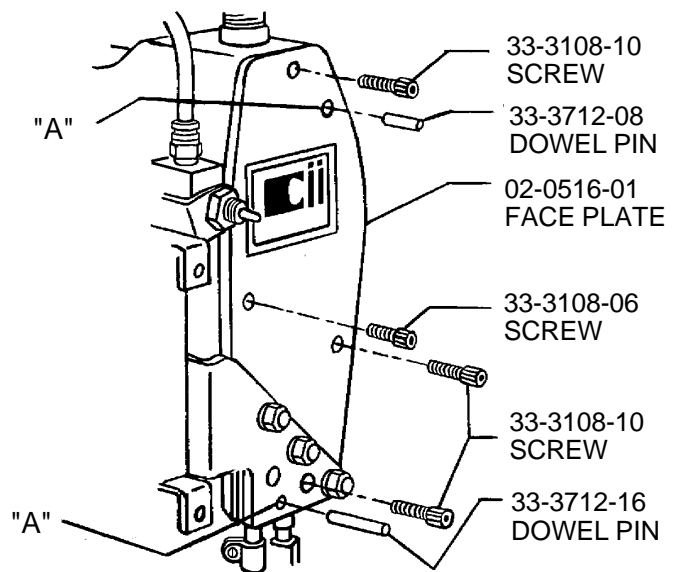

### NOTES:

1. REMOVE EXISTING FACE PLATE AND RETAP (4) HOLES WITH DRILL NO.29 (30-2130-29) AND TAP 8-32 (30-1266-01) SUPPLIED.
2. MOUNT VERTICAL SHEAR CUTTER WITH (3) SCREWS 33-3108-10 & (1) 33-3108-06.
3. USING HOLES MARKED "A" AS A GUIDE, DRILL (2) HOLES 3/16" DIAMETER BY 3/16" DEEP. 3/16" DRILL (30-2376-12) SUPPLIED.
4. INSERT DOWEL PINS (1) 33-3712-08 UPPER SIDE, AND (1) 33-3712-16 LOWER SIDE.



Clinton Industries, Inc.  
700 Washington Ave.  
Carlstadt, N.J. 07072  
Phone: 201-935-4242  
Fax: 201-935-3615  
www.clintonind.com  
E-mail: general@clintonind.com

## INSTALLATION & ADJUSTMENTS INSTRUCTIONS

### MOVABLE BLADE

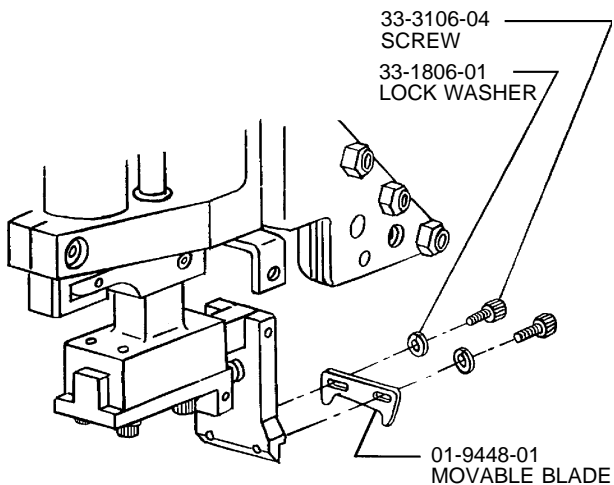

### STATIONARY BLADE

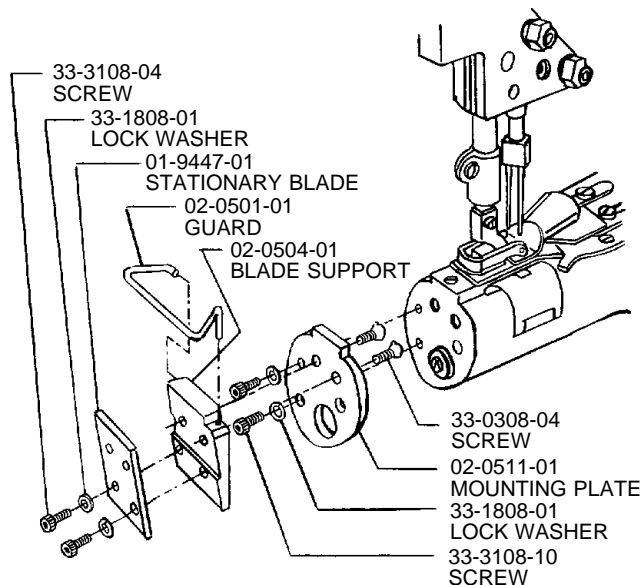

**NOTES:**

1. ASSEMBLE MOVABLE BLADE 01-9448-01 WITH SCREWS (2) 33-3106-04 AND LOCK WASHERS (2) 33-1806-01.
2. DO NOT TIGHTEN MOVABLE BLADE SCREWS AT THIS TIME. REFER TO ALIGNMENT ADJUSTMENT.

**NOTE:**

ASSEMBLE STATIONARY BLADE AS SHOWN.

### RADIAL

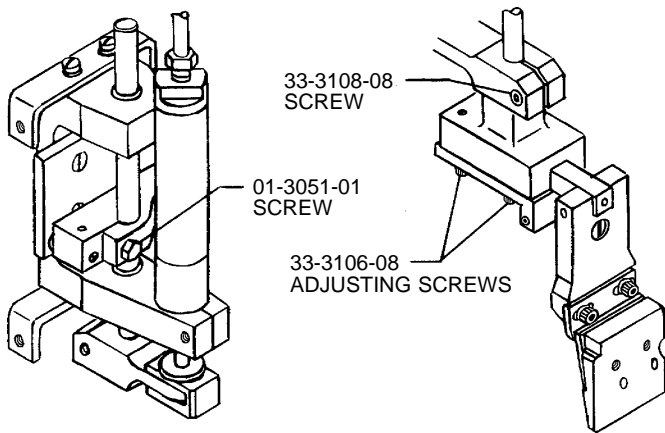

### ALIGNMENT

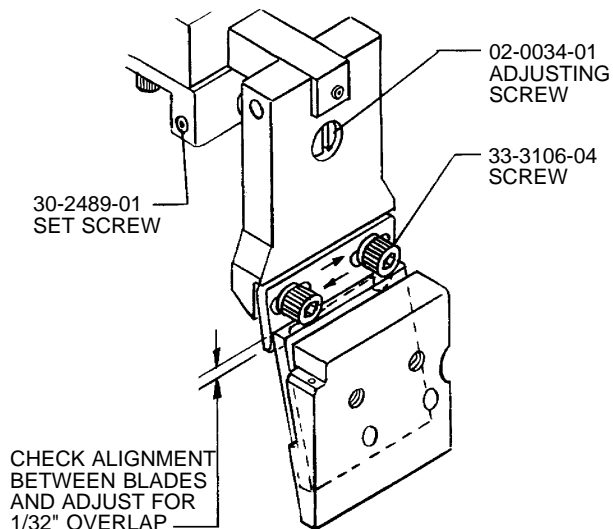

**NOTES:**

1. LOOSEN SCREW 01-3051-01 AND 33-3108-08 AND ROTATE ASSEMBLY FOR PROPER ENGAGEMENT.
2. LOOSEN SCREWS 33-3106-08 AND ADJUST MOVABLE BLADE AGAINST STATIONARY BLADE AND LOCK IN PLACE.

**NOTE:**

LOOSEN SET SCREW 30-2489-01 AND ADJUST SCREW 02-0034-01 COUNTER-CLOCKWISE FOR MORE CUTTING EDGE ENGAGEMENT.

**DRILLING & INSTALLATION INSTRUCTIONS**

**WARNING!! TO PREVENT SERIOUS INJURY, DISCONNECT AIR SUPPLY BEFORE MAKING ANY ADJUSTMENTS.**

**DRILL JIG**

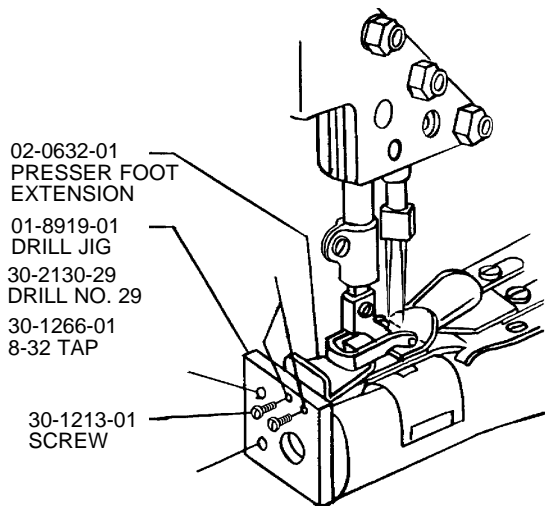

**NOTES:**

1. FASTEN DRILL JIG 01-8919-01 TO MACHINE USING SCREWS 30-1213-01 SUPPLIED AT POINTS MARKED "B".
2. USING DRILL NO. 29, DRILL THE CASTING AT POINTS MARKED "C" REMOVE THE DRILL JIG, AND TAP HOLES AT POINTS MARKED "C" USING THE 8-32 TAP SUPPLIED.

**FILTER, OILER, REGULATOR & GAUGE ASSEMBLY**

80-0181-01  
80-0181-10

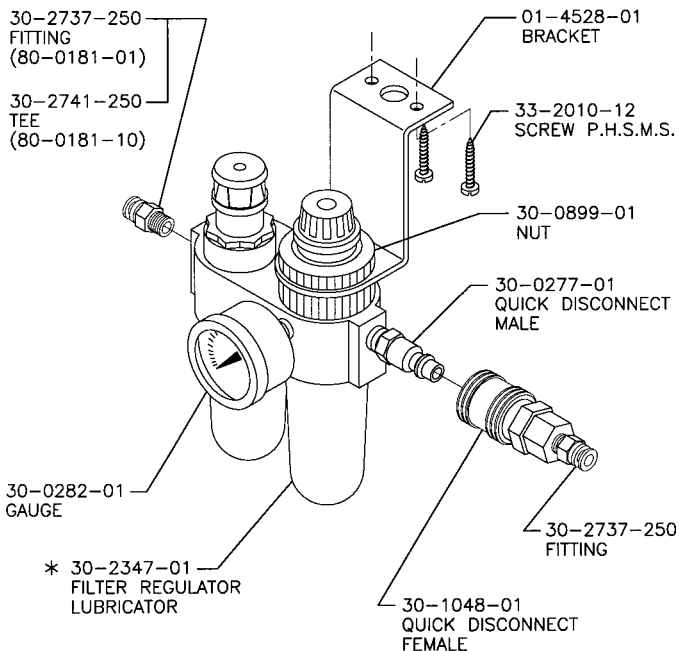

\* NOTE: SEE INS-DRAWINGS 2100-1 AND 2100-2 FOR SPARE PARTS

INS-570-3D

**AIR CIRCUIT DIAGRAM**

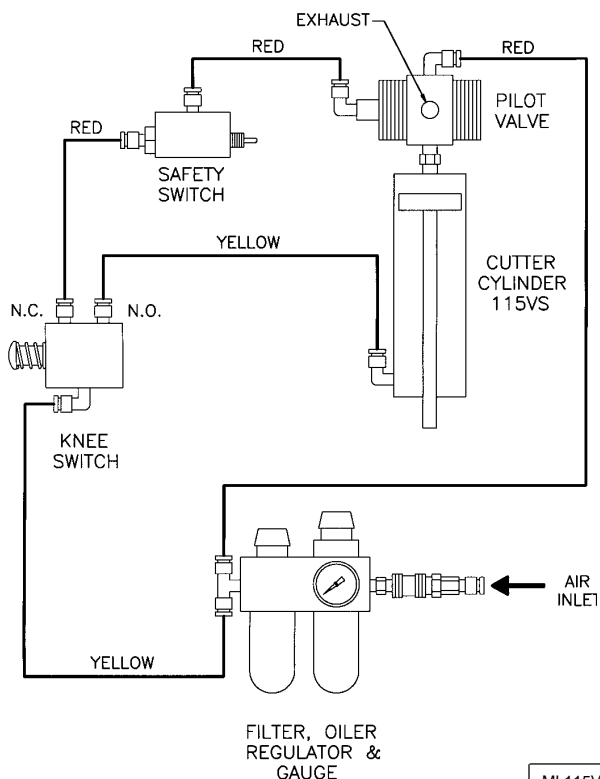

ML115VS-9E

**4 WAY AIR VALVE, KNEE OPERATED**  
80-0185-01

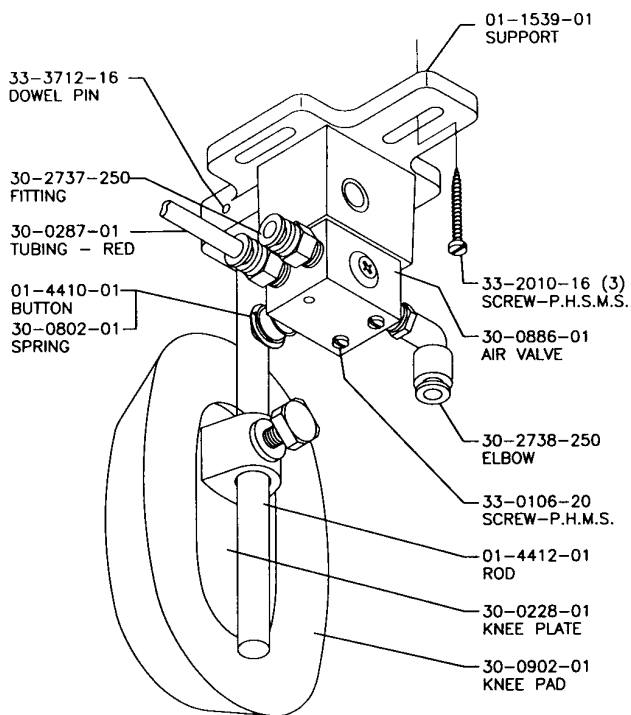

INS-619-1A

PARTS LIST  
 MODEL 115VS-FD0TA-KS  
 SINGER 261  
 80-0525-01

