

CONSEW MODEL 101

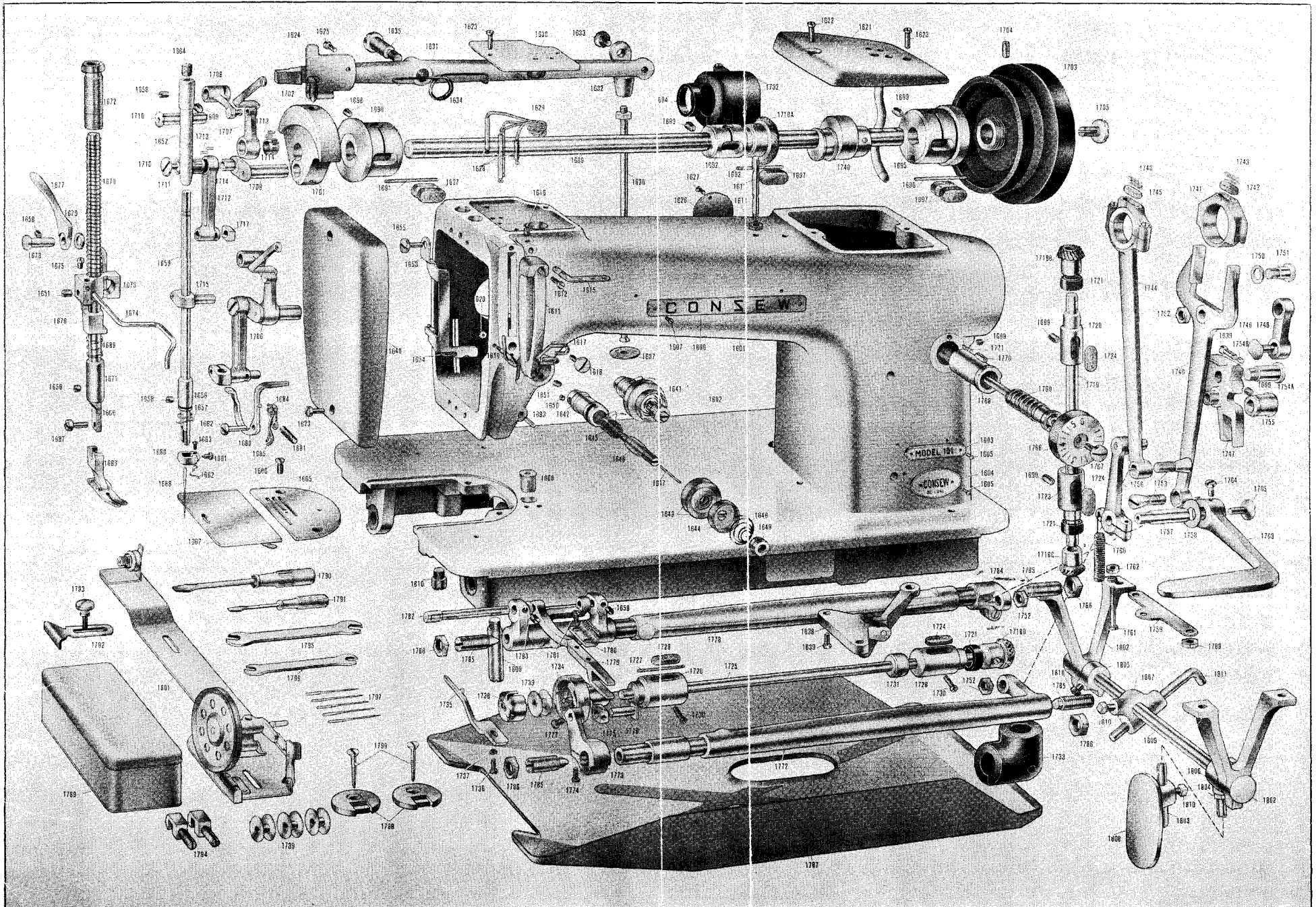

new 101 - To 105

CONSEW MODEL 101

PART NO.	PART NAME	PART NO.	PART NAME	PART NO.	PART NAME	PART NO.	PART NAME	PART NO.	PART NAME
1601	ARM ONLY	1646	TENSION SPRING	1690	MAIN SHAFT FRONT BUSHING	1729	OIL FELT FOR 1726	1770	STOP PIN FOR 1766
1602	BED ONLY	1647	TENSION RELEASE PIN	1691	OIL WICK FOR 1690	1730	SCREW FOR 1726, 1728	1771	FEED REGULATOR STOPPING SPRING
1603	MODEL NUMBER PLATE	1648	TENSION STUD	1692	MAIN SHAFT CENTER BUSHING	1731	COLLAR FOR 1725	1772	FEED LIFTING SHAFT
1604	MEDALLION	1649	TENSION ADJUSTING NUT	1693	OIL WICK FOR 1692	1732	UPPER GEAR CASE COMPLETE	1773	FEED LIFTING BELL CRANK
1605	RIVET FOR 1603, 1604	1650	SCREW FOR 1648	1694	GASKET FOR 1732	1733	LOWER GEAR CASE COMPLETE	1774	SCREW FOR 1773
1606	NAME PLATE	1651	SCREW FOR 1641	1695	MAIN SHAFT REAR BUSHING	1734	POTATING HOOK ASSEMBLY	1775	SLIDING BLOCK FOR 1773
1607	SCREW FOR 1606	1652	NEEDLE BAR UPPER BUSHING	1696	OIL WICK FOR 1695	1735	HOOK RETAINER	1776	STUD FOR 1775
1608	OIL CUP	1653	HOLDER FOR 1654	1697	OIL WICK FOR 1695	1736	SCREW FOR 1735	1777	SCREW FOR 1776
1609	BED LEG, FRONT	1654	OIL WICK FOR NEEDLE BAR	1698	SCREW FOR 1690	1737	WASHER FOR 1736	1778	FEED ROCK SHAFT
1610	BED LEG, REAR	1655	SCREW FOR 1653	1699	SCREW FOR 1692, 1695, 1720, 1723, 1768, 1755, 1716	1738	BOBBIN CASE ASSEMBLY	1779	FEED BAR
1611	GUARD FOR TAKE UP LEVER	1656	NEEDLE BAR LOWER BUSHING	1701	TAKE UP LEVER CRANK WITH SCREW	1739	BOBBIN	1780	FEED DOG
1612	SCREW FOR 1611	1657	THREAD GUIDE FOR 1656	1702	POSITION SCREW FOR 1701	1740	FEED AND FEED LIFTING ECCENTRIC WITH SCREW	1781	SCREW FOR 1780
1613	SPOOL PIN	1658	SCREW FOR 1652, 1656	1703	HAND WHEEL	1741	SLEEVE FOR 1740	1782	FEED BAR SHAFT
1614	NUT FOR 1613	1659	NEEDLE BAR ONLY	1704	SCREW FOR 1703	1742	OIL FELT FOR 1741	1783	WASHER FOR 1782
1615	THREAD GUIDE WITH THREE HOLES	1660	NEEDLE CLAMP BODY	1705	CAP SCREW FOR 1703	1743	SPRING FOR 1742, 1745	1784	FEED ROCK ARM WITH SCREW
1616	SCREW FOR 1615	1661	SCREW FOR 1660	1706	TAKE UP LEVER COMPLETE	1744	FEED LIFTING CRANK ROD COMPLETE	1785	SCREW CENTER FOR 1772, 1778
1617	THREAD GUIDE (RIGHT)	1662	THREAD GUIDE FOR 1660	1707	TAKE UP LEVER BODY	1745	OIL FELT FOR 1744	1786	NUT FOR 1785
1618	SCREW FOR 1617	1663	SCREW FOR 1662	1708	TAKE UP LEVER LINK	1746	FEED FORK	1787	DRIP PAN
1619	THREAD GUIDE (LEFT)	1664	OIL FELT FOR 1652	1709	NEEDLE BAR CRANK	1747	FEED REGULATOR FORK	1788	NUT FOR 1759
1620	NUT FOR 1619	1665	NEEDLE PLATE	1710	CAP SCREW FOR 1709	1748	LINK FOR 1747	1789	ACCESSORY BOX
1621	ARM COVER PLATE (RIGHT)	1666	SCREW FOR 1665	1711	WASHER FOR 1710	1749	LINK SCREW FOR 1748	1790	SCREW DRIVER, LARGE
1622	SCREW FOR 1621 (LEFT)	1667	SLIDE PLATE COMPLETE	1712	NEEDLE BAR CRANK CONNECTION	1750	ADJUSTING WASHER FOR 1751	1791	SCREW DRIVER, SMALL
1623	SCREW FOR 1621 (RIGHT)	1668	NEEDLE	1713	BEARING ROLLERS	1751	HINGED SCREW FOR 1747	1792	CLOTH GUIDE
1624	BACK COVER PLATE (LEFT)	1669	PRESSER BAR ONLY	1714	RETAINER FOR 1713	1752	NUT FOR 1751	1793	CLOTH GUIDE THUMB SCREW
1625	SCREW FOR 1624	1670	PRESSER SPRING	1715	NEEDLE BAR BRACKET WITH SCREW	1753	HINGE CONNECTION SCREW FOR 1744, 1746	1794	BED HINGE STUD
1626	BACK COVER PLATE (RIGHT)	1671	BUSHING FOR 1669	1716	HINGED STUD FOR 1708	1754A	HINGE STUD FOR 1747	1795	WRENCH, LARGE
1627	SCREW FOR 1626	1672	PRESSURE REGULATOR	1717	SLIDING BLOCK FOR 1715	1754B	CUSHION FOR 1754A	1796	WRENCH, SMALL
1628	GUIDE TUBE FOR 1629	1673	PRESSER BAR GUIDE BRACKET	1718A	MAIN SHAFT GEAR	1755	BUSHING FOR 1754A	1797	NEEDLES
1629	OIL WICK	1674	THREAD REGULATOR	1718B	VERTICAL SHAFT UPPER GEAR	1756	REVERSING ARM FOR 1747	1798	HINGE PLATE
1630	COVER PLATE FOR OIL WELL	1675	SCREW FOR 1674	1718C	VERTICAL SHAFT LOWER GEAR	1757	SHAFT FOR 1756	1799	SCREW FOR 1798
1631	KNEE LIFTER LEVER	1676	PRESSER BAR LIFTER	1718D	HOOK SHAFT GEAR	1758	WASHER FOR 1763	1801	BOBBIN WINDER
1632	KNEE LIFTER LINK	1677	PRESSER BAR LIFTER LEVER	1719	VERTICAL SHAFT ONLY	1759	RETAINER FOR 1760	1802	KNEE LIFTER BRACKET
1633	LINK SCREW FOR 1632	1678	HINGED STUD FOR 1677	1720	VERTICAL SHAFT UPPER BUSHING	1760	SPRING FOR 1756	1803	KNEE LIFTER ARM
1634	RETURN SPRING FOR 1631	1679	ADJUSTING WASHER FOR 1677	1721	GASKET FOR 1733	1761	ADJUSTING SCREW FOR 1760	1804	NUT FOR 1803
1635	HINGE SCREW FOR 1631	1680	THREAD TENSION RELEASE	1722	VERTICAL SHAFT LOWER BUSHING	1762	NUT FOR 1761	1805	COLLAR FOR 1809
1636	KNEE LIFTER PULL ROD	1681	SPRING FOR 1680	1723	OIL FELT FOR 1720, 1723	1763	FEED REVERSING LEVER	1806	KNEE LIFTER KNEE ARM JOINT
1637	FELT WASHER FOR 1636	1682	FULCRUM PIN FOR 1680	1724	HOOK SHAFT ONLY	1764	SCREW FOR 1763	1807	KNEE LIFTER LEVER
1638	KNEE LIFTER BELL CRANK LEVER & BRACKET	1683	SCREW FOR 1682	1725	HOOK SHAFT FRONT BUSHING	1765	CAP SCREW FOR 1763	1808	KNEE LIFTER PAD
1639	SCREW FOR 1638, 1754	1684	HOLDER FOR 1685	1726	HOOK SHAFT REAR BUSHING	1766	FEED REGULATING KNOB	1809	KNEE LIFTER SHAFT
1640	FACE PLATE	1685	OIL WICK FOR 1715	1727	OIL WICK FOR 1726	1767	CAP SCREW FOR 1766	1810	SET SCREW FOR 1808, 1807, 1805
1641	TENSION COMPLETE	1686	HINGED FOOT COMPLETE	1728	HOOK SHAFT FRONT BUSHING	1768	BUSHING FOR 1769	1811	KNEE LIFTER LEVER ARM
1642	TENSION BARREL	1687	SCREW FOR 1686	1729	OIL WICK FOR 1726	1769	FEED REGULATING SCREW SPINDLE		
1643	TENSION DISC	1688	SPRING FOR 1676	1730	HOOK SHAFT REAR BUSHING				
1644	TENSION RELEASE WASHER	1689	MAIN SHAFT ONLY						
1645	CHECK SPRING								