

TOYOTA D324

Model
(120)

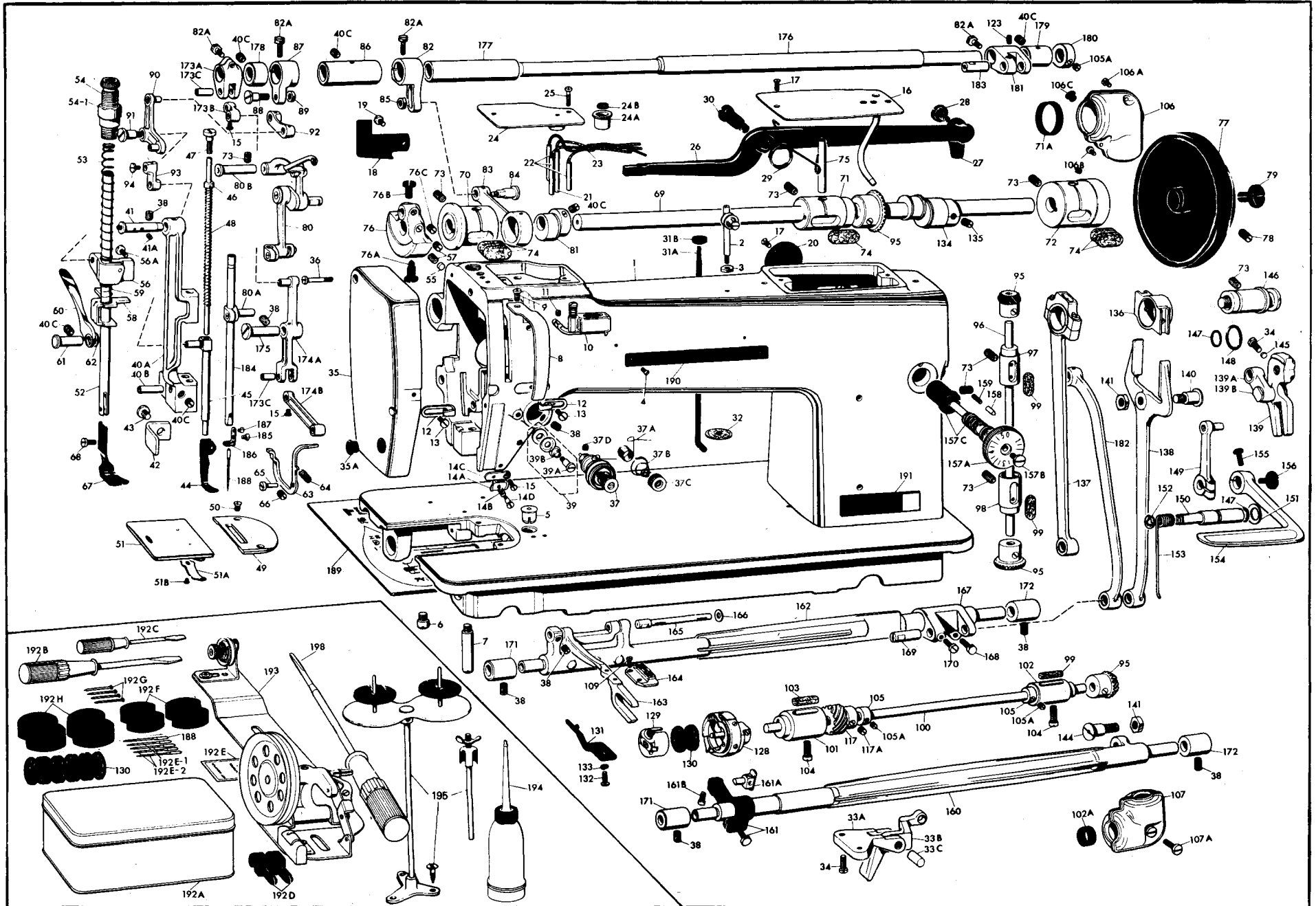

TOYOTA D324

IDEN NO.	PARTS NO.	PARTS NAME	IDEN NO.	PARTS NO.	PARTS NAME	IDEN NO.	PARTS NO.	PARTS NAME	IDEN NO.	PARTS NO.	PARTS NAME
1	2120311-100-R	ARM BED ASSEMBLY	40B	2120305-435	RETAINER PIN FOR 40A	84	9015500-060-A	PIBOT SCREW FOR 83	156	9541208-107	CAP SCREW FOR 154
2	2110202-310	SPOOL PIN COMPLETE	40C	9501509-276	SET SCREW FOR 40B	85	9440124-119	NUT FOR 84	157	2120315-032-C	FEED REGULATOR DIAL COMPLETE
3	2110602-319	NUT FOR 2	41	2110602-214	HINGE PIN FOR 38	86	2120305-423-A	METAL FOR UPPER FEED SHAFT	157A	2110815-350-B	FEED REGULATOR DIAL
4	9540805-102	SCREW FOR 190	41A	9500802-276	SET SCREW FOR WICK	87	2120305-420-B	UPPER FEED LINK UPPER	157B	9541203-247	SET SCREW FOR 157A
5	2110401-204-B	OIL CAP (COMPLETE)	42	2120302-512-A	GUIDE PLATE FOR 38	88	9015500-055-A	PIVOT SCREW FOR 87	157C	2110305-305	FEED REGULATOR BUSHING
6	2210101-153-A	BED LEG REAR	43	9541501-119	SET SCREW FOR 42	89	9410151-219	UNIT FOR 88	158	2110305-353-B	STOP PIN FOR 157A
7	2110401-153-B	BED LEG FRONT	44	2120303-260-A	WALKING FOOT	90	2120305-401-A	LINK FOR 93	159	2110105-354-A	SPRING FOR 158
8	2120301-241	GUARD FOR TAKE UP LEVER	45	2120303-262	WALKING FOOT BAR	91	9015500-056	PIVOT SCREW FOR 90	160	2120305-251	FEED LIFTING SHAFT
9	9541104-259	SCREW FOR 8	46	2120303-280	GUIDE BAR FOR 48	92	2120305-415-C	UPPER FEED LINK UPPER	161	2110305-260-B	FEED LIFTING BELL ARM
10	0252011-110-A	LUBRICATING DEVICE FOR UPPER THREAD	47	9531503-259	ADJUSTING SCREW FOR 48	93	2120305-416-A	LOWER FEED LINK LOWER	161A	2110205-204	SLIDING BLOCK
11	9501102-256	SCREW FOR THREAD GUIDE WITH THREE HOLES	48	2120303-263	WALKING FOOT BAR SPRING	94	9540804-276	SET SCREW FOR 93	161B	9541207-279	SET SCREW FOR 161
12	2110602-313-B	THREAD GUIDE	49	2120303-113-D	NEEDLE PLATE	95	2120304-101	GEAR COMPLETE	162	2120305-271-A	FEED ROCK SHAFT
13	9540901-101	SET SCREW FOR 12	50	9561103-261	SET SCREW FOR 49	96	2120304-241	VERTICAL SHAFT ONLY	163	2120305-221-B	FEED BAR
14	2120312-350	TENSION (COMPLETE)	51	2110213-120-A	SLIDE PLATE COMPLETE	97	2120304-242-A	VERTICAL SHAFT UPPER BUSHING	164	2120305-223-B	FEED DOG
14A	2120302-352	TENSION DISC	51A	1110301-522	SLIDE PLATE SPRING	98	2120304-243-B	VERTICAL SHAFT LOWER BUSHING	165	2110205-225-D	FEED BAR SHAFT
14B	2120302-355	TENSION SPRING	51B	9540601-103	SET SCREW FOR 51A	99	2110406-367	FELL FOR 97, 98	166	9030100-036	THRUST WASHER FOR 165
14C	2120302-365	TENSION PLATE	52	2120303-211-A	PRESSER BAR	100	2120304-211	HOOK SHAFT ONLY	167	2120305-281	FEED ROCK ARM
14D	9015500-059	TENSION ADJUSTING SCREW	53	2110403-213-A	PRESSER SPRING	101	2120304-212-B	HOOK SHAFT FRONT BUSHING COMPLETE	168	9531102-256	SET SCREW FOR 167
15	9540905-319	SET SCREW FOR 14C	54	2110403-271-A	PRESSURE REGULATOR SCREW	102	2120304-202	HOOK SHAFT REAR BUSHING COMPLETE	169	2120305-282-A	HINGED PIN FOR 167
16	2110411-210-A	TOP COVER PLATE	54-1	2130103-274	PRESSURE REGULATOR NUT	102A	2110404-272	PACKING FOR 107	170	9531102-256	SET SCREW FOR 169
17	9560904-307	SCREW FOR 16	55	2120303-273	PLUG FOR 57	103	2110416-364	FELT FOR 101	171	2110205-231	FRONT BUSHING FOR 162
18	2120301-263	COVER PLATE	56	2120303-230-A	PRESSER BAR GUIDE BRACKET COMPLETE	104	9531501-256	SET SCREW FOR 101, 102	172	2110205-232	REAR BUSHING FOR 162
19	9540916-119	SET SCREW FOR 18	56A	9531202-119	SET SCREW FOR 56	105	2210204-240	HOOK SHAFT COLLAR COMPLETE	173	2120305-430-A	NEEDLE FEED ARM FRONT COMPLETE
20	2110201-251	BACK COVER PLATE	57	9501801-276	ADJUSTING SCREW FOR 55	106	2110404-205-J	UPPER GEAR CASE COMPLETE	173A	2120305-431-A	NEEDLE FEED ARM FRONT
21	2120306-385	OIL TUBE FOR 80	58	2120303-242-C	KNEE LIFTER PLATE	105A	9501102-256	SET SCREW FOR 105	173B	2120305-432	UPPER LINK
22	2110106-384-D	GUIDE TUBE	59	2110403-216-A	SPRING FOR 58	106	2110404-205-J	UPPER GEAR CASE COMPLETE	173C	2120305-433	HINGE PIN FOR 173B
23	2120306-311	OIL WICK	60	2110103-351-B	KNEE LIFTER	106A	9530901-116	SET SCREW FOR 106	174	2120305-400-C	CONNECTING ROD COMPLETE
24	2110401-260-A	COVER PLATE FOR OIL WELL	61	1110102-367-C	KNEE LIFTER PIN	106B	9540908-279	SET SCREW FOR 106	174A	2120305-440-C	CONNECTING ROD
24A	2110406-172-A	OIL WELL	62	9030100-039	WASHER FOR 60	106C	2110201-254	PLUG FOR 106	174B	2120305-434-A	LOWER LINK
24B	2110406-361	FELT IN OIL WELL	63	2120303-411-A	THREAD TENSION RELEASE	107	2110404-206-C	LOWER GEAR CASE COMPLETE	175	2120305-441	NEEDLE FEED CONNECTING ROD
25	9540907-207	SET SCREW FOR 24	64	2120302-393	SPRING FOR 63	107A	9541206-102	SET SCREW FOR 107	176	2120305-451-A	NEEDLE FEED SHAFT
26	2120303-311-A	KNEE LIFTER LEVER	65	2110203-413-B	SHAFT FOR 63	109	9530801-279	SET SCREW FOR 164	177	2120305-422	UPPER FEED SHAFT
27	2110103-313	KNEE LIFTER LINK	66	9540905-319	SET SCREW FOR 65	128	2120304-310-A	ROTATING HOOK ASSEMBLY	178	2120305-452	FRONT BUSHING FOR 176
28	9015500-029-B	LINK SCREW FOR 27	67	2120303-264-A	PRESSER FOOT	129	2120304-301	BOBBIN CASE ASSEMBLY	179	2120305-454	REAR BUSHING FOR 176
29	2120303-333	SPRING FOR 26	68	9540903-241	SET SCREW FOR 67	130	2120314-321	BOBBIN	180	2120305-405-A	COLLAR FOR 79
30	9015500-038-B	HINGE SCREW FOR 26	69	2110404-111-B	TOP SHAFT	131	2110204-315-E	HOOK RETAINER	181	2120305-436	NEEDLE FEED ROCK ARM
31	2120303-320	KNEE LIFTER PULL ROD COMPLETE	70	2110804-112-B	TOP SHAFT FRONT BUSHING COMPLETE	132	9531104-267	SET SCREW FOR 131	182	2120305-442	NEEDLE FEED ROD
31A	2120303-321	KNEE LIFTER PULL ROD	71	2110804-103-A	TOP SHAFT CENTER BUSHING COMPLETE	133	9130500-318	SPRING WASHER FOR 132	183	2110205-282	HINGED PIN FOR 167
31B	9440124-107	NUT FOR 31A	71A	2110404-271	PACKING FOR 106	134	2120305-111-B	FEED CAM	184	2120302-111-B	NEEDLE BAR ONLY
32	1210102-187-A	FELT WASHER FOR 31A	72	2110804-114-A	TOP SHAFT REAR BUSHING COMPLETE	135	9501508-276	SET SCREW FOR 134	185	9540809-259	SET SCREW FOR 188
33	2120303-330-B	KNEE LIFTER RELEASE LEVER	73	9015600-006	SET SCREW FOR 72	136	2120305-112-A	GUIDE FOR FEED FORK	186	2120312-116-B	THREAD GUIDE FOR 188
33A	2110403-331-A	BRACKET FOR 33B	74	2110406-364	FELT FOR 72	137	2110305-160-A	CRANK ROD COMPLETE	187	9530601-104	SET SCREW FOR 186
33B	2120303-332-B	KNEE LIFTER RELEASE LEVER	75	2110106-384	OIL PIPE LARGE	138	2120305-141	FEED FORK	188	2120302-189	NEEDLE # 23
33C	2110403-334-A	KNEE LIFTER JOINT	76	2120312-130	TAKE UP LEVER CRANK COMPLETE	139	2120305-310-D	FEED REGULATOR COMPLETE	190	2110949-215	NAME PLATE
34	9541201-256	SET SCREW FOR 33A	76A	9013400-013	SET SCREW FOR 76	139A	2110305-319-A	FEED REGULATOR LINK	191	2120309-411-C	MODEL NUMBER PLATE
35	2120301-230-D	FACE COVER PLATE	76B	9541604-256	CLAMP SCREW FOR 80	139B	2110305-313	CAP SCREW FOR 139A	192	0203171-110	ACCESSORY BOX (COMPLETE)
35A	2120201-234	PLUG FOR 35	76C	9501604-256	SET SCREW FOR 80	140	9013300-005	SET SCREW FOR 138	192A	0102681-111-E	ACCESSORY BOX
36	9540920-207	SET SCREW FOR 35	77	2120304-151-A	HAND WHEEL	141	9410182-204	NUT FOR 138	192B	0103083-111	DRIVER LARGE
37	2110912-350-A	TENSION COMPLETE	78	9501503-276	SET SCREW FOR 77	144	9015500-036-A	PIVOT SCREW FOR 160	192C	0103083-111	DRIVER SMALL
37A	2110202-354-B	CHECK SPRING	79	2110604-152	CAP SCREW FOR 77	145	2110105-325	METAL PAD	192D	0201385-173-A	HINGE SHEET
37B	2110402-355	TENSION SPRING	80	2120302-021-C	TAKE UP LEVER COMPLETE	146	2110305-320-A	FULCRUM SHAFT COMPLETE	192E	2120312-190	NEEDLE
37C	2110202-359	TENSION ADJUSTING KNOB	80A	2120302-101-A	NEEDLE BAR BRACKET	147	9060100-007	WASHER FOR 146	192E-1	2120302-197	NEEDLE # 21
37D	2110202-358	SET SCREW	80B	2110202-214	HINGE STUD FOR 80	148	9060100-008	WASHER FOR 146	192E-1	2120302-198	NEEDLE # 22
38	9501508-276	SET SCREW FOR 37	81	2120305-410	FEED CAM	149	2110605-330-A	FEED REGULATOR ARM	193	2110202-410-C	BOBBIN WINDER
39	2120302-350	TENSION COMPLETE	82	2120305-406-A	UPPER FEED BAR REAR COMPLETE	150	2110605-335-A	REGULATOR SHAFT	194	0202012-105	OILER
39A	9015500-054	ADJUSTING SCREW	82A	9581201-456	SET SCREW FOR 82	151	9030400-001	WASHER FOR 150	195	0201106-130	SPOOL HOLDER
39B	2110212-355	TENSION SPRING	83	2120305-412	UPPER FEED CONNECTING ROD	152	9080200-001	STOP RING FOR 150	198	0201013-111-C	DRIVER LARGE
40	2120302-510-B	NEEDLE BAR (COMPLETE)				153	2110605-338-A	SPRING FOR 150			
40A	2120302-511-B	NEEDLE BAR ARM				154	2110905-334-C	REVERSE LEVER			
						155	9541220-107	SET SCREW FOR 154			