

Model 202R 202RB

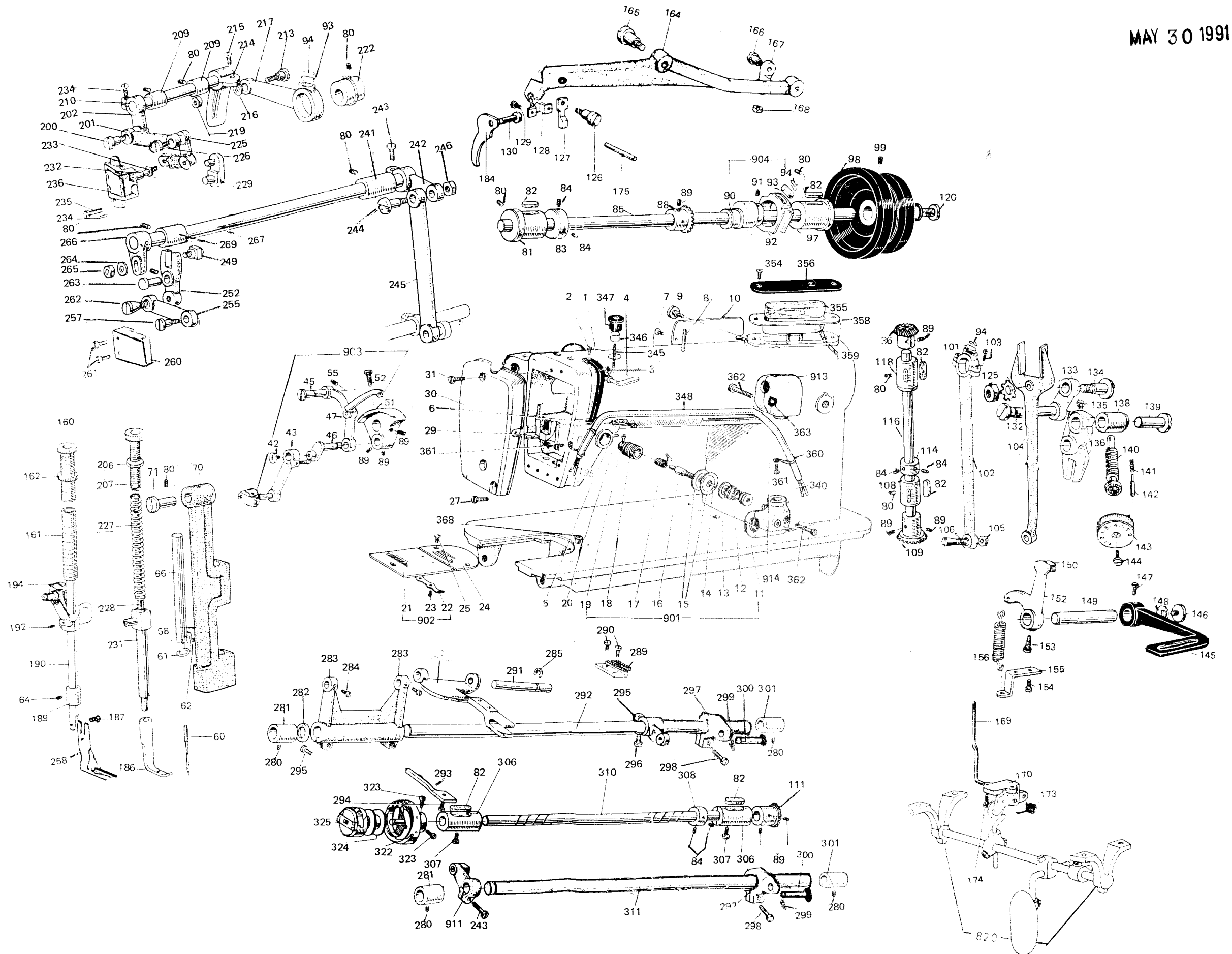

Industrial Sewing Machine Parts Catalog

| Fig No. | Description | Fig No. | Description | Fig No. | Description | Fig No. | Description | Fig No. | Description |
|---------|--|---------|---|---------|---------------------------------------|---------|---|---------|------------------------------------|
| 1 | Thread take-up cover | 93 | Felt for feed cam | 165 | Hinged screw 5/16(24)X30 | 245 | Feed drive connecting link | 340 | Wool yarn |
| 2 | Screw 11/64(40)X5.5 | 94 | Spring for feed cam | 166 | Hinged screw 15/64(28)X10 | 246 | Nut 9/32(28) | 345 | Oil wick ϕ 2.5X35 |
| 3 | Set screw 11/64(40)X5.5 | 97 | Arm shaft bushing (right) | 167 | Knee lifter rock shaft arm | 249 | Feed connecting slick block complete | 346 | Felt for oiler |
| 4 | Three hole thread guide | 98 | Balance wheel | 168 | Nut 3/16(32) | 252 | Feed connecting rod lever | 347 | Cap for oiler |
| 5 | Thread guide for arm | 99 | Screw 15/64(28)X12 | 169 | Lifting lever connecting rod | 255 | Walking foot connecting link | 348 | Oil pipe ϕ 3X ϕ 4.2X580 |
| 6 | Screw 9/64(40)X6 | 101 | Felt for crank rod | 170 | Knee lifter bell crank complete | 257 | Hinged screw 1/4(40)X12 | 913 | Arm shaft bevel gear box complete |
| 7 | Screw 11/64(40)X7 | 102 | Crank rod | 173 | Knee lifter bell crank spring | 258 | Walking foot | 914 | Hook shaft bevel gear box complete |
| 8 | Spool pin | 104 | Feed forked connecting rod | 174 | Screw 11/64(40)X12 | 259 | Screw 9/64(40)X8 | 354 | Screw 11/64(40)X7 |
| 10 | Arm side cover | 105 | Nut 9/32(28) | 175 | Upper thread releasing pin | 260 | Guide bracket | 355 | Felt for oil reservoir |
| 11 | Thread tension regulating thumb nut | 106 | Taper screw 9/32(28)X23 | 184 | Presser lifter | 261 | Screw 11/64(40)X12 | 356 | Oil reservoir cover (right) |
| 12 | Thread tension spring | 108 | Vertical shaft bushing (under) | 185 | Set screw 11/64(40)X8.5 | 262 | Taper screw 1/4(40)X26 | 358 | Oil reservoir (right) |
| 13 | Thread tension releasing disc | 109 | Bevel gear for vertical shaft (under) | 186 | Presser foot (inside) | 263 | Hing pin | 359 | Oil wick ϕ 2.5X100 |
| 14 | Thread tension releasing pin ϕ 2X28.4 | 111 | Bevel gear for hook shaft | 187 | Screw 1/4(40)X9 | 264 | Washer | 360 | Oil pipe holder |
| 15 | Thread tension disc | 116 | Vertical shaft | 188 | Set screw 11/64(40)X27 | 265 | Nut 1/4(24) | 361 | Screw 9/64(40)X6.5 |
| 16 | Thread tension stud | 118 | Vertical shaft bushing (upper) | 189 | Presser bar bushing (under) | 266 | Feed driving rock shaft crank (left) | 362 | Screw M5X12 |
| 17 | Thread take-up spring | 120 | Screw 11/32(28)X10 | 190 | Presser bar | 267 | Feed driving shaft (upper) | | |
| 18 | Thread tension regulator bushing | 126 | Hinged screw 3/16(28)X6.2 | 192 | Set screw 15/64(28)X8 | 269 | Feed driving shaft bushing (left) | | |
| 19 | Screw 9/64(40)X4 | 127 | Upper thread releasing cam | 194 | Presser bar holder | 280 | Set screw 15/64(28)X10 | | |
| 901 | Thread tension regulator complete | 128 | Guide plate | 200 | Hinged screw 1/4(40)X12 | 281 | Feed rock shaft bushing | | |
| | Set screw 15/64(28)X8 | 129 | Screw 11/64(40)X7 | 201 | Feed lifting rock shaft link | 282 | Feed rock shaft bushing washer | | |
| 902 | Slide plate complete | 130 | Presser foot lifting pin | 202 | Upper feed lifting rock shaft crank | 283 | Feed rock shaft crank (left) | | |
| 24 | Needle plate B2.6(7mm) | 132 | Eccentric pin | 206 | Nut 9/32(28) | 284 | Screw 11/64(40)X8 | | |
| 27 | Screw 11/64(40)X20 | 133 | Feed connecting link | 207 | Feed regulating screw 9/32(28)X35 | 285 | E-type spring | | |
| 29 | Thread guide for face Plate | 134 | Set pin | 209 | Feed lifting rock shaft bushing | 286 | Feed bar | | |
| 30 | Face plate | 135 | Screw 15/64(28)X10 | 210 | Feed lifting rock shaft | 289 | Feed dog | | |
| 31 | Screw 5/32(40)X30 | 136 | Feed regulator | 213 | Hinged screw M3 PO 75X24 | 290 | Screw 1/8(44)X6 | | |
| 903 | Thread take-up lever & needle bar complete | 138 | Feed connecting bushing | 214 | Feed lifting rock shaft crank (right) | 291 | Feed bar holder stud | | |
| 51 | Crank | 139 | Feed connecting hinge pin | 215 | Screw 1/4(24)X16 | 292 | Feed rock shaft | | |
| 52 | Screw 4 x 16 | 140 | Stitch length regulator screw | 216 | Washer 6 | 293 | Rotating hook positioner | | |
| 60 | Needle DPX17 #22 | 141 | Presser spring for stitch length | 217 | Feed connecting crank rod | 294 | Screw 11/64(40)X10 | | |
| 61 | Needle bar thread guide set screw | 142 | Stopper pin for stitch length 4X18 | 219 | U-nut 6X0.75 | 295 | Screw 3/16(28) X5 | | |
| 62 | Thread guide for needle bar | 143 | Stitch length regulator dial | 222 | Feed lifting eccentric | 297 | Feed lifting & rock shaft crank | | |
| 66 | Needle bar | 144 | Screw 3/16(28)X8 | 225 | Bell crank | 298 | Screw 1/4(24)X16 | | |
| 68 | Needle bar thread guide set screw | 145 | Reverse sewing lever | 226 | Screw 3/16(28)X10 | 299 | Screw 15/64(28)X8.5 | | |
| 70 | Needle bar guide bracket | 146 | Screw 3/16(28)X6.5 | 227 | Spring | 300 | Pin for feed lifting rock shaft crank | | |
| 71 | Needle bar guide bracket rot | 147 | Screw 15/64(28)X8.5 | 228 | Spring guide bar complete | 303 | Feed lifting rock shaft screw 3/8(28)X35 | | |
| 80 | Set screw 15/64(28)X7 | 148 | Spring washer | 229 | Vibrating presserbar link | 304 | Nut 3/8(28) | | |
| 81 | Arm shaft bushing (left) | 149 | Reverse stitch lever shaft | 231 | Vibrating presser bar | 311 | Feed lifting rock shaft | | |
| 82 | Felt for arm shaft bushing | 152 | Stitch length regulating bracket complete | 232 | Bell crank guide bracket block | 911 | Feed lifting rock shaft crank complete (left) | | |
| 83 | Collar for arm shaft | 153 | Screw 15/64(28)X14.5 | 233 | Bell crank guide pin | 306 | Rotating hook shaft bushing (right) | | |
| 84 | Set screw 1/4(40)X4 | 154 | Screw 11/64(40)X8 | 234 | Spring Pin | 307 | Screw 11/64(40)X13 | | |
| 85 | Arm shaft | 155 | Feed regulating spring holder | 235 | Screw 11/64(40)X8 | 308 | Collar for rotating hook shaft | | |
| 86 | Bevel gear for vertical shaft (upper) | 156 | Spring | 236 | Bell crank guide bracket | 310 | Rotating hook shaft | | |
| 88 | Bevel gear for arm shaft | 160 | Presser regulating thumb screw 1/2(28)X43 | 241 | Feed driving shaft bushing (right) | 322 | Rotating hook complete HSM-A | | |
| 89 | Set screw 1/4(40)X7 | 161 | Presser bar spring | 242 | Feed driving rock shaft crank | 323 | Screw 11/64(40)X5 | | |
| 90 | C-type stop ring | 162 | Special nut 1/2(28) | 243 | Screw 1/4(24)X16 | 324 | Bobbin | | |
| 904 | Feed cam complete | 164 | Lifting lever (upper) | 244 | Hinged screw for connecting rod | 325 | Bobbin case complete | | |