

CONSEW PARTS FOR MODELS 326

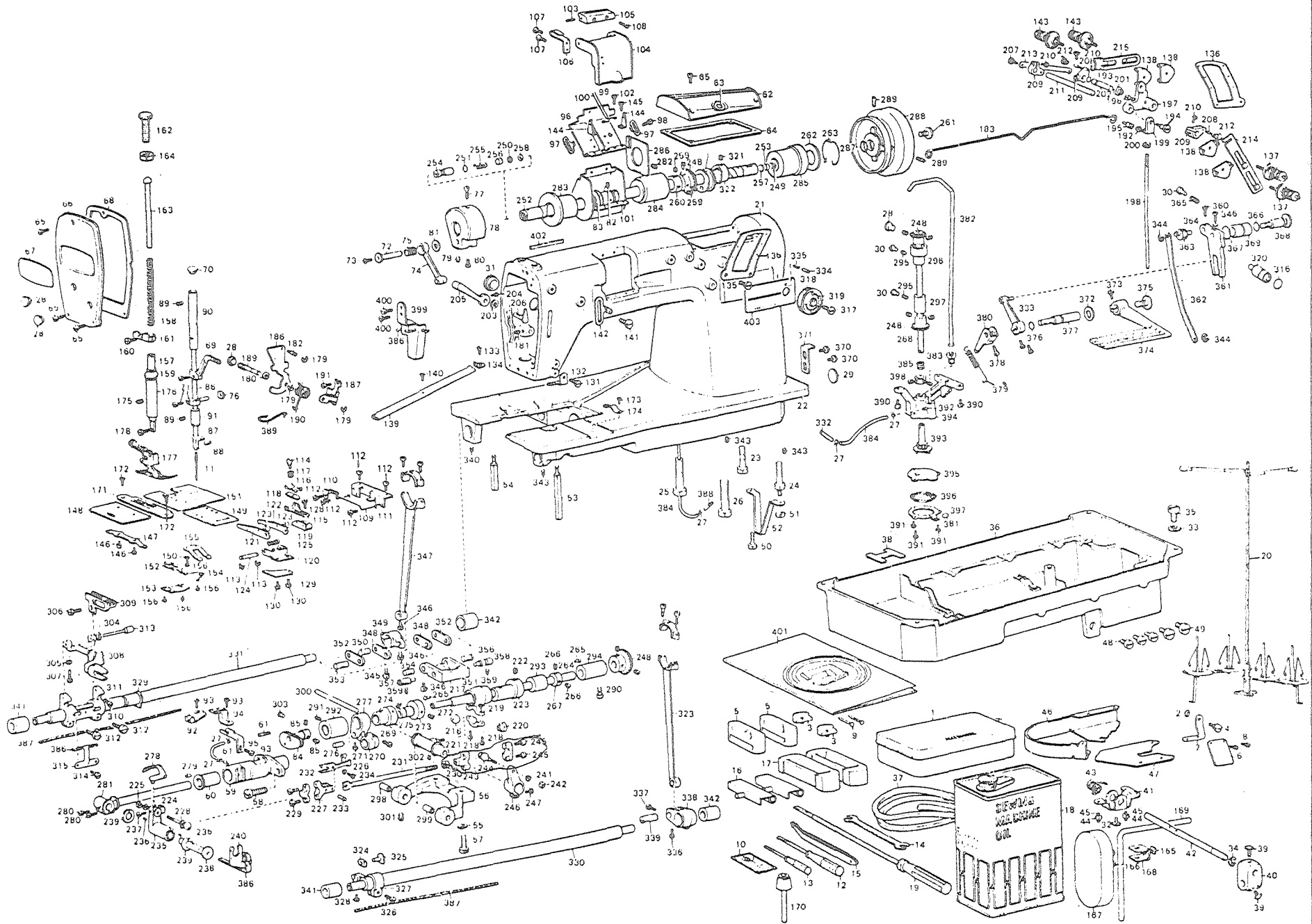

© 1982 - CONSEW - 282 - Printed in U.S.A.

From the library of: Superior Sewing Machine & Supply LLC

IDEN NO.	PARTS NAME	IDEN NO.	PARTS NAME	IDEN NO.	PARTS NAME	IDEN NO.	PARTS NAME	IDEN NO.	PARTS NAME
1	ACCESSORY BOX COMPLETE	82	SET SCREW FOR 83	164	NUT FOR 162	248	GEAR COMPLETE	330	FEED LIFTING SHAFT ONLY
2	SPRING WASHER FOR 7	83	THREAD (NEEDLE) TAKE-UP	165	SET SCREW FOR 168	249	SET SCREW FOR 253	331	FEED ROCK SHAFT ONLY
3	CORNER RUBBER	84	THREAD (LOOPER) TAKE-UP	166	KNEE LIFTER PLATE	250	FLAT WASHER FOR 256	332	OIL HOSE NIPPLE
4	HINGE SCREW FOR 7	85	SET SCREW FOR 84	167	KNEE LIFTER PAD	251	RUBBER RING FOR 254	333	FEED REGULATOR ARM
5	RUBBER BASE FOR BED	86	NEEDLE BAR ONLY	168	SUPPORT FOR 166	252	TOP SHAFT ONLY	334	FEED REGULATOR DIAL PIN
6	NEEDLE GUARD WINDOW	87	NEEDLE CLAMP THREAD GUIDE	169	KNEE LIFTER ARM	253	TOP SHAFT OIL STOPPER	335	FEED REGULATOR DIAL SPRING
7	BRACKET FOR 6	88	NEEDLE CLAMP BODY	170	KNEE LIFTER PLUNGER	254	ADJUSTING VALVE FOR LUBRICATION	336	SET SCREW FOR 338
8	SET SCREW FOR 6	89	SET SCREW FOR 91, 90	171	NEEDLE PLATE	255	SPRING FOR 254	337	SET SCREW FOR 339
9	NAIL	90	NEEDLE BAR UPPER BUSHING	172	SET SCREW FOR 171	256	OIL FELT FOR 252	338	FEED LIFTING BELL CRANK
10	NEEDLE COMPLETE	91	NEEDLE BAR LOWER BUSHING	173	SET SCREW FOR 174	257	OIL STOPPER WASHER FOR 252	339	HINGED PIN FOR 338
11	NEEDLE B-64 # 80	92	NEEDLE GUARD	174	SPRING FOR 149	258	RUBBER WASHER	340	SET SCREW FOR 341
12	DRIVER MIDDLE	93	SET SCREW FOR 92, 94 & ETC	175	SET SCREW FOR 176	259	SET SCREW FOR 260	341	FRONT BUSHING FOR 330 & 331
13	DRIVER SMALL	94	NEEDLE GUARD HOLDER	176	PRESSER BAR BUSHING	260	TOP SHAFT COLLAR	342	REAR BUSHING FOR 330 & 331
14	WRENCH	95	NEEDLE GUARD HOLDER BRACKET	177	HINGED FOOT COMPLETE	261	CAP SCREW FOR 288	343	SET SCREW FOR 341 & 342
15	PINCETTE	96	THREAD (NEEDLE) TAKE-UP STRIPPER PLATE	178	SET SCREW FOR 177	262	FELT FOR 285	344	STOPPER RING FOR 356 & 363
16	BED HINGE	97	THREAD (NEEDLE) GUIDE B FOR 96	179	STOP RING FOR 189	263	RETAINER FOR 262	345	SET SCREW FOR 349
17	HINGE RUBBER	98	SET SCREW FOR 97	180	WASHER FOR 189	264	LOWER SHAFT ONLY	346	SET SCREW FOR 354, 350, 353 & ETC
18	OIL	99	THREAD HOLD DOWN PLATE RIGHT	181	SET SCREW FOR 189	265	OIL STOPPER FOR 264	347	FEED LIFTING CRANK ROD
19	DRIVER LARGE	100	THREAD HOLD DOWN PLATE LEFT	182	HINGE SCREW FOR 186	266	SET SCREW FOR 267	348	FEED ROCK JOINT
20	SPOOL HOLDER	101	COVER FOR THREAD TAKE UP	183	KNEE LIFTER ROD	267	COLLAR FOR 264	349	FEED ROCK ARM
21	ARM	102	SET SCREW FOR 99 & 100	186	KNEE LIFTER PLATE	268	VERTICAL SHAFT ONLY	350	FEED ROCK CONNECTING SHAFT
22	BED	103	HINGE PIN FOR 104	187	SPRING CLAMP FOR 190	269	SET SCREW FOR 270	351	FEED REGULATOR BODY
23	SET SCREW REAR FOR 22	104	COVER PLATE FOR 83	190	SPRING FOR 186	270	LOOPER FEED LIFTING CRANK	352	FEED ROCK OUTER JOINT
24	SET SCREW FRONT FOR 22	105	HINGE ARM	191	SET SCREW FOR 187	271	SET SCREW FOR 276	353	FEED LINK SHAFT A
25	SET SCREW REAR FOR 22	106	SPRING FOR 104	192	STOP RING FOR 195	272	SET SCREW FOR 273	354	FEED LINK SHAFT B
26	SET SCREW FRONT FOR 22	107	SET SCREW FOR 106	193	RUBBER RING FOR 202	273	LOOPER FEED CAM A	356	FEED LINK SHAFT-C
27	OIL HOSE FOR CLEP	108	TENSION SCREW FOR 105	194	HINGE SCREW FOR 199	274	SET SCREW FOR 275	357	FEED REGULATOR SHAFT A
28	PLUG FOR 66	109	SPRING FOR 84	195	HINGE SCREW FOR 197	275	LOOPER FEED CAM B	358	FEED REGULATOR SHAFT B
29	PLUG FOR BED HOLE	110	THREAD (LOOPER) GUIDE RIGHT	196	SET SCREW FOR 197	276	HINGED PIN FOR 277	359	SET SCREW FOR 357 & 358
30	PLUG FOR SCREW HOLE	111	COVER PLATE FOR 84	197	KNEE LIFTER LINK	277	LOOPER FEED LIFTING JOINT	360	SET SCREW FOR 363
31	PLUG FOR 78	112	SET SCREW FOR 109, 110, 111	198	KNEE LIFTER PULL	278	LOOPER	361	FEED REGULATOR CAM
32	SET SCREW FOR 41	113	STOP RING FOR 124	199	KNEE LIFTER BELL CRANK LINK	279	OIL FELT	362	FEED REGULATOR ROD
33	PACKING FOR 35	114	SET SCREW FOR 116	200	NUT FOR 198	280	SET SCREW FOR 281	363	ADJUSTING PIN FOR 362
34	STOP RING FOR 42	115	TENSION THREAD GUIDE (LOOPER)	201	BUSHING FOR 202	281	LOOPER HOLDER LOCK SHAFT	364	PAD FOR 346
35	DRAIN PLUG	116	TENSION UPPER PLATE (LOOPER)	202	HINGE PIN FOR 197	282	SET SCREW FOR 284	365	SET SCREW FOR 369
36	OIL PAN	117	TENSION SPRING (LOOPER)	203	OIL SEAL FOR 206	283	TOP SHAFT FRONT BUSHING	366	RUBBER RING FOR 368
37	OIL PAN GASKET	118	TENSION LOWER PLATE (LOOPER)	204	SET SCREW FOR 205	284	TOP SHAFT CENTER BUSHING	367	RUBBER RING FOR 369
38	OIL FELT FOR 36	119	THREAD (LOOPER) TAKE-UP PLATE	205	PRESSER BAR LIFTER LEVER	285	TOP SHAFT REAR BUSHING	368	FEED REGULATOR SHAFT FOR 361
39	SET SCREW FOR 40	120	HINGE HOLDER FOR 124	206	FULCRAM FOR 205	286	OIL STOPPER FOR FELT	369	FEED REGULATOR BUSHING
40	KNEE LIFTER ARM JOINT	121	THREAD (LOOPER) TAKE UP GUIDE	207	JOINT SCREW FOR 213	287	PACKING FOR 288	370	SET SCREW FOR 371
41	KNEE LIFTER CONTROLLER	122	THREAD (LOOPER) HOLD DOWN PLATE	208	HINGE SCREW FOR 209	288	HAND WHEEL	371	LEVER STOPPER
42	KNEE LIFTER SHAFT	123	SPACER FOR 121, 122, 119	209	TENSION RELEASE SHAFT CRANK	289	SET SCREW FOR 288	372	WASHER FOR 377
43	SPRING FOR 41	124	HINGED PIN FOR 120	210	SET SCREW FOR 209	290	SET SCREW FOR 294	373	SET SCREW FOR 374
44	NUT FOR 43	125	SPRING FOR 120	211	TENSION RELEASE SHAFT	291	SET SCREW FOR 292	374	HAND LEVER FOR FEED REGULATOR
45	ADJUST SCREW FOR 41	126	SET SCREW FOR 115	212	SPRING FOR 208	292	LOWER SHAFT FRONT BUSHING	375	CAP SCREW FOR 374
46	BELT COVER BASE	129	SPRING FOR 120	213	TENSION RELEASE CONNECTING ROD	293	LOWER SHAFT CENTER BUSHING	376	RUBBER RING FOR 377
47	COVER PLATE FOR 46	130	SET SCREW FOR 129, 120	214	TENSION (NEEDLE THREAD) RELEASER	294	LOWER SHAFT REAR BUSHING	377	REGULATOR SHAFT
48	SET SCREW FOR 47	131	SET SCREW FOR 132	215	TENSION (LOOPER THREAD) RELEASER	295	SET SCREW FOR 296, 297	378	SET SCREW FOR 380
49	SET SCREW FOR 46	132	THREAD (NEEDLE) GUIDE LOWER	216	LOOPER DRIVING BALL STUD	296	VERTICAL SHAFT UPPER BUSHING	379	SPRING FOR 377
50	SET SCREW FOR 52	133	SET SCREW FOR 134	217	LOOPER DRIVING BALL STUD CONNECTION	297	VERTICAL SHAFT LOWER BUSHING	380	RETAINER FOR 379
51	NUT FOR 52	134	THREAD (LOOPER) GUIDE	218	SET SCREW FOR 217	298	BUSHING REAR FOR 300	381	MAGNET
52	BED LEG RIGHT	135	SET SCREW FOR 136	219	NUT FOR 218	299	BUSHING FRONT FOR 300	382	OIL FEED TUBE
53	BED LEG FRONT	136	THREAD GUIDE ARM TOP	220	NUT FOR 221	300	HINGE SHAFT FOR 221	383	NUT FOR 382
54	BED LEG REAR	137	TENSION (NEEDLE THREAD) COMPLETE	221	LOOPER BALL CRANK	301	SET SCREW FOR 298, 299	384	OIL HOSE
55	SPRING WASHER FOR 57	138	TENSION THREAD GUIDE	222	SET SCREW FOR 223	302	SET SCREW FOR 221	385	SPRING JOINT
56	LOOPER BALL CRANK HOLDER	139	THREAD (LOOPER) TUBE COMPLETE	223	LOOPER FEED ECCENTRIC	304	FLAT WASHER FOR 313	386	OIL WICK FOR 240
57	SET SCREW FOR 56	140	SET SCREW FOR 139	224	SPRING WASHER FOR 228	305	NUT FOR 307	387	OIL WICK FOR 330 & 331
58	SET SCREW FOR 59	141	SET SCREW FOR 142	225	NUT FOR 228	306	CLAMP SCREW FOR 309	388	OIL HOSE NIPPLE
59	LOOPER HOLDER ROCK SHAFT SUPPORT	142	THREAD (NEEDLE) EYELET	226	WASHER FOR 234	307	ADJUSTING SCREW FOR 309	389	OIL HOSE CLAMP
60	BUSHING FOR 59	143	TENSION (LOOPER THREAD) COMPLETE	227	PITMAN HEAD LEFT	308	FEED BAR	390	SET SCREW FOR 394
61	OIL HOSE NIPPLE	144	THREAD (NEEDLE) GUIDE A FOR 96	228	LOOPER DRIVING BALL STUD	309	FEED DOG	391	SET SCREW FOR 397
62	TOP COVER PLATE	145	SET SCREW FOR 144	229	SET SCREW FOR 227	310	SET SCREW FOR 313	392	OIL HOSE NIPPLE
63	OIL GAUGE WINDOW	146	SET SCREW FOR 147	230	LOCK NUT FOR 231	311	FEED BAR BELL CRANK	393	OIL PUMP IMPELLER
64	GASKET FOR 62	147	SPRING FOR 148	231	LOOPER BALL CRANK PITMAN ROD	312	SET SCREW FOR 311	394	OIL PUMP BODY
65	SET SCREW FOR 62	148	SLIDE PLATE COMPLETE	232	SPRING FOR 231	313	FEED BAR SHAFT	395	OIL PUMP COVER
66	FACE COVER PLATE	149	LAP SEAM FELLER SET PLATE	233	PIN FOR 231	314	SET SCREW FOR 315	396	OIL PUMP FILTER
67	NAME PLATE	150	WASHER FOR 156	234	SET SCREW FOR 232	315	OIL WICK RETAINER	397	OIL PUMP FRAME
68	GASKET FOR 66	151	ORNAMENT COVER PLATE	235	LOOPER HOLDER	316	RUBBER RING FOR 320	398	OIL PUMP COLLAR
69	TAKE UP LEVER COMPLETE	152	STOPPER FOR 151	236	SPRING PIN FOR 239	317	LOCK SCREW FOR 318	399	OIL WICK RETAINER
70	CAP FOR 80	153	GUIDE FOR 152	237	SET SCREW FOR 278	318	FEED REGULATOR DIAL BASE	400	SET SCREW FOR 399
71	NEEDLE BAR BRACKET COMPLETE	154	SPRING FOR 152	238	HINGE PIN FOR 235	319	FEED REGULATOR DIAL PLATE	401	INSTRUCTION BOOKLET
72	NEEDLE BAR CRANK PIN	155	SPRING FOR 151	239	WASHER FOR 238	320	FEED REGULATOR DIAL SHAFT	402	SUB NAME PLATE
73	OIL STOPPER SCREW FOR 72	156	SET SCREW FOR 155	240	OIL WICK RETAINING	321	SET SCREW FOR 322	403	MODEL PLATE
74	NEEDLE BAR CRANK ROD	157	PRESSER BAR ONLY	241	SPRING WASHER FOR 244	322	FEED CAM		
75	NEEDLE BEARING COMPLETE	158	PRESSER SPRING	242	NUT FOR 244	323	FEED ROCK CONNECTING ROD		
76	SLIDING BLOCK FOR 74	159	OIL GUARD FOR 157	243	PITMAN HEAD RIGHT	324	SLIDING BLOCK FOR 308		
77	SET SCREW FOR 78	160	SET SCREW FOR 161	244	LOOPER DRIVING BALL STUD	325	SLIDING BLOCK SHAFT		
78	TAKE UP LEVER CRANK	161	PRESSER BAR GUIDE BRACKET	245	SET SCREW FOR 243	326	SET SCREW FOR 327		
79	SET SCREW FOR 72	162	PRESSER REGULATOR SCREW	246	LOOPER BALL CRANK ARM	327	FEED LIFTING BELL ARM		
80	CLAMP SCREW FOR 72	163	PRESSER REGULATOR ROD	247	SET SCREW FOR 246	328	SET SCREW FOR 325		
81	THRUST WASHER FOR 74					329	RUBBER FLANGE		