

NEEDLE BAR MECHANISM FOR PW-8, 8B, 28, 28B

PW-8, 8B, 28, 28B 針棒関係

LIFTING ROCK SHAFT MECHANISM FOR PW-8, 8B, 28, 28B

PW-8, 8B, 28, 28B 横軸関係

A
B
C
D
E
F
G
H
J
K
L
M
N
O
P
Q
R
S
T
U
V

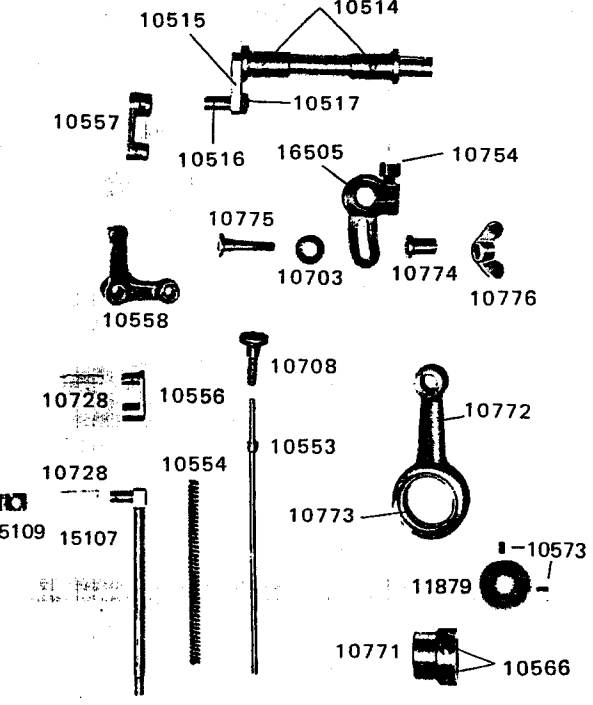
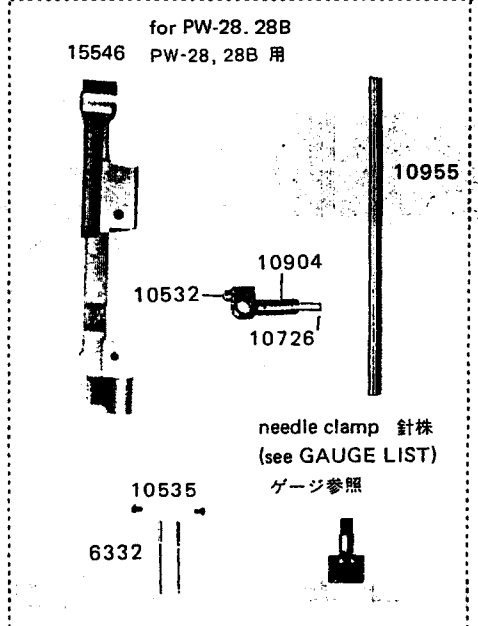
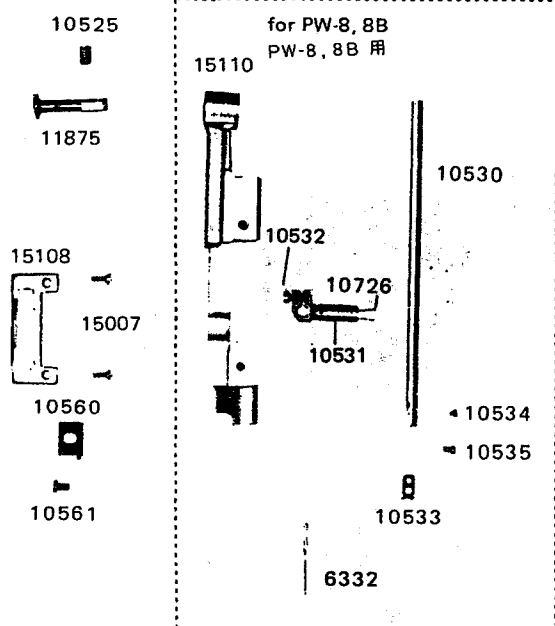

PRESSER BAR MECHANISM FOR PW-8, 8B, 28, 28B

PW-8, 8B, 28, 28B 押え棒関係

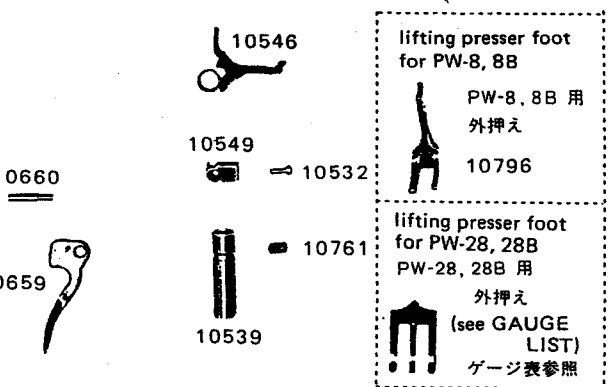
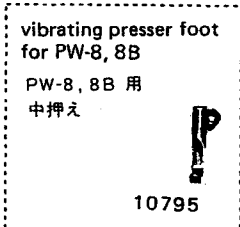
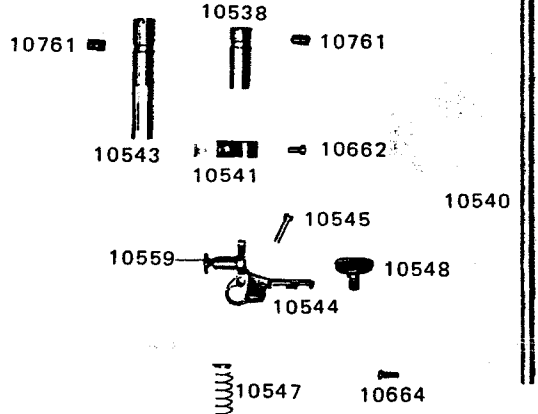

KNEE LIFTER LIFTING LEVER, CONNECTING ROD

全機種、弓、吊り棒関係

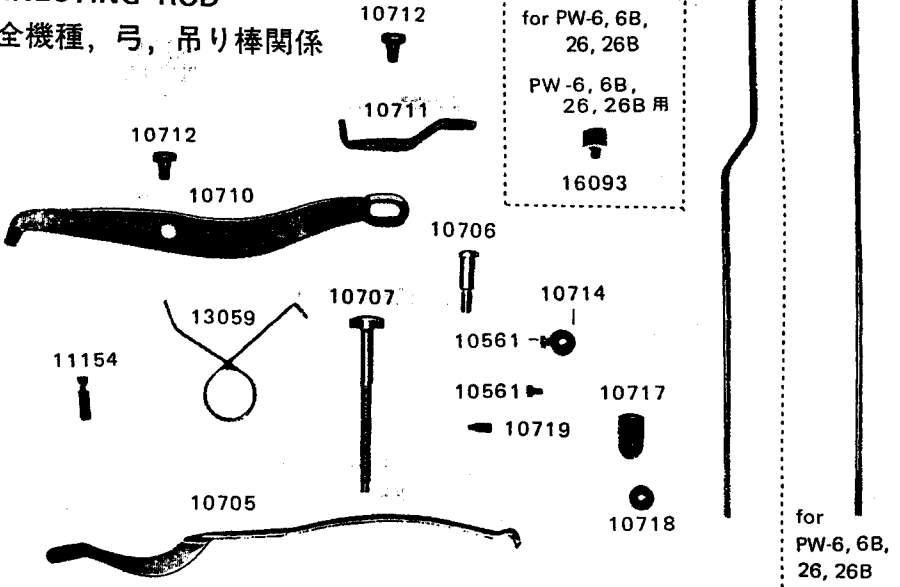

GAUGE LIST FOR PW-28, 28B

PW-28, 28B ゲージ表

<p>needle clamp 針株</p> <p>10001 (3/32")</p> <p>10002 (1/8")</p>	<p>lifting presser foot 外押え</p> <p>10181 (3/32")</p> <p>10182 (1/8")</p>	<p>needle plate 針板</p> <p>10361 (3/32")</p> <p>12211 (1/8")</p>	<p>lifting presser foot 外押え</p> <p>10183 (3/16")</p> <p>10184 (7/32")</p> <p>10185 (1/4")</p> <p>10186 (5/16")</p> <p>10187 (3/8")</p> <p>10188 (7/16")</p>	<p>needle clamp 針株</p> <p>10003 (3/16")</p> <p>10004 (7/32")</p> <p>10005 (1/4")</p> <p>10006 (5/16")</p> <p>10007 (3/8")</p> <p>10008 (7/16")</p>	<p>needle plate 針板</p> <p>12213 (3/16")</p> <p>10364 (7/32")</p> <p>12216 (1/4")</p> <p>10366 (5/16")</p> <p>10367 (3/8")</p> <p>10368 (7/16")</p>	<p>needle clamp 針株</p> <p>10009 (1/2")</p> <p>10010 (9/16")</p> <p>10011 (5/8")</p> <p>10012 (3/4")</p>	<p>lifting presser foot 外押え</p> <p>10189 (1/2")</p> <p>10190 (9/16")</p> <p>10191 (5/8")</p> <p>10192 (3/4")</p>	<p>needle plate 針板</p> <p>10369 (1/2")</p> <p>12239 (9/16")</p> <p>12240 (5/8")</p> <p>12241 (3/4")</p>	<p>lifting presser foot 外押え</p> <p>10283 (3/16")</p> <p>10284 (7/32")</p> <p>10285 (1/4")</p> <p>10286 (5/16")</p> <p>10287 (3/8")</p> <p>10288 (7/16")</p>	<p>needle plate 針板</p> <p>12223 (3/16")</p> <p>10394 (7/32")</p> <p>12226 (1/4")</p> <p>10396 (5/16")</p> <p>10397 (3/8")</p> <p>10398 (7/16")</p>	<p>lifting presser foot 外押え</p> <p>10289 (1/2")</p> <p>10290 (9/16")</p> <p>10291 (5/8")</p> <p>10292 (3/4")</p>	<p>needle plate 針板</p> <p>10399 (1/2")</p> <p>12249 (9/16")</p> <p>12250 (5/8")</p> <p>12251 (3/4")</p>
---	--	---	---	--	--	---	--	---	---	--	--	---

1 2 3 4 5 6 7 8 9 10 11 12 13 14 15

LOWER SHAFT, FEED MECHANISM 送り機構, 下軸関係

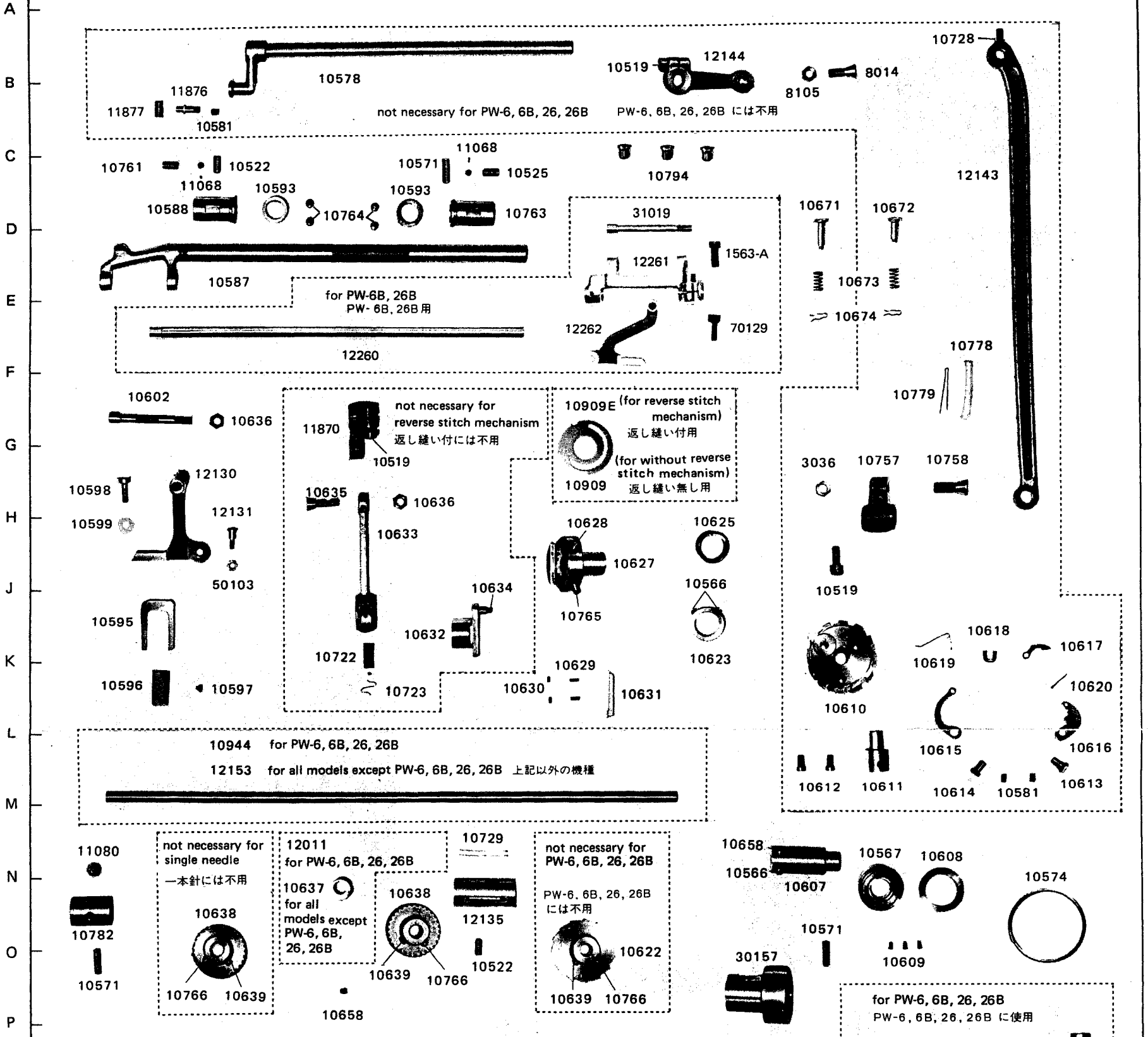

REVERSE STITCH MECHANISM

返し縫い関係

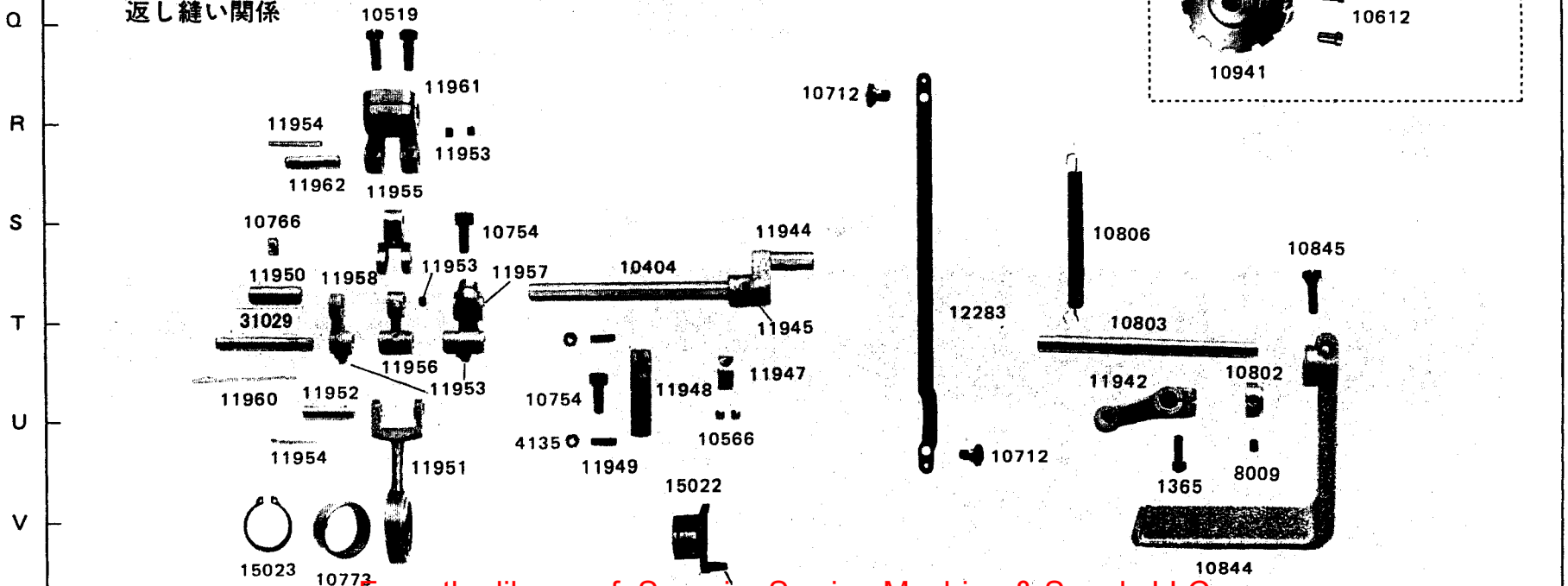

FEED DOG LEVER POST, HOOK SADDLE MECHANISM (SINGLE NEEDLE)

一本針用, 針板土台, カマ土台関係

for PW-7, 7B, 8, 8B
PW-7, 7B, 8, 8B 用

12117 needle plate 針板
12126 feed dog 送り歯

for PW-6, 6B (flat presser foot)
PW-6, 6B 平押え用

12003 needle plate 針板
12006 feed dog 送り歯

for PW-6, 6B (roller presser foot)
PW-6, 6B ローラー押え用

12020 needle plate 針板
12021 feed dog 送り歯

13023
10766 10517
12122 12121 12137 10561 6339 12128 12129 10703 13076
12119 12435 12106 12114 12115 10650 12116 12108 12111-N 12112-N
12132 6031 10545 12123 12136 12110
12136 12120 11134 10767 10650 12136 12110

HOOK カマ

Hook complete number
カマセット番号

12032.... for single need
12530.... for twin needle

for single needle 一本針用
for twin needle 二本針用

13086 1 11124 2 10655-3 16291-3 16407 4 11124-10 11124-12 16407-11 12032 5

FEED DOG LEVER POST, HOOK SADDLE MECHANISM (TWIN NEEDLE)

二本針用, 針板土台, カマ土台関係

for PW-27, 27B, 28, 28B
PW-27, 27B, 28, 28B 用

針板 needle plate 送り歯 feed dog
(see GAUGE LIST) ゲージ表参照

for PW-26, 26B (flat presser foot)
PW-26, 26B 平押え用

針板 needle plate 送り歯 feed dog
(see GAUGE LIST) ゲージ表参照

for PW-26, 26B (roller presser foot)
PW-26, 26B ローラー押え用

針板 needle plate 送り歯 feed dog
(see GAUGE LIST) ゲージ表参照

10656 12105 12107 12530
12052-N 12051-N 12108 12106 12115 12114 6339 12128 12129 10703 13076 12139 10561 12127 12137 10561 12136 12056 12120
12113 12116 10650 12116 12108 12111 12112 12136 12110
12136 12110
11134 10767
12053-N 12054-N
12138 12140 10561

common use for single needle and twin needle
一本針・二本針共通

12138 12140

6031 12231(1/32"-1/8")
12237(3/16"-3/8")
12132(1/2" - 3/4")

NEEDLE BAR MECHANISM FOR PW-7, 7B, 27, 27B
PW-7, 7B, 27, 27B 針棒関係

NEEDLE BAR MECHANISM FOR PW-6, 6B, 26, 26B
PW-6, 6B, 26, 26B 針棒関係

for single needle 一本針用

for twin needle 二本針用

10525, 10537, 10855, 10856, 10726, 10532, 10560, 10561, 10534, 10535, 10860, 6332

12005, 10571, 10856, 10532, 10726, 10571, 10539, 10859, 10534, 10535, 10860, 11194 (for flat presser foot) 平押え用, 12022 (for roller presser foot) ローラー押え用, 10992, needle clamp 針株 (see GAUGE LIST) ゲージ表参照, 11194 (for flat presser foot) 平押え用, 12022 (for roller presser foot) ローラー押え用

needle set screw for twin needle 二本針用針止 12076.....for 12067 12067用, 10535 (right 右) 15823 (left 左)for 15819 15819用

PRESSER BAR MECHANISM FOR PW-6, 6B, 7, 7B, 26, 26B, 27, 27B
PW-6, 6B, 7, 7B, 26, 26B, 27, 27B 押え棒関係

flat presser foot 平押え

roller presser foot ローラー押え

10543, 10538, 10761, 10541, 10662, 10548, 10858, 10660, 10857, 10659, 10532, 10549, 10761, 15836

10540, 10664, 13105, 12432, 12440, 12433, 10535, 12442, 12441, 12433, 10535, 12442, 12441

15833, 15832, 15834, 12740 (1/16" - 3/32"), 12435 (1/32" - 3/64"), 15829, 15826, Set No. 15829C セットNo. 15829C

for twin needle 二本針用 12433, roller holder shim ホルダー受板 12737(1/32"), 12729(3/64"), 12738(1/16"), 12730(5/64"), 12731(3/32"), 10535, 12073, 3052, roller presser needle guard 補助押え 12523 (5/64"), 15844 (3/32"), 12522 (1/16"), 12521 (3/64"), 12520 (1/32")

presser foot for single needle 押え金 一本針用 13105, for twin needle 二本針用 (see GAUGE LIST) ゲージ表参照

GAUGE LIST FOR PW-27, 27B
PW-27, 27B ゲージ表

needle plate 針板	feed dog 送り歯	presser foot 押え金 (平押え用)	needle clamp 針株
10360 (1/16")	10390 (1/16")	11210 (1/16")	11200 (1/16")
10361 (3/32")	10391 (3/32")	11211 (3/32")	11201 (3/32")
12211 (1/8")	12221 (1/8")	11212 (1/8")	11202 (1/8")
12213 (3/16")	12223 (3/16")	11213 (3/16")	11203 (3/16")
10364 (7/32")	10394 (7/32")	10164 (7/32")	10024 (7/32")
12216 (1/4")	12226 (1/4")	11214 (1/4")	11204 (1/4")
10366 (5/16")	10396 (5/16")	11215 (5/16")	11205 (5/16")
10367 (3/8")	10397 (3/8")	11216 (3/8")	11206 (3/8")
10368 (7/16")	10398 (7/16")	10168 (7/16")	10028 (7/16")
10369 (1/2")	10399 (1/2")	10169 (1/2")	10029 (1/2")
12239 (9/16")	12249 (9/16")	10170 (9/16")	10030 (9/16")
12240 (5/8")	12250 (5/8")	10171 (5/8")	10031 (5/8")
12241 (3/4")	12251 (3/4")	10172 (3/4")	10032 (3/4")

GAUGE LIST FOR PW-26, 26B (FLAT PRESSER FOOT)
PW-26, 26B 平押え用ゲージ表

needle plate 針板	feed dog 送り歯
10350 (1/16")	10380 (1/16")
10351 (3/32")	10381 (3/32")
10352 (1/8")	10382 (1/8")
10353 (3/16")	10383 (3/16")
10354 (7/32")	10384 (7/32")
10355 (1/4")	10385 (1/4")
10356 (5/16")	10386 (5/16")
10357 (3/8")	10387 (3/8")
10358 (7/16")	10388 (7/16")
10359 (1/2")	10389 (1/2")
12550 (9/16")	12560 (9/16")
12551 (5/8")	12561 (5/8")
12552 (3/4")	12562 (3/4")

GAUGE LIST FOR PW-26, 26B (ROLLER PRESSER FOOT)
PW-26, 26B, ローラー押え用ゲージ表

needle clamp 針株	needle plate 針板	feed dog 送り歯
12067 (1/32" - 5/64")	12058 (1/32" - 3/64")	12057 (1/32" - 1/16")
15819 (3/32")	12060 (1/16")	12064 (5/64" - 3/32")
	12061 (5/64")	
	12062 (3/32")	

ACCESSORIES

付属品

8132

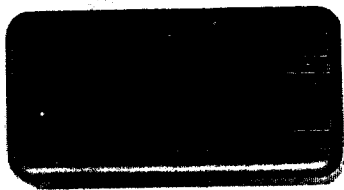

10656



8124



10748



10747

only for reverse stitch mechanism
返し縫い付のみ

11969

11196



only for twin needle
二本針のみ

6332

for all models except PW-6, 26(B)
(flat & roller presser foot)
下記以外の機種

11194

for PW-6, 26(B) flat presser foot
PW-6, 26(B) 平押え用

12022

for PW-6, 26(B) roller presser foot
PW-6, 26(B) ローラー押え用

8118



8120



8121



8123



6052

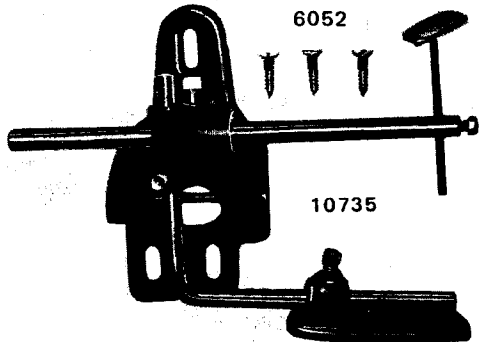

10735

11171

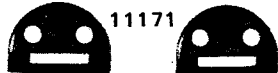

6052

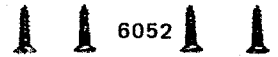

11170

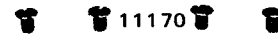

11169

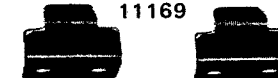

10734

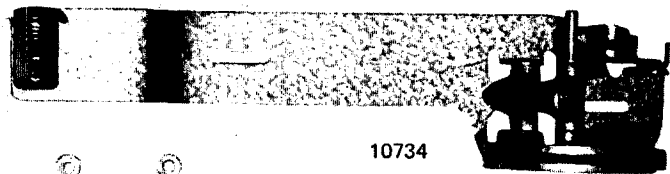

Rubber hinge connection cushion set
(Optional equipment)
ラバーヒンジ(別注品)

6055



6055



11170

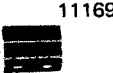

11886



11169A



10733



BELT GUARD (Optional Equipment)

ベルトガード(別注品)

6339



12294-2

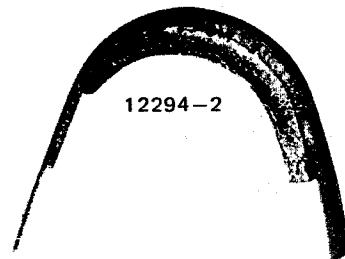

10559



12294-1

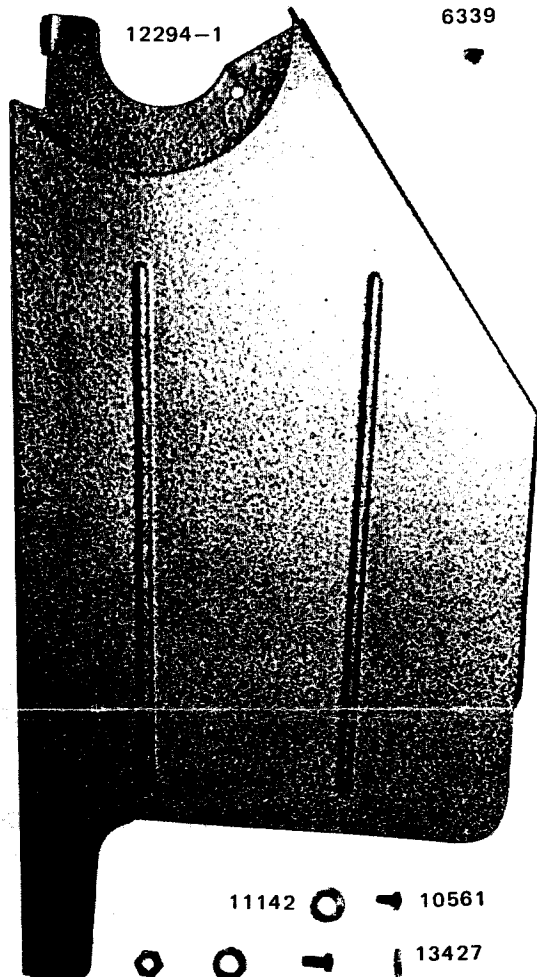

6339



10561



11142



12294-4



14024



16287



50103



11142



10561

50103



16287



14024



13427



10947 complete set number for twin needle
二本針用セットナンバー

35254 complete set number for single needle
一本針用セットナンバー

