

MODEL DSN-178-2

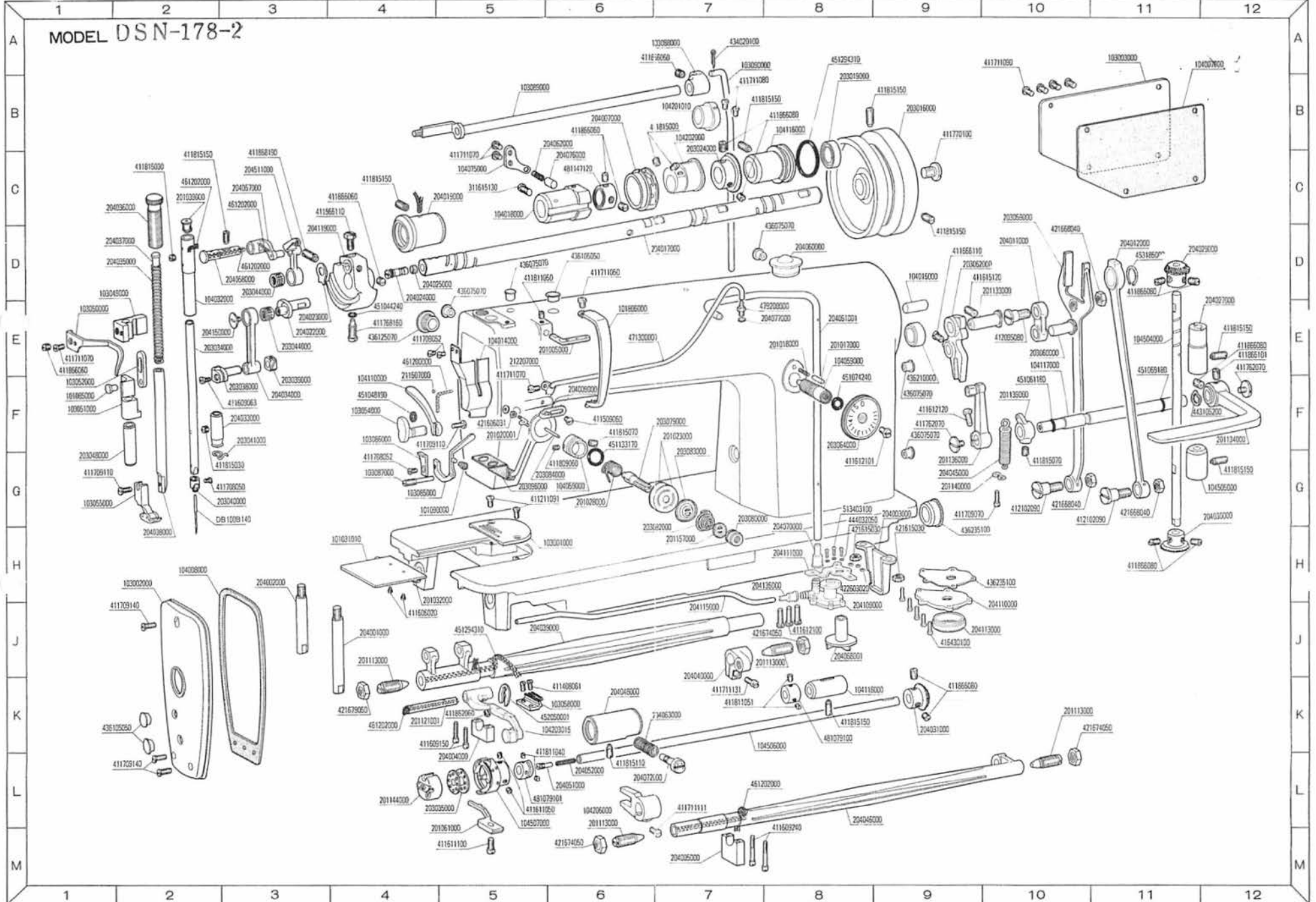

Part No.	Description	Am't.	Part No.	Description	Am't.	Part No.	Description	Am't.
201017000	Feed regulator pin	E 8	436125070	Counterweight screw hole plug	E 4	411211091	Screw 1/64-40 L=8.5	G 5
201018000	Feed regulator pin spring	E 8	436235100	Hookshaft rubber plug	H 9	411606020	Screw 3/32-56 L=1.9	J 4
201020001	Frame thread guide(B)	F 5	436105050	Rubber plug	K 2, D 6	411708051	Screw 1/8-44 L=4.5	O 3
201023000	Thread tension disc	F 7	104014000	Thread take-up lever oil shield	E 5	411866080	Screw 1/4-40 L=8.0	B 8, K 9
201026000	Take-up spring	G 6	436216000	Rubber plug for adjuster hole	F 9	411866060	Screw 1/4-40 L=6.0	E 1, C 4
101031010	Bed slide	H 4	104016000	Rubber plug for lifting shaft hole	D 9	411815150	Screw 15/64-28 L=15.0	C 2, C 4
201032000	Bed slide spring	H 4	204017000	Main shaft	D 7	411811050	Screw 1/64-40 L=5.0	D 5
201039000	Plug	C 2	104018000	Main shaft bushing, intermediate	C 5	411709110	Screw 9/64-40 L=10.5	G 1
204007000	Forked rod sleeve	B 6	204019000	Main shaft bushing, front	C 5	411408051	Screw 1/8-44 L=6.4	K 6
101085000	Lifting lever link pin	F 1	204119000	Counterweight	D 3	411862060	Screw 3/16-32 L=6.0	K 5
101090000	Tension releasing lever spring	G 4	204022000	Needle bar crank	E 3	411665110	Screw 1/4-40 L=11.0	D 9
201121001	Feed bar shaft	K 4	204023000	Counterweight wearing plate	E 3	411866090	Screw 1/4-40 L=8.5	E 12
201133000	Feed regulator hinge pin	D 10	204025000	Crank oil regulating felt	O 4	411762070	Screw 3/16-32 L=6.5	F 9, E 12
201134000	Reverse feed control lever	F 12	104504000	Upright shaft	E 11	411612120	Screw 3/16-28 L=12.0	F 9
201136000	Reverse feed control lever crank	G 9	204027000	Upright shaft bushing, upper	E 12	411711111	Screw 1/64-40 L=10.5	L 7
201139000	Suspension bracket	F 10	104505000	Upright shaft bushing, lower	G 12	411711070	Screw 1/64-40 L=7.0	E 1, E 4
201140000	Suspension hook	G 9	204029000	Pinion	D 11	411711060	Screw 1/64-40 L=8.5	A 10
			204030000	Gear	G 12	411711050	Screw 1/64-40 L=5.0	D 6
			204031000	Pinion	K 9	411815110	Screw 15/64-28 L=10.5	L 6
103001000	Throat plate	H 6	104032000	Needle bar bushing, upper	D 2	411768160	Screw 9/32-28 L=16.0	E 4
103002000	Face plate	H 2	204033000	Needle bar bushing, lower	F 3	411868190	Screw 9/32-28 L=19.0	C 3
103003000	Side plate	A 11	204034000	Needle bar crank connecting rod	F 3	411815030	Screw 15/64-28 L=3.4	G 2, C 2
101805000	Thread take-up lever cover	E 6	204035000	Presser spring	D 2	411608063	Screw 9/64-40 L=6.0	F 3
201095000	Three-hole thread eyelet	E 6	204036000	Presser spring regulator	C 2	201113000	Center screw	J 4, L 6
201096000	Hand Wheel	B 9	204037000	Presser guide bar	D 2	412102090	Hinge screw D=10.20 H=9.6	G 10
203018000	Oil seal ring	B 8	204038000	Presser bar	H 2	412095080	Hinge screw D=9.53 H=8.0	E 10
401147120	Thrust collar	C 6	204039000	Feed rock shaft	J 5	411711131	Screw 1/64-40 L=12.8	K 7
203024000	Gear	B 7	204040000	Feed rock shaft crank	J 7	411709070	Screw 9/64-40 L=6.8	G 9
203034000	Needle bar	E 2	104055000	Feed regulating screw	E 8	411611100	Screw 1/64-40 L=9.5	M 5
203038000	Needle bar connection	F 3	204045000	Tension spring	G 9	204150000	Thread take-up crank left screw	E 2
203039000	Needle bar connection guide block	F 3	204046000	Feed driving shaft	L 8	411708052	Screw 9/64-40 L=4.5	E 4
203040000	Needle bar thread guide	G 3	104506000	Hook driving shaft	K 8	411608150	Screw 9/64-40 L=15.0	K 5
203041000	Needle bar thread guide	F 3	204048000	Hook driving shaft bushing asm, front	K 6	411609240	Screw 9/64-40 L=23.5	L 8
203044000	Needle bearing	D 3, E 3	204051000	Lower shaft front screw	L 6	311615130	Screw 15/64-28 L=12.5	C 5
081008140	Needle (DBX # 14)	G 3	204052000	Oil felt	L 6	411966110	Screw 1/4-40 L=10.5	C 4
203048000	Presser bar bushing	Q 1	104507000	Lubricating hook	L 5	411611050	Screw SM4.46-40 L=4.7	L 5
103049000	Presser bar guide bracket	D 2	481079100	Hook driving shaft thrust collar (B)	K 8	411811040	Screw 1/64-40 L=3.5	K 5
103050000	Presser bar clamp thread guide	E 1	481079101	Hook driving shaft thrust collar	L 5	411811051	Screw 1/64-40 L=4.5	K 7
103051000	Presser bar lifting bracket	F 1	204511000	Thread take-up lever	C 3	411612100	Screw 3/16-40 L=10.5	J 8
103052000	Lifting lever link	F 1	204057000	Thread take-up crank	C 3	411615120	Screw 15/64-28 L=12.0	D 9
104110000	Hand lifter lever	F 4	204058000	Thread take-up crank shaft stud	D 3	411770100	Hand wheel end screw	B 9
103054000	Hand lifter cam	F 4	104659000	Thread tension post socket	G 6	411708052	Screw 1/8-44 L=4.9	G 4
103055000	Hinged presser foot	G 1	479200000	Oil tube connecting screw	E 8	411711080	Screw 1/64-40 L=8.0	C 7
103056000	Feed dog	K 6	204061001	Main shaft oil tube	E 8	513403100	Screw M3x0.5 L=10	G 8
203059000	Plunger	C 10	204062000	Plunger spring	B 6	416430100	Screw 3-24 L=10	O 9
203060000	Feed regulator connecting link hinge pin	E 10	204063000	Spring	K 7			
204011000	Feed regulator connecting link	D 10	204109000	Lubricating oil pump	J 8			
203062000	Feed regulator	D 9	204110000	Lubricating oil pump cover	H 10	421668040	Nut 9/32-28	D 10, G 10
203063000	Stitch dial asm.	F 8	204113000	Lubricating oil pump lifter screen	J 10	421606031	Nut 3/32-56	F 5
201064000	Bobbin case holder positioning finger	L 5	204068001	Lubricating oil pump impeller	J 8	421674050	Nut 3/8-28	K 4, M 6
201144000	Bobbin case	L 4	204070000	Main shaft oil tube clamp screw	G 8	421615030	Nut 15/64-28	G 8, H 9
203035000	Bobbin	L 5	204072000	Oil adjusting screw	L 6	422603020	Nut M3x0.5	J 8
203079000	Thread tension post	F 7	204115000	Hook driving shaft oil tube asm.	J 7			
203080000	Thread tension nut	G 7	104115000	Main shaft bushing(B), rear	C 5			
201157000	Thread disc rotation stopper	H 7	104117000	Reverse feed control lever shaft	C 6	443105200	Wavy washer 10.5x14.5x0.3	F 12
203082000	Thread tension spring	G 7	104118000	Hook driving shaft bushing, rear	E 8	444032050	Washer 4.2x6.6x0.8	E 4
203083000	Thread tension disc presser	F 7	204024000	Crank oil adjusting pin asm	D 8			
203084000	Tension release pin	G 6	104075000	Plunger thrust plate	B 8			
103085000	Tension releasing lever	G 4	204076000	Lubricating pump plunger	E 10	434020100	Cotter pin	A 7
103086000	Tension releasing lever guide	F 4	204077000	Oil tube connecting screw gasket	K 8	461202000	Oil wick	F 4
103087000	Tension releasing lever hinge screw	G 4	204069000	Oil sil sight window	D 4	461200000	Oil wick	C 2, D 3
103088000	Knee lifter lifting shaft crank	A 7	204138000	Hook driving shaft oil tube joint	H 8			
103089000	Knee lifter lifting shaft	B 5	204012000	Feed driving shaft connecting rod	D 11			
103090000	Lifting lever connecting rod	B 7	204111000	Pump installing plate	H 8	451044240	O-ring 4.4x9.2x2.4	E 4
212207000	Oil return tube holder	E 5	204114000	Pump impeller support plate	H 9	451294310	O-ring 29.4x35.6x3.1	A 8
203095000	Oil return felt asm	G 5	211607000	Oil wick retainer	F 4	451061180	O-ring 6.07x9.63x1.78	F 10
			104201010	Feed driving eccentric cam	C 7	451069180	O-ring 6.9x10.46x1.78	E 11
			104202000	Feed eccentric cam	C 7	451074240	O-ring 7.4x12.2x2.4	F 8
			104203015	Feed bar	K 5	451133170	O-ring 13.3x16.7x1.7	F 6
204001000	Bed screw stud(A)	J 4	104206000	Feed rocker shaft crank	L 6	451048190	O-ring 4.8x8.6x1.9	F 4
204002000	Bed screw stud(B)	H 3						
204003000	Bed support	G 9	411709140	Screw 9/64-40 L=13.5	J 2, L 2	471300000	Vinyl tube	E 6
204004000	Feed rock shaft support block	L 5	411205070	Screw 9/64-40 L=5.7	G 8			
204005000	Feed driving shaft support block	M 7	411612101	Screw 3/16-28 L=9.5	G 8			
436075070	Rubber plug	D 5, D 8	411506060	Screw 9/64-40 L=6.0	F 6			
			411808060	Screw 9/64-40 L=5.5	G 6			
104007000	Side plate gasket	H 2	411815070	Screw 15/64-28 L=7.0	F 6, B 7			
104008000	Face plate gasket	H 2						
204009000	Frame thread guide(A)	F 6						

SUBCLASS MACHINES

EXCLUSIVE PARTS FOR HEAVY MATERIAL (MODEL)

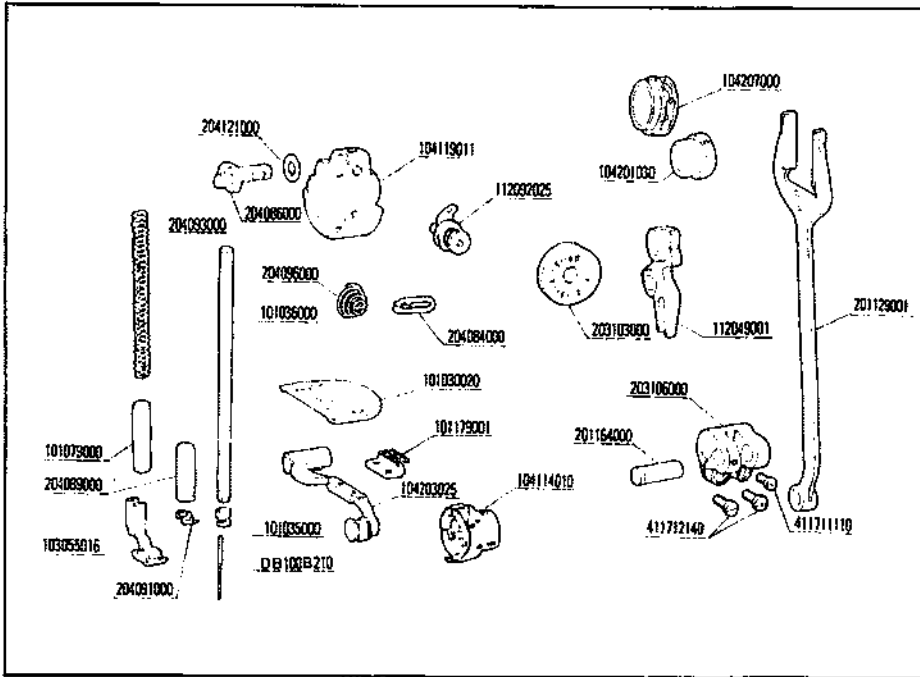

Part No.	Description	Amt. Req.
101035000	Needle bar thread guide	1
101036000	Needle bar	1
101079000	Presser bar bushing	1
201129001	Pitman	1
201164000	Pitman hinge stud	1
101179000	Feed dog	1
103055016	Hinged presser foot	1
203106000	Feed rock shaft crank	1
204084000	Frame thread guide (A)	1
204089000	Needle bar bushing, lower	1
204091000	Needle bar thread guide	1
DB 100B 210	Needle (DB x 1 - 21)	1
204093000	Presser spring	1
204095000	Thread tension spring	1
104114010	Lubricating hook	1
101030020	Throat plate	1
204086000	Needle bar Crank	1
104119011	Counter weight	1
204121000	Counter weight wearing plate	1
104201030	Feed driving eccentric cam	1
104203035	Feed bar	1
203103000	Stitch dial	1
112049001	Feed regulator	1
112092025	First thread tension post	1
411712140	Screw 3 16-28 L=14.0	2
411711110	Screw 11 64-40 L=10.5	1
104207000	Screw 1 4 -40 L= 4.5	1
104207000	Forked rod sleeve	1

EXCLUSIVE PARTS FOR LIGHT MATERIAL (MODEL)

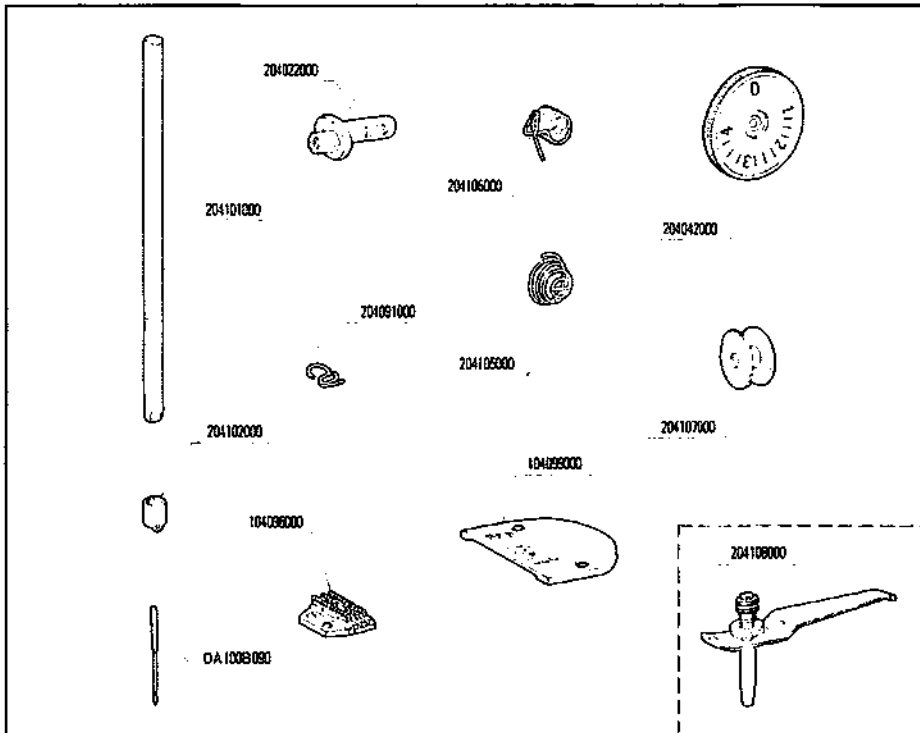

Part No.	Description	Amt. Req.
204091000	Needle bar thread guide	1
104096000	Feed	1
104099000	Throat plate	1
204022000	Needle bar crank	1
204101000	Needle bar	1
204102000	Needle bar thread guide	1
DA100B 090	Needle 88 x 1 (DA x 1) #9	1
204042000	Stitch dial asm.	1
204105000	Tension spring	1
204106000	Take-up spring	1
204107000	Bobbin	1
204108000	Thread guide pin asm.	1