

TOYOTA D324

Model
(120)

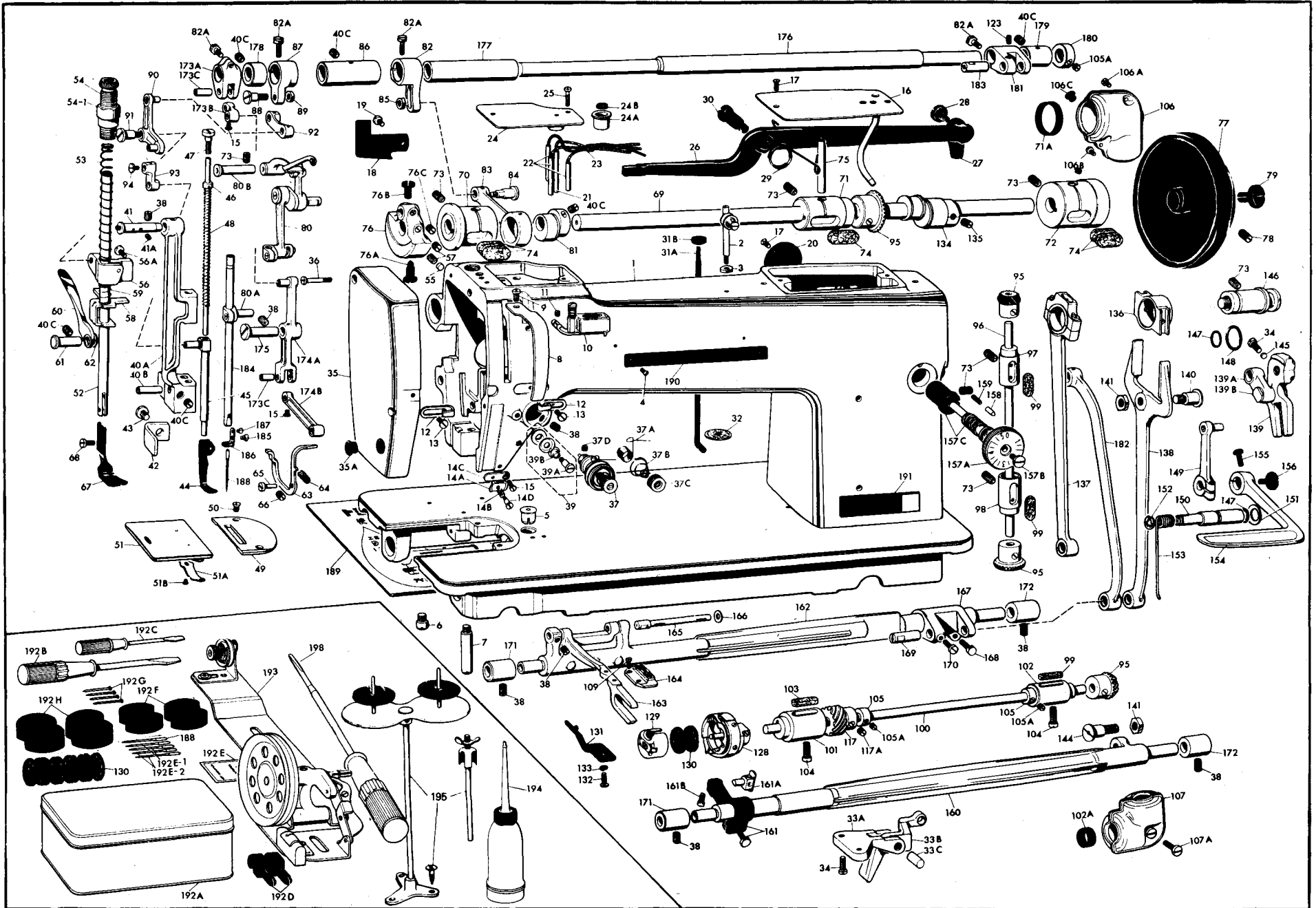

TOYOTA D324

| IDEN NO. | PARTS NO. | PARTS NAME | IDEN NO. | PARTS NO. | PARTS NAME | IDEN NO. | PARTS NO. | PARTS NAME | IDEN NO. | PARTS NO. | PARTS NAME |
|----------|---------------|---|----------|---------------|------------------------------------|----------|---------------|-----------------------------------|----------|---------------|--------------------------------|
| 1 | 2120311-100-R | ARM BED ASSEMBLY | 40B | 2120305-435 | RETAINER PIN FOR 40A | 84 | 9015500-060-A | PIBOT SCREW FOR 83 | 156 | 9541208-107 | CAP SCREW FOR 154 |
| 2 | 2110202-310 | SPOOL PIN COMPLETE | 40C | 9501509-276 | SET SCREW FOR 40B | 85 | 9440124-119 | NUT FOR 84 | 157 | 2120315-032-C | FEED REGULATOR DIAL COMPLETE |
| 3 | 2110602-319 | NUT FOR 2 | 41 | 2110602-214 | HINGE PIN FOR 38 | 86 | 2120305-423-A | METAL FOR UPPER FEED SHAFT | 157A | 2110815-350-B | FEED REGULATOR DIAL |
| 4 | 9540805-102 | SCREW FOR 190 | 41A | 9500802-276 | SET SCREW FOR WICK | 87 | 2120305-420-B | UPPER FEED LINK UPPER | 157B | 9541203-247 | SET SCREW FOR 157A |
| 5 | 2110401-204-B | OIL CAP (COMPLETE) | 42 | 2120302-512-A | GUIDE PLATE FOR 38 | 88 | 9015500-055-A | PIVOT SCREW FOR 87 | 157C | 2110305-305 | FEED REGULATOR BUSHING |
| 6 | 2210101-153-A | BED LEG REAR | 43 | 9541501-119 | SET SCREW FOR 42 | 89 | 9410151-219 | UNIT FOR 88 | 158 | 2110305-353-B | STOP PIN FOR 157A |
| 7 | 2110401-153-B | BED LEG FRONT | 44 | 2120303-260-A | WALKING FOOT | 90 | 2120305-401-A | LINK FOR 93 | 159 | 2110105-354-A | SPRING FOR 158 |
| 8 | 2120301-241 | GUARD FOR TAKE UP LEVER | 45 | 2120303-262 | WALKING FOOT BAR | 91 | 9015500-056 | PIVOT SCREW FOR 90 | 160 | 2120305-251 | FEED LIFTING SHAFT |
| 9 | 9541104-259 | SCREW FOR 8 | 46 | 2120303-280 | GUIDE BAR FOR 48 | 92 | 2120305-415-C | UPPER FEED LINK UPPER | 161 | 2110305-260-B | FEED LIFTING BELL ARM |
| 10 | 0252011-110-A | LUBRICATING DEVICE FOR UPPER THREAD | 47 | 9531503-259 | ADJUSTING SCREW FOR 48 | 93 | 2120305-416-A | LOWER FEED LINK LOWER | 161A | 2110205-204 | SLIDING BLOCK |
| 11 | 9501102-256 | SCREW FOR THREAD GUIDE WITH THREE HOLES | 48 | 2120303-263 | WALKING FOOT BAR SPRING | 94 | 9540804-276 | SET SCREW FOR 93 | 161B | 9541207-279 | SET SCREW FOR 161 |
| 12 | 2110602-313-B | THREAD GUIDE | 49 | 2120303-113-D | NEEDLE PLATE | 95 | 2120304-101 | GEAR COMPLETE | 162 | 2120305-271-A | FEED ROCK SHAFT |
| 13 | 9540901-101 | SET SCREW FOR 12 | 50 | 9561103-261 | SET SCREW FOR 49 | 96 | 2120304-241 | VERTICAL SHAFT ONLY | 163 | 2120305-221-B | FEED BAR |
| 14 | 2120312-350 | TENSION (COMPLETE) | 51 | 2110213-120-A | SLIDE PLATE COMPLETE | 97 | 2120304-242-A | VERTICAL SHAFT UPPER BUSHING | 164 | 2120305-223-B | FEED DOG |
| 14A | 2120302-352 | TENSION DISC | 51A | 1110301-522 | SLIDE PLATE SPRING | 98 | 2120304-243-B | VERTICAL SHAFT LOWER BUSHING | 165 | 2110205-225-D | FEED BAR SHAFT |
| 14B | 2120302-355 | TENSION SPRING | 51B | 9540601-103 | SET SCREW FOR 51A | 99 | 2110406-367 | FELL FOR 97, 98 | 166 | 9030100-036 | THRUST WASHER FOR 165 |
| 14C | 2120302-365 | TENSION PLATE | 52 | 2120303-211-A | PRESSER BAR | 100 | 2120304-211 | HOOK SHAFT ONLY | 167 | 2120305-281 | FEED ROCK ARM |
| 14D | 9015500-059 | TENSION ADJUSTING SCREW | 53 | 2110403-213-A | PRESSER SPRING | 101 | 2120304-212-B | HOOK SHAFT FRONT BUSHING COMPLETE | 168 | 9531102-256 | SET SCREW FOR 167 |
| 15 | 9540905-319 | SET SCREW FOR 14C | 54 | 2110403-271-A | PRESSURE REGULATOR SCREW | 102 | 2120304-202 | HOOK SHAFT REAR BUSHING COMPLETE | 169 | 2120305-282-A | HINGED PIN FOR 167 |
| 16 | 2110411-210-A | TOP COVER PLATE | 54-1 | 2130103-274 | PRESSURE REGULATOR NUT | 102A | 2110404-272 | PACKING FOR 107 | 170 | 9531102-256 | SET SCREW FOR 169 |
| 17 | 9560904-307 | SCREW FOR 16 | 55 | 2120303-273 | PLUG FOR 57 | 103 | 2110416-364 | FELT FOR 101 | 171 | 2110205-231 | FRONT BUSHING FOR 162 |
| 18 | 2120301-263 | COVER PLATE | 56 | 2120303-230-A | PRESSER BAR GUIDE BRACKET COMPLETE | 104 | 9531501-256 | SET SCREW FOR 101, 102 | 172 | 2110205-232 | REAR BUSHING FOR 162 |
| 19 | 9540916-119 | SET SCREW FOR 18 | 56A | 9531202-119 | SET SCREW FOR 56 | 105 | 2210204-240 | HOOK SHAFT COLLAR COMPLETE | 173 | 2120305-430-A | NEEDLE FEED ARM FRONT COMPLETE |
| 20 | 2110201-251 | BACK COVER PLATE | 57 | 9501801-276 | ADJUSTING SCREW FOR 55 | 106 | 2110404-205-J | UPPER GEAR CASE COMPLETE | 173A | 2120305-431-A | NEEDLE FEED ARM FRONT |
| 21 | 2120306-385 | OIL TUBE FOR 80 | 58 | 2120303-242-C | KNEE LIFTER PLATE | 105A | 9501102-256 | SET SCREW FOR 105 | 173B | 2120305-432 | UPPER LINK |
| 22 | 2110106-384-D | GUIDE TUBE | 59 | 2110403-216-A | SPRING FOR 58 | 106 | 2110404-205-J | UPPER GEAR CASE COMPLETE | 173C | 2120305-433 | HINGE PIN FOR 173B |
| 23 | 2120306-311 | OIL WICK | 60 | 2110103-351-B | KNEE LIFTER | 106A | 9530901-116 | SET SCREW FOR 106 | 174 | 2120305-400-C | CONNECTING ROD COMPLETE |
| 24 | 2110401-260-A | COVER PLATE FOR OIL WELL | 61 | 1110102-367-C | KNEE LIFTER PIN | 106B | 9540908-279 | SET SCREW FOR 106 | 174A | 2120305-440-C | CONNECTING ROD |
| 24A | 2110406-172-A | OIL WELL | 62 | 9030100-039 | WASHER FOR 60 | 106C | 2110201-254 | PLUG FOR 106 | 174B | 2120305-434-A | LOWER LINK |
| 24B | 2110406-361 | FELT IN OIL WELL | 63 | 2120303-411-A | THREAD TENSION RELEASE | 107 | 2110404-206-C | LOWER GEAR CASE COMPLETE | 175 | 2120305-441 | NEEDLE FEED CONNECTING ROD |
| 25 | 9540907-207 | SET SCREW FOR 24 | 64 | 2120302-393 | SPRING FOR 63 | 107A | 9541206-102 | SET SCREW FOR 107 | 176 | 2120305-451-A | NEEDLE FEED SHAFT |
| 26 | 2120303-311-A | KNEE LIFTER LEVER | 65 | 2110203-413-B | SHAFT FOR 63 | 109 | 9530801-279 | SET SCREW FOR 164 | 177 | 2120305-422 | UPPER FEED SHAFT |
| 27 | 2110103-313 | KNEE LIFTER LINK | 66 | 9540905-319 | SET SCREW FOR 65 | 128 | 2120304-310-A | ROTATING HOOK ASSEMBLY | 178 | 2120305-452 | FRONT BUSHING FOR 176 |
| 28 | 9015500-029-B | LINK SCREW FOR 27 | 67 | 2120303-264-A | PRESSER FOOT | 129 | 2120304-301 | BOBBIN CASE ASSEMBLY | 179 | 2120305-454 | REAR BUSHING FOR 176 |
| 29 | 2120303-333 | SPRING FOR 26 | 68 | 9540903-241 | SET SCREW FOR 67 | 130 | 2120314-321 | BOBBIN | 180 | 2120305-405-A | COLLAR FOR 79 |
| 30 | 9015500-038-B | HINGE SCREW FOR 26 | 69 | 2110404-111-B | TOP SHAFT | 131 | 2110204-315-E | HOOK RETAINER | 181 | 2120305-436 | NEEDLE FEED ROCK ARM |
| 31 | 2120303-320 | KNEE LIFTER PULL ROD COMPLETE | 70 | 2110804-112-B | TOP SHAFT FRONT BUSHING COMPLETE | 132 | 9531104-267 | SET SCREW FOR 131 | 182 | 2120305-442 | NEEDLE FEED ROD |
| 31A | 2120303-321 | KNEE LIFTER PULL ROD | 71 | 2110804-103-A | TOP SHAFT CENTER BUSHING COMPLETE | 133 | 9130500-318 | SPRING WASHER FOR 132 | 183 | 2110205-282 | HINGED PIN FOR 167 |
| 31B | 9440124-107 | NUT FOR 31A | 71A | 2110404-271 | PACKING FOR 106 | 134 | 2120305-111-B | FEED CAM | 184 | 2120302-111-B | NEEDLE BAR ONLY |
| 32 | 1210102-187-A | FELT WASHER FOR 31A | 72 | 2110804-114-A | TOP SHAFT REAR BUSHING COMPLETE | 135 | 9501508-276 | SET SCREW FOR 134 | 185 | 9540809-259 | SET SCREW FOR 188 |
| 33 | 2120303-330-B | KNEE LIFTER RELEASE LEVER | 73 | 9015600-006 | SET SCREW FOR 72 | 136 | 2120305-112-A | GUIDE FOR FEED FORK | 186 | 2120312-116-B | THREAD GUIDE FOR 188 |
| 33A | 2110403-331-A | BRACKET FOR 33B | 74 | 2110406-364 | FELT FOR 72 | 137 | 2110305-160-A | CRANK ROD COMPLETE | 187 | 9530601-104 | SET SCREW FOR 186 |
| 33B | 2120303-332-B | KNEE LIFTER RELEASE LEVER | 75 | 2110106-384 | OIL PIPE LARGE | 138 | 2120305-141 | FEED FORK | 188 | 2120302-189 | NEEDLE # 23 |
| 33C | 2110403-334-A | KNEE LIFTER JOINT | 76 | 2120312-130 | TAKE UP LEVER CRANK COMPLETE | 139 | 2120305-310-D | FEED REGULATOR COMPLETE | 190 | 2110949-215 | NAME PLATE |
| 34 | 9541201-256 | SET SCREW FOR 33A | 76A | 9013400-013 | SET SCREW FOR 76 | 139A | 2110305-319-A | FEED REGULATOR LINK | 191 | 2120309-411-C | MODEL NUMBER PLATE |
| 35 | 2120301-230-D | FACE COVER PLATE | 76B | 9541604-256 | CLAMP SCREW FOR 80 | 139B | 2110305-313 | CAP SCREW FOR 139A | 192 | 0203171-110 | ACCESSORY BOX (COMPLETE) |
| 35A | 2120201-234 | PLUG FOR 35 | 76C | 9501604-256 | SET SCREW FOR 80 | 140 | 9013300-005 | SET SCREW FOR 138 | 192A | 0102681-111-E | ACCESSORY BOX |
| 36 | 9540920-207 | SET SCREW FOR 35 | 77 | 2120304-151-A | HAND WHEEL | 141 | 9410182-204 | NUT FOR 138 | 192B | 0103083-111 | DRIVER LARGE |
| 37 | 2110912-350-A | TENSION COMPLETE | 78 | 9501503-276 | SET SCREW FOR 77 | 144 | 9015500-036-A | PIVOT SCREW FOR 160 | 192C | 0103083-111 | DRIVER SMALL |
| 37A | 2110202-354-B | CHECK SPRING | 79 | 2110604-152 | CAP SCREW FOR 77 | 145 | 2110105-325 | METAL PAD | 192D | 0201385-173-A | HINGE SHEET |
| 37B | 2110402-355 | TENSION SPRING | 80 | 2120302-021-C | TAKE UP LEVER COMPLETE | 146 | 2110305-320-A | FULCRUM SHAFT COMPLETE | 192E | 2120312-190 | NEEDLE |
| 37C | 2110202-359 | TENSION ADJUSTING KNOB | 80A | 2120302-101-A | NEEDLE BAR BRACKET | 147 | 9060100-007 | WASHER FOR 146 | 192E-1 | 2120302-197 | NEEDLE # 21 |
| 37D | 2110202-358 | SET SCREW | 80B | 2110202-214 | HINGE STUD FOR 80 | 148 | 9060100-008 | WASHER FOR 146 | 192E-1 | 2120302-198 | NEEDLE # 22 |
| 38 | 9501508-276 | SET SCREW FOR 37 | 81 | 2120305-410 | FEED CAM | 149 | 2110605-330-A | FEED REGULATOR ARM | 193 | 2110202-410-C | BOBBIN WINDER |
| 39 | 2120302-350 | TENSION COMPLETE | 82 | 2120305-406-A | UPPER FEED BAR REAR COMPLETE | 150 | 2110605-335-A | REGULATOR SHAFT | 194 | 0202012-105 | OILER |
| 39A | 9015500-054 | ADJUSTING SCREW | 82A | 9581201-456 | SET SCREW FOR 82 | 151 | 9030400-001 | WASHER FOR 150 | 195 | 0201106-130 | SPOOL HOLDER |
| 39B | 2110212-355 | TENSION SPRING | 83 | 2120305-412 | UPPER FEED CONNECTING ROD | 152 | 9080200-001 | STOP RING FOR 150 | 198 | 0201013-111-C | DRIVER LARGE |
| 40 | 2120302-510-B | NEEDLE BAR (COMPLETE) | | | | 153 | 2110605-338-A | SPRING FOR 150 | | | |
| 40A | 2120302-511-B | NEEDLE BAR ARM | | | | 154 | 2110905-334-C | REVERSE LEVER | | | |
| | | | | | | 155 | 9541220-107 | SET SCREW FOR 154 | | | |