

CONSEW

PARTS FOR MODEL 218

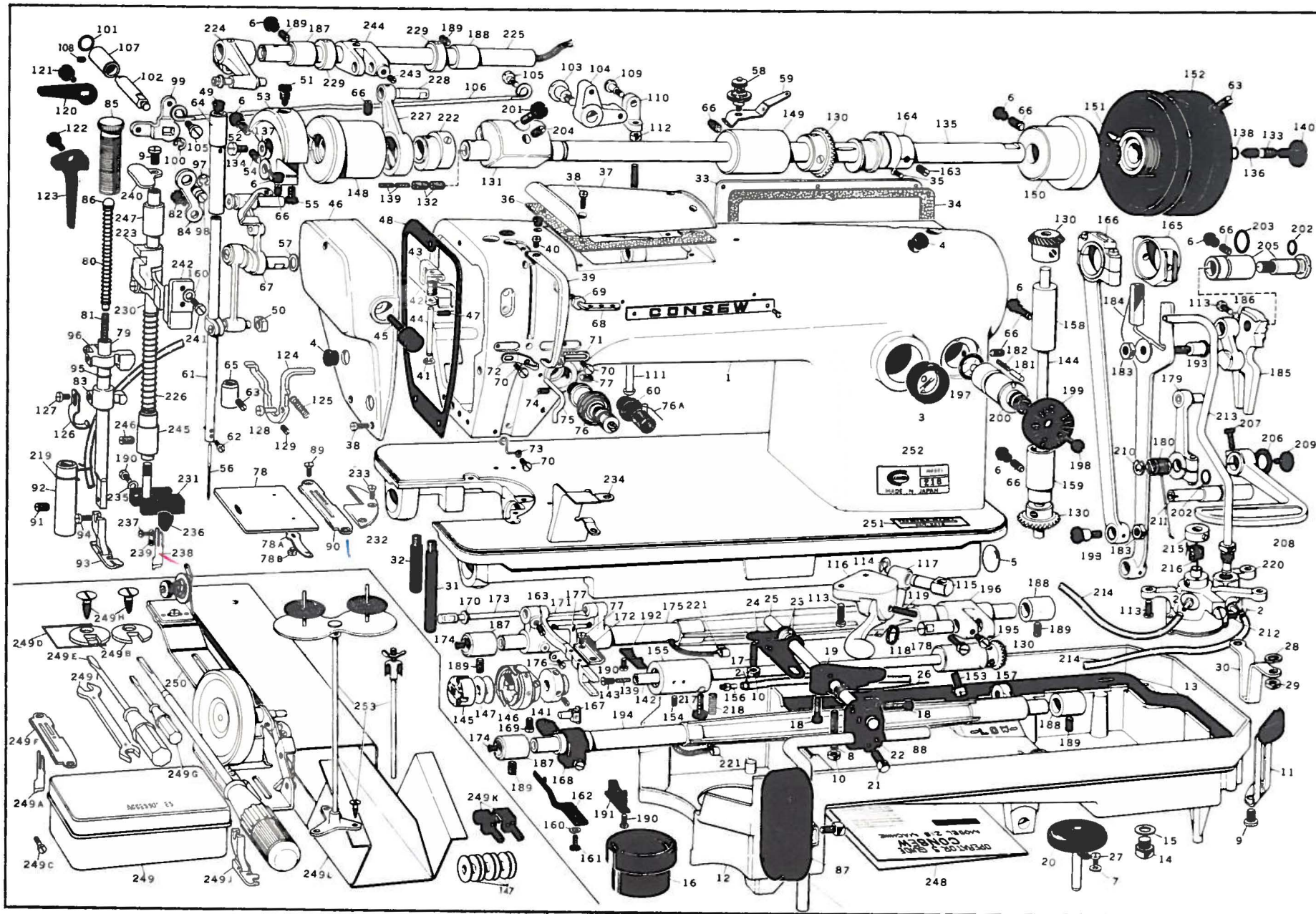

Order parts by both reference and part number.

From the library of: Superior Sewing Machine & Supply LLC

PART NO.	PART NAME	PART NO.	PART NAME	PART NO.	PART NAME	PART NO.	PART NAME
1	ARM BED ASSEMBLY	61	NEEDLE BAR ONLY	117	KNEE LIFTER RELEASE LEVER	176	SET SCREW FOR 177
2	OIL HOSE CLIP	62	SET SCREW FOR 56	118	SPRING FOR 117	177	OIL WICK RETAINER
3	OIL GAUGE WINDOW	63	SET SCREW FOR 65	119	HINGE SHAFT FOR 117	178	HINGED PIN FOR 196
4	RUBBER PLUG	64	NEEDLE BAR UPPER BUSHING	120	PRESSER BAR LIFTER CRANK ARM	179	FEED REGULATOR ARM
5	PLUG FOR BED HOLE	65	NEEDLE BAR LOWER BUSHING	121	CAP SCREW FOR 120	180	SPRING FOR 179
6	PLUG FOR SCREW HOLE	66	SET SCREW FOR 67, ETC.	122	HINGE SCREW FOR 123	181	STOP PIN FOR 199
7	WASHER FOR 27	67	TAKE UP LEVER COMPLETE	123	PRESSER BAR LIFTER LEVER	182	SPRING FOR 181
8	ADJUST SCREW FOR 19	68	THREAD GUIDE WITH THREE HOLES	124	THREAD TENTION RELEASE	183	NUT FOR 193
9	SET SCREW FOR 11	69	NUT FOR 68	125	SPRING FOR 124	184	FEED FORK
10	NUT FOR 8 & 17	70	SET SCREW FOR 71, 72 & 73	126	ADJUST PLATE FOR TENTION RELEASE	185	FEED REGULATOR BODY COMPLETE
11	OIL PAN SUPPORT COMPLETE	71	THREAD GUIDE RIGHT	127	SET SCREW FOR 126	186	SOFT PLUG FOR 185
12	OIL PAN	72	THREAD GUIDE LEFT	128	SHAFT FOR 124	187	FRONT BUSHING FOR 175, 194, ETC.
13	OIL PAN PACKING	73	THREAD GUIDE LOWER	129	SET SCREW FOR 128	188	REAR BUSHING FOR 175, 194, ETC.
14	DRAIN SCREW	74	SET SCREW FOR 75	130	GEAR COMPLETE	189	SET SCREW FOR 187 & 188
15	PACKING FOR 14	75	THREAD GUIDE CENTER	131	BALANCE WEIGHT	190	SET SCREW FOR 191 & 192
16	GUIDE PIPE	76	TENTION COMPLETE	132	ADJUST SCREW FOR 139	191	OIL STOPPER FOR 194
17	ADJUST SCREW FOR 24	76-A	CHECK SPRING	133	SET SCREW FOR 136	192	OIL STOPPER FOR 175
18	CAP SCREW FOR 19 & 22	77	SET SCREW FOR 76	134	OIL STOP SCREW FOR 135	193	JOINT SCREW FOR 166
19	KNEE LIFTER LOWER LEVER	78	SLIDE PLATE COMPLETE	135	TOP SHAFT ONLY	194	FEED LIFTING SHAFT ONLY
20	KNEE LIFTER PLUNGER	78-A	SET SCREW FOR 78-B	136	TOP SHAFT OIL STOPPER REAR	195	SET SCREW FOR 178
21	SET SCREW FOR 88	78-B	SPRING FOR 78	137	PACKING FOR 134	196	FEED ROCK ARM
22	KNEE LIFTER ARM JOINT	79	PRESSER BAR ONLY	138	WASHER FOR 136	197	OIL SEAL OUTER FOR 200
23	WASHER FOR 24	80	PRESSER SPRING OUTER	139	OIL FELT FOR 135 & 142	198	LOCK SCREW FOR 199
24	KNEE LIFTER CONTROLLER	81	PRESSER SPRING INNER	140	CAP SCREW FOR 152	199	FEED REGULATOR DIAL
25	KNEE LIFTER SHAFT	82	HINGE SCREW FOR 84	141	OIL DEFLECTOR FOR 155	200	FEED REGULATOR BUSHING COMPLETE
26	SPRING FOR 19	83	PRESSER BAR LIFTER	142	HOOK SHAFT ONLY	201	CAP SCREW FOR 131
27	SET SCREW FOR 20	84	KNEE LIFTER PLATE	143	SET SCREW FOR 139	202	OIL SEAL INNER FOR 205 & 211
28	WASHER FOR 30	85	PRESSER REGULATOR SCREW	144	VERTICAL SHAFT ONLY	203	OIL SEAL OUTER FOR 205
29	NUT FOR 30	86	PRESSER REGULATOR ROD	145	BOBBIN CASE COMPLETE	204	SET SCREW FOR 131
30	BED LEG RIGHT	87	KNEE LIFTER PAD COMPLETE	146	ROTATING HOOK ASSEMBLY	205	FULCRUM SHAFT AND BUSHING FOR 185
31	BED LEG FRONT	88	KNEE LIFTER ARM	147	BOBBIN	206	WASHER FOR 208
32	BED LEG REAR	89	SET SCREW FOR 90	148	TOP SHAFT FRONT BUSHING	207	CAP SCREW FOR 208
33	SIDE COVER PLATE	90	NEEDLE PLATE WITH CHIP 1/8"	149	TOP SHAFT CENTER BUSHING	208	FEED REGULATOR HAND LEVER
34	PACKING FOR 33	91	SET SCREW FOR 92	150	TOP SHAFT REAR BUSHING	209	CAP SCREW FOR 208
35	SET SCREW FOR 33	92	BUSHING FOR 79	151	PACKING FOR 152	210	STOP RING FOR 180
36	PACKING FOR 37	93	HINGED FOOT COMPLETE 1/8"	152	HAND WHEEL	211	REGULATOR SHAFT
37	TOP COVER PLATE	94	SET SCREW FOR 93	153	SET SCREW FOR 157	212	MAGNET
38	SET SCREW FOR 37	95	RUBBER RING FOR 96	154	SET SCREW FOR 155	213	OIL FEED TUBE COMPLETE
39	GUARD FOR TAKE UP LEVER	96	PRESSER BAR GUIDE BRACKET COMPLETE	155	HOOK SHAFT FRONT BUSHING	214	OIL HOSE
40	SET SCREW FOR 39	97	STOP RING FOR 84	156	OIL HOSE NIPPLE	215	COLLAR COMPLETE FOR 216
41	STOP RING FOR 44	98	KNEE LIFTER BELL CRANK PIN	157	HOOK SHAFT REAR BUSHING	216	SPRING JOINT
42	SPRING FOR 43	99	KNEE LIFTER BELL CRANK LEFT	158	VERTICAL SHAFT UPPER BUSHING	217	OIL REGULATING SCREW
43	DRIVING ARM	100	STOP RING FOR 102	159	VERTICAL SHAFT LOWER BUSHING	218	SPRING FOR 217
44	DRIVING ARM SHAFT	101	RUBBER RING FOR 107	160	SPRING WASHER FOR 161	219	HOSE RETAINER
45	PUSH BUTTON	102	KNEE LIFTER BELL CRANK SHAFT	161	SET SCREW FOR 162	220	OIL PUMP COMPLETE
46	FACE PLATE	103	HINGE SCREW FOR 104	162	HOOK RETAINER	221	OIL WICK CLAMP
47	SET SCREW FOR 44	104	KNEE LIFTER BELL CRANK RIGHT	163	SET SCREW FOR 164	222	CUTTER DRIVE CAM
48	PACKING FOR 46	105	JOINT SCREW FOR 106	164	FEED CAM	223	CUTTER GUIDE BRACKET
49	RUBBER CAP FOR 64	106	KNEE LIFTER ROD	165	GUIDE FOR FEED FORK	224	CUTTER DRIVE BELL ARM
50	SLIDING BLOCK FOR 67	107	BUSHING FOR 102	166	CRANK ROD COMPLETE	225	CUTTER DRIVE SHAFT
51	SET SCREW FOR 53	108	SET SCREW FOR 107	167	SLIDING BLOCK FOR 168	226	CUTTER BAR SPRING
52	CAP SCREW FOR 53	109	HINGED SCREW FOR 110	168	FEED LIFTER BELL ARM	227	CUTTER CRANK ROD
53	TAKE UP LEVER CRANK	110	KNEE LIFTER BELL CRANK LINK	169	SET SCREW FOR 167	228	CUTTER CRANK ROD PIN
54	SET SCREW FOR 67	111	KNEE LIFTER PULL ROD	170	WASHER FOR 173	229	COLLAR FOR 225
55	CLAMP SCREW FOR 67	112	NUT FOR 111	171	FEED BAR	230	CUTTER BAR
56	NEEDLE No. 14	113	SET SCREW FOR 116 & 185	172	FEED DOG	231	CUTTER BAR ARM
57	WASHER FOR 67	114	STOP RING FOR 115	173	FEED BAR SHAFT		
58	SUB TENTION COMPLETE	115	JOINT FOR 111	174	PLUG FOR 175 & 194		
59	THREAD GUIDE PLATE	116	BRACKET FOR 117	175	FEED ROCK SHAFT ONLY		
60	PACKING FOR 76						
						232	SUB NEEDLE PLATE
						233	SET SCREW FOR 232
						234	HOOK SUPPORT
						235	WASHER FOR 236
						236	KNIFE HOLDER
						237	SET SCREW FOR 238
						238	TOP KNIFE
						239	WASHER FOR 238
						240	CUTTER HAND LEVER
						241	SET SCREW FOR 242
						242	GUIDE FOR 223
						243	SET SCREW FOR 228
						244	CUTTER DRIVE ARM
						245	CUTTER BAR LOWER BUSHING
						246	SET SCREW FOR 245
						247	CUTTER BAR UPPER BUSHING
						248	OPERATORS GUIDE BOOK
						249	ACCESSORY BOX
						249-A	TOP KNIFE
						249-B	HINGE SEAT
						249-C	ADJUST SCREW FOR 238
						249-D	NEEDLES
						249-E	SCREW DRIVER LARGE
						249-F	NEEDLE PLATE WITH CHIP 3/16"
						249-G	SCREW DRIVER SMALL
						249-H	CAP SCREW FOR 249-B
						249-I	WRENCH
						249-J	HINGED FOOT COMPLETE 3/16"
						249-K	BED HINGE
						249-L	WASTE CHUTE
						250	BOBBIN WINDER
						251	NEEDLE SIZE PLATE
						252	MODEL PLATE
						253	COTTON STAND