

# CONSEW MODEL 345

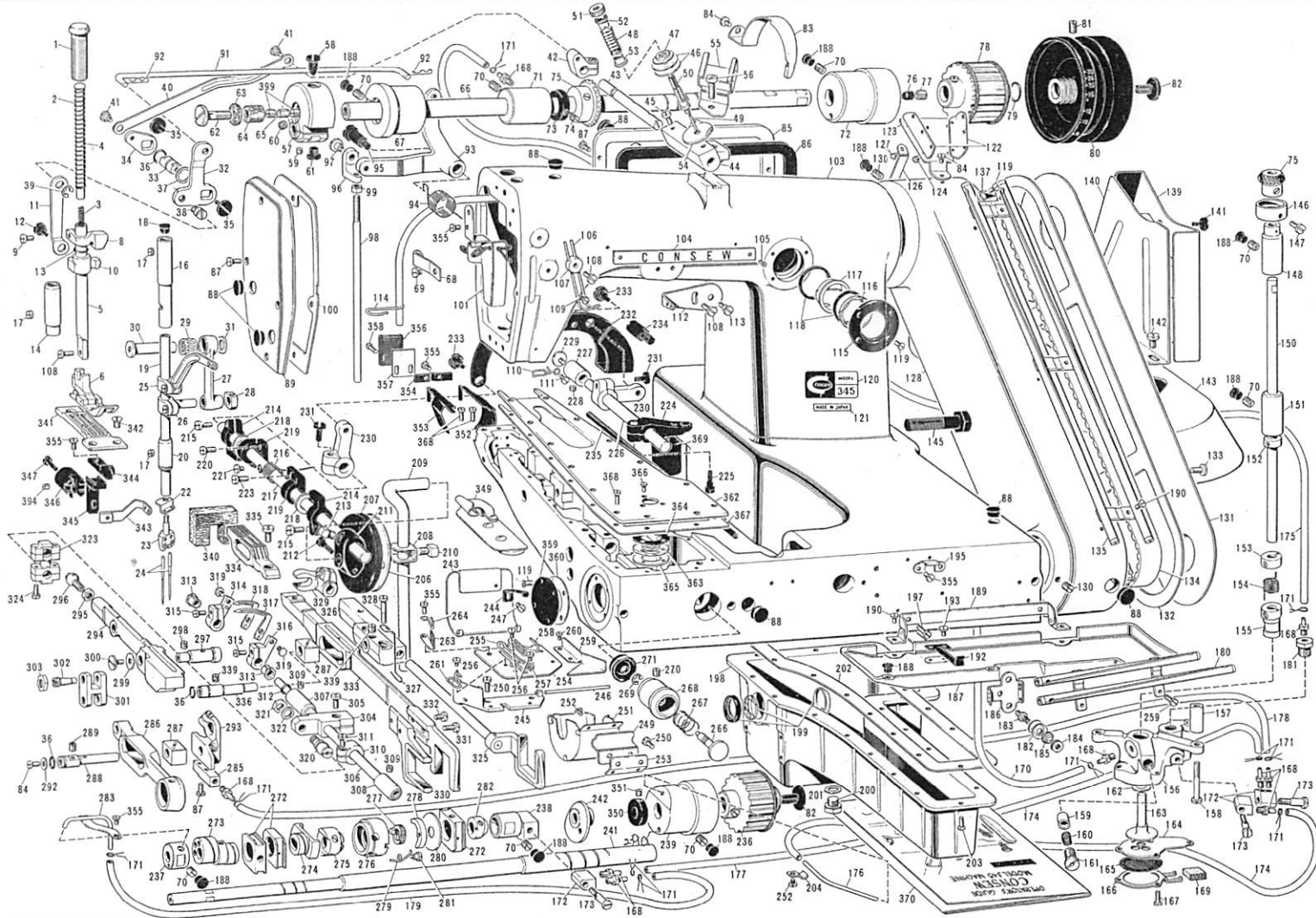

1/4" GAUGE MACHINE

3/16"

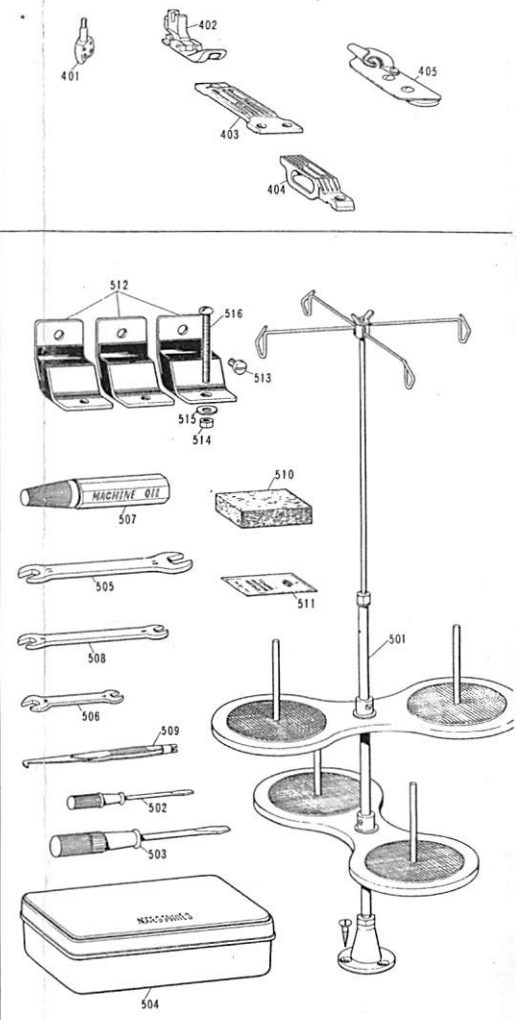

# CONSEW MODEL 345

ART NO.	PART NAME	PART NO.	PART NAME	PART NO.	PART NAME	PART NO.	PART NAME	PART NO.	PART NAME	
2110203-271-A	PRESSURE REGULATOR SCREW	83	2110201-218	OIL GUIDE PLATE	169	2110206-116-B	MAGNET	253	2110202-254	SUPPORT FOR 251
2110203-272-A	PRESSURE REGULATOR ROD	84	9549067-207	SET SCREW FOR 83, 123, ETC	170	2110206-425	OIL RETURN HOSE	254	2110202-252	THREAD (LOOPER) TAKE UP STRIPPER
2110203-213-B	PRESSER SPRING, INNER	85	2110201-181	BACK COVER PLATE	171	0251011-154-A	OIL HOSE CLIP	255	2110102-258	PLATE
2110203-214	PRESSER SPRING, OUTER	86	2110201-182-A	GASKET FOR 85	172	2110206-182	OIL HOSE UNION	256	9549098-279	STRIPPER STAPLE FOR 254
2110203-215	PRESSER BAR ONLY	87	2110203-253	SET SCREW FOR 85, 89, ETC	173	2110206-183-A	OIL HOSE UNION SCREW	257	9549098-279	SET SCREW FOR 255 & 261
2210103-220	HINGED FOOT COMPLETE (1/4")	88	2110201-234	RUBBER PLUG FOR 89, 103, ETC	174	2110206-158	OIL HOSE	257	9031001-006-A	WASHER FOR 255
2210103-231	PRESSER BAR GUIDE BRACKET	89	2110201-231	FACE COVER PLATE	175	2110206-147	OIL FEED HOSE	258	2110202-254	THREAD GUIDE, RIGHT FOR 254
9531102-256	SET SCREW FOR 8	91	2110203-253	KNEE LIFTER ROD	176	2110206-173	OIL TUBE FOR 239	259	2110202-259	THREAD GUIDE PLATE FOR 254
2110203-241	PRESSER BAR LIFTER	92	2110206-145	OIL HOSE	177	2110206-145	OIL HOSE	260	9549086-106	SET SCREW FOR 251
2110203-242	PRESSER BAR LIFTER ROD	93	2110203-252-A	KNEE LIFTER BELL CRANK, RIGHT	178	2110206-146	OIL HOSE	261	2110202-262	THREAD GUIDE, LEFT FOR 254
9018500-021	HINGE SCREW FOR 11	94	2110203-256	SPRING FOR 93	179	2110206-144	OIL HOSE	262	2110202-255	THREAD GUIDE, REAR, LOWER FOR 254
9060100-009	RUBBER RING FOR 11	95	9035030-038	HINGE SCREW FOR 93	180	2110202-340	LOWER THREAD GUIDE TUBE COMPLETE	264	2110202-261	THREAD GUIDE, REAR, UPPER FOR 254
2110203-215	PRESSER BAR BUSHING	96	9110603-313	KNEE LIFTER BELL CRANK LINK	181	2110206-181	SCREW FOR 156	266	2110201-221	PUSH BUTTON
2110102-113	NEEDLE BAR UPPER DUSHING	97	2110206-019-A	HINGE SCREW FOR 96	182	2110202-352	TENSION DUNC (LOOPER)	267	2110202-222	PUSH BUTTON SPRING
9501501-256	SET SCREW FOR 14, 16, ETC	98	2110203-314-B	KNEE LIFTER PULL ROD	183	2110202-357	TENSION STOP (LOOPER)	268	2110201-223	PUSH BUTTON SLEVE
2110202-115-A	RUBBER CAP FOR 16	99	9410125-100	NUT FOR 98	184	2110202-359	TENSION ADJUSTING NUT (LOOPER)	269	9039200-007	STOP RING FOR 266
2110202-111-A	NEEDLE BAR ONLY	100	2110561-232-A	GASKET FOR 89	185	2110202-368	TENSION SPRING (LOOPER)	270	9501502-256	SET SCREW FOR 268
2110202-114-B	NEEDLE BAR LOWER BUSHING	101	2110106-391-A	ARM WICK RETAINER	186	2110202-371	TENSION THREAD GUIDE (LOOPER)	271	2110201-224	PACKING FOR 268
2110202-116	NEEDLE CLAMP THREAD GUIDE	103	2110201-100-H	OIL BCD COMPLETE	187	2110202-327-A	THREAD GUIDE COVER PLATE	272	2110204-355	SLIDE BLOCK FOR 325, 330, ETC
2110202-170	NEEDLE CLAMP BODY (1/4")	104	2110202-211	NAME PLATE	188	2110202-327-A	THREAD GUIDE COVER PLATE	273	2110204-350	FEED LIFTING & LOOPER ECCENTRIC
2110202-195	NEEDLES (L#16)	105	9549806-102	SET SCREW FOR 104	189	2110201-254	CAP FOR 70	274	2110205-121	FEED ECCENTRIC
2110202-021	TAKE UP LEVER COMPLETE	106	2110202-327	THREAD (NEEDLE) GUIDE, UPPER	192	2110202-337	HINGE COMPLETE FOR 187	275	2110205-102	BRACKET FOR 274
2110202-101-A	NEEDLE BAR BRACKET COMPLETE	107	2110102-325	THREAD (NEEDLE) GUIDE SEAT	190	9549099-119	SET SCREW FOR 135 & 189	276	2110205-150	SLEVE FOR 275
2110202-121	NEEDLE BAR CRANK ROD	108	9049033-241	SET SCREW FOR 107, 112, ETC	192	2110202-338-A	SET SCREW FOR 187	277	2110205-114	FEED ECCENTRIC RATCHET WHEEL
2110202-122-A	SLIDING BLOCK FOR 27	109	9013400-003	PRESS SCREW FOR 106	193	9549016-119	SET SCREW FOR 192	278	2110205-115	FEED ECCENTRIC RATCHET
2110202-140	NEEDLE BEARING COMPLETE	110	2110102-315	THREAD (NEEDLE) GUIDE, LOWER	195	2110202-339	RETAINER FOR 192	279	2110205-122-A	SPRING FOR 278
2110202-102	NEEDLE BAR CRANK PIN	111	9549094-102	SET SCREW FOR 110	197	9549098-279	SET SCREW FOR 189	281	9012020-131	OIL HOSE UNION FOR 293
2110202-215-A	WASHER FOR 40	112	2110202-321	WASHER (NEEDLE) EYELET	199	2110202-310	SET SCREW FOR 189	281	9015500-001	SET SCREW FOR 279
2110203-255	KNEE LIFTER BELL CRANK, LEFT	113	9015500-011	HINGE SCREW FOR 112	199	2110201-316	OIL GAUGE COMPLETE	282	2110204-304	LOOPER FEED CAM
2110203-251	SHAFT FOR 32	114	2110106-424-A	HORN CLAMP	200	2110201-313-A	DRAIN PLUG	283	2110206-159-A	OIL TUBE FOR 237
2110203-219	CRANK FOR 40	115	2110601-402	OIL GAUGE WINDOW FRAME	201	2110201-314-B	PACKING FOR 200	285	2110201-111	OIL HOSE UNION FOR 293
9541111-207	SET SCREW FOR 32	116	2110201-212-A	OIL GAUGE WINDOW	202	2110201-312	PACKING FOR GASKET	286	2110204-375	LOOPER CONNECTOR
9060100-001	RUBBER RING FOR 33, 288, ETC	117	2110202-217	OIL GAUGE BASE	203	9541201-256	SET SCREW FOR 198	287	2110205-226-A	SLIDING BLOCK FOR 286 & 333
9030100-012	WASHER FOR 33	118	2110201-213	PACKING FOR 116 & 117	204	2110202-423	OIL HOSE RETAINER	288	2110204-379-A	SHAFT FOR 287
9060200-335-A	STOP RING FOR 11 & 32	119	9560903-307	SET SCREW FOR 115 & 359	205	2110203-336	KNEE LIFTER PLATE	289	2110204-380-A	SET SCREW FOR 288
2110203-418	TENSION RELEASE CONNECTING ROD	120	2110201-411	MODEL NUMBER PLATE	207	2110203-337	KNEE LIFTER COVER FOR 206	292	2110204-368	WASHER FOR 288
9015500-447	JOINT SCREW FOR 40	121	2110209-421	EXPORT MARK	208	2110203-338	SUPPORT FOR 206	293	2110204-308-A	GUIDE BRACKET FOR 286
2110203-407	TENSION RELEASE SHAFT CRANK	122	2110202-326	THREAD GUIDE FOR LOOPER	209	2110203-342	KNEE LIFTER ARM	294	2110204-376	LOOPER LEVER
2110203-413-A	TENSION RELEASE SHAFT	123	2110203-342	BRACKET FOR 122	210	9024000-001	SET SCREW FOR 208	295	9410161-297	NUT FOR 286
2110203-416-A	UPPER THREAD TENSION BRACKET	124	9549089-259	SET SCREW FOR 122	211	2110203-341-B	KNEE LIFTER ARM JOINT	296	2110204-366	LOOPER DRIVING BALL STUD
9549033-259	STOP SCREW FOR 43	125	2110202-324	STAY FOR 123	212	9581601-207	SET SCREW FOR 211	297	2110204-377-A	SHAFT FOR 294
2110202-352	TENSION DISC	127	9549100-236	SET SCREW FOR 120	213	9592002-159	SET SCREW FOR 211	298	9501506-279	SET SCREW FOR 297
2110202-353	TENSION DISC WASHER	128	2110203-344	TIMING BELT COVER	214	2110203-345	SET SCREW FOR 211	299	2110204-369	WASHER FOR 290
2110202-355-A	UPPER THREAD TENSION SPRING	129	9501501-256	SET SCREW FOR 128	215	9541202-279	CLAMP SCREW FOR 214	300	9539096-119	CAP SCREW FOR 297
2110202-356-A	TENSION RELEASE PIN	130	2110201-452	GASKET PLATE FOR 128	216	2110203-333	KNEE LIFTER SPRING	301	2110204-361-A	LOOPER LINK
2110202-357	TENSION SCREW STUD	131	2110203-431	CAP SCREW FOR 131	217	2110203-334	KNEE LIFTER SHAFT	302	2110204-362-A	LOOPER LINK SHAFT
2110202-359	UPPER THREAD TENSION ADJUSTING NUT	132	9541202-239	WASHER FOR 131	218	2110203-334	WASHER FOR 217	303	9420201-119	FASTENING NUT FOR 302
2110202-366	UPPER THREAD TENSION ADJUSTING NUT	134	2110204-161	TIMING BELT	219	2110203-338	BRACKET FOR 217	304	2110204-365	LOOPER SHAFT HOLDER
2110202-367	UPPER SLEAVE FOR 48	135	2110202-330	INCLINED THREAD GUIDE TUBE COMPLETE	220	9541201-256	SET SCREW FOR 219	305	9541012-259	CLAMP SCREW FOR 304
2110202-371	TENSION THREAD GUIDE	137	2110201-243	STITCH LENGTH INDICATOR	221	9539099-207	SET SCREW FOR 216	306	2110204-364	CLAMP SCREW FOR 305
2110202-318-A	THREAD (NEEDLE) GUIDE, ARM TOP	139	2110201-411	BELT COVER PLATE	224	2110203-362-B	KNEE LIFTER LEVER	307	2110204-382	LOOPER SHAFT REAR BUSHING
9531503-259	SET SCREW FOR 85	140	2110201-412	BELT COVER SUPPORT	225	9581601-207	CLAMP BOLT FOR 224	309	9501201-259	SET SCREW FOR 307 & 308
9015500-021	OIL HOSE RETAINER	141	9549099-247	SET SCREW FOR 139	226	2110203-363	BUSHING FOR 224	310	2110204-383	LOOPER SHUTT COLLAR
9013400-013	SET SCREW FOR 57	142	9541501-116	SET SCREW FOR 140	227	2110203-367	BUSHING FOR 228	311	9541102-259	CLAMP SCREW FOR 310
9501203-276	SET SCREW FOR 30	143	2110201-413-A	BELT COVER BED	228	9501509-276	SET SCREW FOR 227	313	9060100-001	OIL SEAL FOR 308
9501801-278	SET SCREW FOR 57	145	9583201-436	SET BOLT FOR 143	229	9549015-104	CAP SCREW FOR 227	312	2110204-353	BUSHING FOR LOOPER HOLDER
2110202-256	CLAMP SCREW FOR 30	146	2110202-357	VERTICAL SHAFT OIL TRAY	230	2110203-357	VERTICAL SHAFT RELEASE ARM	314	2110204-354	BUSHING FOR LOOPER HOLDER
2110104-121	TOP SHAFT FRONT CAP SCREW	147	9539098-119	SET SCREW FOR 146	231	9541602-107	CLAMP SCREW FOR 230	315	9541112-256	CLAMP SCREW FOR 314 & 316
2110104-119	PACKING FOR 62	148	2110204-242	VERTICAL SHAFT UPPER BUSHING	232	2110203-338-B	KNEE LIFTER CONNECTING ROD	316	2110204-351	LOOPER HOLDER, REAR
2110106-361	TOP SHAFT OIL FELT, OUTER	150	2110204-241	VERTICAL SHAFT ONLY	233	9015500-029	HINGE SCREW FOR 232	317	2110204-341	LOOPER A
2110106-132-A	TOP SHAFT OIL FELT, INNER	151	2110204-243	VERTICAL SHAFT LOWER BUSHING	234	2110203-337	LOOPER SHUTT COLLAR	318	2110204-342	LOOPER B
2110204-111-A	TOP SHAFT ONLY	152	2110204-240	VERTICAL SHAFT COLLAR COMPLETE	235	2110202-345	THREAD GUIDE TUBE	319	2110204-343	SET SCREW FOR LOOPER
2110204-112-A	TOP SHAFT FRONT BUSHING	153	2110606-150	COLLAR FOR 154	236	2110204-250-A	TIMING BELT WHEEL, LOWER	320	2110104-366	LOOPER DRIVING BALL STUD
9531101-264	SET SCREW FOR 68	155	2110606-152	SPRING POINT	237	2110204-212	LOWER SHAFT FRONT BUSHING	321	9401511-219	NUT FOR 320
9015600-006	SET SCREW FOR 67, 72, ETC	155	2110206-118-A	OIL RETURN CAM SHAFT	238	2110202-250	LOWER SHAFT CENTER BUSHING	322	9194201-102	SPRING WASHER FOR 321
2110204-113-A	TOP SHAFT CENTER BUSHING	156	2110206-118	OIL PUMP BODY	239	2110204-214	LOWER SHAFT REAR BUSHING	323	2110204-370	LOOPER TOGGLE LINK COMPLETE
9531101-264	SET SCREW FOR 68	157	2110206-118	OIL PUMP BODY SEAT	241	2110204-211	LOWER SHAFT ONLY	324	9549097-259	SET SCREW FOR 323
9015600-004	SET SCREW FOR 76	158	9541211-102	SET SCREW FOR 156	242	2110202-250-A	THREAD (LOOPER) TAKE UP	325	2110204-382	LOOPER FEELER COMPLETE
9060100-160-A	TIMING BELT WHEEL, UPPER	164	2110206-112	PISTON FOR 155	243	2110202-250-A	THREAD (LOOPER) TAKE UP	326	2110201-172-B	LOOPER FEELER SHAFT SUPPORT
9060100-160-A	PACKING FOR 106	165	9013300-004	SPRING FOR 159	244	2110202-272	TAKE UP	327	2110206-174	OIL HOSE CLAMP
2110201-051-A	SET SCREW FOR 80	166	9030100-021	SET SCREW FOR 160	245	2110202-273-B	SPRING FOR 243	328	9541206-102	SET SCREW FOR 326
9501505-376	SET SCREW FOR 80	167	2110206-103	WASHER FOR 163	246	2110202-273-B	WASHER FOR 243	329	2110204-306-A	FEELER SPRING ARM
2110604-152	CAP SCREW FOR 80 & 236	168	2110206-103	OIL PUMP IMPELLER	247	9549086-106	SET SCREW FOR 244	330	9549097-259	FEEL LIFTING FORK
			164	2110606-112	249	9549086-106	RETAINER FOR 244	331	953-1104-279	SET SCREW FOR 330
			165	2110606-114	249	2110203-276	RETAINER FOR 244	332	9549097-259	SET SCREW FOR 330
			166	2110606-115	250	9549097-259	FRAME FOR 165	333	9549097-259	SET SCREW FOR 330
			167	9549097-259	251	2110202-263	COVER COMPLETE FOR 242	334	2110205-223	FEED DOG (1/4")
			168	2110206-163	252	9549094-119	SET SCREW FOR 204 & 251	335	9531205-256	SET SCREW FOR 334

(3/16")  
 401 2210152-170 NEEDLE CLAMP BODY (3/16")  
 402 2210143-220 HINGED FOOT COMPLETE (3/16")  
 403 2210213-111 NEEDLE PLATE (3/16")  
 404 2210215-223 FEED DOG (3/16")  
 405 2210213-140 LAP SEAM FELLER