



HERCULES®

herculescutters.com

HRK-100

5-SPEED DIRECT-DRIVE
CUTTING MACHINE
FOR MULTI-PLY CLOTH & FABRIC CUTTING

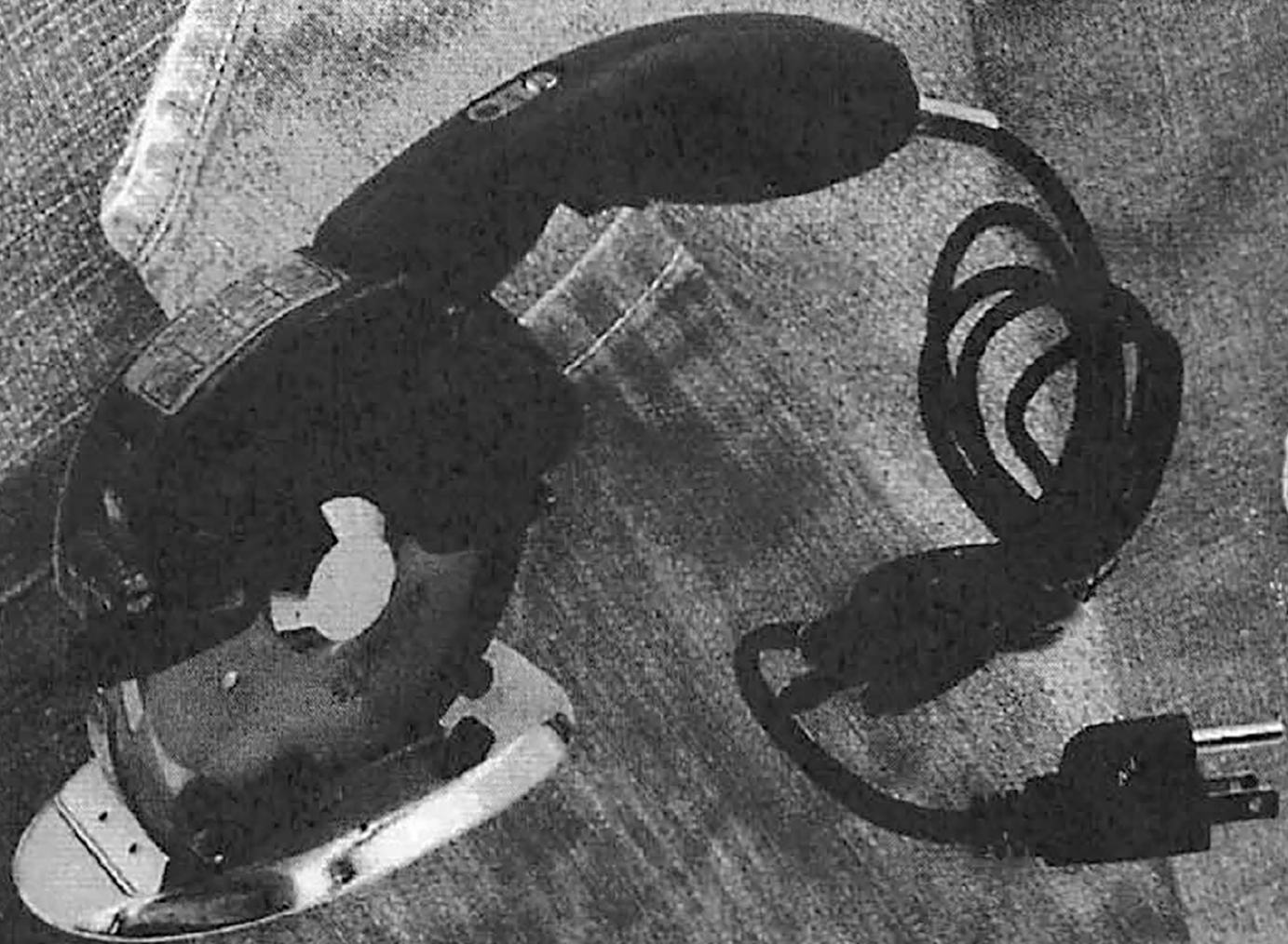

Hercules® HRK-100 5-Speed Cutting Machine

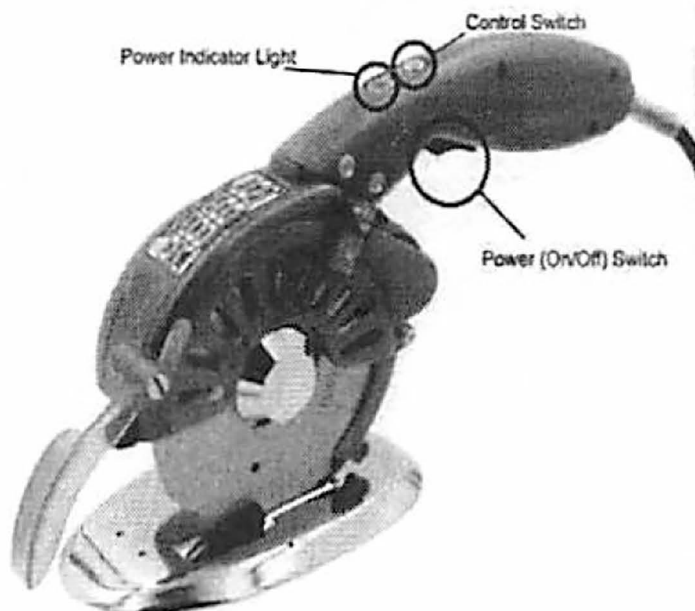

MAINTENANCE...

Blade Inspection and Maintenance

1. To ensure optimal performance and longevity you should lubricate the blade after every 50 hours of use. Open the included plastic oil dispenser and place a drop or two of oil onto the lubricating pad at the top of the blade guard.
2. Keep the blade sharp with the built-in sharpener. Turn the machine on at the lowest speed and use your index finger to apply lateral pressure to the sharpening wheel until it makes contact with the blade, then hold the sharpening wheel against the blade for 2-3 seconds.
3. Replace the blade and sharpening wheel as needed. See instructions later in this manual.



Inspect and Tighten Mounting Screws

To ensure optimal performance and operational safety you should regularly inspect all mounting screws to ensure that they are properly tightened. If any are found loose re-tighten them immediately, failure to do so could result in serious injury.

Keep Unit Clean and Dry

Keep the HRK-100 clean and dry for years of problem-free service and performance.

RECOMMENDED USE...

This machine is designed to cut all types of patterns and is capable of handling slippery or synthetic materials singly or in multiple plies. The HRK-100 easily cuts all types of fabrics in multiple layers. The powerful 5-speed direct-drive servo motor provides smooth and consistent operation through all cutting applications.

USAGE INSTRUCTIONS...

1. The Power Switch is located on the bottom of the handle; turn it to the On position. (Use caution because the blade will begin turning immediately.)
2. The speed is adjusted using the Control Switch which is located on top of the handle. The initial operational speed is 600 RPM; Press the Control Switch to cycle through the 5-speeds, returning to the initial operational speed.
3. To turn on the LED cutting light simply press the Control Switch and hold it for 3 seconds. Press the Control Switch again to turn the LED cutting light off.

SAFETY PRECAUTIONS...

1. Workplaces should be clean and free of debris.
2. Do not expose the HRK-100 to moisture.
3. The blade is extremely sharp and spinning at 600-1200 RPM, use caution around the unit when it is plugged in and never allow children near when in operation.
4. Store the HRK-100 in a dry place that isn't exposed to extreme temperature shifts.
5. Always perform a visual inspection of the unit before using to make sure all safety shields are in place, all mounting screws are secure and the blade is secure.
6. It should not be hard to push the machine through the material. If it is, check the blade for sharpness and make sure you're not trying to cut too many layers.
7. Always wear safety glasses and never wear loose clothing or neckties while operating the HRK-100.
8. Before performing any maintenance, unplug the machine and make sure the red power indicator light is off.
9. Routine maintenance should be performed to ensure optimal cutting performance, safety, and longevity. Follow the maintenance instructions in this manual.
10. Other than routine maintenance, and replacement of the blade and sharpening stone, no other repairs should be performed by anyone other than a qualified repair professional using genuine Hercules® replacement parts.

Hercules® HRK-100 5-Speed Cutting Machine

REPLACING THE BLADE AND SHARPENING STONE...

IMPORTANT: Before attempting to replace the blade, unplug the HRK-100 and make sure the red power indicator light on top of the handle is off. **NEVER ATTEMPT TO PERFORM ANY MAINTENANCE ON THE HRK-100 WHILE THE MACHINE HAS POWER.**

1. Remove the shield by removing the four screws that attach the shield to the machine.

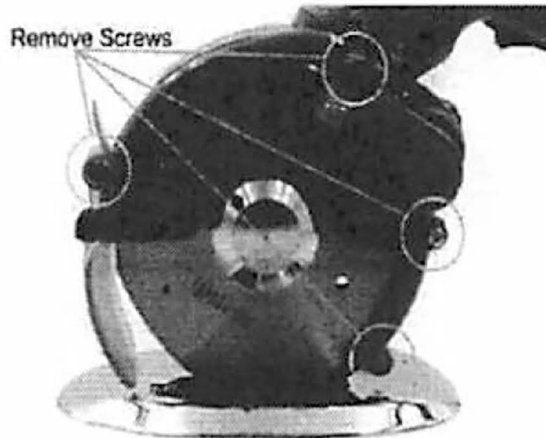

2. Align the locator hole in the blade with the locator hole in the backing plate.

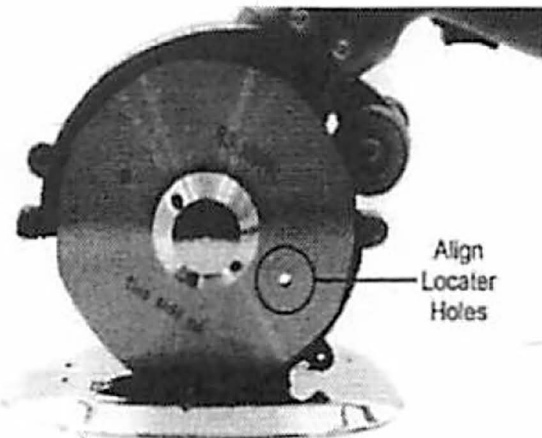

3. Insert the hex wrench (included) through the blade and the backing plate to lock the blade in place then insert the butterfly wrench on the blade lock-nut.

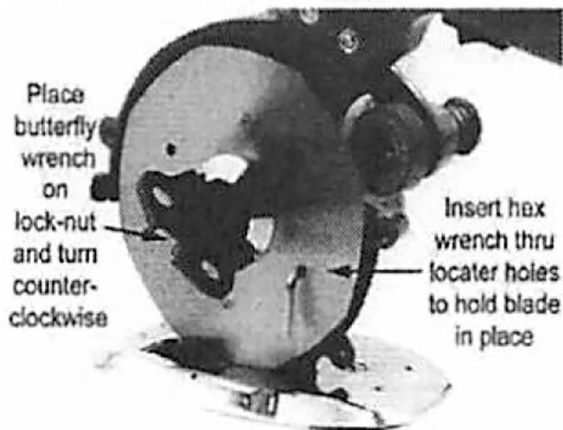

4. Turn the butterfly wrench counterclockwise to loosen the blade lock-nut, unscrew and remove the lock-nut, then carefully remove the blade.



5. To remove the sharpening wheel, insert the hex wrench through the locator hole in the shaft to lock the wheel, then turn counterclockwise to unscrew.



6. Reverse these steps to reassemble your HRK-100

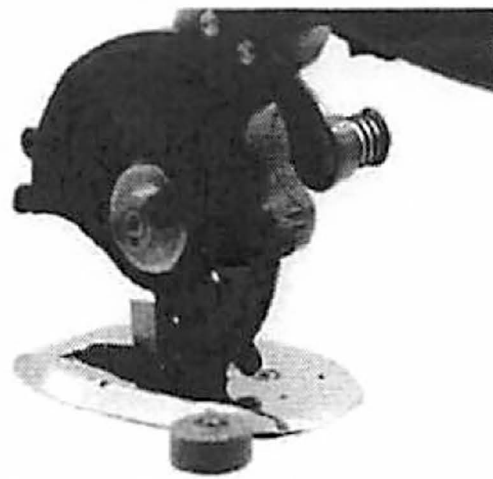

Hercules® HRK-100 5-Speed Cutting Machine

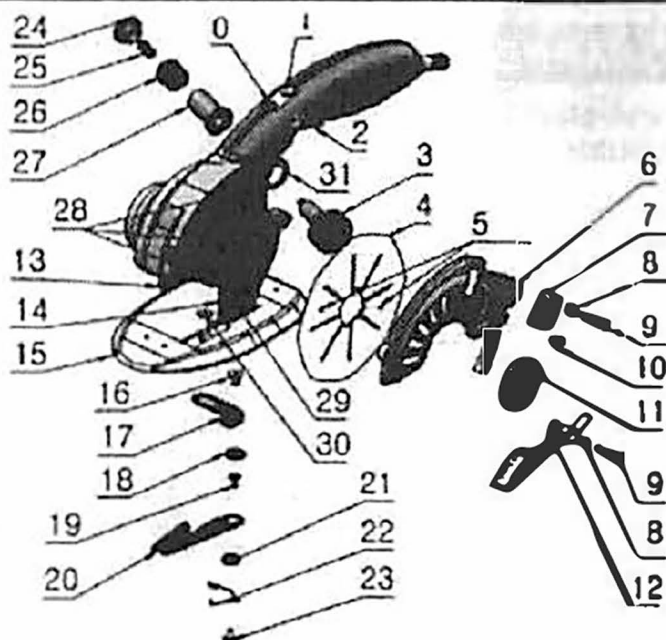

Knife Size: 100mm (4")
 Knife Shape: Octagon
 Working Voltage: 110V - 240V
 Operational Power: 3.6W - 200W
 Noise Level: <55dB
 Cutting Height: <=27mm
 Machine Weight: 1.3KG (2.9LBS)
 Working Speed: 600 - 1200 RPM
 Cutting Light: LED

NOTICE: All Hercules® products are constantly being improved and modified to incorporate the latest technological advancements, because of this some parts may change without notice. Due to continuing research and development the specifications listed herein are also subject to change without prior notice.

PARTS LIST...

0	Power Light	16	Under-knife Fastening Screw
1	Speed Control Switch (Part # 6741)	17	Under-knife Connector Arm
2	On/Off Switch (Part # 6742)	18	Two-step Nut
3	Sharpening Wheel (Part # 6743)	19	Large Pan-Screw
4	4" (100mm) Round Knife (Part # 6744)	20	Under-knife
5	Locator Hole	21	Three-step Screw
6	Safety Shield	22	Under-knife Spring
7	Oil Pot	23	Under-knife Spring Nut
8	Pressure Spring	24	Wheel Cap
9	Step Screw	25	1/2 Inch Sharpening Spring
10	Cover Screw	26	Wheel Pressure Spring
11	Blade Pressure Plate	27	Wheel Spindle Sleeve
12	Blade Guard	28	Bracket Screw
13	LED Light	29	Separator Screw
14	Separator Plate	30	Chassis Screw
15	Chassis	31	Sharpening Frame

LIMITED WARRANTY...

The HRK-100 5-Speed Cutting Machine is warranted to be free of defects in material and workmanship under normal use for a period of 6 months from the date of purchase.

Liability is limited to repair or replacement of material found defective, free of charge F.O.B. St. Louis, MO. Unauthorized repairs, modifications, or replacements will not be subject to factory warranty.

From the library of Superior Sewing Machine & Supply LLC - www.supsew.com