

EASTMAN

Marking Machines

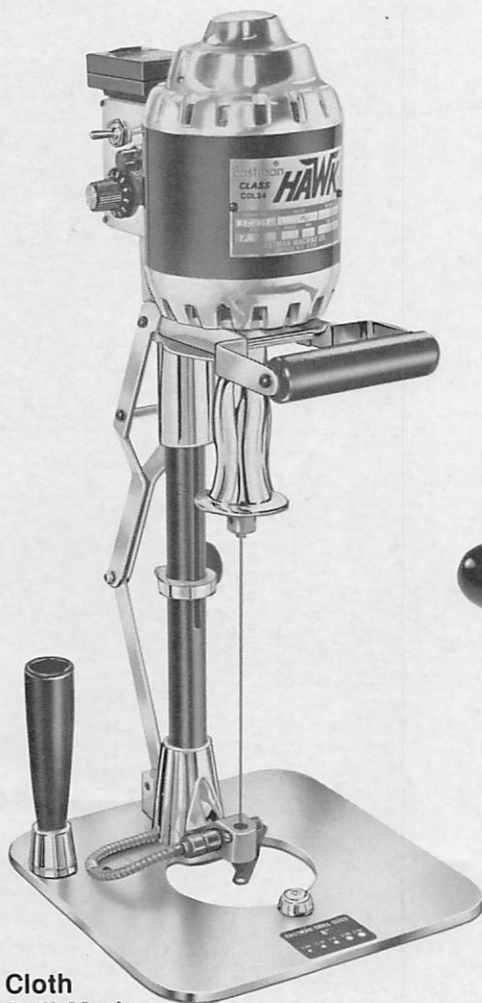

Hot Notcher
Model HVN
Page 17



Cloth
Drill Marker
Model CD3, CD3H
Hawk/Model CDL, CDLH
Page 3

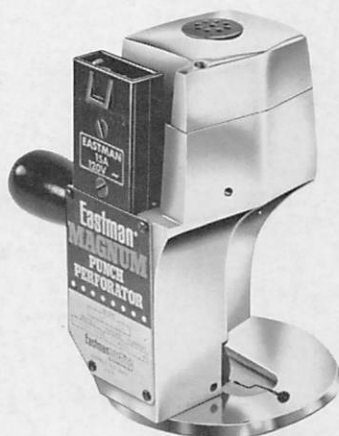

Magnum
Punch Perforator
Model MP2
Page 14

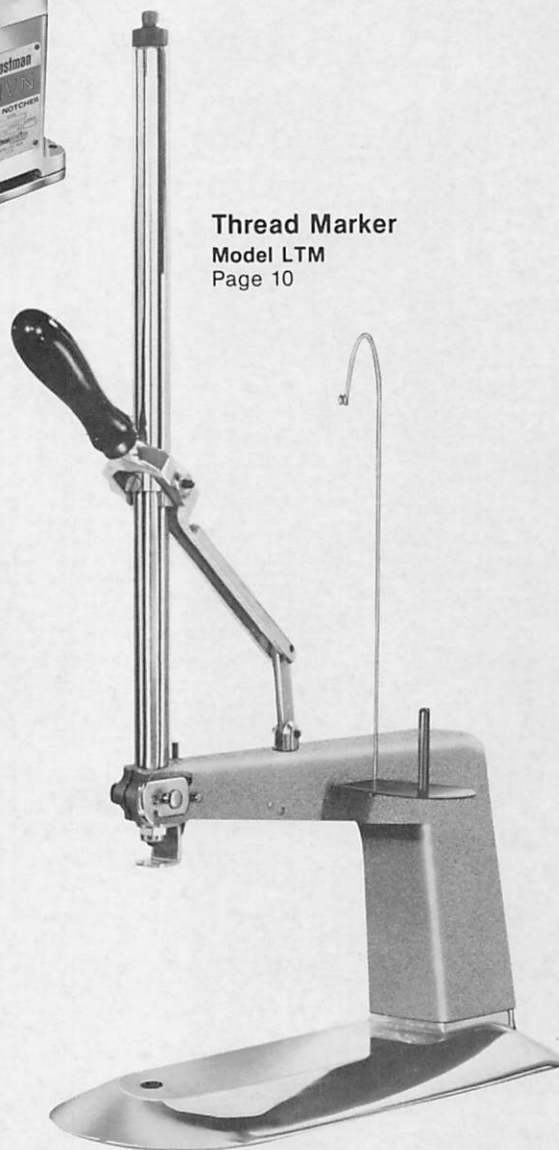

Thread Marker
Model LTM
Page 10

INSTRUCTION BOOK AND PARTS LIST

Eastmanmachine
COMPANY

779 WASHINGTON STREET • BUFFALO, NEW YORK 14203 • AREA CODE: 716, 856-2200 • TELEX 91-9141 • CABLE EMCO

Marking Machines

Hot Notcher
Model HVN

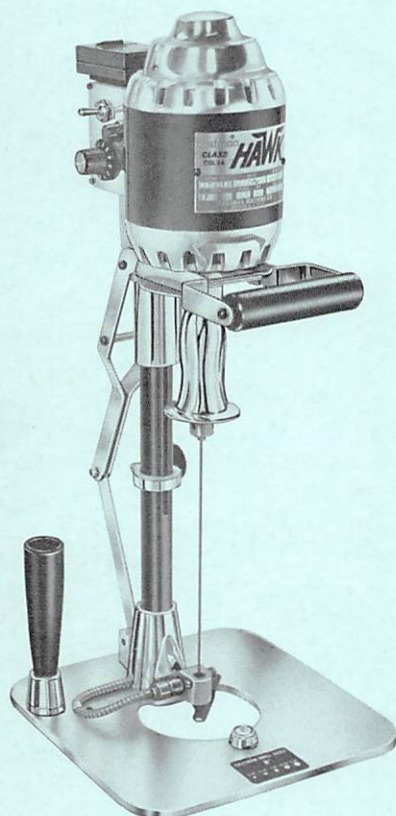
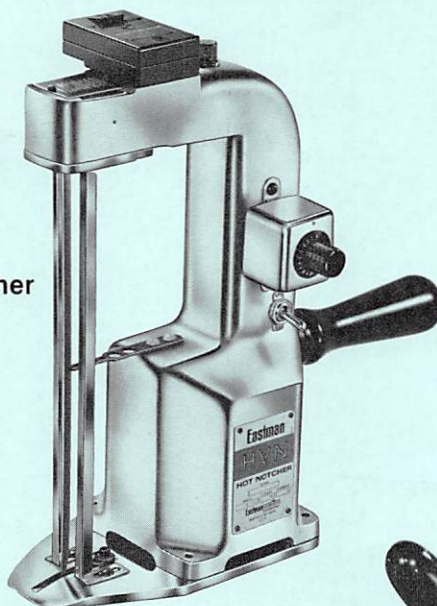

Cloth Drill Marker
Model CD3, CD3H
Hawk/Model CDL, CDLH

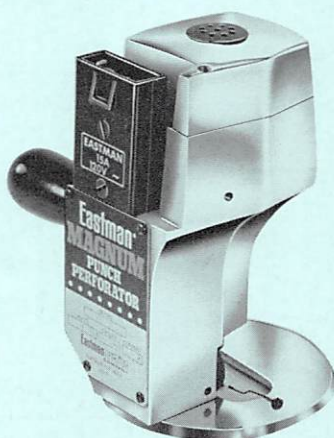

Magnum Punch Perforator
Model MP2

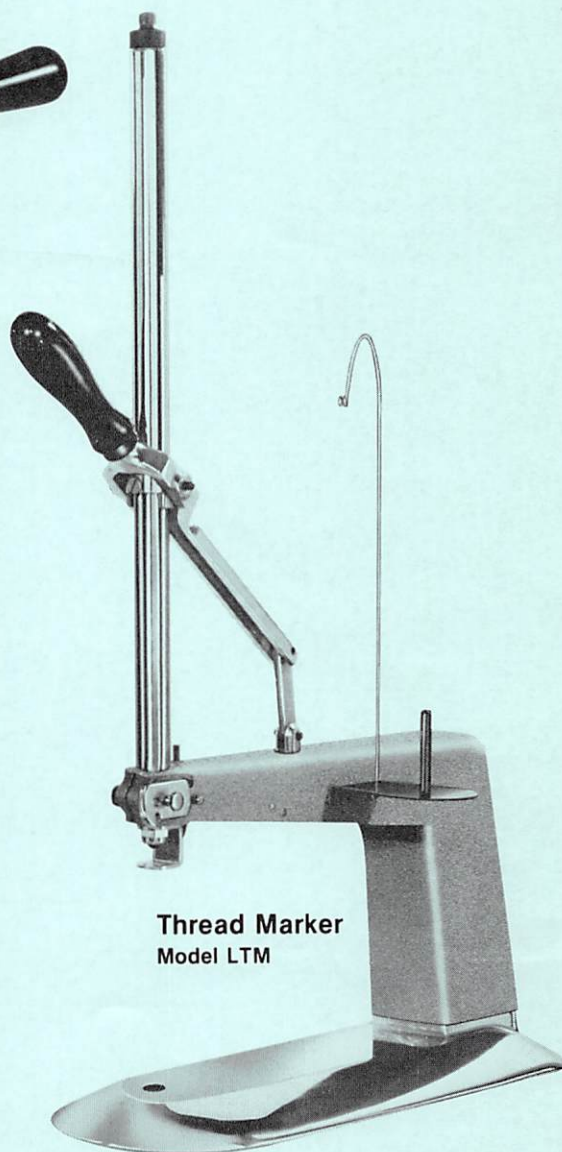

Thread Marker
Model LTM

Eastman Machine Company manufactures a complete line of marking machines, carefully designed to save time and eliminate costly errors. Parts for these machines are readily available and Eastman Marking Machines are serviced by the same sales and service network that has made Eastman Cutting Machines so popular.

HOT NOTCHER—Model HVN—Burns a perfectly true mark in knit goods without costly raveling. No lost marks between cutting and sewing rooms.

CLOTH DRILL MARKERS—Available with or without needle heating attachment, 6, 8 or 11½ inch drilling capacity and drill sizes 3/64 to 3/8 inch diameter. The solid state needle heater heats faster, hotter and holds heat longer...completely enclosed for operator safety.

Model CD3—The Drill Markers low profile design and telescopic drive shaft allow accurate drilling straight down through high layers of all types of material. The powerful motor is built to provide many years of trouble-free operation.

Model CDL—The Hawk is a lever-action cloth drill engineered by Eastman to drill faster and better than any marking machine made. This drill is manufactured for tough, thick cloth like denim, corduroy, cotton duck, broadcloth, canvas and sailcloth.

MAGNUM PUNCH PERFORATOR—The Model MP2 Magnum Punch Perforator makes four crisp, clean holes to an inch through as many as five thicknesses of average weight pattern paper. The punching mechanism is adjustable to accommodate various thicknesses of paper. This powerful machine never misses one of the punches. A single control lets the operator free-wheel or single perforate.

EASTMAN

Cloth Drill

Model CD3, CD3H, CDL, and CDLH

Operating Instructions

CAUTION:

Read instructions carefully before starting motor. Be sure that voltage is the same as stamped on nameplate.

OPERATION

Set gauge as indicated on illustration for drilling proper height of material.

Position Drill Marker over mark on material with drill directly over mark.

To start, throw Switch Lever to "on" position and let motor gather full speed before starting to drill.

Enter Drill or Awl in the goods slowly—Do not force the drill thru the goods with too much pressure as this will cause the drill to burn and possibly bend and snap off.

LUBRICATION

The Upper and Lower Motor Ball Bearings as well as the Spindle Ball Bearing in the handle are grease sealed and require no lubrication.

TO CHANGE DRILL

Lay Drill Marker on its side, use Chuck Key to loosen drill. Remove old drill from Chuck and pull down and thru Drill Guide Bushing.

Insert new Drill thru lower Drill Guide Bushing and up into Chuck. Tighten Drill using Chuck Key.

NOTE:

Each diameter Drill or Awl requires a corresponding Guide Bushing. See chart below. List the serial number of your drilling machine on all orders for drills or parts.

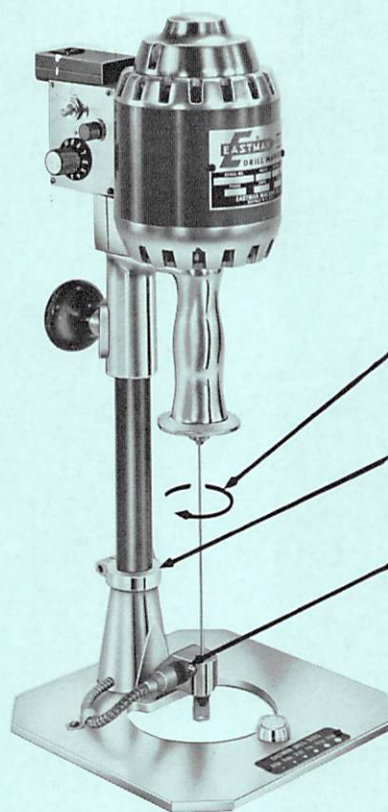

NOTE: Drill must run in direction as shown by Arrow

Set Gauge to the correct height so that drill will not penetrate table

To remove Guide Bushing loosen Screw 3 turns

EASTMAN DRILL SELECTION TABLES

Eastman offers a wide selection of Drill Points and Awls for different type materials.

Make sure you get the type Drill you need. Avoid errors by using the Drill Number listed in the tables.

Drills and Awls for 4" Drills, actually measure 5½" Long.

Drills and Awls for 6" Drills, actually measure 7½" Long.

Drills and Awls for 8" Drills, actually measure 10" Long.

Drills and Awls for 11½" Drills, actually measure 13½" Long.

DRILL OR AWL SELECTION TABLE

| Drill or Awl dia. | | 3/64" | 5/64" | 3/32" | 1/8" | 5/32" | 3/16" | 1/4" | 5/16" | 3/8" |
|-------------------|--------------|---------|----------|----------|----------|----------|----------|----------|----------|---------|
| Hole size | Drill length | ● | ● | ● | ● | ● | ● | ● | ● | ● |
| Diamond Point | 4" | 231C1 | 231C1-1 | 231C1-2 | 231C1-3 | 231C1-4 | — | — | — | — |
| | 6" | 231C1-6 | 231C1-7 | 231C1-8 | 231C1-9 | 231C1-10 | — | — | — | — |
| | 8" | — | 231C1-12 | 231C1-13 | 231C1-14 | — | — | — | — | — |
| | 11½" | — | — | — | — | — | — | — | — | — |
| Taper Point | 4" | 231C2-1 | 231C2-2 | 231C2-3 | 231C2-4 | 231C2-5 | — | — | — | — |
| | 6" | 231C2-7 | 231C2-8 | 231C2-10 | 231C2-12 | 231C2-13 | — | — | — | — |
| | 8" | — | 231C2-19 | 231C2-20 | 231C2-21 | 231C2-24 | — | — | — | — |
| | 11½" | — | — | 231C2-27 | 231C2-26 | 231C2-28 | 231C2-29 | — | — | — |
| Open End Awl | 4" | — | 231C3 | 231C3-1 | 231C3-2 | 231C3-3 | 231C3-4 | 231C3-5 | 231C3-10 | 231C3-7 |
| | 6" | — | 231C3-18 | 231C3-11 | 231C3-12 | 231C3-13 | 231C3-14 | 231C3-15 | 231C3-16 | — |
| | 8" | — | 231C3-19 | 231C3-20 | 231C3-21 | 231C3-24 | — | — | — | — |
| | 11½" | — | — | 231C3-25 | 231C3-27 | 231C3-28 | — | — | — | — |
| Closed End Awl | 4" | — | — | 231C4 | 231C4-1 | 231C4-2 | 231C4-3 | — | — | — |
| | 6" | — | — | 231C4-5 | 231C4-6 | 231C4-7 | 231C4-8 | 231C4-9 | — | — |
| | 8" | — | — | 231C4-15 | 231C4-10 | 231C4-11 | 231C4-12 | — | — | — |
| | 11½" | — | — | 231C4-17 | 231C4-18 | 231C4-19 | — | — | — | — |

DRILL GUIDE BUSHINGS SELECTION TABLE

| | | | | | | | | | |
|------------------------|----------|----------|----------|----------|----------|----------|----------|----------|----------|
| Cold Drill Bushing | 21C13-40 | 21C13-36 | 21C13-34 | 21C13-35 | 21C13-37 | 21C13-38 | 21C13-42 | 21C13-41 | 21C13-44 |
| Hot Drill Bushing | 21C13-51 | 21C13-52 | 21C13-53 | 21C13-54 | 21C13-55 | 21C13-56 | — | — | — |
| *Multiple Size Bushing | 21C13-59 | 21C13-59 | 21C13-59 | 21C13-59 | 21C13-63 | 21C13-63 | — | — | — |

*OPTIONAL Multiple size bushing, cold drills only.

Bushing No. 21C13-59 for 3/64, 5/64, 3/32 & 1/8 hole sizes.

Bushing No. 21C13-63 for 5/32 & 3/16 hole sizes.

Eastmanmachine
COMPANY

Cloth Drill

Model CD3, CD3H, CDL, and CDLH
Illustrated Parts List

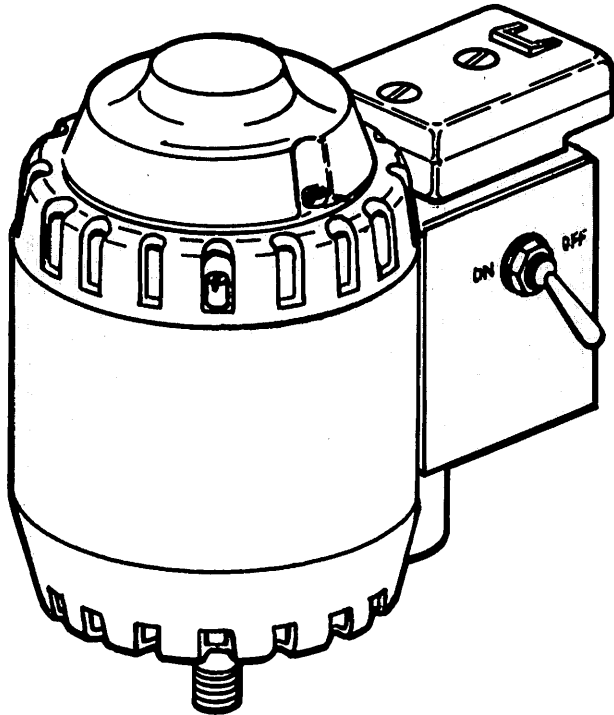

Motor Assemblies

NOTE: Please specify model and serial number of machine when ordering parts.

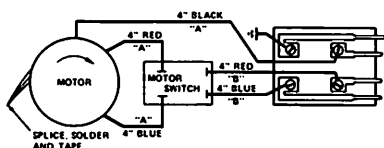

WIRING DIAGRAM CD3 AND CDL
 Three Phase

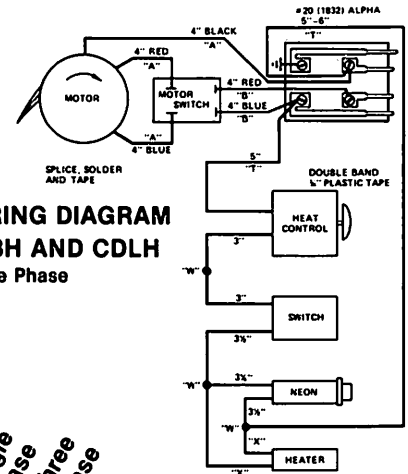

WIRING DIAGRAM
 CD3H AND CDLH
 Three Phase

| Part Number | CD3 & CDL | CD3H & CDLH | CD3 & CDL | CD3H & CDLH | Description |
|-------------|-----------|-------------|-----------|-------------|--|
| 1C4-11 | 0 | 0 | 1 | 1 | Spacer Sleeve |
| 4C1-180 | 4 | 4 | 4 | 4 | Nut |
| 4C1-191 | 1 | 1 | 1 | 1 | Shaft Lock Nut |
| 4C1-192 | 1 | 1 | 1 | 1 | Lower Bearing Nut |
| 4C2-101 | 0 | 1 | 0 | 1 | Wire Nut |
| 4C2-111 | 0 | 1 | 0 | 1 | Speed Nut |
| 8C5-10 | 1 | 1 | 1 | 1 | Automatic Switch Insulation |
| 10C2-30 | 1 | 1 | 1 | 1 | Rotor Fan |
| 12C1-34 | 0 | 2 | 0 | 2 | Lock Washer |
| 12C1-42 | 1 | 1 | 1 | 1 | Loading Spring Washer |
| 12C15-90 | 0 | 1 | 0 | 1 | Lock Washer for Control |
| 18C6-31 | 1 | 1 | 1 | 1 | Tolerance Ring |
| 18C6-36 | 1 | 1 | 1 | 1 | Location Ring Switch |
| 20C3-32 | 4 | 4 | 4 | 4 | Motor Screw |
| 20C13-91 | 0 | 1 | 0 | 1 | Drive Screw |
| 52C5-164 | 1 | 1 | 1 | 1 | Switch Base |
| 52C5-172 | 0 | 1 | 0 | 1 | Control, Pilot Light, Switch Base |
| 52C5-181 | 1 | 0 | 1 | 0 | Switch Base |
| 53C2-106 | 1 | 0 | 1 | 0 | Switch Cover |
| 53C7-39 | 1 | 1 | 1 | 1 | Rear Bearing Cover |
| 53C7-42 | 1 | 1 | 1 | 1 | Rear Bearing Cover 11 1/2" |
| 73C7-121 | 2 | 2 | 2 | 2 | Tubing Insulation |
| 90C1-154 | 1 | 1 | 1 | 1 | Upper Bearing Housing |
| 90C2-144 | 1 | 1 | 1 | 1 | Lower Bearing Housing |
| 90C6-43 | 1 | 1 | 1 | 1 | Lower Ball Bearing |
| 90C6-44 | 1 | 1 | 1 | 1 | Upper Ball Bearing |
| 98C4-32 | 0 | 1 | 0 | 1 | Switch Cap |
| 104C1-6 | 0 | 1 | 0 | 1 | Dial Indicator |
| 144C1-10 | 0 | 1 | 0 | 0 | Pilot Light 110V. |
| 144C1-11 | 0 | 0 | 0 | 1 | Pilot Light 220V. |
| 147C1-35 | 1 | 1 | 1 | 1 | Extension for Cover 11 1/2" |
| 251C1 | 0 | 0 | 0 | 1 | Heat Control 220V. |
| 251C1-1 | 0 | 1 | 0 | 0 | Heat Control 110V. |
| 300C10-3 | 3 | 3 | 3 | 3 | Screw, 6-32 x 5/16 Round Head |
| 300C12-2 | 2 | 2 | 2 | 2 | Screw, 8-32 x 3/8 Round Head |
| 301C7-3 | 3 | 3 | 3 | 3 | Screw, 4-36 x 1/4 Fillister Head |
| 301C10-3 | 2 | 2 | 2 | 2 | Screw, 6-32 x 3/8 Fillister Head |
| 301C10-4 | 2 | 2 | 2 | 2 | Screw, 6-32 x 1/2 Fillister Head |
| 301C14-7 | 2 | 2 | 2 | 2 | Screw, 10-24 x 1 Fillister Head |
| 512C1-122 | 1 | 1 | 1 | 1 | Rotor With Fan |
| 513C3-220 | 1 | 1 | 1 | 1 | Rotor With Shaft |
| 514C4-110 | 1 | 1 | 0 | 0 | Stator With Band 110V. 60cy. 3600 R.P.M. |
| 514C4-114 | 1 | 1 | 0 | 0 | Stator With Band 110V. 50cy. 3000 R.P.M. |
| 514C4-115 | 1 | 1 | 0 | 0 | Stator With Band 220V. 60cy. 3600 R.P.M. |
| 514C4-116 | 1 | 1 | 0 | 0 | Stator With Band 220V. 50cy. 3000 R.P.M. |
| 514C4-117 | 0 | 0 | 1 | 1 | Stator With Band 220V. 60cy. 3600 R.P.M. |
| 514C4-118 | 0 | 0 | 1 | 1 | Stator With Band 220V. 50cy. 3000 R.P.M. |
| 537C1-21 | 1 | 1 | 1 | 1 | Rear Bearing Cover w/Extension 11 1/2" |
| 580C1-48 | 0 | 1 | 0 | 1 | Toggle Switch |
| 580C1-65 | 0 | 0 | 1 | 1 | Switch For Motor (Three Phase) |
| 580C1-70 | 1 | 1 | 0 | 0 | Automatic Cut Out Switch |
| 580C1-85 | 1 | 1 | 0 | 0 | Switch For Motor (Single Phase) |
| 597C2-26 | 1 | 1 | 0 | 0 | Automatic Cut Out 60cy. 3600 R.P.M. |
| 597C2-27 | 1 | 1 | 0 | 0 | Automatic Cut Out 50cy. 3000 R.P.M. |
| 626C1-42 | 1 | 0 | 1 | 0 | Switch Bracket w/Switch Base |
| 626C1-43 | 0 | 1 | 0 | 1 | Switch Bracket w/Switch Base |
| 783C13 | 1 | 1 | 1 | 1 | Ground Wire Assy. |

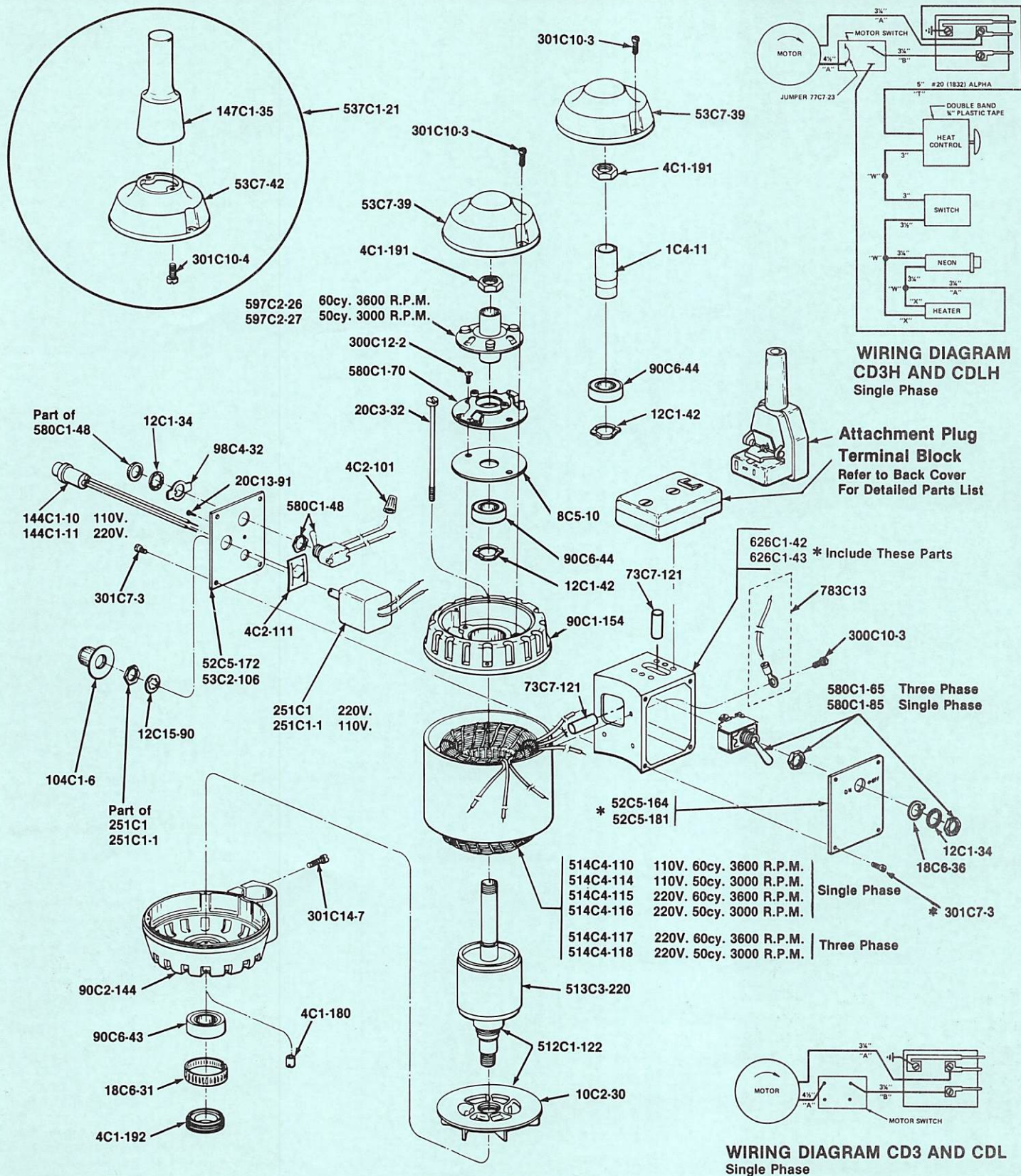

EASTMAN

Cloth Drill

Model CD3 and CD3H

Illustrated Parts List

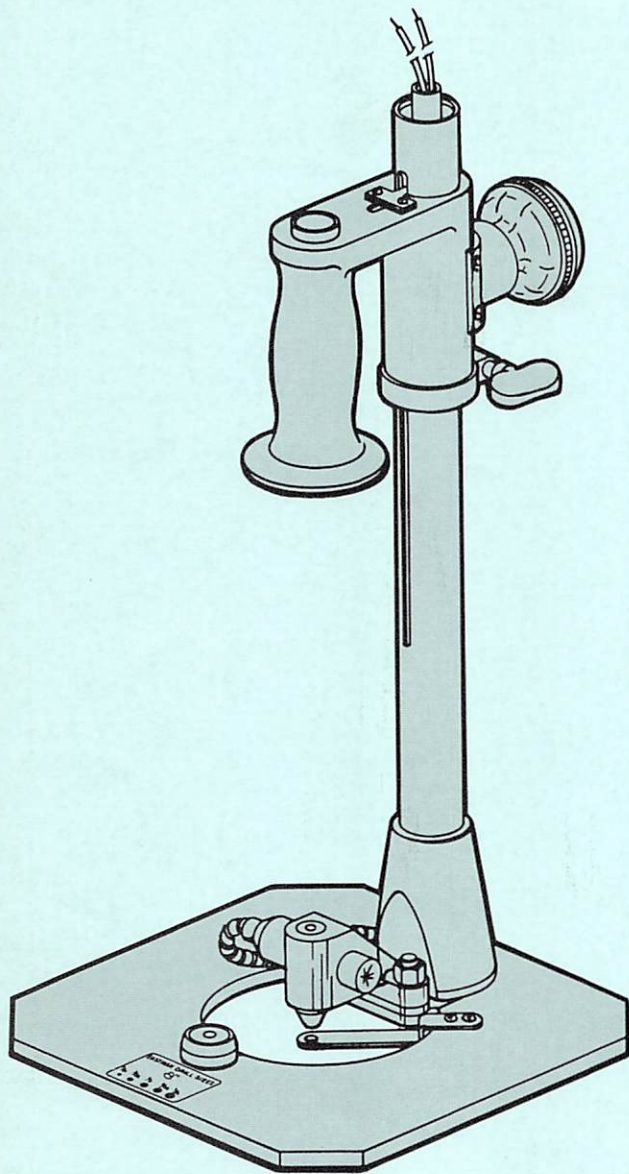

Standard, and Base Plate Assembly

NOTE: Please specify model and serial number of machine when ordering parts.

| Part Number | No. Req'd. | | Description |
|-------------|------------|------|---|
| | CD3 | CD3H | |
| 4C1-161 | 2 | 0 | Flex Nut |
| 4C1-184 | 0 | 2 | Stop Nut |
| 8C13-69 | 0 | 2 | Heat Insulator |
| 12C4-12 | 0 | 1 | Nylon Washer |
| 14C1-27 | 1 | 1 | Handle Grip |
| 14C1-30 | 1 | 1 | Handle Grip |
| 15C1-25 | 1 | 1 | Machine Handle Stud |
| 17C1-17 | 2 | 0 | Dowel Pin |
| 17C1-22 | 0 | 2 | Dowel Pin |
| 17C15-126 | 1 | 1 | Dowel Pin |
| 18C6-42 | 1 | 1 | Retaining Ring |
| 18C6-43 | 2 | 2 | Rubber "O" Ring |
| 18C6-44 | 1 | 1 | Retaining Ring |
| 20C7-13 | 1 | 1 | Thumb Screw |
| 20C13-67 | 1 | 1 | Screw, 6-32 x 5/16 Round Head Nylon |
| 20C13-86 | 2 | 2 | Set Screw |
| 21C14-9 | 1 | 1 | Bushing For Spring |
| 29C6-85 | 1 | 0 | Adaptor For Bushing |
| 34C10-155 | 1 | 1 | Spring For 6" Post |
| 34C10-156 | 1 | 1 | Spring For 8" Post |
| 34C10-157 | 1 | 1 | Spring For 11-1/2" Post |
| 50C11-30 | 0 | 1 | Cable Clamp |
| 52C5-155 | 1 | 1 | Level Base |
| 52C5-182 | 1 | 1 | Base Plate |
| 55C4-95 | 0 | 1 | Spacer For Heating Element |
| 62C1-170 | 1 | 1 | Handle Bracket |
| 62C16-172 | 1 | 0 | Lower Guide Bracket |
| 62C16-234 | 1 | 1 | Lower Guide Bracket |
| 70C4-30 | 1 | 1 | Locator Guide |
| 71C3-39 | 2 | 2 | Spring Retainer |
| 73C7-123 | 0 | 1 | 8" Tube For Lead Wire |
| 73C7-124 | 0 | 1 | 6" Tube For Lead Wire |
| 73C7-125 | 0 | 1 | 11-1/2" Tube For Lead Wire |
| 79C12-265 | 1 | 1 | 6" Drill Size Decal |
| 79C12-266 | 1 | 1 | 8" Drill Size Decal |
| 79C12-267 | 1 | 1 | 11-1/2" Drill Size Decal |
| 83C4-14 | 1 | 1 | Level Flange |
| 83C4-16 | 1 | 1 | Flange For Post |
| 90C6-45 | 1 | 1 | Spindle Ball Bearing |
| 92C2-12 | 1 | 1 | Spindle 6" and 8" |
| 92C2-13 | 1 | 1 | Spindle 11-1/2" |
| 127C1-6 | 0 | 1 | Heat Element 110V. |
| 127C1-7 | 0 | 1 | Heat Element 220V. |
| 141C1-40 | 1 | 1 | Gauge |
| 142C1-18 | 1 | 1 | Key For Driver |
| 142C1-19 | 1 | 1 | Key For Handle |
| 189C1-19 | 1 | 1 | 8" Post |
| 189C1-20 | 1 | 1 | 6" Post |
| 189C1-21 | 1 | 1 | 11-1/2" Post |
| 200C1-10 | 1 | 1 | Driver Only |
| 229C1-5 | 1 | 1 | Chuck |
| 237C1 | 1 | 1 | Bullseye Vial |
| 300C10-2 | 0 | 1 | Screw, 6-32 x 1/4 Round Head |
| 300C10-3 | 3 | 3 | Screw, 6-32 x 5/16 Round Head |
| 300C10-4 | 2 | 2 | Screw, 6-32 x 3/8 Round Head |
| 301C12-9 | 0 | 1 | Screw, 8-32 x 1/4 Fillister Hd. (Stainless Steel) |
| 302C12-13 | 4 | 4 | Screw, 8-32 x 3/8 Flat Head |
| 302C10-7 | 2 | 0 | Screw, 6-32 x 5/8 Flat Head |
| 302C12-12 | 0 | 2 | Screw, 8-32 x 1 Flat Head |
| 302C14-6 | 3 | 3 | Screw, 10-24 x 5/16 Flat Head |
| 305C10-2 | 1 | 1 | Screw No. 6 x 1/4 Phillips; Self Tapping, Binding Hd. |
| 531C1-48 | 1 | 1 | Machine Handle |
| 728C1-6 | 0 | 1 | Guide Heat Bracket |
| 797C1-1 | 1 | 1 | Key for Chuck and Holder |
| 802C1 | 1 | 1 | Driver With Key |

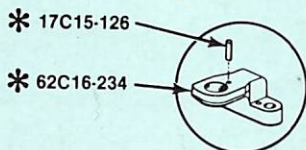

* PARTS OPTIONAL ON CD3 & CDL ONLY
For selecting bushing size
see chart on page 3.
21C13-59 Bushing
21C13-63 Bushing

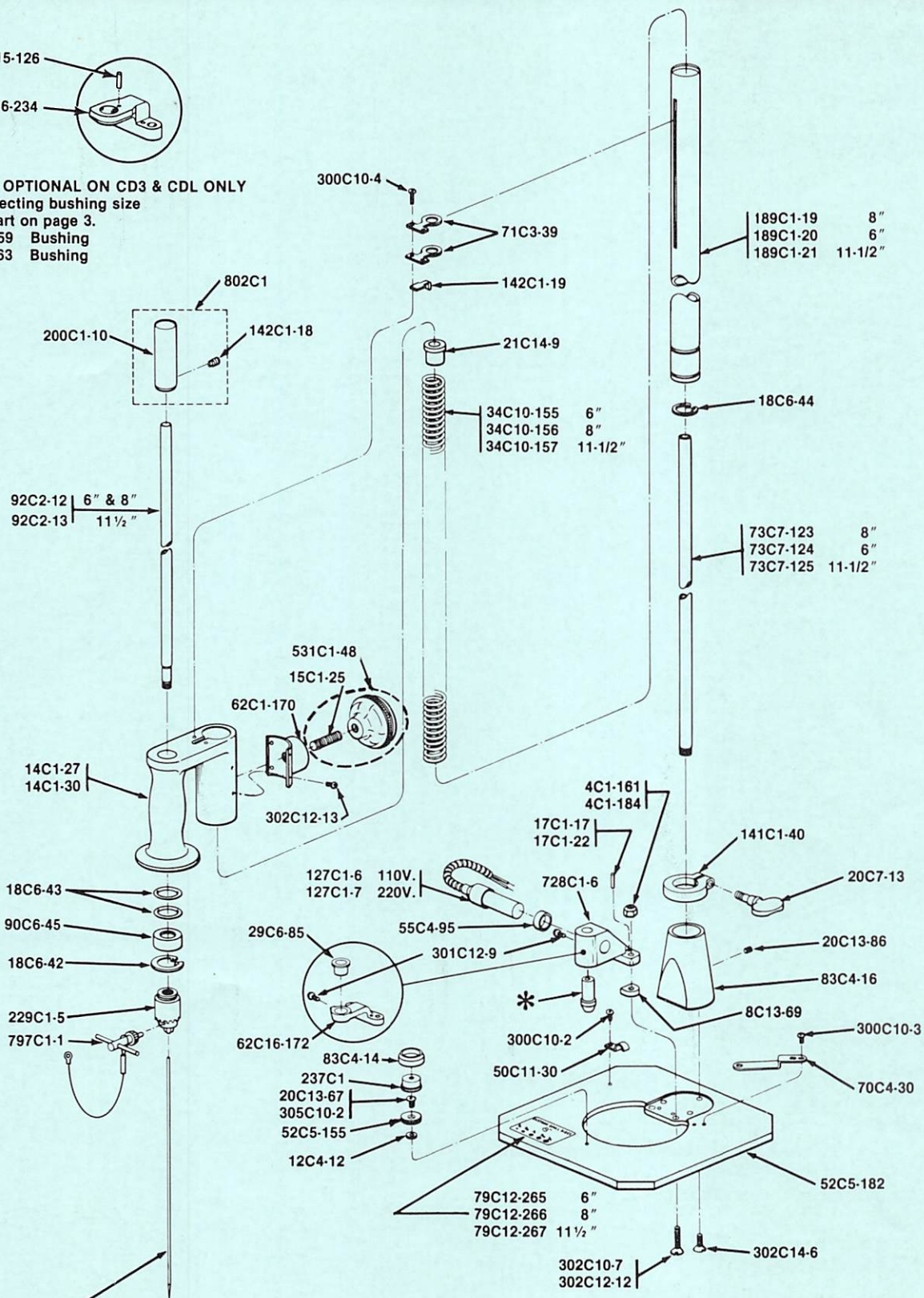

* SEE PAGE 3
FOR DRILL OR AWL SELECTION TABLE
AND DRILL GUIDE BUSHING TABLE

Eastmanmachine
COMPANY

EASTMAN

Cloth Drill

Model CDL and CDLH

Illustrated Parts List

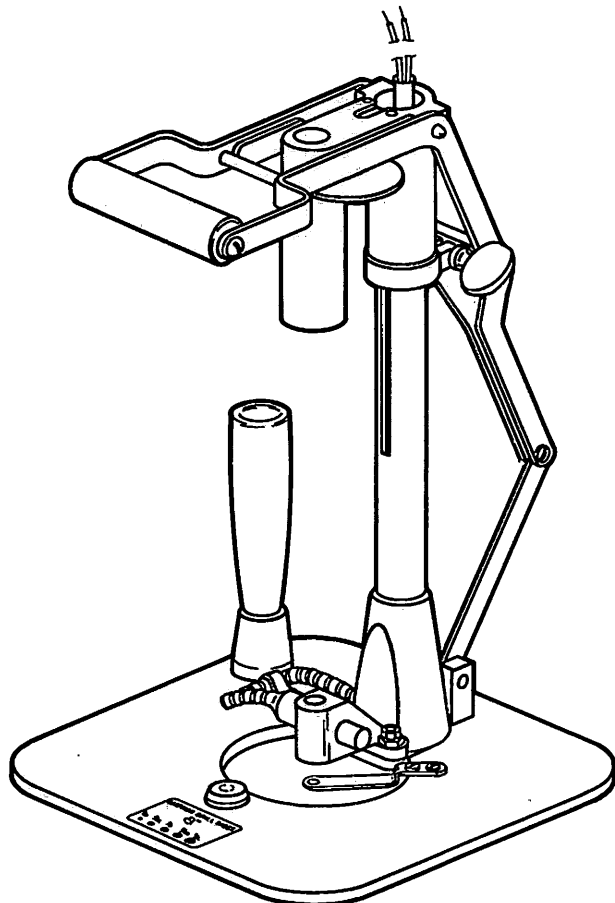

Standard, and Base Plate Assembly

NOTE: Please specify model and serial number of machine when ordering parts.

| Part Number | No. Req'd. | Description |
|-------------|------------|--------------------|
| | | |
| 4C1-149 | 3 3 | Elastic Stop Nut |
| 4C1-181 | 2 0 | Flex Nut |
| 4C1-184 | 0 2 | Elastic Stop Nut |
| 4C2-110 | 1 1 | Elastic Stop Nut |
| 8C13-69 | 0 1 | Heat Insulator |
| 12C1-21 | 6 6 | Lock Washer |
| 12C4-12 | 0 1 | Nylon Washer |
| 14C1-32 | 1 1 | Operating Handle |
| 14C1-34 | 1 1 | Handle Grip w/Lugs |

| Part Number | No. Req'd. | Description |
|-------------|------------|---|
| | | |
| 15C1-30 | 1 1 | Stud For Handle |
| 17C1-17 | 1 0 | Dowel Pin |
| 17C1-22 | 0 1 | Dowel Pin |
| 17C5-17 | 2 2 | Pivot Point |
| 17C15-116 | 1 1 | Roll Pin |
| 17C15-128 | 1 1 | Dowel Pin |
| 18C6-42 | 1 1 | Retaining Ring |
| 18C6-43 | 2 2 | Rubber "O" Ring |
| 18C6-44 | 1 1 | Retaining Ring |
| 20C7-13 | 1 1 | Thumb Screw |
| 20C12-143 | 1 1 | Pivot Screw 6" & 8" Drills |
| 20C13-67 | 0 1 | Screw, 6-32 x 5/16 Round Head Nylon |
| 20C13-86 | 2 2 | Set Screw |
| 21C14-9 | 1 1 | Bushing For Spring |
| 22C3-8 | 1 1 | Tapered Handle |
| 28C6-85 | 1 0 | Adaptor For Bushing |
| 34C10-155 | 1 1 | Spring 6" Drill |
| 34C10-156 | 1 1 | Spring 8" Drill |
| 34C10-157 | 1 1 | Spring 11 1/2" Drill |
| 46C3-21 | 1 1 | Block For Link |
| 50C11-30 | 0 1 | Cable Clamp |
| 52C5-155 | 1 1 | Level Base |
| 52C5-191 | 1 1 | Base |
| 55C4-95 | 0 1 | Spacer For Heating Element |
| 55C4-105 | 2 2 | Spacer Lever Handle |
| 62C16-172 | 1 0 | Lower Guide Bracket |
| 62C16-234 | 1 0 | Lower Guide Bracket |
| 70C4-30 | 1 1 | Locator Guide |
| 71C3-39 | 2 2 | Spring Retainer |
| 73C7-123 | 1 1 | 8" Tube For Lead Wire |
| 73C7-124 | 1 1 | 6" Tube For Lead Wire |
| 73C7-125 | 1 1 | 11 1/2" Tube For Lead Wire |
| 77C7-24 | 1 1 | 8" Link |
| 77C7-25 | 1 1 | 6" Link |
| 77C7-26 | 1 1 | 11 1/2" Link |
| 79C12-265 | 1 1 | 6" Drill-Size Decal |
| 79C12-266 | 1 1 | 8" Drill-Size Decal |
| 79C12-267 | 1 1 | 11 1/2" Drill-Size Decal |
| 83C4-14 | 1 1 | Level Flange |
| 83C4-16 | 1 1 | Flange For Post |
| 83C4-20 | 1 1 | Flange For Handle |
| 90C8-45 | 1 1 | Spring Ball Bearing |
| 92C2-12 | 1 1 | 6" & 8"—Spindle |
| 92C2-13 | 1 1 | 11 1/2"—Spindle |
| 127C1-6 | 0 1 | 110V Heating Element |
| 127C1-7 | 0 1 | 220V Heating Element |
| 141C1-40 | 1 1 | Gauge |
| 142C1-18 | 1 1 | Key For Driver |
| 142C1-19 | 1 1 | Key For Handle |
| 147C1-37 | 1 1 | 11 1/2" Extension For Handle Lever |
| 189C1-19 | 1 1 | 8" Post |
| 189C1-20 | 1 1 | 6" Post |
| 189C1-21 | 1 1 | 11 1/2" Post |
| 200C1-10 | 1 1 | Driver Only |
| 229C1-5 | 1 1 | Chuck |
| 237C1 | 1 1 | Bullseye Vial |
| 300C10-2 | 1 1 | Screw, 6-32 x 1/4 Round Head |
| 300C10-3 | 3 3 | Screw, 6-32 x 5/16 Round Head |
| 300C10-4 | 2 2 | Screw, 6-32 x 3/8 Round Head |
| 300C12-3 | 6 6 | Screw, 8-32 x 3/8 Round Head |
| 300C15-4 | 1 1 | Screw, 10-32 x 1/2 Round Head 11 1/2" Only |
| 300C15-7 | 2 2 | Screw, 10-32 x 5/8 Round Head |
| 301C12-9 | 1 1 | Screw, 8-32 x 9/16 Fillister Head (Stainless Steel) |
| 302C10-7 | 2 2 | Screw 6-32 x 5/8 Flat Head |
| 302C12-12 | 2 2 | Screw, 8-32 x 1" Flat Head |
| 302C14-6 | 3 3 | Screw, 10-32 x 5/16 Flat Head |
| 302C15-4 | 4 4 | Screw, 10-24 x 5/8 Flat Head |
| 305C10-2 | 1 1 | Screw No. 6 x 1/4 Phillips |
| 309C12-2 | 2 2 | Screw, 8-32 x 5/16 Socket Set Screw |
| 728C1-8 | 1 1 | Guide Heat Bracket |
| 787C1-1 | 1 1 | Key for Chuck and Holder |
| 802C1 | 1 1 | Driver with Key |
| 808C1-1 | 1 1 | L.H. Handle Lever Assembly 8" Drill |
| 808C1-2 | 1 1 | R.H. Handle Lever Assembly 8" Drill |
| 808C1-3 | 1 1 | L.H. Handle Lever Assembly 6" Drill |
| 808C1-4 | 1 1 | R.H. Handle Lever Assembly 6" Drill |
| 808C1-5 | 1 1 | L.H. Handle Lever Assembly 11 1/2" Drill |
| 808C1-6 | 1 1 | R.H. Handle Lever Assembly 11 1/2" Drill |

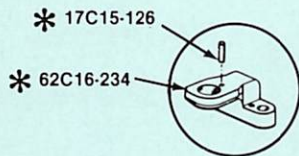

* PARTS OPTIONAL ON CD3 & CDL ONLY
For selecting bushing size
see chart on page 3.
21C13-59 Bushing
21C13-63 Bushing

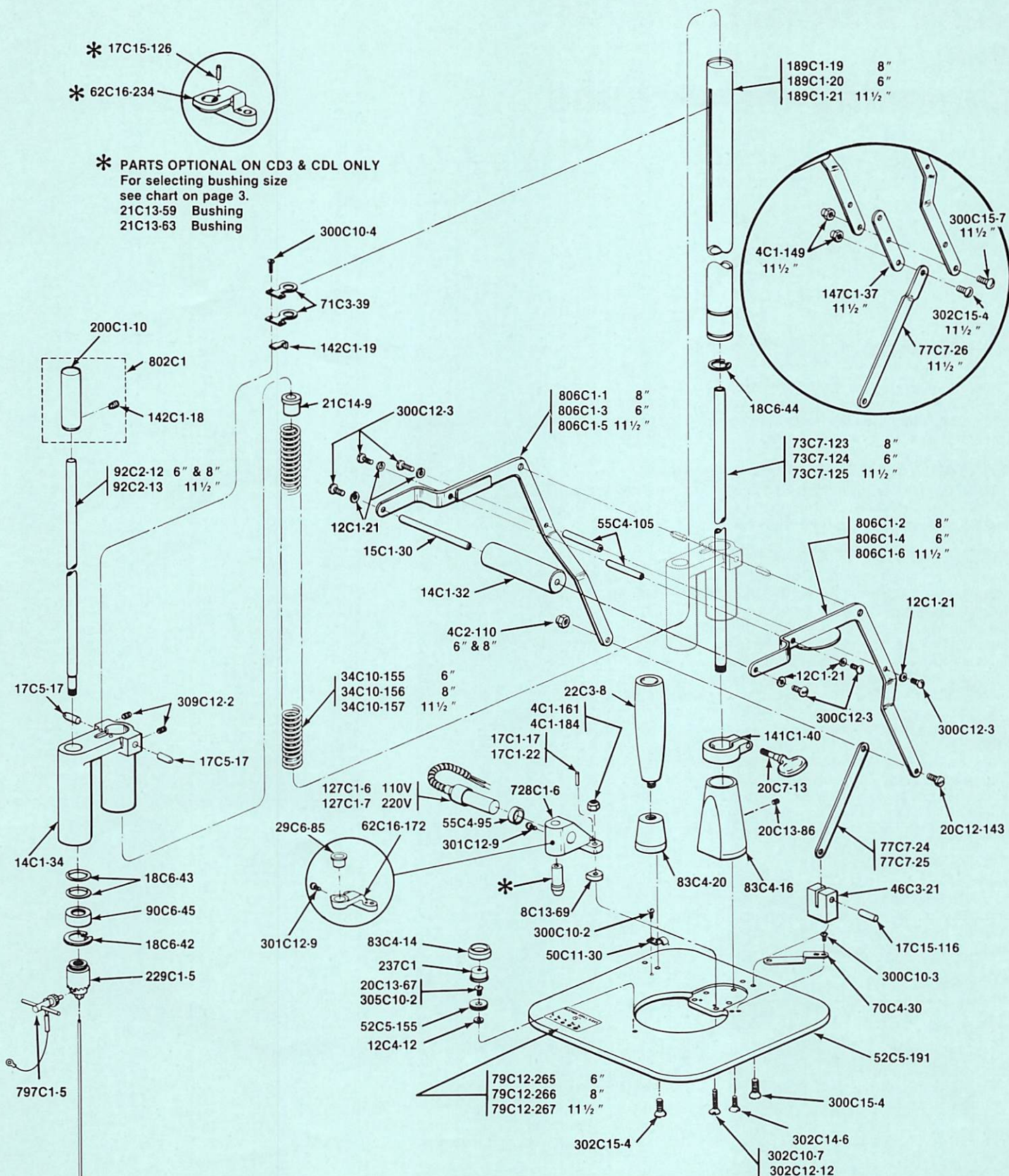

* SEE PAGE 3
FOR DRILL OR AWL SELECTION TABLE
AND DRILL GUIDE BUSHING TABLE

Eastman machine
COMPANY

EASTMAN

Threadmarker

Model LTM

Operating Instructions

Care And Operation

The threadmarking machines are intended to be used for marking pockets, etc., on lays of material such as woolens where the electric drilling machines are not practicable due to the holes closing immediately after the drill is removed.

THREADING THE MACHINE

Thread from spool through thread eye "C" to the thread hole "D" in the rear of the thread cutter; then to the needle eye "H". Thread needle from the spool side of the machine.

OPERATION OF THE MACHINE

After the material has been cut and marked with chalk, slide the front beveled portion "F" on the threadmarker beneath the lay. Press looper locking latch (located on opposite side) down to set the looper. The operation of setting the looper must be performed before every needle stroke. Pull handle "B" down until stop "J" makes contact with the threadmarker housing. This action releases the looper contained in the base of the machine. By slowly retracting the needle a loop is formed and caught by the looper. The end of the thread is held firmly by the looper and as the machine is withdrawn from the lay, about fifteen to eighteen inches of thread should be stripped from the spool and cut off with the thread cutter "E". This operation is continued until all marked positions have been completed. Each layer of cloth is clipped with shears between each layer, the operator leaving about $\frac{3}{4}$ to 1 inch of thread in each layer of cloth. If the thread is clipped too short, it may fall out in subsequent handling.

TO REMOVE NEEDLE

Remove knurled cap "A" from top of machine—turn counter-clockwise to remove. Lift needle rod and needle assembly clear from the machine. Loosen bottom set screw and remove the needle from rod. When replacing needle and re-assembling needle rod in machine, refer to instruction sheet #672C1-110.

OILING

Oil rod and tube at "G" twice a week.

THREAD

It is suggested that a good grade of button hole gimp be used. It can readily be understood that, if the thread is too weak, forcing the needle through such a great thickness of material will result in thread breakage.

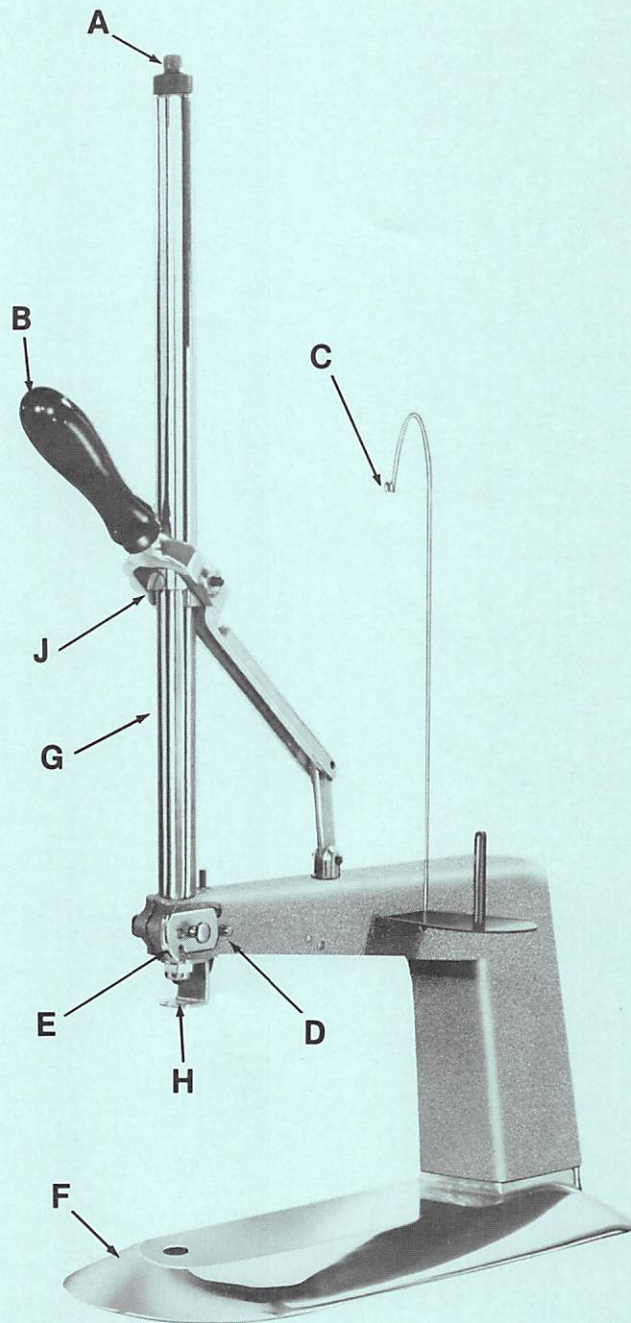

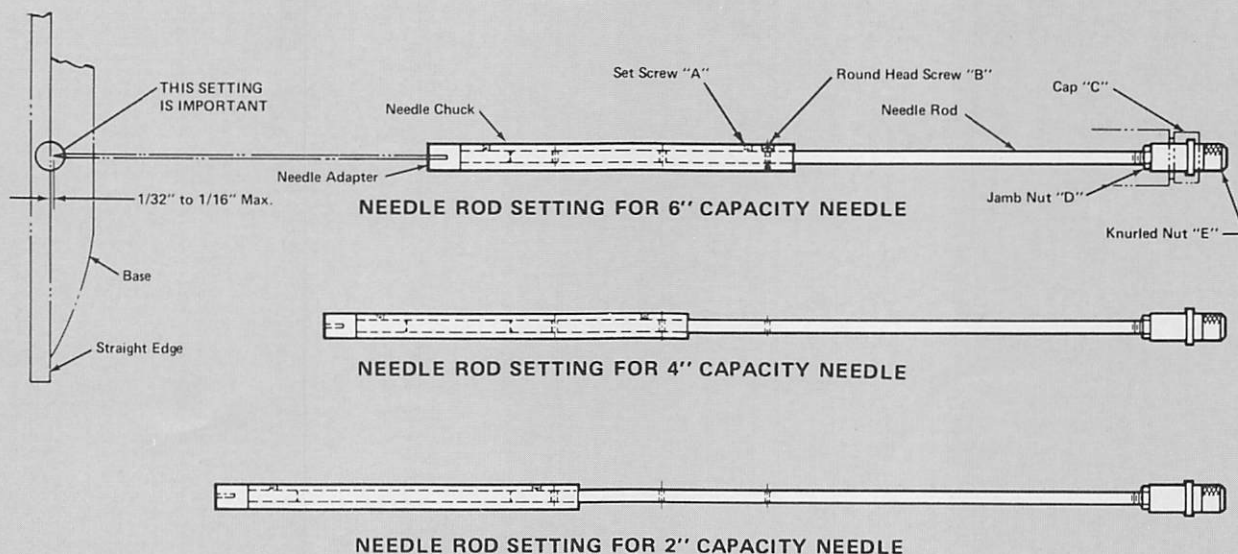

SETTING ADJUSTABLE NEEDLE ROD

TO CHANGE THE SETTING, loosen Allen Set Screw "A" and remove Round Head Screw "B". Then slide the Needle Chuck to the correct new setting for the Needle you wish to install; replace Round Head Screw "B" and tighten Allen Set Screw "A".

CHECK LENGTH OF NEEDLE AFTER ASSEMBLY IN THREADMARKER. Due to slight variations in lengths of some Needles, it may be necessary to make a finer adjustment of the length of the Needle Rod. Pull Threadmarker Handle down to its lowest position. Hold Handle in this position and tilt Threadmarker back so that a straight edge can be placed across the bottom of Base where Needle extends thru Base. Needle should come within 1/32" to 1/16" of touching straight edge. If adjustment is necessary remove Cap "C" and remove Needle Rod Assembly. Loosen Jamb Nut "D", turn Knurled Nut "E" to lengthen or shorten as needed. Re-tighten Jamb Nut "D", re-assemble Needle Rod in machine and check again.

WHEN CHANGING TO DIFFERENT DIAMETER NEEDLE, it is necessary to change the Needle Adapter and the Needle Bushing (located in Work Clamp Nut) for best results. See Chart below for Part Numbers. NOTE: Needles are plain Needles without brass head.

Thread for Threadmarker

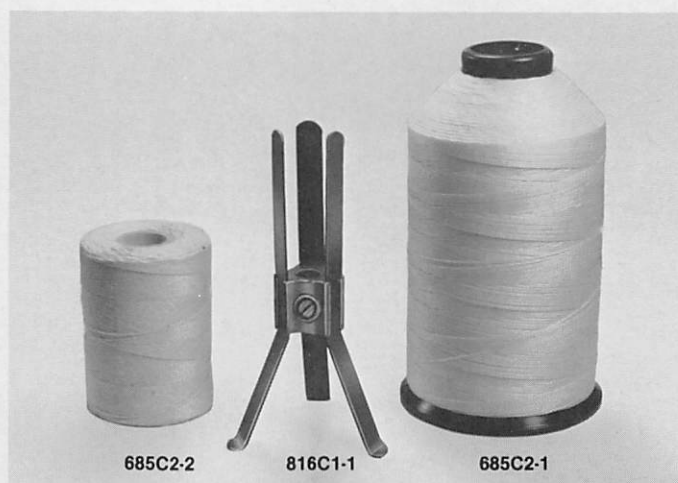

| Part Number | Description |
|-------------|-------------------------------------|
| 685C2-1 | Nylon Thread 8 oz. Spool |
| 685C2-2 | Mercerized 2 oz. Spool |
| 685C2-3 | Glo-Notch Thread |
| 816C1-1 | Thread Spool Holder for 8 oz. Spool |

| Capacity | Needle | Needle Diameter | Bushing | Adapter | Needle Length | Needle Point |
|----------|----------|-----------------|----------|----------|---------------|--------------|
| 6" | 228C1-11 | .078 | 21C13-50 | 29C6-104 | 7-7/8 | Triangular |
| 2" | 228C1-13 | .063 | 21C13-49 | 29C6-103 | 3-5/8 | Taper |
| 4" | 228C1-15 | .063 | 21C13-49 | 29C6-103 | 5-13/16 | Taper |
| 2" | 228C1-16 | .052 | 21C13-48 | 29C6-102 | 3-5/8 | Taper |
| 6" | 228C1-18 | .078 | 21C13-50 | 29C6-104 | 7-7/8 | Taper |

Eastmanmachine
COMPANY

Threadmarker

Model LTM

Illustrated Parts List

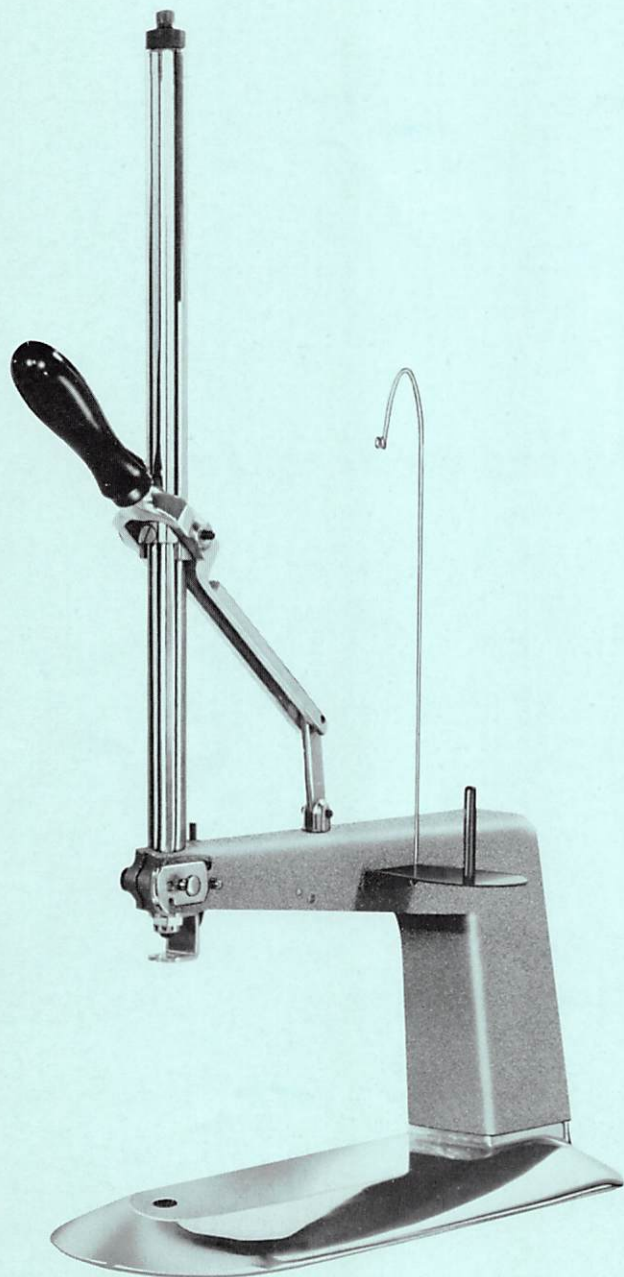

NOTE: Please specify model and serial number of machine when ordering parts.

| Part Number | No. Req'd. | Description |
|-------------|------------|-----------------------------------|
| 4C1-154 | 1 | Needle Rod Jam Nut |
| 4C2-58 | 1 | Nut, Hex 1/4 x 20 |
| 4C2-91 | 1 | Nut, Hex 10-32 |
| 4C2-100 | 1 | Work Clamp Nut |
| 4C2-104 | 1 | Nut, Hex 10-24 |
| 4C3-10 | 1 | Needle Rod Adjusting Nut |
| 12C11-56 | 1 | Washer Spacer |
| 12C15-67 | 2 | Work Clamp Locating Washer |
| 17C15-90 | 2 | Handle Lever Bearing Pin |
| 17C15-106 | 1 | Roll Pin |
| 17C15-109 | 1 | Release Pin |
| 17C15-111 | 1 | Looper Locking Latch Pin |
| 17C15-112 | 1 | Cotter Pin |
| 17C15-116 | 2 | Pivot Pin |
| 18C6-17 | 2 | Snap Ring |
| 20C5-19 | 1 | Clamp Screw, Arm |
| 20C7-1 | 1 | Cover Screw |
| 20C12-118 | 2 | Screw, Allen Set 10-32 x 1/4 |
| 20C12-127 | 1 | Cutter Holder Thread Guide Screw |
| 20C12-132 | 1 | Work Clamp Locating Screw |
| 20C12-134 | 1 | Handle Lever Tube Lock Screw |
| 20C12-144 | 1 | Looper Link Screw |
| 20C13-26 | 4 | Screw, Socket Hd. Cap 5/16-18 x 1 |
| 20C13-52 | 3 | Screw, Allen Set 10-32 x 1/8 |
| 20C13-55 | 1 | Screw, 3-48 x 1/2 Round Head |
| 21C13-26 | 1 | Guide Bushing |
| 33C9-4 | 1 | Cutter Holder |
| 34C8-11 | 1 | Work Clamp Spring |
| 34C10-96 | 1 | Needle Lever Tube Spring |
| 34C10-121 | 1 | Looper Spring |
| 34C10-122 | 1 | Looper Latch Spring |
| 35C7-27 | 1 | Thread Marker Arm |
| 46C3-6 | 1 | Spring Block |
| 50C9-10 | 1 | Work Clamp |
| 53C11-71 | 1 | Cutter Holder Cover |
| 57C4-1 | 1 | Handle Lever |
| 62C16-192 | 1 | Hinge Bracket |
| 65C6-62 | 1 | Needle Rod |
| 65C6-74 | 1 | Latch Rod |
| 73C7-65 | 1 | Slotted Steel Tube |
| 77C7-16 | 1 | Arm and Handle Lever Link |
| 77C7-17 | 1 | Looper Link |
| 79C2-34 | 1 | Number Plate |
| 79C12-184 | 1 | Needle Plate |
| 80C13-11 | 1 | Thread Cutter Knife |
| 86C7-25 | 1 | Cap |
| 97C3-37 | 1 | Looper Locking Latch |
| 98C4-12 | 1 | Looper Assembly Clip |
| 151C1-2 | 1 | Link and Looper Coupling |
| 201C1-5 | 1 | Thread Eye |
| 229C1-3 | 1 | Needle Chuck |
| 300C10-1 | 2 | Screw, 6-32 x 3/16 Round Head |
| 300C10-2 | 2 | Screw, 6-32 x 1/4 Round Head |
| 300C12-3 | 2 | Screw, 8-32 x 3/8 Round Head |
| 301C7-2 | 2 | Screw, 4-36 x 3/16 Fillister Head |
| 301C10-1 | 1 | Screw, 6-32 x 1/4 Fillister Head |
| 301C12-3 | 1 | Screw, 8-32 x 3/8 Fillister Head |
| 301C12-6 | 2 | Screw, 8-32 x 3/4 Fillister Head |
| 301C14-6 | 1 | Screw, 10-24 x 7/8 Fillister Head |
| 302C10-2 | 2 | Screw, 6-32 x 1/4 Flat Head |
| 531C1-53 | 1 | Operating Handle |
| 710C1-1 | 1 | Looper Assembly |
| 720C1-52 | 1 | Work Clamp |
| 763C1-5 | 1 | Work Clamp Tube and Head |
| 763C1-8 | 1 | Handle Lever Tube Assembly |
| 808C1-1 | 1 | Thread Marker Base |
| 816C1 | 1 | Spool Holding Assembly |

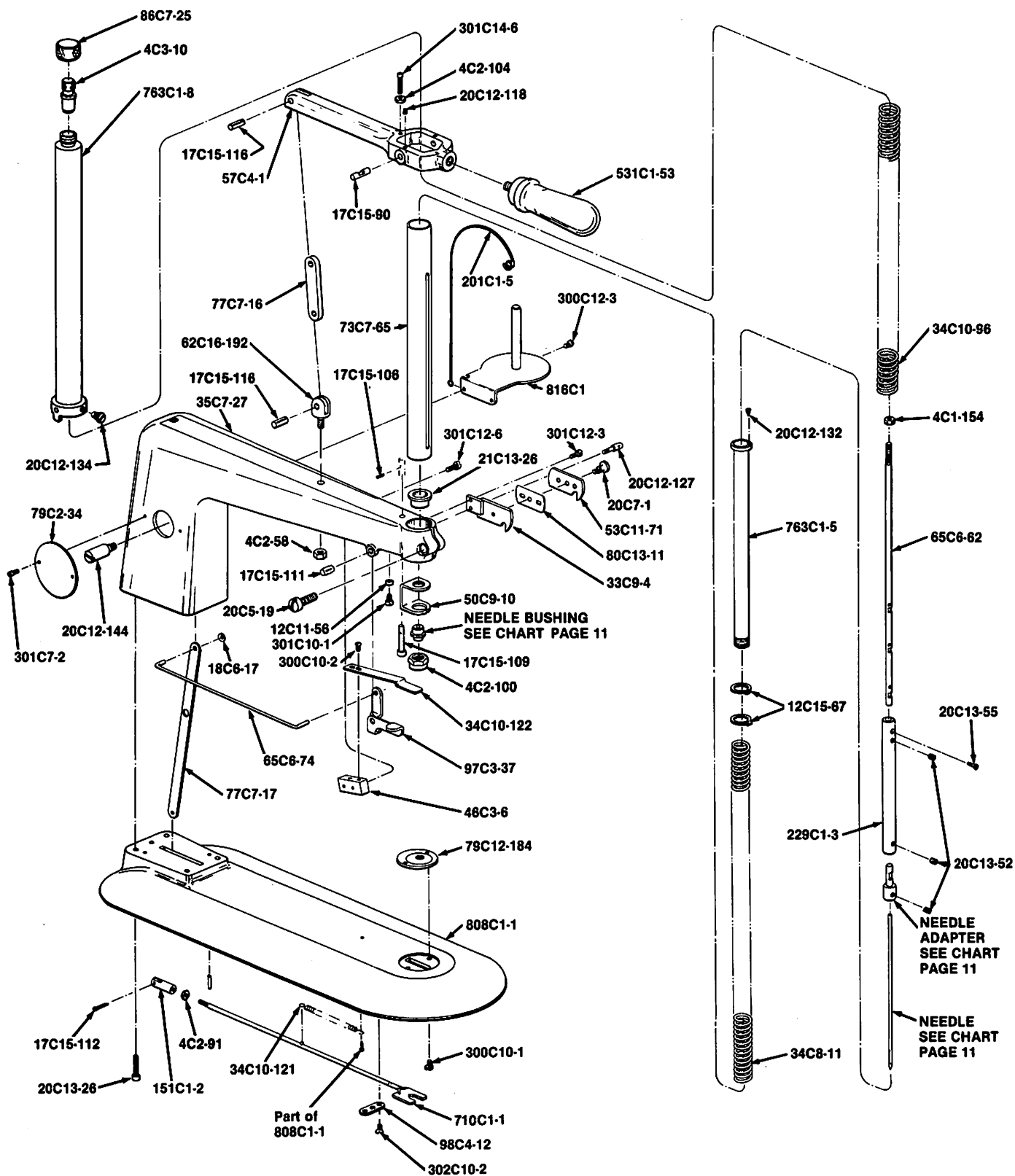

Bottom View



720C1-52
SPECIAL WORK
CLAMP AVAILABLE

Eastmanmachine
COMPANY

EASTMAN Magnum Punch Perforator

Model MP2

Illustrated Parts List



NOTE: Please specify model and serial number of machine when ordering parts.

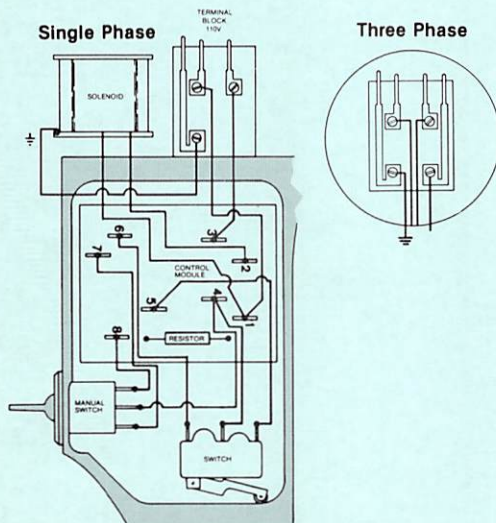

WIRING DIAGRAM

| Part Number | No. Req'd. | Description |
|-------------|--------------|-------------------------------------|
| 4C1-115 | 1 | Locknut Handle |
| 4C2-120 | 1 | Nut, Elastic Stop, Hex. 5/16 x 24 |
| 8C4-74 | 1 | Switch Insulation |
| 8C13-76 | 1 | Housing Insulation |
| 8C13-77 | 1 | Housing Insulation |
| 8C15-1 | 1 | Cover Insulation |
| 12C1-22 | 3 | Lockwasher, Ext. Tooth #6 |
| 12C1-35 | 4 | Lockwasher, Ext. Tooth #8 |
| 12C1-48 | 1 | Lockwasher Int. Tooth 5/16 |
| 12C11-75 | 1 | Spring Washer |
| 12C15-107 | 2 (Optional) | Spacer Washer |
| 17C15-137 | 1 | Wheel Pin |
| 18C6-53 | 1 | O'Ring Style #2-205 |
| 18C6-54 | 1 | Drive Ring 9/16 x 1-1/16 x 1/4 |
| 21C6-2 | 1 | Shoulder Bushing |
| 34C10-164 | 1 | Spring |
| 54C4-65 | 1 | Vent Plug |
| 59C3-123 | 1 | Flat Plate |
| 70C4-24 | 1 | Guide Perforator |
| 70C4-42 | 1 | Guide Wire |
| 73C7-93 | 1 | Tubing Front Bearing |
| 79C1-131 | 1 | Number Plate |
| 90C4-73 | 1 | Plunger Bearing |
| 118C1-4 | 1 | Rod Plunger |
| 133C2-8 | 1 | Wheel with Sprocket |
| 199C1-23 | 8 | Lug Terminal |
| 225C1 | 1 | Punch 1/16 dia. |
| 230C1 | 1 | Drift Punch |
| 234C1-8 | 1 | Resistor (63K 220V) |
| 234C1-9 | 1 | Resistor (30K 110V) |
| 251C2 | 1 | Control Module |
| 300C10-2 | 3 | Screw 6-32 x 1/4 Round Hd. |
| 301C10-8 | 1 | Screw, 6-32 x 1-1/4 Fillister Hd. |
| 300C10-10 | 1 | Screw 6-32 x 1 Round Hd. |
| 301C12-2 | 4 | Set Screw 8-32 x 5/16 Fillister Hd. |
| 302C15-14 | 2 | Screw 10-32 x 7/16 Flat Hd. |
| 305C8-1 | 4 | Screw 4-40 x 1/4 Binding Hd. |
| 306C3 | 2 | Screw 2-56 x 3/8 Pan Hd. |
| 309C12-2 | 1 | Set Screw 8-32 x 5/16 Flat Point |
| 528C4-9 | 1 | Standard and Cover |
| 531C1-13 | 1 | Handle |
| 580C1-101 | 1 | Switch, Paddle 2 Pole |
| 580C1-102 | 1 | Switch, Micro Type 1052 |
| 692C2-11 | 1 | Solenoid 115 Volts 60 Hz. |
| 692C2-12 | 1 | Solenoid 230 Volts 60 Hz. |
| 692C2-13 | 1 | Solenoid 110 Volts 50 Hz. |
| 692C2-14 | 1 | Solenoid 220 Volts 50 Hz. |
| 783C13 | 1 | Ground Wire Assy. |

European Plug

| | | |
|-----------|---|-------------------------------------|
| 8C13-74 | 1 | Insulation, Terminal Block |
| 29C6-67 | 1 | Adapter Plate |
| 302C15-8 | 2 | Screw 10-32 x 1-3/8 Fillister Hd. |
| 301C15-12 | 2 | Screw 10-32 x 1-1/8 Fillister Hd. |
| 302C8-1 | 2 | Screw 4-40 x 3/8 Flat Hd. |
| 508C1-94 | 1 | Terminal Block European (Male Plug) |
| 509C1-59 | 1 | Terminal Block Adapter |
| 523C1-95 | 1 | 90° Angle Attachment Plug |

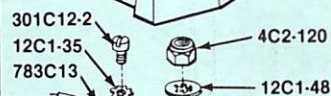
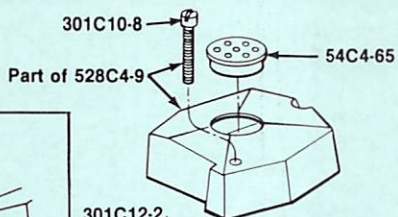
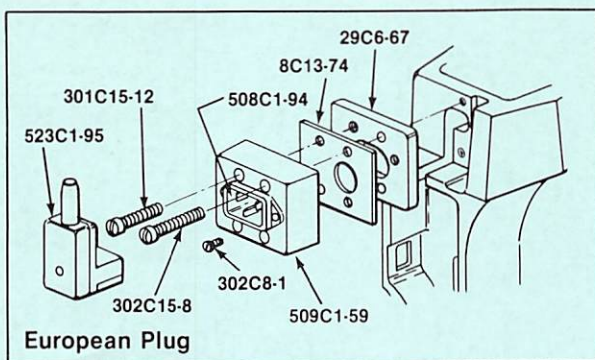

| | |
|----------|------------------|
| 692C2-11 | 115 Volts 60 Hz. |
| 692C2-12 | 230 Volts 60 Hz. |
| 692C2-13 | 110 Volts 50 Hz. |
| 692C2-14 | 220 Volts 50 Hz. |

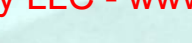
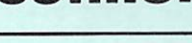
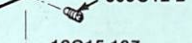
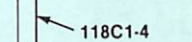
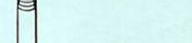
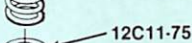
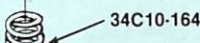
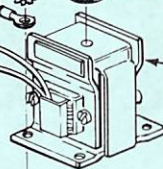

**Attachment Plug
Terminal Block**
Refer to Back Cover
For Detailed Parts List

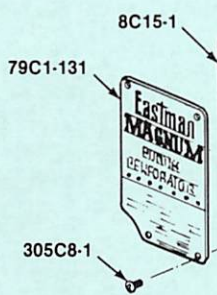
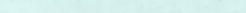
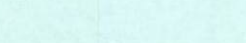
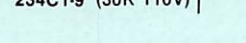
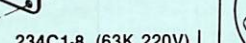
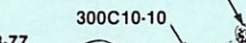
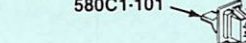
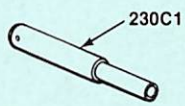

**Eastmanmachine
COMPANY**

EASTMAN

Magnum Punch Perforator

Model MP2

Operating Instructions

PREPARATION

Select the proper pattern paper. We recommend 40 to 50 pound kraft paper measuring .005" to .006" thick. If thicker paper is to be used, the Perforator will have to be adjusted for increased power—see Power Adjustment below.

Do not use oiled paper, as it will clog the punch and the perforating powder will stick to the paper and eventually close up the perforated holes.

To prepare the operating surface for perforating, we recommend Rubber Pad (191C1-36) placed on a solid, perfectly flat and smooth table top. Replace the Rubber Pad periodically to insure a clear surface for clean cut perforations.

WARNING:

Before operating your Perforator, make sure that your electrical current is the same as indicated on the perforating machine. Disconnect from power source before servicing.

OPERATION

Your Perforator is ready to go as soon as you connect the attachment plug; it does not have an "on—off" switch. It will start perforating instantly as you move it forward or backward over the table top.

To push the Perforator into position to start perforating, press the Free-Wheeling Lever "D" up with your index finger.

To start perforating, push the same Lever "D" downward with your index finger and release it. This action will cause the Perforator to make a single punch, or a starting point.

After making the initial punch, push the Perforator forward or backward along the line to be perforated as required. Use the Line Guide "E" to follow the line.

After the pattern has been completely perforated and readied for use by checking to insure that all the perforations are clear, place it on top of the material to be marked and use weights on top of the pattern to prevent it from shifting. Then, using the Pattern Duster, dust the pattern lightly with Pattern Powder. This will leave a line on top of the material ready to be cut. Do not over-dust the pattern, as this will distort the cutting line and make it difficult to follow when cutting.

REPLACING PUNCHES

Your Perforator will make four perforations to the inch. There are various size Punches available for different operations. 1/16" diameter Punch is the standard size furnished with your machine, but 3/32" diameter, Pin Point, and Dash or Spade Punches are available on special order.

To remove a Punch, insert a small Drift in the hole in the Punch, as shown, and tap the Drift lightly until it comes loose.

To install a new Punch, place the Punch on the end of the Plunger Shaft, and place Drift (230C1) over the tip of the Punch. Then gently tap the Drift to seat the Punch on the Plunger Shaft.

If the Punch becomes loose on the Plunger Shaft, remove the Punch and tap it lightly on the side, as shown, to reduce its size and cause it to fit more tightly on the Plunger Shaft.

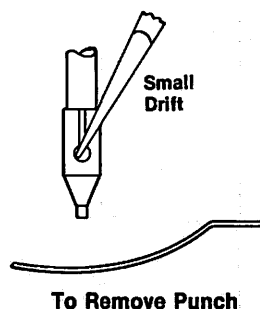
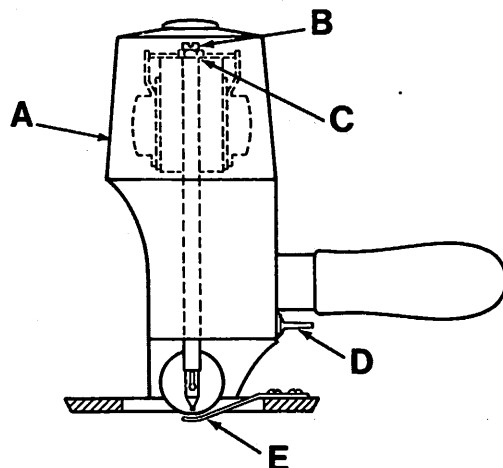

To Remove Punch

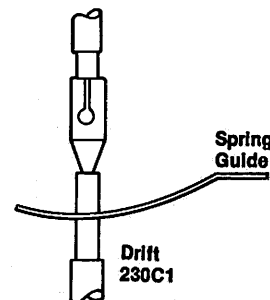

To Reassemble Punch

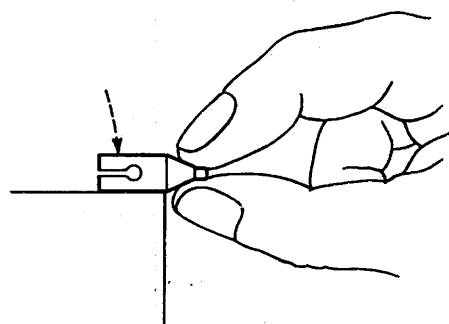

To Tighten Punch

POWER ADJUSTMENT

To increase or decrease power—remove from power source. Remove Machine Cover A. Hold Plunger Shaft B with screwdriver and loosen Nut C. Turn Shaft B clockwise to increase punch power—counterclockwise to decrease power. Tighten Locknut securely and check that required punching depth has been obtained. Replace cover.

OPTIONAL SUPPLIES

- 1 Pattern Duster
- 2 Marking Powder—available in 5 lb. cans or 50 lb. drums in white, red, blue, yellow and black.
- 3 25 Ft. Cord—with attachment plug and male connection.

Hot Notcher

Model HVN

Operating Instructions

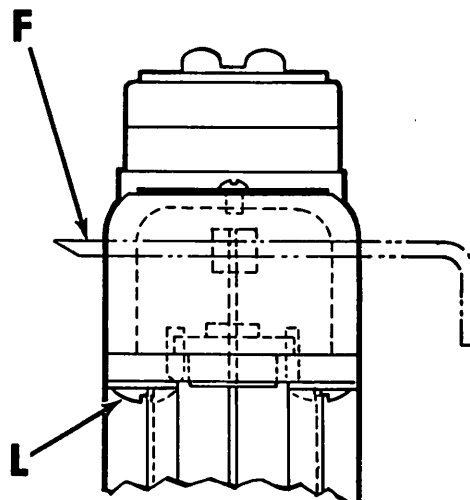
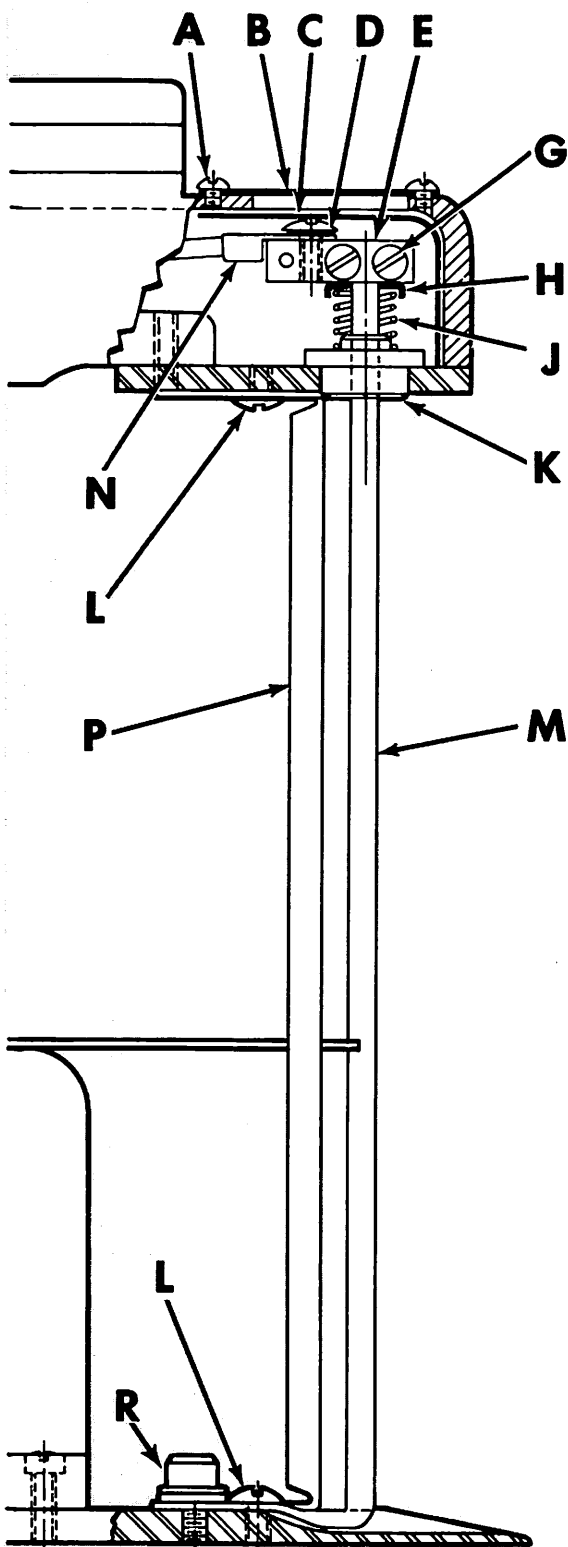

WARNING:

Before performing any of the following procedures, make sure that the attachment plug has been disconnected from power source.

THIS APPLIES TO SERIAL #253 AND ABOVE

FOR CHANGING MARKING WIRE

- 1 Remove two (2) Screws—"A".
- 2 Remove Name Plate—"B".
- 3 Remove Insulation—"C".
- 4 Loosen Screw—"R".
- 5 Disengage Wire "M" from Screw "R".
- 6 Insert Key "F" thru hole in Housing and hole in Block "E". This is to prevent the twisting of the Marking Wire.
- 7 Remove Screw "D" from Block "E", so as to disconnect Wire with Lug "N".
- 8 Remove Key "F" and lift Marking Wire Assembly out of Housing.
- 9 Loosen Screws "G" and remove Wire "M" from Block "E", Washer "H", Spring "J" and Bushing "K".
- 10 Exchange Wire and reverse procedure to completion of assembly.

TO ADJUST DEPTH OF MARK

- 1 Loosen four (4) Screws "L".
- 2 Adjust two (2) Gauges "P" to correct depth.
- 3 Check the squareness of Gauges and retighten four (4) Screws "L".

Eastmanmachine
COMPANY

Hot Notcher

Model HVN

Illustrated Parts List

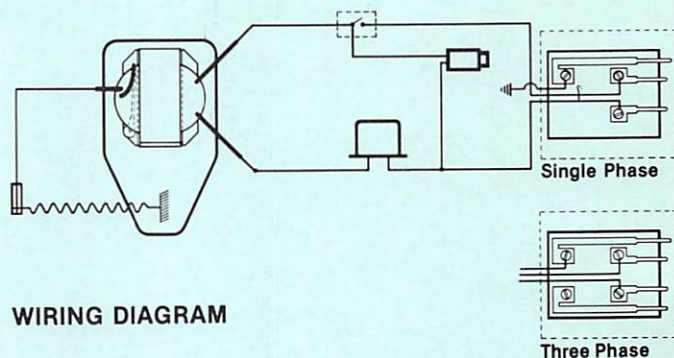
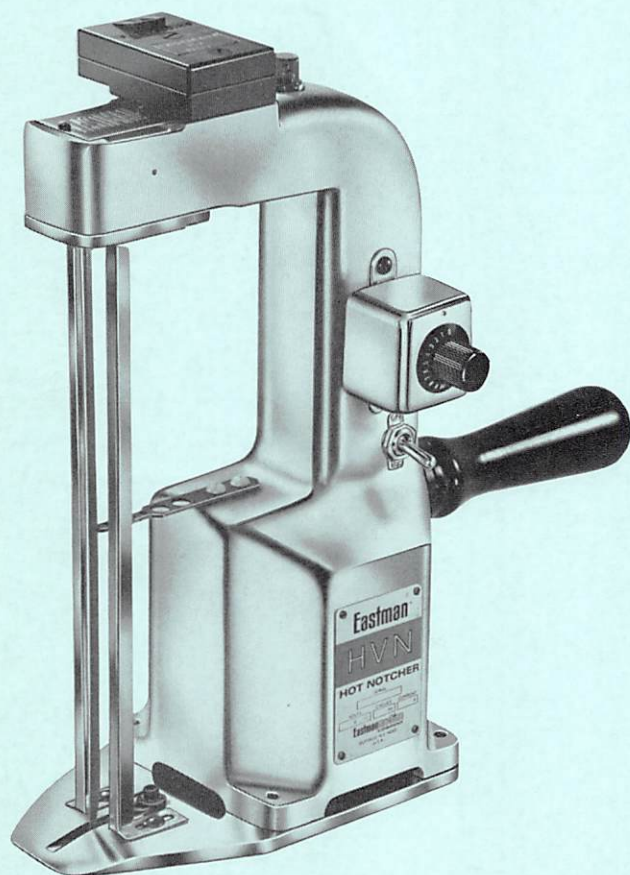

NOTE: Please specify model and serial number of machine when ordering parts.

| Part Number | No. Req'd. | Description |
|-------------|------------|--------------------------------|
| 4C1-111 | 1 | Locknut, Handle |
| 4C2-83 | 2 | Nut Hex 8-32 |
| 4C2-111 | 1 | Nut, Speed |
| 8C13-63 | 1 | Control Block Insulation |
| 8C13-67 | 1 | Marking Wire Insulation |
| 12C1-32 | 1 | Washer, Lock |
| 12C1-34 | 2 | Washer, Lock Switch |
| 12C1-35 | 4 | Washer, Shake Proof |
| 12C1-36 | 2 | Washer, Lock |
| 12C1-37 | 2 | Washer, Lock |
| 12C10-2 | 1 | Washer |
| 12C15-84 | 1 | Washer, Guide Spring |
| 17C15-123 | 1 | Pin, Roll |
| 20C13-14 | 3 | Screw, Cap |
| 20C13-29 | 2 | Screw, Cap |
| 20C13-51 | 4 | Screw, Truss Hd. Stnls |
| 20C13-79 | 2 | Screw, Nylon Round Hd. |
| 21C2-12 | 1 | Wire Insulation Bushing |
| 34C10-132 | 1 | Wire Straightener Spring |
| 46C3-7 | 1 | Block, Contact |
| 48C5-2 | 1 | Marking Wire |
| 62C16-208 | 2 | Bracket Transformer |
| 73C7-104 | 1 | Vinylglas Tubing |
| 73C7-106 | 1 | Shrink Tubing |
| 79C1-154 | 1 | Number Plate |
| 79C2 | 1 | Name Plate |
| 79C12-209 | 1 | Base Plate |
| 79C12-210 | 1 | Plate, Gauge Support |
| 95C5-5 | 1 | Wrench, Allen Hex 7/64 |
| 95C5-6 | 1 | Wrench, Allen Hex 9/64 |
| 98C4-32 | 1 | Clip, Switch |
| 104C1-5 | 1 | Dial Indicator |
| 119C4-27 | 1 | Support, Wire |
| 122C1-13 | 1 | Housing |
| 141C1-39 | 2 | Gauge Bar |
| 142C1-17 | 1 | Key, Contact Block |
| 144C1-10 | 1 | Lamp, Pilot Lite 110V |
| 144C1-11 | 1 | Lamp, Pilot Lite 230V |
| 199C1-16 | 1 | Lug High Heat |
| 199C1-17 | 1 | Lug Cool |
| 251C1-2 | 1 | Control Heat 230V |
| 251C1-3 | 1 | Control Heat 110V |
| 300C7-2 | 6 | Screw 4-36 x 3/16 Round Hd. |
| 300C12-13 | 5 | Screw 8-32 x 5/16 Round Hd. |
| 300C12-15 | 2 | Screw 8-32 x 2-1/4 Round Hd. |
| 301C12-5 | 4 | Screw 8-32 x 5/8 Fillister Hd. |
| 302C12-5 | 4 | Screw 8-32 x 1/2 Flat Hd. |
| 305C10-1 | 1 | Screw 6-32 x 1/4 Binding Hd. |
| 531C1-53 | 1 | Operating Handle, Long |
| 580C1-72 | 1 | Switch |
| 783C13 | 1 | Ground Wire Assy. |
| 819C1-10 | 1 | Transformer 110V 50/60 Hz |
| 819C1-12 | 1 | Transformer 230V 50/60 Hz |



