

Fortuna-SAS⁺



SPARE PARTS

FOR

MODELS C-G-E & F SKIVING MACHINES

Series 100 through 16,000

and 20,000 up

CAMPBELL-RANDALL LEATHER MACHINERY Co.

The World's Finest Leather Machinery



401



TO THE OWNER, OPERATOR OR PURCHASING AGENT

Important Notice.

This catalogue has been printed to enable you to readily identify the various parts on your **FORTUNA** Skiving Machine. In many cases parts are the same for all models. However, in the course of time, our newest models have had some changes made in order to give you the finest skiving machine available.

Therefore, it is of *utmost importance* that you state the *Model* and *Serial Number* of the machine when ordering parts. The older models have the model letter and serial number stamped in the casting of the arm. These machines are of serial numbers up to and including 16,000. Newer models have the model letter and serial number stamped on the **FORTUNA** name plate and range from 20,000 and up.

Numbers prefixed with "20-" denote parts pertaining to machines with Serial Numbers 20,000 and over.

WARNING. When ordering parts give model letter and serial number. Use genuine **FORTUNA** parts only for best results.

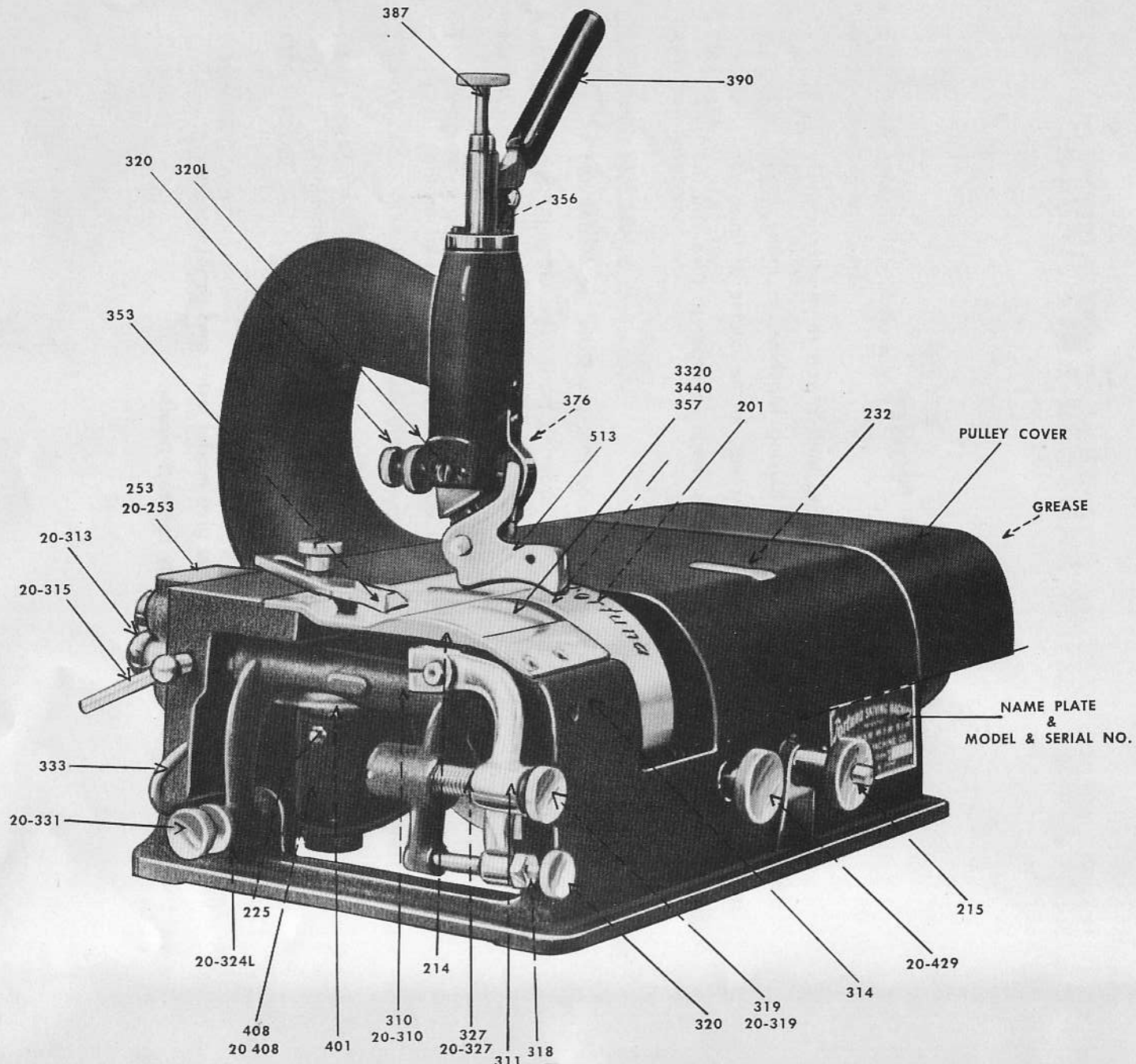

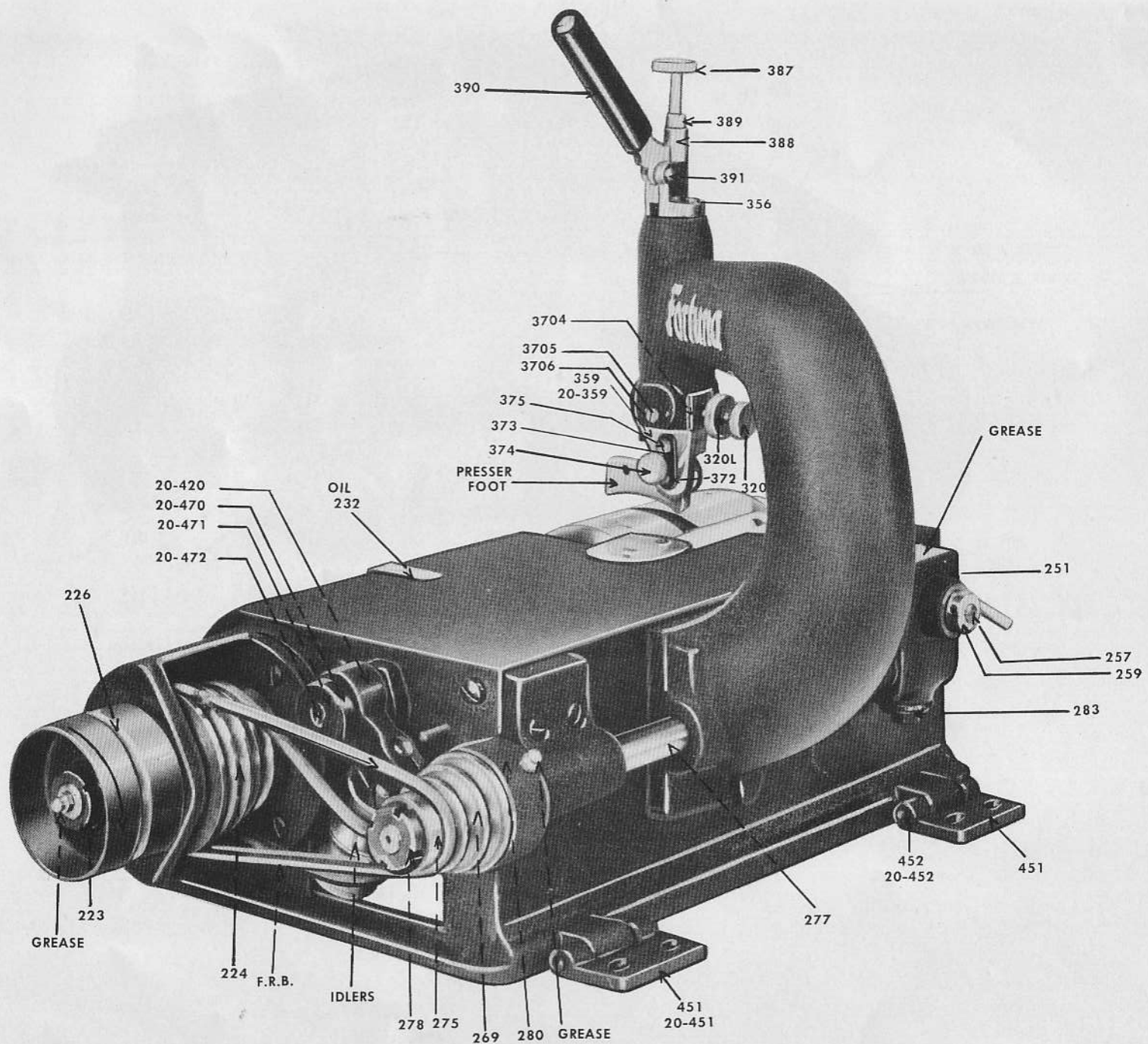

From the library of Merrow Superior - www.supsew.com • www.merrow.com

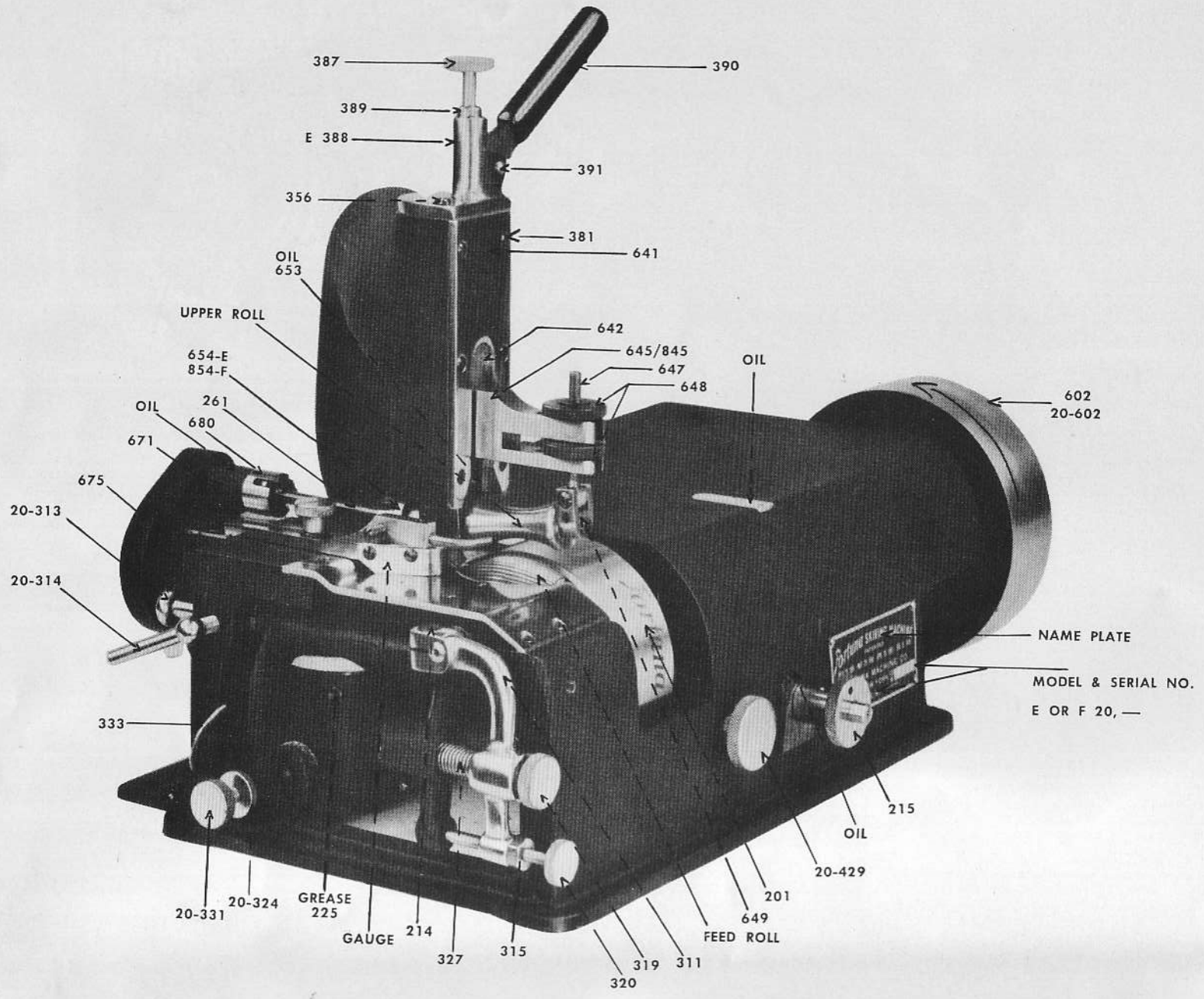

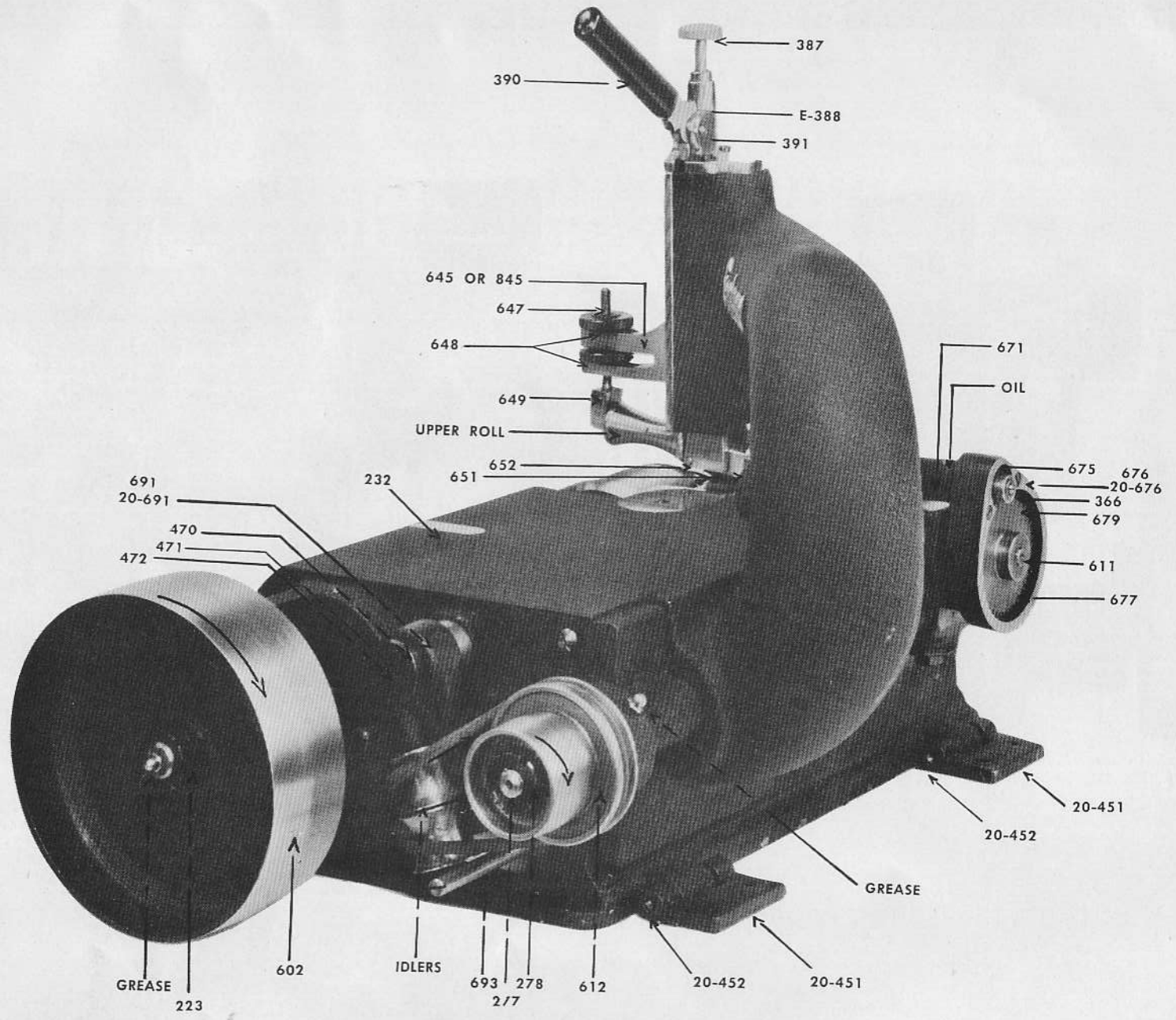

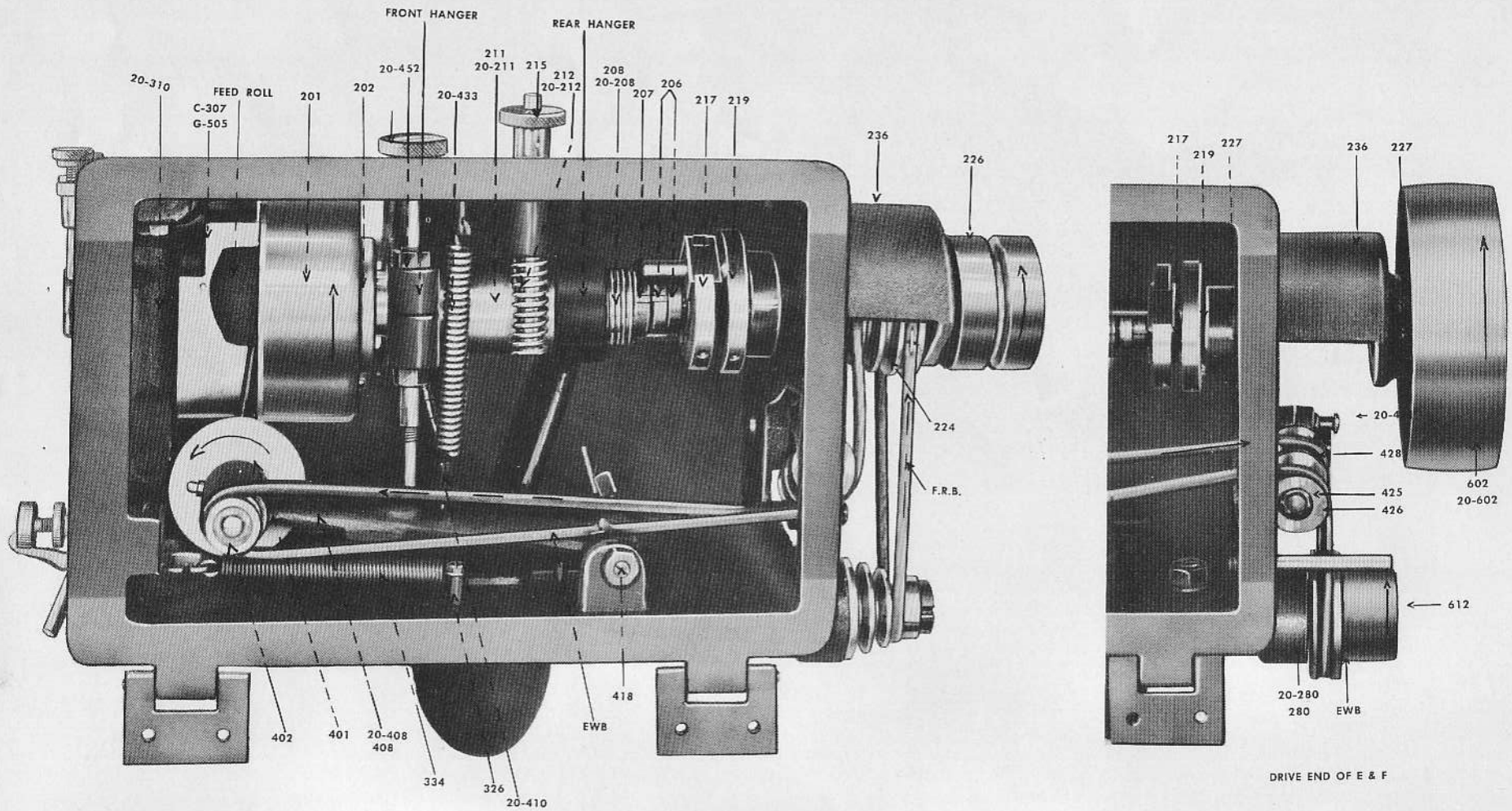

FORTUNA stands ready to help you with any maintenance problem you may have. Please call on us without hesitation.

We have spent over fifty years in bringing you what we believe to be the ultimate in skiving machines. However, over the years, our research and engineering departments have constantly improved the models. If you have an older model why don't you avail yourself of our liberal trade-in allowance so you too may benefit by the progress we have made.

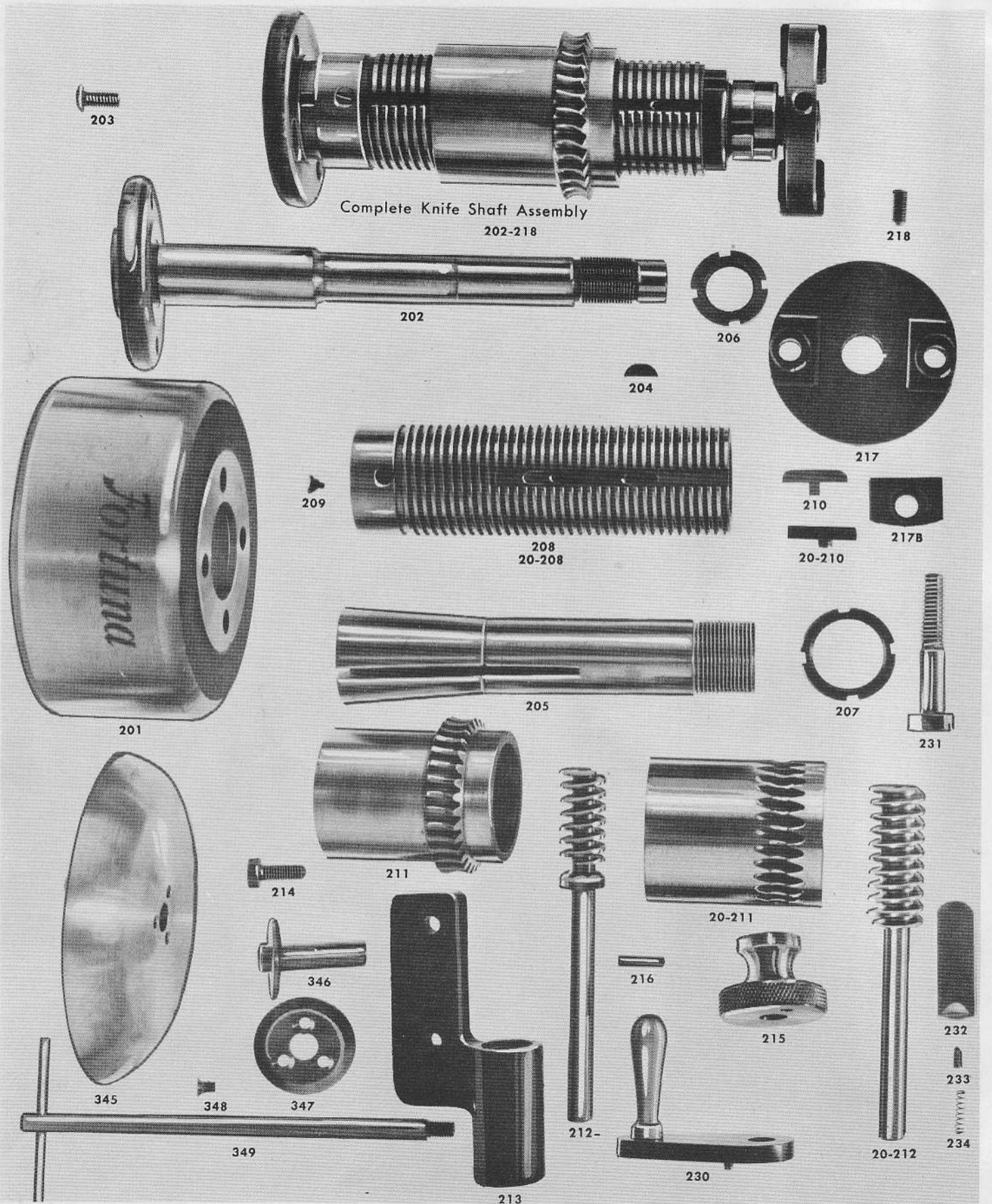

Parts for FORTUNA SKIVING MACHINES

- No. 202-218** Complete Knife Shaft Assembly
- 1 — Knife Shaft
 - 4 — Knife Screws
 - 1 — Knife Shaft Bushing
 - 1 — Worm Sleeve for Knife Shaft Bushing
 - 1 — Set Screw for Sleeve
 - 1 — Worm Sleeve Nut
 - 1 — Adjusting Nut for Bushing
 - 2 — Adjusting Nuts for Shaft
 - 1 — Driving Disc
 - 1 — Key for Shaft
 - 1 — Set Screw for Driving Disc
- No. 201** Knife
- No. 202** Knife Shaft
- No. 203** Knife Screw
- No. 204** Key for End of Knife Shaft
- No. 205** Knife Shaft Bushing
- No. 206** Knife Shaft Adjusting Nut
- No. 207** Knife Shaft Bushing Adjusting Nut
- No. 208** Worm Sleeve for Knife Shaft Bushing (Up to and including 16000 Series)
- No. 20-208** Worm Sleeve for Knife Shaft Bushing (20000 Series and above)
- No. 209** Set Screw for No. 208 and No. 20-208 Worm Sleeve
- No. 210** Key for Worm Sleeve (Up to and including 16000 Series)
- No. 20-210** Key for Worm Sleeve (20000 Series and above)
- No. 211** Worm Nut
- No. 212** Worm Nut Screw
- No. 213** Worm Nut Screw Bracket
- No. 20-211** Worm Nut
- No. 20-212** Worm Nut Screw
- } Up to and Including 16,000 Series
- } 20000 Series and above
- No. 214** Screw for Holding Nos. 213, 236, 251, 280 and 311
- No. 215** Knife Advancing Knob
- No. 216** Taper Pin for No. 215
- No. 217** Knife Shaft Driving Disc with Fibre Bushing
- No. 217B** Bushing for No. 217
- No. 218** Set Screw for 217, 219 and 224
- No. 230** Crank for Advancing and Changing Knife
- No. 231** Binding Bolt to Hold No. 208 (Up to and including 16,000 Series)
See page 6 for Higher Series
- No. 232** Oil Hole Cover
- No. 233** Poppin Pin
- No. 234** Spring for Poppin Pin
- No. 344** Expellor Complete with Adjusting Rod
- No. 345** Shell for Expellor
- No. 346** Holder for Shell
- No. 347** Disc to Hold Shell
- No. 348** Screws (3) to Secure Shell to Holder
- No. 349** Adjusting Rod to Insert Expellor into Knife

CHECK MODEL AND SERIAL NUMBER OF MACHINE BEFORE ORDERING PARTS

PARTS PHOTOS ONE-HALF ACTUAL SIZE

From the library of Merrow Superior - www.supsew.com • www.merrow.com

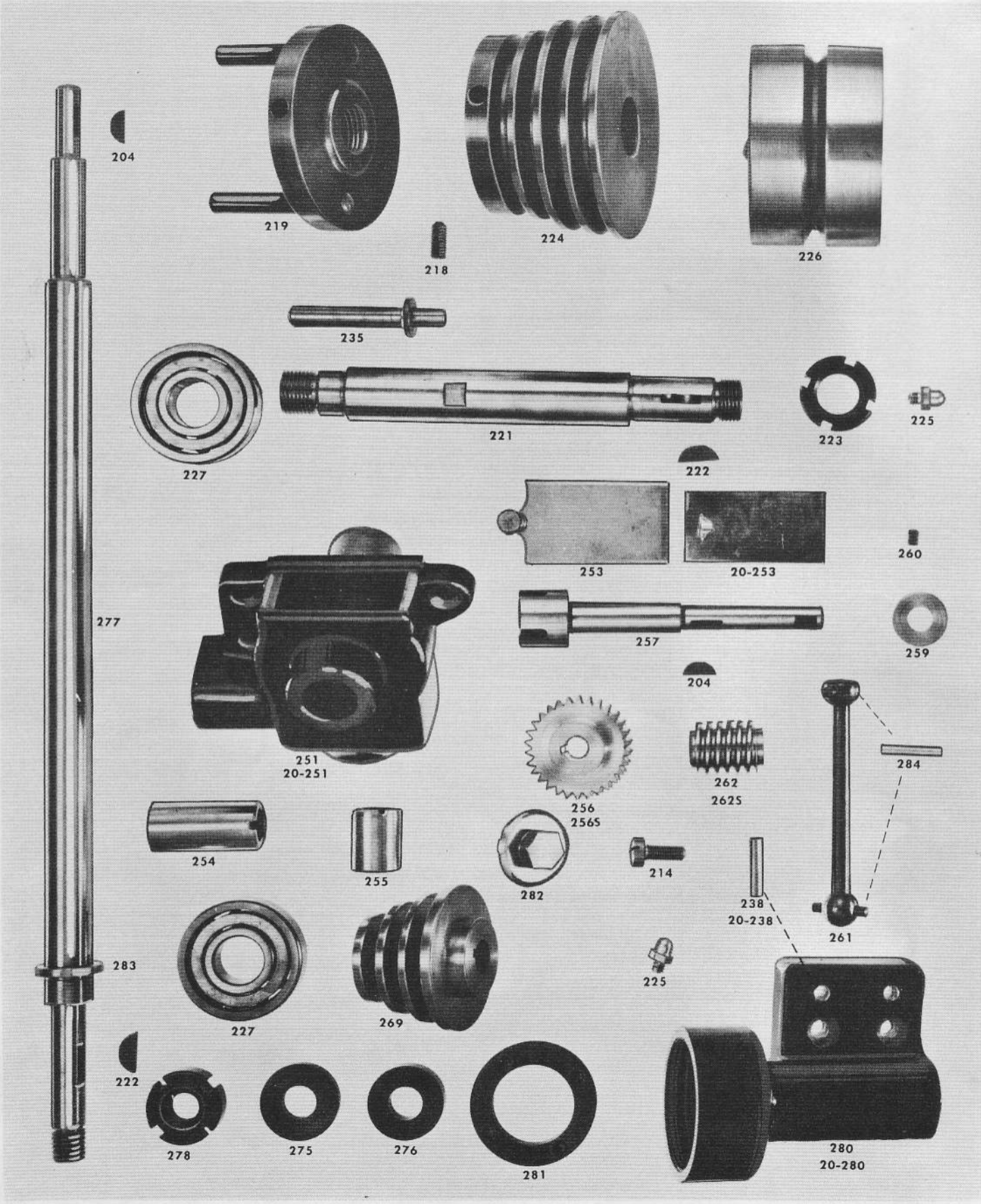

Parts for FORTUNA SKIVING MACHINES

- No. 204 Small Key for No. 277 and No. 257
- No. 214 Screw for Gear Box and Ball Bearing Housing
- No. 218 Set Screw for No. 219 and No. 224
- No. 219 Drive Disc with 2 Pins
- No. 221 Main Drive Shaft for C & G Models
- No. 222 Large Key for No. 221 and No. 227
- No. 223 Nut to Hold No. 226 on No. 221
- No. 224 Large 4 Step Sheave (Pulley) on Main Drive
- No. 225 Grease Fittings
- No. 226 Main Drive Pulley
- No. 226V V Type Main Drive Pulley
- No. 227 Large Size Ball Bearing for Main Drive No. 221 and Feed Shaft No. 277
- No. 251 Gear Box Old Models 16,000 and Below
- No. 253 Gear Box Cover for No. 251
- No. 20-251 Gear Box for New Machines (20,000 Series and up)
- No. 20-253 Gear Box Cover for No. 20-251
- No. 254 Bronze Bushing Large Size for No. 257 and No. 277 Shafts
- No. 255 Bronze Bushing Small Size for No. 257 Small End
- No. 256 Regular Gear
- No. 256S Double Speed Gear (Use 262S Worm with Gear Only)
- No. 257 Collet Shaft for C & G Models
- No. 259 Collar for End of No. 257
- No. 260 Set Screw for No. 259
- No. 261 Universal Bar (for Driving Feed Roll)
- No. 262 Worm for Driving No. 256
- No. 262S Double Speed Worm for Driving No. 256S (Use only No. 256S Gear with this Worm)
- No. 269 Small 3 Step Sheave (Pulley) with Collar for Back Shaft No. 277
- No. 275 Thin Distance Washer for No. 269
- No. 276 Thick Distance Washer for No. 269 (Used with Pulley not having Hub)
- No. 277 Feed Drive Shaft (Back Shaft)
- No. 278 Nut for Holding No. 269 to No. 277
- No. 280 Ball Bearing Housing (Models up to and including 16,000)
- No. 20-280 Ball Bearing Housing (Models 20,000 and above)
- No. 281 Face Nut for Retaining Bearing No. 227 in No. 280 and No. 20-280
- No. 282 Plug for bottom of No. 251 Gear Box
- No. 283 Collar for No. 227 when placed on No. 277
- No. 284 Replacement Pins for No. 261 Universal Bar
- No. 238 Dowel Pins for No. 280
- No. 20-238 Dowel Pins for No. 20-280
- No. 235 Pin for Disc No. 219

CHECK MODEL AND SERIAL NUMBER OF MACHINE BEFORE ORDERING PARTS

PARTS PHOTOS ONE-HALF ACTUAL SIZE

From the library of Merrow Superior - www.supsew.com • www.merrow.com

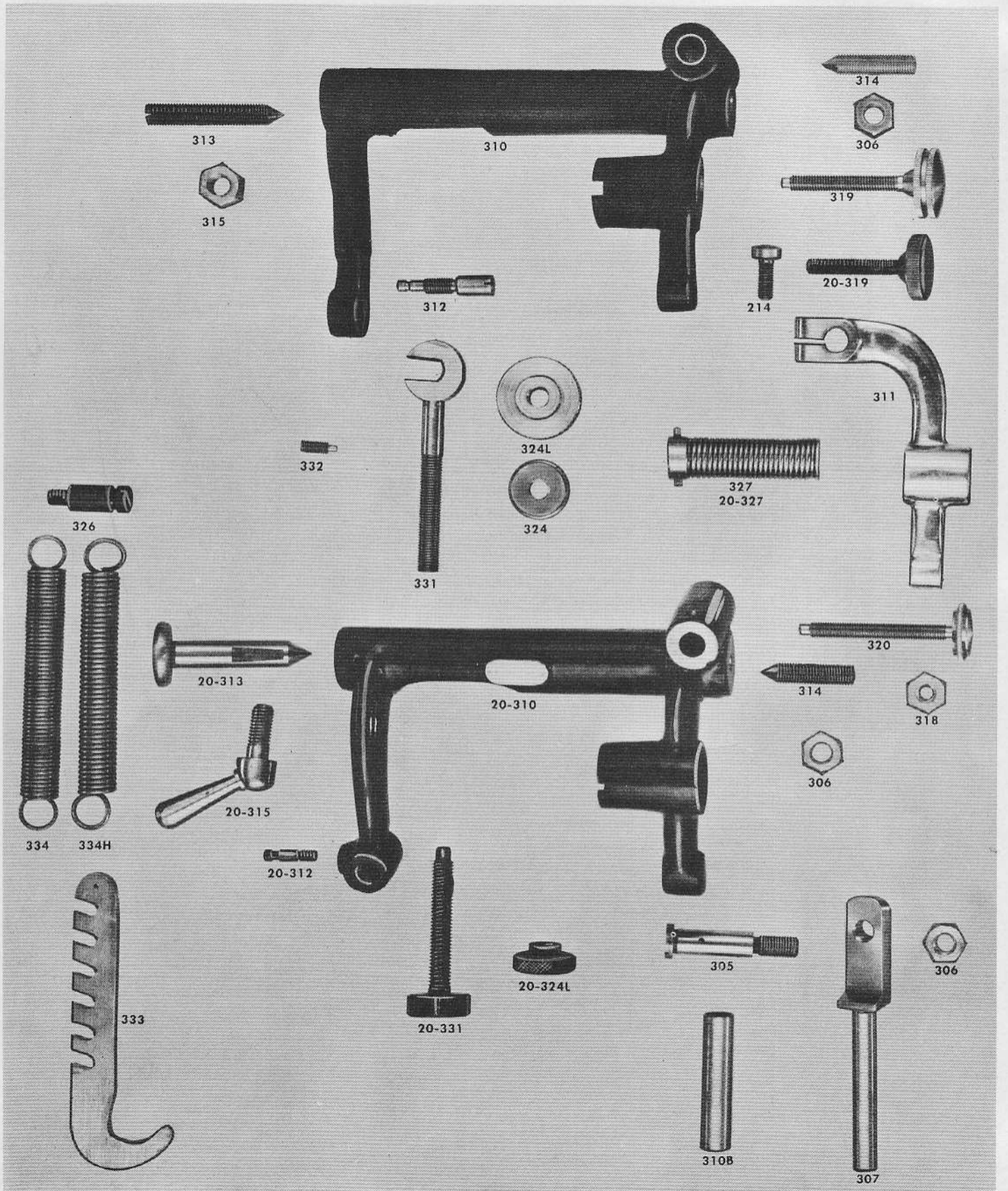

Parts for FORTUNA SKIVING MACHINES

- No. 305 Feed Roll Stud 1 1/4" Roll Size Model C
- No. 306 Lock Nut for No. 305 and No. 314
- No. 307 Feed Roll Holder for 1 1/4" Roll Size Model C
- No. 310 Feed Roll Arm for all models (up to and including Serial Numbers 16,000)
- No. 310B Bushing for Feed Roll Arm No. 310
- No. 311 Feed Roll Holder Control Arm all machines
- No. 214 Screw for top of No. 311
- No. 312 Stud for Spring Rack No. 333
- No. 313 Long Cone Screw for back end of No. 310
- No. 314 Short Cone Screw for front end of No. 310 and No. 20-310
- No. 315 Lock Nut for No. 313
- No. 306 Lock Nut for No. 314 and No. 305
- No. 319 Long Screw for No. 327 Spring (Serial Numbers up to and including 16,000)
- No. 320 Adjusting Screw for No. 311
- No. 318 Lock Nut for No. 320
- No. 324 Regulating Nut for No. 331 (Serial Numbers up to and including 16,000)
- No. 324L Large Lock Nut for No. 331 (Serial Numbers up to and including 16,000)
- No. 326 Stud in Base for Spring No. 334
- No. 327 Spring for Feed Roll Tilt (Serial Numbers up to and including 16,000) —
No. 1 Light and No. 3 Heavy Spring
- No. 331 Hook for No. 310 Arm (Serial Numbers up to and including 16,000)
- No. 332 Guide Screw for No. 331 (Serial Numbers up to and including 16,000)
- No. 333 Rack for Spring Adjusting all C & G Models
- No. 334 Regular Spring for No. 333
- No. 334H Heavy Spring for No. 333
- No. 20-310 Feed Roll Arm for new models (Serial Numbers 20,000 and up)
- No. 20-312 Stud on No. 20-310 for No. 333
- No. 20-313 Cone Stud for back end of No. 20-310 Feed Roll Arm
- No. 314 Small Cone Screw for front end of No. 20-310 Feed Roll Arm
- No. 20-315 Binding Bolt for No. 20-313
- No. 20-324L Lock Nut for No. 20-331
- No. 20-331 Adjusting Screw for No. 20-310 Feed Roll Arm
- No. 20-319 Long Screw for No. 20-327 Spring (Serial Numbers 20,000 and above)
- No. 20-327 Spring for Feed Roll Tilt (Serial Numbers 20,000 and above)

CHECK MODEL AND SERIAL NUMBER OF MACHINE BEFORE ORDERING PARTS

PARTS PHOTOS ONE-HALF ACTUAL SIZE

From the library of Merrow Superior - www.supsew.com • www.merrow.com

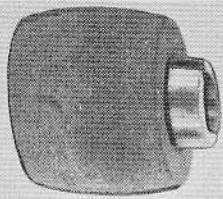

301

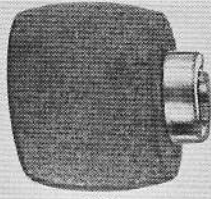

302



302X

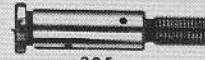

305



306

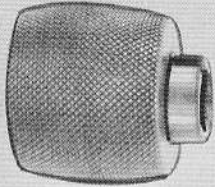

303SP

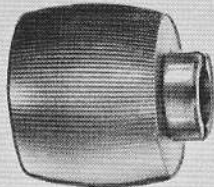

303

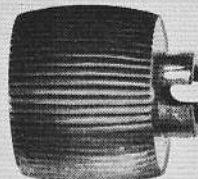

304

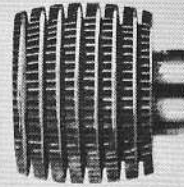

304S

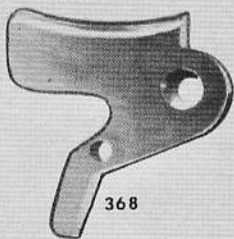

368



368S



368SP SH



372



368SP-SH

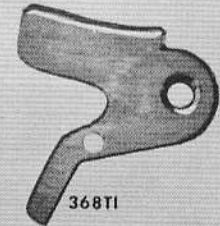

368TI



368FE

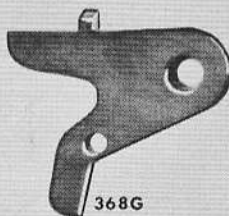

368G

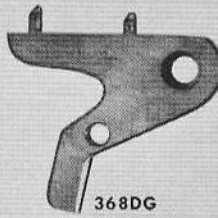

368DG



368DE

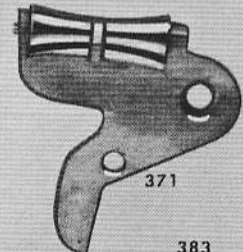

371



383
20-383

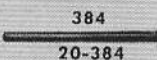

384
20-384

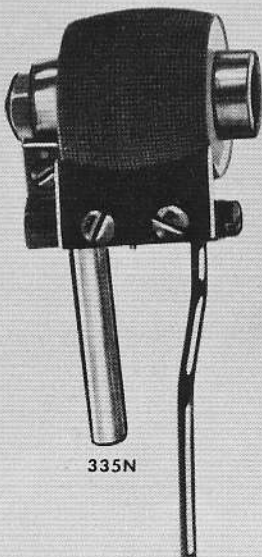

335N

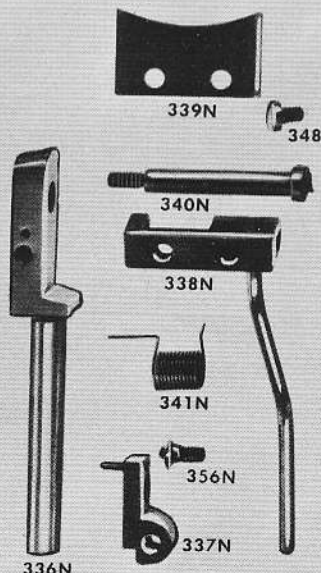

339N

348

340N

338N

341N

356N

337N

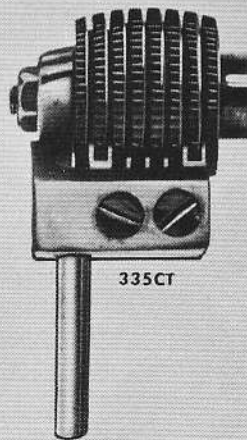

335CT

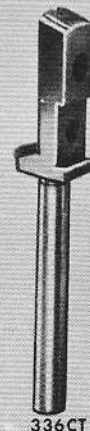

336CT

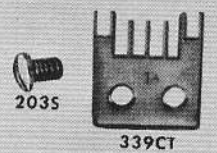

2035

339CT

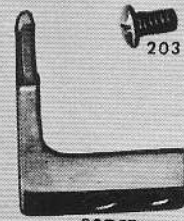

203

337CT

Parts for FORTUNA SKIVING MACHINES

- No. 301 Fine Emery Feed Roll 1 1/4" Size Model C (for Soft Suede Leathers, Baby Calf, etc.)
- No. 302 Medium Emery Feed Roll 1 1/4" Size Model C (General Work)
- No. 302X Coarse Emery Feed Roll 1 1/4" Size Model C (Extra Heavy Calf Skins, etc.)
- No. 303SP Fine Knurled Steel Feed Roll 1 1/4" Size Model C (Light Cowhides, etc.)
- No. 303 Fine Fluted Steel Feed Roll 1 1/4" Size Model C (Medium Weight Leathers)
- No. 304 Coarse Fluted Steel Feed Roll 1 1/4" Size Model C (Heavy Cowhide, Tires, etc.)
- No. 304S Extra Coarse Double Cut Steel Feed Roll 1 1/4" (Extra Heavy Work)
- No. 305 Feed Roll Stud for 1 1/4" Rolls above
- No. 306 Lock Nut for No. 305
- No. 368 Regular Presser Foot 1 1/4" Model C (Edging and Wide Scarf)
- No. 368S Splitting Presser Foot 1 1/4" Model C (Splitting)
- No. 368SP-SH Edging and Scarfing Presser Foot for work up to 5/8"
- No. 368SP-SH Edging and Scarfing Presser Foot for work up to 3/8"
- No. 368TI Turning in Foot
- No. 368FE Feather Edging and Narrow "V" Groove
- No. 368G Grooving Foot 1/8" (other sizes to order)
- No. 368DG Double Groove to order
- No. 368DE Double Edging Foot Special to size
- No. 372 Stud to hold Presser Foot to Plunger
- No. 371 Roller Presser Foot for 1 1/4" size (for Heavy Cowhide)
- No. 383 Rolls (2 pieces) for old style Screw Stud No. 371
- No. 384 Pin with Threaded End for old style No. 383
- No. 20-383 Rolls (2 pieces) for new style No Thread Stud No. 371
- No. 20-384 Pin without Thread End for new No. 371
- No. 335N Scrap Remover complete with 303SP (helps to remove waste from roll)
- No. 336N Holder for No. 335N
- No. 337N Block for holding Plate Holder No. 338N
- No. 338N Plate Holder 1 1/4" Model "C"
- No. 339N Steel Plate 1 1/4" Model "C"
- No. 340N Stud for Scrap Remover 1 1/4" Size Model "C"
- No. 341N Spring for Scrap Remover Model "C"
- No. 348 Screw to hold Plate No. 339N to 338N
- No. 356N Screw to hold Block No. 337N to Holder No. 336N
- No. 335CT Comb Type Scrap Remover for Heavy Leathers, etc.
- No. 336CT Feed Roll Holder for No. 337CT
- No. 337CT Comb Holder for No. 339CT Comb
- No. 203S Screw to hold No. 339CT to No. 337CT
- No. 203 Screw to hold No. 337CT to No. 336CT
- No. 339CT Seven Tooth Comb for No. 335CT

CHECK MODEL AND SERIAL NUMBER OF MACHINE BEFORE ORDERING PARTS

PARTS PHOTOS ONE-HALF ACTUAL SIZE

From the library of Merrow Superior - www.supsew.com • www.merrow.com

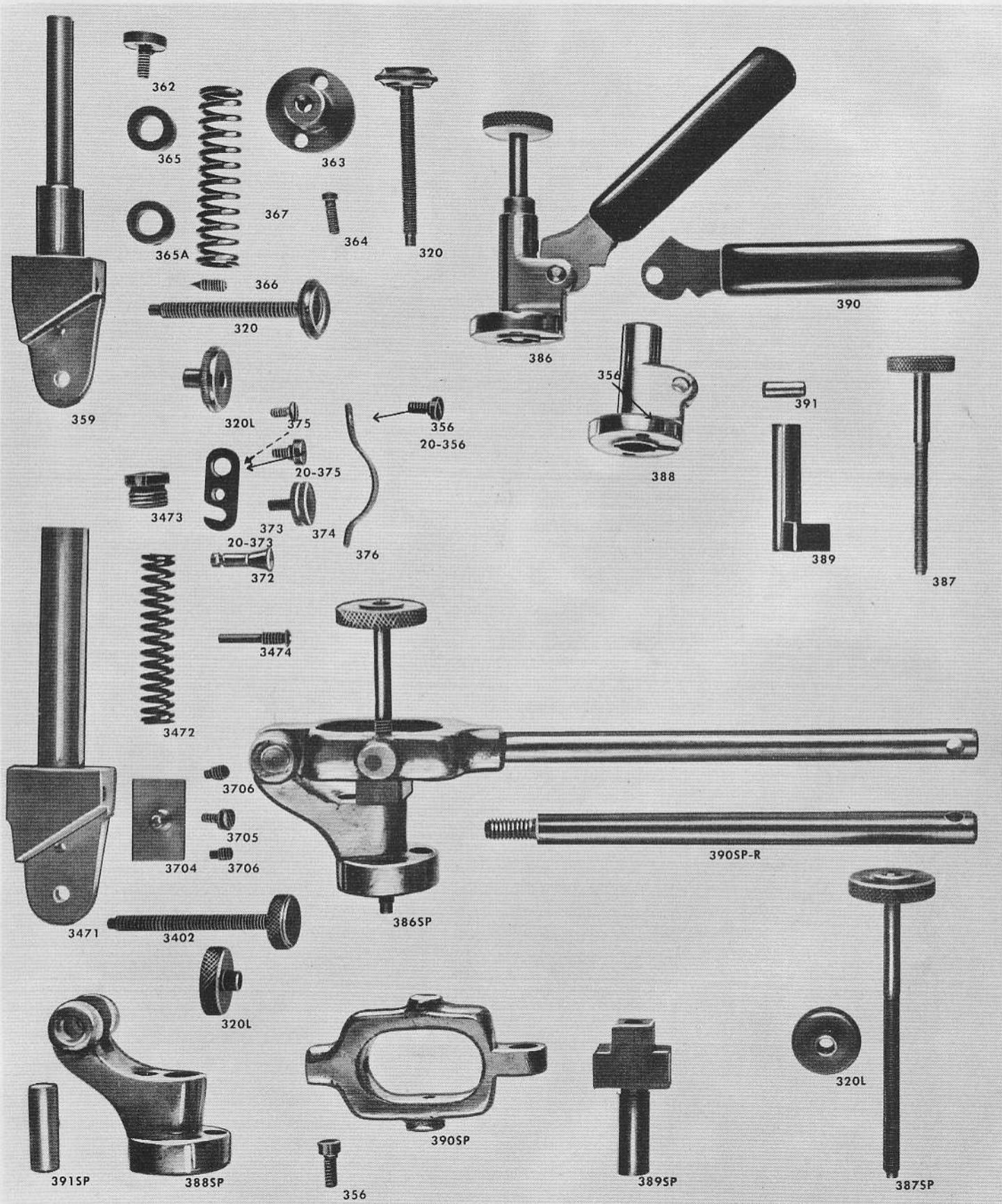

Parts for FORTUNA SKIVING MACHINES

- No. 359 Plunger for old models C & G (Serial Numbers up to and incl. 16,000)
- No. 362 Cap Screw for No. 359
- No. 363 Cap on top of arm
- No. 364 Screw for No. 363
- No. 365 Collar for top end of No. 359
- No. 365A Collar for lower end of No. 359
- No. 366 Small Cone Set Screw for No. 365A
- No. 367 Spring for No. 359
- No. 320 Presser Foot Adjusting Screw
- No. 320L Lock Nut for No. 320
- No. 372 Stud for Presser Foot
- No. 373 Latch for Holding Presser Foot to Plunger
- No. 374 Binding Knob for No. 373 and No. 20-373
- No. 375 Screw for Holding Latch No. 373 to Plunger
- No. 376 Spring for Presser Foot
- No. 356 Screw for Holding Spring No. 376 to Arm (Models up to and incl. 16,000)
- No. 20-356 Screw for Holding Spring No. 376 to Arm (Models 20,000 and up)
- No. 3471 Plunger for New Models C & G (Serial No. 50,000 and up)
- No. 3472 Spring for No. 3471
- No. 3473 Cap Screw for No. 3471
- No. 3474 Stud for Spring No. 3472
- No. 3402 Regulating Screw for No. 3471
- No. 320L Lock Nut for No. 320 and No. 3402
- No. 3704 Bronze Adjusting Plates for No. 3471
- No. 3705 Binding Screw for No. 3704
- No. 3706 Adjusting Screws for No. 3704
- No. 386 Automatic Plunger Raiser (Presser Foot Lifter) all C & G Models
- No. 387 Adjusting Screw for No. 386
- No. 388 Housing for No. 386
- No. 389 Plunger for No. 386
- No. 390 Handle for No. 386
- No. 391 Pin for No. 390
- No. 356 Screw to hold No. 386 to arm
- No. 386SP Special Foot Operated Foot Lifter
- No. 387SP Adjusting Screw for No. 386SP
- No. 388SP Housing for No. 386SP
- No. 389SP Plunger for No. 386SP
- No. 390SP Lever for No. 386SP
- No. 390SP-R Rod for No. 390SP
- No. 391SP Pin for No. 390SP
- No. 320L Lock Nut for No. 387SP
- No. 356 Screw for No. 390SP and to hold No. 386SP to Arm
- No. 20-375 Screw for holding Latch No. 20-373 to Plunger
- No. 20-373 Latch for holding Presser Foot to No. 359 and No. 3471
(Use Screw No. 20-375)

CHECK MODEL AND SERIAL NUMBER OF MACHINE BEFORE ORDERING PARTS

PARTS PHOTOS ONE-HALF ACTUAL SIZE

From the library of Merrow Superior - www.supsew.com • www.merrow.com

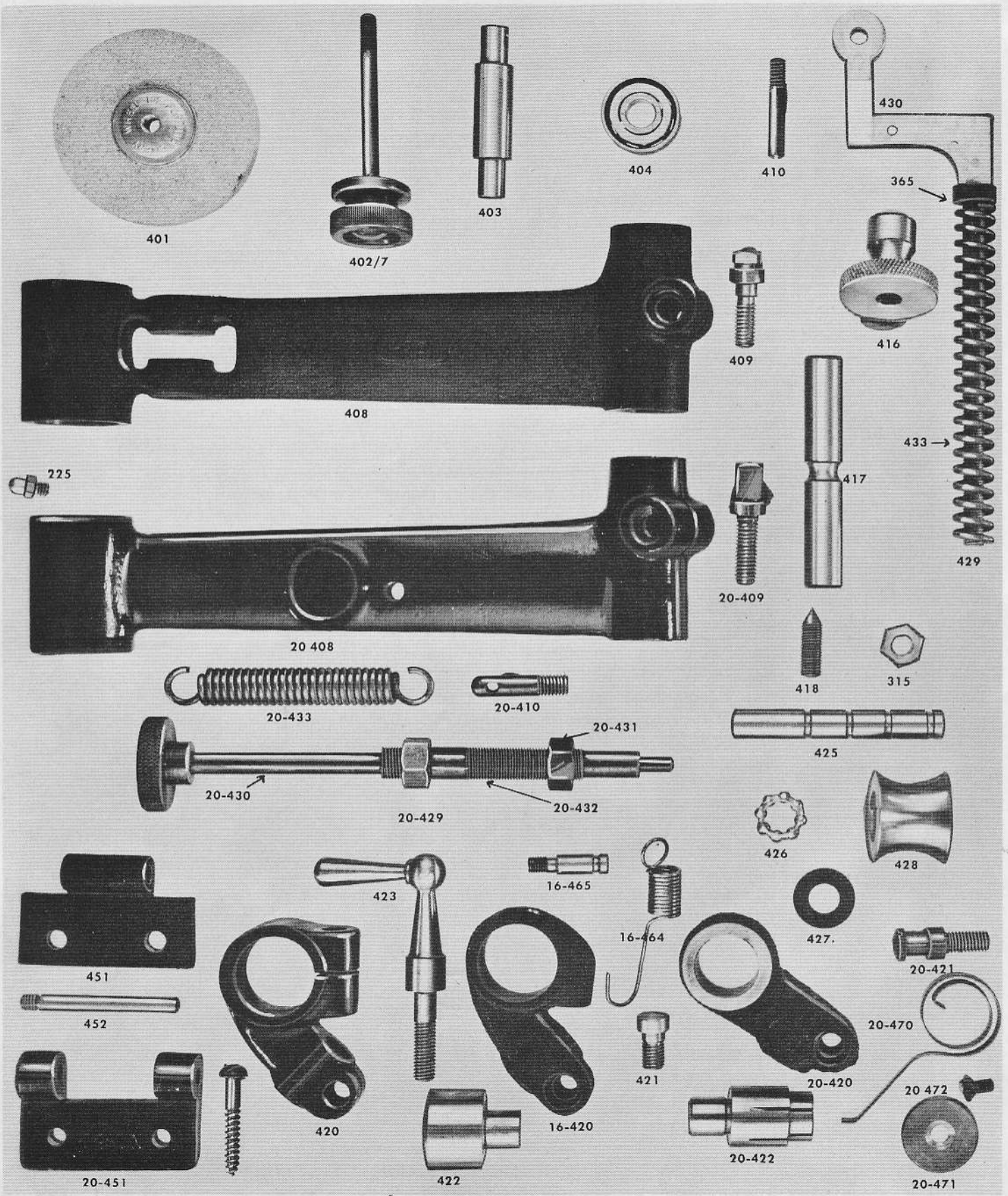

Parts for FORTUNA SKIVING MACHINES

- No. 401 Emery Wheel (Grinding Wheel) all models
- No. 402/7 Binding Bolt for No. 401 all models
- No. 403 Hollow Shaft for No. 404 Bearings all models
- No. 403 Emery Wheel Arm for all old models (up to and including 16,000)
- No. 409 Binding Bolt for No. 417
- No. 410 Stud for No. 429 on Arm No. 408
- No. 416 Knob for No. 429
- No. 417 Eccentric Stud for all Emery Wheel Arms
- No. 418 Cone Screws (2 required) for No. 417
- No. 315 Lock Nut for No. 418
- No. 429 Control Arm for Emery Wheel Arm (all old models up to and incl. 16,000)
- No. 430 Control Arm without Spring or Collar
- No. 433 Spring for No. 430
- No. 365 Collar for No. 430
- No. 20-408 Emery Wheel Arm for all new models (Serial No. 20,000 and up)
- No. 20-409 Binding Bolt for No. 417
- No. 20-410 Stud for Spring No. 20-433 (2 required)
- No. 20-429 Emery Wheel Control Arm and Binding Bolt for Shaft Hanger
all new models (20,000 up)
- No. 20-430 Control Rod only for No. 20-408
- No. 20-432 Binding Bolt with Nuts for Knife Shaft Hanger
- No. 20-431 Nut for No. 20-432
- No. 20-433 Spring for Emery Wheel Arm No. 20-408 (Serial No. 20,000 and up)
- No. 420 Idler Bracket
- No. 421 Binding Screw for No. 425 use on No. 420 and No. 16-420
- No. 422 Stud for No. 420 — all old models (up to and including 16,000)
- No. 423 Binding Post for No. 420 models under No. 16,000
- No. 16-420 Idler Bracket — (16,000 Series only)
- No. 16-464 Spring for No. 16-420
- No. 16-465 Stud for Spring and Cover — (16,000 Series only)
- No. 20-420 Idler Bracket — (20,000 Series and up)
- No. 20-421 Binding Screw for No. 20-420
- No. 20-422 Stud for No. 20-420
- No. 20-470 Spring for Belt Tightener
- No. 20-471 Disc for holding No. 20-470 to No. 20-422
- No. 20-472 Screw for No. 20-471
- No. 425 Idler Shaft (1 required) all models
- No. 426 Ball Bearings (4 required) all models
- No. 427 Fibre Washer (1 required) all models
- No. 428 Idler Pulleys (2 required) all models
- No. 404 Bearing for Emery Wheel Arm (2 required)
- No. 225 Grease Fittings
- No. 451 Hinge for old models (up to and including 16,000)
- No. 452 Pin for No. 451 and No. 20-451
- No. 20-451 Hinge for new models (20,000 and up)

CHECK MODEL AND SERIAL NUMBER OF MACHINE BEFORE ORDERING PARTS

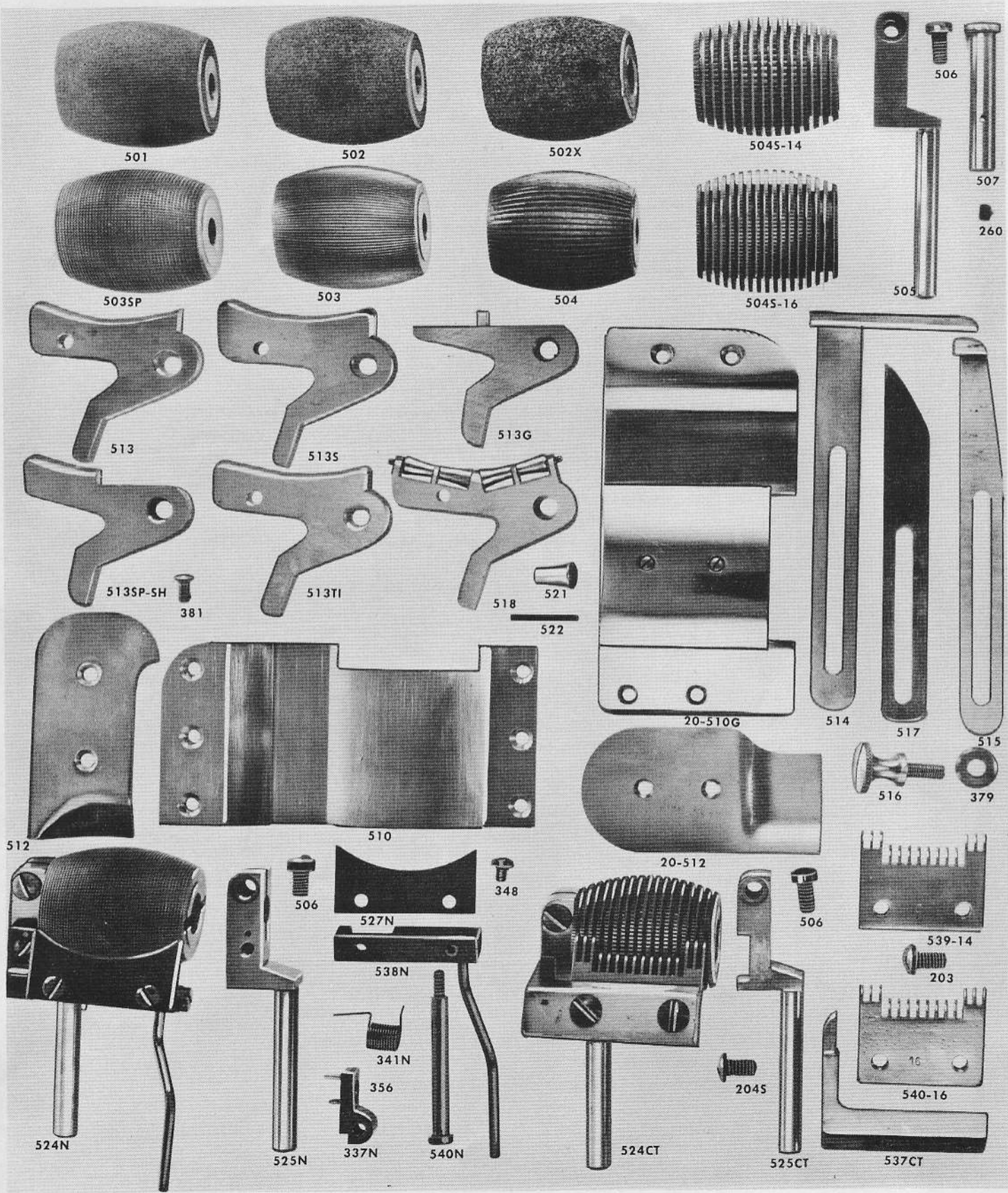

Parts for FORTUNA SKIVING MACHINES

- No. 501 Fine Emery Feed Roll 2" Model G (Fine Leathers — Baby, Calf, etc.)
- No. 502 Medium Emery Feed Roll 2" Model G (General Leathers)
- No. 502X Coarse Emery Feed Roll 2" Model G (Medium Cowhides, Kip, etc.)
- No. 503SP Fine Knurled Steel Feed Roll 2" Model G (Heavy Calf)
- No. 503 Fine Fluted Steel Feed Roll 2" Model G (Heavy Cowhides)
- No. 504 Coarse Fluted Steel Feed Roll 2" Models G or F (Extra Heavy Cowhides, Rubber, etc.)
- No. 504S-14 Coarse Double Cut Steel Feed Roll 14 Grooves
- No. 504S-16 Fine Double Cut Steel Feed Roll 16 Grooves
- No. 505 Feed Roll Holder Models G and F
- No. 506 Binding Screw for No. 505
- No. 507 Feed Roll Stud 2" size for above Feed Rolls
- No. 260 Oil Hole Plug for No. 507
- No. 513 Regular Presser Foot 2" size Model G (Edging Wide Scarf)
- No. 513S Splitting Foot 2" size Model G
- No. 513G Grooving Foot 1/8" width — other size to order
- No. 513SP-SH Narrow Edging and Narrow Scarfing
- No. 513TI Turning in Foot
- No. 518 Roller Presser Foot 2" size (for Heavy Cowhides)
- No. 521 Rolls for No. 518 (2 sets 4 rolls)
- No. 522 Pins for No. 521 (2 required)
- No. 510 Throat Plate for Model G (Series up to and including 16,000)
- No. 512 Rear Throat Plate Model G (Series up to and including 16,000)
- No. 20-510G Throat Plate Model G — (20,000 and up)
- No. 20-512 Rear Throat Plate Models C & G — (20,000 and up)
- No. 381 Screw for all Throat Plates
- No. 514 Straight Guide Model G
- No. 517 Regular Round Guide
- No. 515 Special Round Guide
- No. 516 Guide Screw for Model G old style and all new models
- No. 379 Washer for No. 516
- No. 524N Scrap Remover complete with No. 503SP Feed Roll
- No. 525N Feed Roll Holder for No. 524N
- No. 506 Binding Screw for No. 525N
- No. 337N Block to hold No. 538 to No. 525N
- No. 356 Screw to hold No. 337N to No. 525N
- No. 538N Holder for Plate No. 527N
- No. 527N Steel Scraper Plate
- No. 348 Screws to hold Plate to holders No. 538N
- No. 341N Spring for No. 524N
- No. 540N Stud for No. 538N 2- size
- No. 524CT Comb Type Scrap Remover (for heavy work)
- No. 525CT Feed Roll Holder for Comb Type
- No. 506 Binding Screw for No. 525CT
- No. 537CT Bracket for Comb Blade No. 539 and No. 540
- No. 539-14CT Coarse Comb Type to use with Roll No. 504S-14
- No. 540-16CT Fine Comb Type to use with Roll No. 504S-16
- No. 203 Screw to hold No. 539 and No. 540 to No. 537CT
- No. 204S Screw to hold No. 537CT to No. 525CT

CHECK MODEL AND SERIAL NUMBER OF MACHINE BEFORE ORDERING PARTS

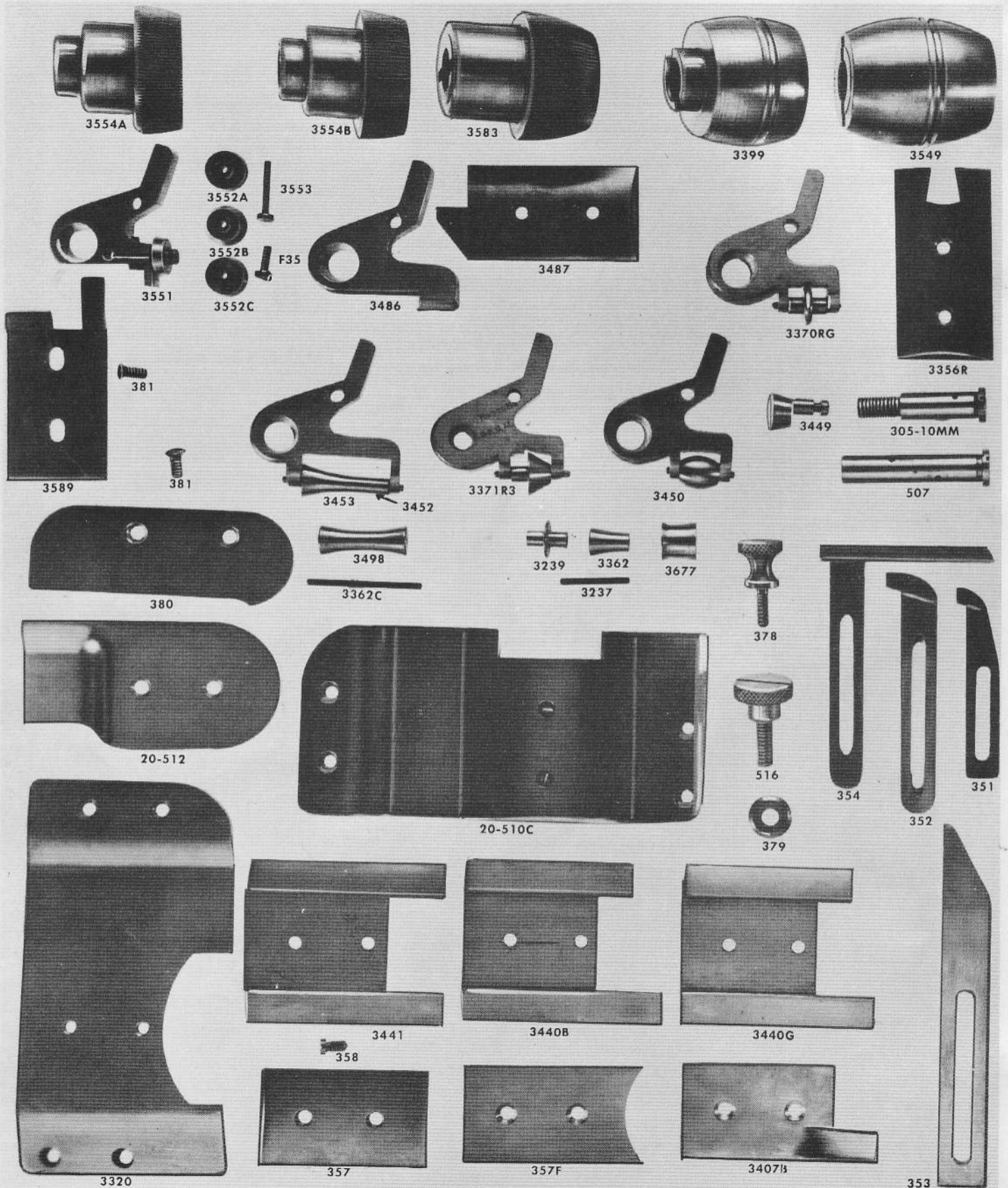

Parts for FORTUNA SKIVING MACHINES

- No. 3554 Special Fine Knurled Steel Feed Roll for cut out work and special edging
1 1/4" size Model C
- No. 3554A Special Fine Fluted Steel Feed Roll for Sharp Angles Burnishing Type Cut
- No. 3554B Special Fine Fluted Steel Feed Roll for cut out work 1 1/4" Model C
- No. 3583 Special Fine Fluted Steel Feed Roll for cut out work and narrow edges
2" Model "G"
- No. 3583A Special Knurled Type Steel Feed Roll same as No. 3583
- No. 3551 Roller Presser Foot for narrow edging use with 1/2 size Rolls
- No. 3552A Roll for No. 3551
- No. 3552B Roll for No. 3551
- No. 3552C Roll for No. 3551
- No. 3553 Pin for Rolls No. 3552A, B, C
- No. 3535 Set Screw for Binding No. 3553
- No. 3589 Throat Plate to use with Presser Foot No. 3551
- No. 3486 Presser Foot for cut out work
- No. 3487 Plate with Pin for cut out work (use with Presser Foot Nos. 3486 & 3449)
- No. 3399 Special Steel Roll 1 1/4" size for Grooving
- No. 3549 Special Steel Roll 2" for Grooving
- No. 3370RG Roller Grooving Foot
- No. 3356R Throat Plate to be used with Presser Foot No. 3370RG
- No. 3453 Single Roll Presser Foot
- No. 3452 Tapered Roll for No. 3453
- No. 3498 Regular Roll for No. 3453
- No. 3371R3 Roller Presser Foot for Sharp Angle Cut
- No. 3239 Roll for Narrow Groove use on Foot No. 3370RG
- No. 3362 Roll for Narrow Scarf use on Foot No. 3450R1
- No. 3237 Pin for No. 3370RG, No. 3371R3, 3450R1
- No. 3677 Roll for Presser Foot No. 3551
- No. 3449 Eccentric Stud for all Special Roller Feet
- No. 305-10MM Stud for Rolls No. 3554A, B, No. 3399
- No. 507 Stud for No. 3583 and No. 3549
- No. 380 Throat Plate for Model C (up to 16,000 Series)
- No. 20-510C Throat Plate for Model C (20,000 and up Series)
- No. 20-512 Rear Throat Plate (20,000 Series and up)
- No. 3320 Throat Plate for all new models (20,000 Series and up)
- No. 3341 Intermediate Plate for 1 1/4" use with No. 3320
- No. 3440B Intermediate Plate for 2" use with No. 3320
- No. 3440G Intermediate Plate for 2" use with No. 3320
- No. 357 Curved Work Plate
- No. 357F Flat Work Plate
- No. 3407B Work Plate to be used with Rolls No. 3554, No. 3583, etc.
- No. 378 Guide Screw Model C (Serial No. up to and including 16,000)
- No. 516 Guide Screws Models C and G (Serial No. 20,000 and up)
- No. 379 Washer for Guide Screws
- No. 354 Straight Guide for Model C (up to and including 16,000)
- No. 352 Round Guide (up to and including 16,000)
- No. 351 Round Guide small size (up to and including 16,000)
- No. 353 Pointed Guide for sharp inside turns
- No. 358 Screw for Plates No. 357, No. 3487, No. 3356R
- No. 381 Screws for Plates No. 3589, No. 380, No. 20-512, No. 3320, No. 20-510C,
No. 357F, No. 3407B
- No. 3362C Pin for Roller Presser Foot No. 3453
- No. 3450 Roller Presser Foot for wide channel cut

CHECK MODEL AND SERIAL NUMBER OF MACHINE BEFORE ORDERING PARTS

PARTS PHOTOS ONE-HALF ACTUAL SIZE

From the library of Merrow Superior - www.supsew.com • www.merrow.com

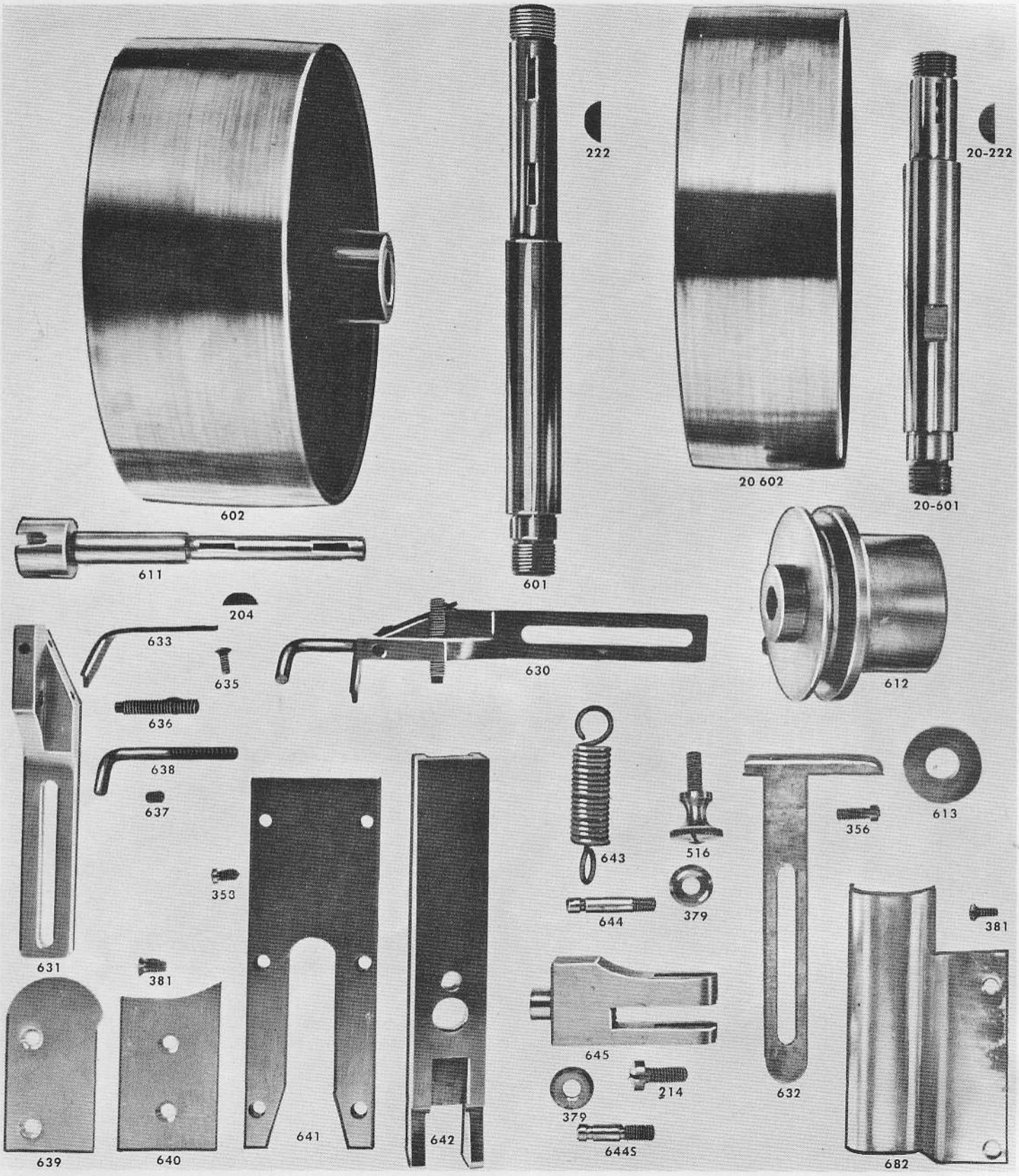

Parts for FORTUNA MODELS "E&F" SKIVING MACHINES

- No. 602 Main Drive Pulley
- No. 601 Main Drive Shaft
- No. 20-602 Main Drive Pulley (Series 20,000 and above)
- No. 20-601 Main Drive Shaft (Series 20,000 and above)
- No. 222 Key for No. 601
- No. 20-222 Key for No. 20-601
- No. 611 Collet Shaft
- No. 204 Key for No. 611 (2 required)
- No. 612 Pulley for No. 277 Feed Shaft
- No. 613 Distance Washer for No. 612 not having hub
- No. 630 Complete Guide for round work and inside curves
- No. 631 Guide
- No. 632 Guide for straight work
- No. 356 Screw for holding No. 638 in No. 632
- No. 633 Plate for Guide No. 631
- No. 635 Screws to hold Plate to No. 631 (2 required)
- No. 636 Stop Screws for No. 631
- No. 637 Set Screws for holding No. 638 to No. 631
- No. 638 Finger Guard for No. 631
- No. 379 Washers for No. 630, No. 632 and No. 645
- No. 516 Guide Screws for No. 630, No. 632
- No. 639 Throat Plate for E and F (Series up to and including 16,000)
- No. 640 Throat Plate for Model E
- No. 641 Plunger Face Plate for E and F
- No. 358 Screw to hold No. 641 to arm (6 required)
- No. 642 Plunger for Models E and F
- No. 643 Spring for Plunger No. 642
- No. 644 Stud for Arm to hold Spring No. 643
- No. 644S Stud for No. 645 to hold Spring No. 643
- No. 645 Fork for Plunger No. 642
- No. 214 Binding Screw for No. 645
- No. 379 Washer for No. 214
- No. 682 Cover Guard for Universal Bar
- No. 381 Screw for No. 682, No. 639, No. 640

CHECK MODEL AND SERIAL NUMBER OF MACHINE BEFORE ORDERING PARTS

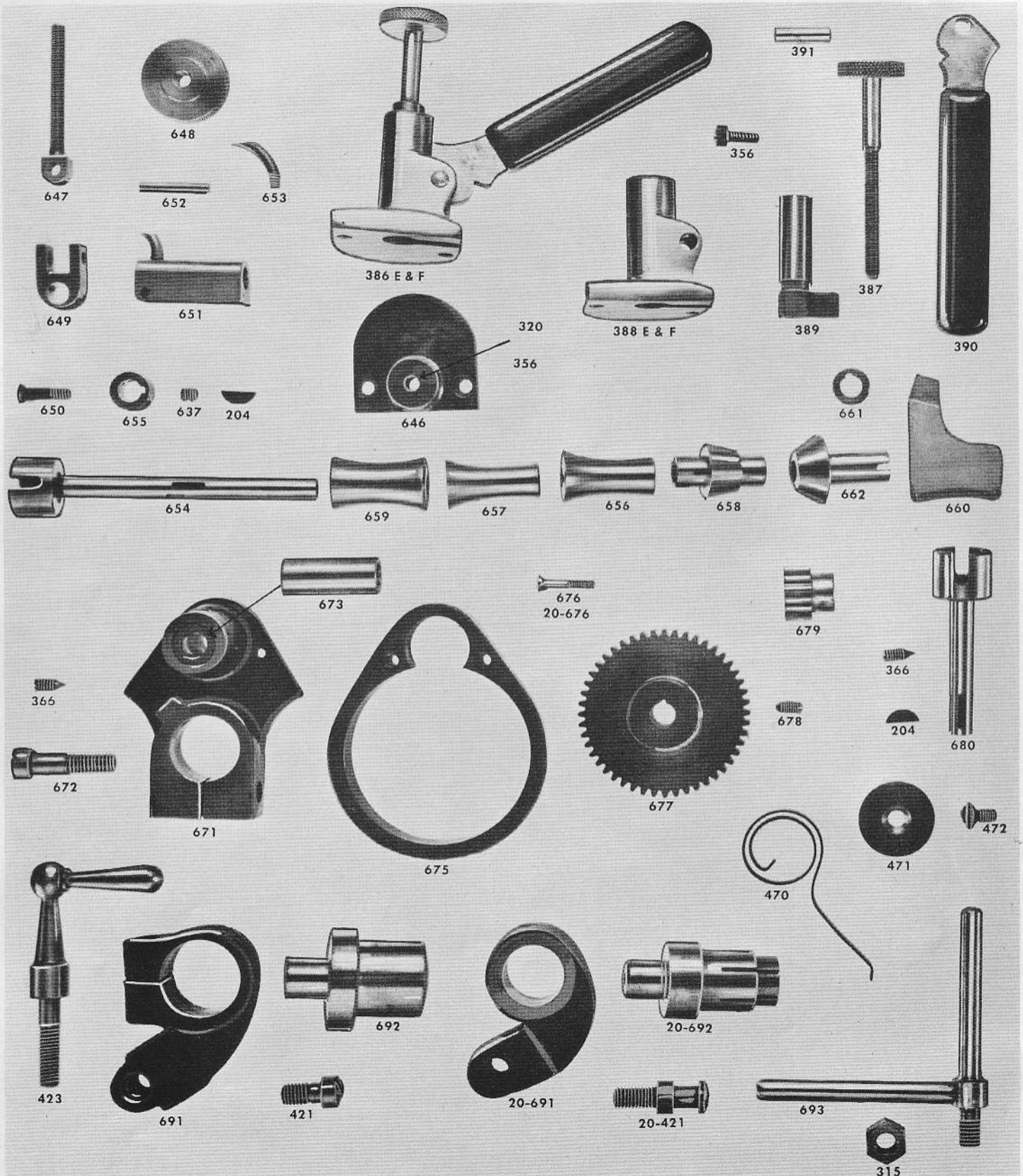

Parts for FORTUNA MODELS "E&F" SKIVING MACHINES

- No. 646 Cap Plate for Plunger Arm old models (up to and including 16,000)
- No. 356 Screws to hold No. 646 and No. 396 E and F to Arm
- No. 320 Plunger Regulating Screw (up to and including 16,000 Series)
- No. 647 Upper Roll Regulating Screw
- No. 648 Knobs for Regulating Screw No. 647 (2 required)
- No. 649 Swivel Bearing for front end of No. 654 and No. 854
- No. 650 Screw for holding Swivel Bearing No. 649 to No. 647
- No. 651 Bearing Block for No. 654 and No. 854
- No. 652 Pin for No. 651
- No. 653 Oil Tube for No. 651
- No. 654 Collet Shaft for Model E
- No. 655 Thrust Collar for No. 654 and No. 854
- No. 637 Set Screws for No. 655
- No. 204 Key for No. 654 and No. 854
- No. 656 Roller Presser Foot 1 1/4" size Model E
- No. 657 Roller Presser Foot 1 1/4" size Model E
- No. 658 Roller Presser Foot 1 1/4" size Model E
- No. 659 Roller Presser Foot 1 1/4" size Model E
- No. 660 Stationary Presser Foot for Model E
- No. 661 Collar for No. 660
- No. 671 Gear Bracket
- No. 672 Binding Screw for No. 671
- No. 675 Gear Guard
- No. 676 Screw to hold No. 675 to No. 671 (2 required)
- No. 20-676 Screws to hold No. 675 to No. 671 — new model (20,000 and above)
- No. 677 Large Gear for upper drive
- No. 678 Set Screw for Gear No. 677
- No. 679 Small Gear for upper drive
- No. 680 Collet Shaft for upper drive
- No. 366 Set Screw for upper Collet Shaft No. 680 and No. 671
- No. 204 Key for upper Gear No. 679
- No. 386 E & F Complete Upper Roll Lifter
- No. 387 Regulating Screw for No. 386 E and F
- No. 388 E & F Housing for Lifter No. 386 E and F
- No. 389 Plunger for No. 386 E and F
- No. 390 Handle for No. 386 E and F
- No. 391 Pin for No. 390
- No. 423 Binding Post for No. 691 and No. 420
- No. 421 Binding Screw for holding Idler Shaft No. 425 on Machines —
(Serial Numbers up to and including 16,000)
- No. 692 Stud for Idler Bracket No. 691
- No. 20-691 Idler Bracket Model E and F (Serial Numbers 20,000 and above)
- No. 20-421 Binding Screw to hold Idler Bearing Shaft No. 425 (Serial Numbers
20,000 and above)
- No. 20-692 Stud for Idler Bracket No. 20-691 and Spring No. 470
- No. 20-470 Tension Spring for Idler Bracket No. 20-691
- No. 471 Plate to retain Spring No. 470
- No. 472 Screw to hold Plate to No. 20-692
- No. 693 Belt Guard
- No. 315 Nut to hold Belt Guard to machine
- No. 662 Roller Presser Foot Model E sharp angle cut
- No. 673 Bushing for No. 671
- No. 691 Idler Bracket Model E and F (up to and including 16,000)

CHECK MODEL AND SERIAL NUMBER OF MACHINE BEFORE ORDERING PARTS

PARTS PHOTOS ONE-HALF ACTUAL SIZE

From the library of Merrow Superior - www.supsew.com • www.merrow.com

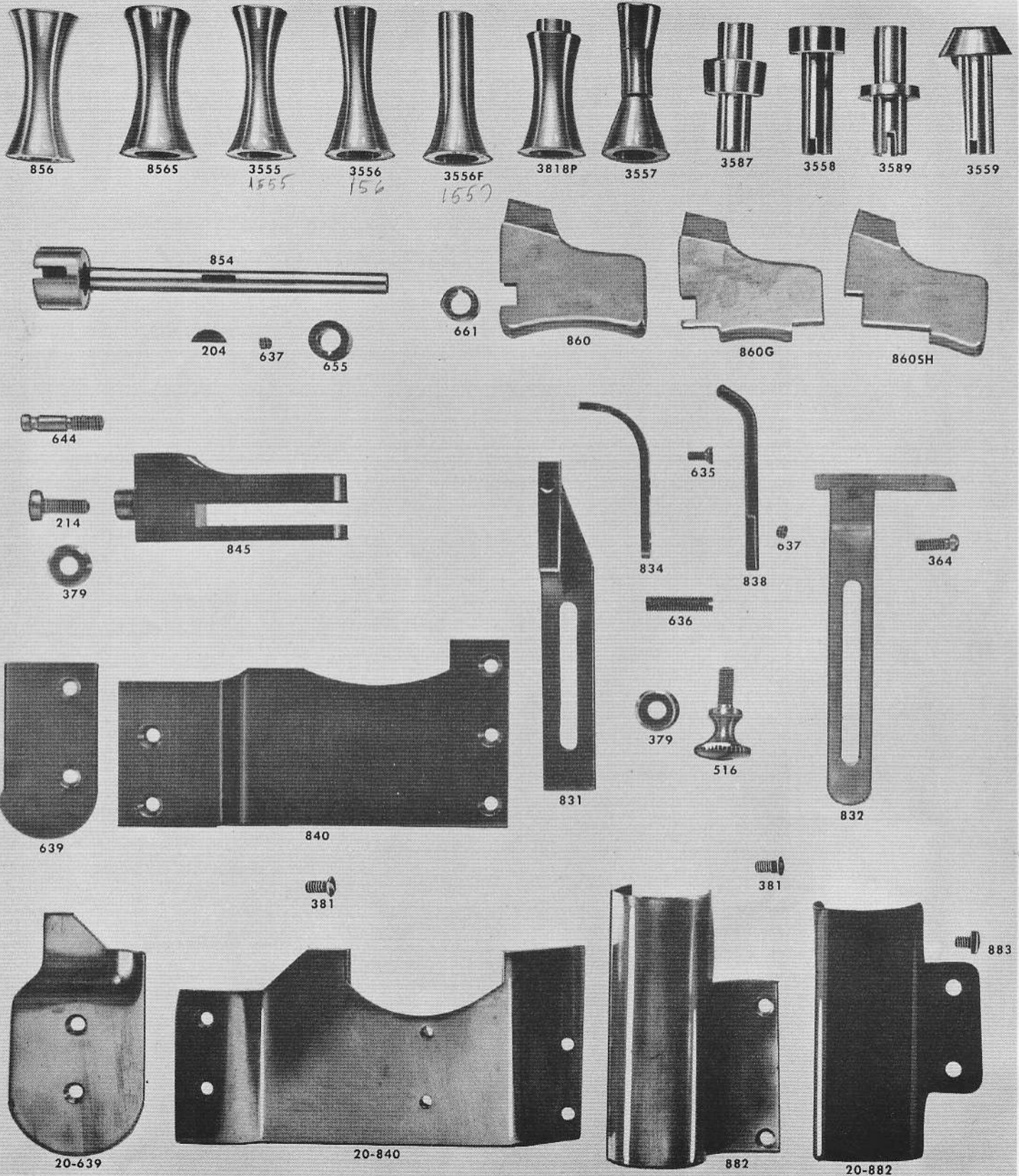

Parts for FORTUNA MODEL "F" SKIVING MACHINE

- No. 845 Fork for Plunger No. 642 Model "F"
- No. 644 Stud for Arm and Fork to hold Spring
- No. 214 Screw to hold No. 845 to No. 642
- No. 379 Washer for No. 214
- No. 854 Collet Shaft for Upper Feed Roll
- No. 204 Key for No. 854
- No. 637 Set Screw for No. 655
- No. 655 Thrust Collar for No. 854
- No. 856 Regular Roller Presser Foot
- No. 856S Roller Presser Foot Rounded Both Ends
- No. 3555 Roller Presser Foot
- No. 3556 Roller Presser Foot
- No. 3556F Roller Presser Foot Long Taper
- No. 3818P Roller Presser Foot
- No. 3557 Roller Presser Foot Sectional Roll
- No. 3587 Roller Presser Foot
- No. 3558 Roller Presser Foot
- No. 3589 Roller Presser Foot Grooving made to size
- No. 3559 Roller Presser Foot sharp angle cut
- No. 860 Stationary Presser Foot for Model F 2"
- No. 860G Stationary Presser Foot for Grooving made to size Model "F"
- No. 860SP-SH Stationary Presser Foot for Shoulder Scarf Model "F"
- No. 661 Distance Collar for No. 860, etc.
- No. 831 Guide for Model F
- No. 834 Plate for Guide No. 831
- No. 635 Screw to hold No. 834 to No. 831 (2 required)
- No. 636 Stop Screw for No. 831
- No. 637 Set Screw for No. 838
- No. 838 Finger Guard
- No. 832 Guide for straight work
- No. 364 Set Screw to hold No. 838 in No. 832
- No. 516 Gauge Screw
- No. 379 Washer for No. 516
- No. 639 Throat Plate (Serial Numbers up to and including 16,000)
- No. 840 Throat Plate (Serial Numbers up to and including 16,000)
- No. 381 Screws to hold Plate No. 639, No. 840, No. 20-639, No. 20-840, No. 882
- No. 20-639 Throat Plate (Serial Numbers 20,000 and up)
- No. 20-840 Throat Plate (Serial Numbers 20,000 and up)
- No. 882 Universal Bar Cover Serial Numbers up to and including 16,000)
- No. 20-882 Universal Bar Cover (Serial Numbers 20,000 and above)
- No. 883 Screw for No. 20-882 (2 required)

CHECK MODEL AND SERIAL NUMBER OF MACHINE BEFORE ORDERING PARTS

PARTS PHOTOS ONE-HALF ACTUAL SIZE

From the library of Merrow Superior - www.supsew.com • www.merrow.com

Pulley Cover for Models C & G

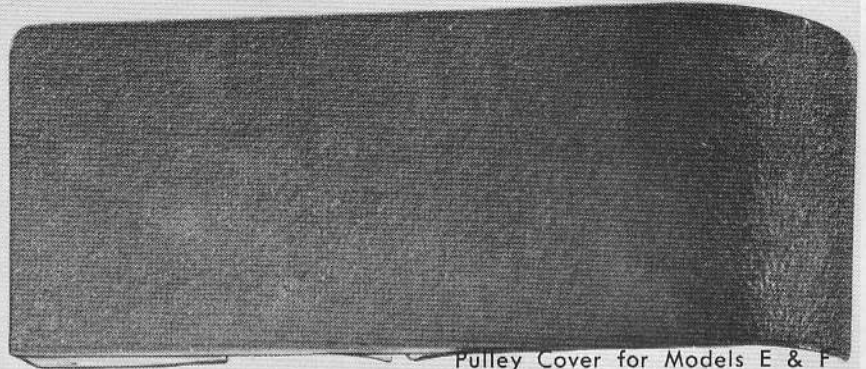
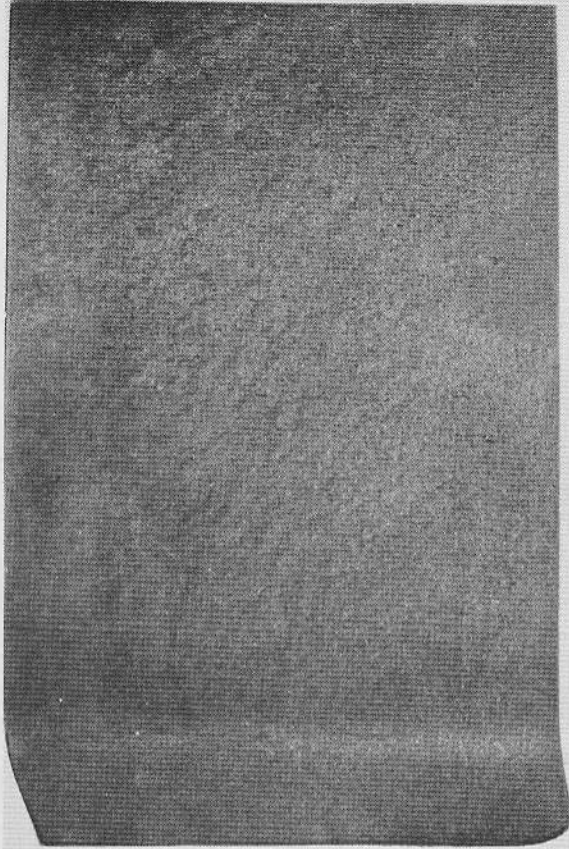

Pulley Cover for Models E & F

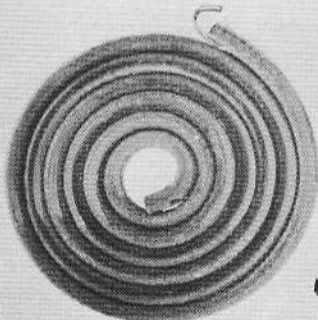
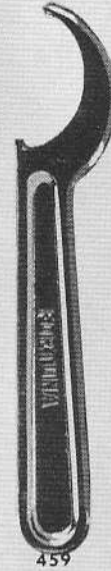

Feed Roll Belt

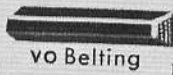

VO Belting

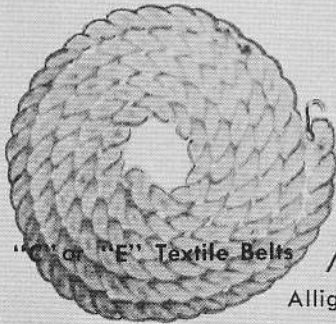

C or E Textile Belts

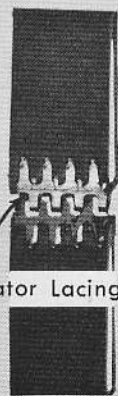

Alligator Lacing

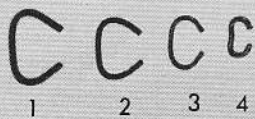

1" Belt



462



462N



453



453N



465



461S



461M

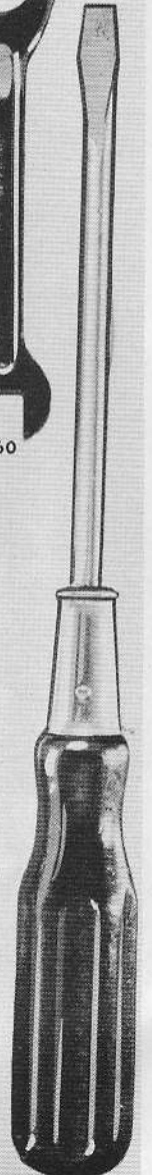

461L

TOOLS & ACCESSORIES

- No. 453N New type Emery Wheel Dresser
- No. 453 Old style Emery Wheel Dresser
- No. 454 Cutters for Wheel Type Emery Wheel Dresser No. 453
- No. 455 Stud for No. 454
- No. 456 Nut for No. 455
- No. 457 Open End Wrench for Nut No. 315, No. 306, No. 231
- No. 458 Spanner Wrench for adjusting Knife Shaft Nuts No. 206 (2 required)
- No. 459 Spanner wrench for adjusting Bushing Nut No. 207
- No. 460 Face Spanner Wrench for Nut No. 223, No. 278, also Screw No. 409
- No. 461S Small Screw Driver
- No. 461M Medium screw driver
- No. 461L Large Screw Driver
- No. 462N New style Oil Stone with Wooden Handle for inside of Knife
- No. 462 Half round Oil Stone for inside of Knife
- No. 465 Grease Gun for new machines (Serial Numbers 20,000 and up)
- E.W.B. Emery Wheel Belt
- F.R.B. Feed Roll Belt
- "C" Textile Belts Cotton Emery Wheel Belts for C & G machines
- "E" Textile Belts Cotton Emery Wheel Belts for E & F machines
- V.O. Belting V.O. 32 used in place of 1/4" Round Belting
V.O. 40 used in place of 5/16" and heavier Belting

LEATHER BELTING BY THE FOOT OR 100 FT. ROLLS

- 3/16" Round Belting — Hooks No. 3
- 1/4" Round Belting — Hooks No. 2
- 5/16" Round Belting — Hooks No. 1
- 1" Flat Belting — Alligator Belt Lacing 12" Length
- Pulley Cover for Models C & G
- Pulley Cover for Models E & F
- No. 203 Screw to hold Covers C, G, E and F

CHECK MODEL AND SERIAL NUMBER OF MACHINE BEFORE ORDERING PARTS

Introducing

OTHER FORTUNA FINE LEATHER WORKING MACHINERY

- **STRIPPING MACHINES (Adjustable)**
Large, Medium and Small
- **CIRCULAR KNIFE GRINDER**
for Stripper Knives
- **EMBOSSING MACHINE**
with Foil Attachments
- **CREASING MACHINES (Adjustable)**
Single Edge & Double Edge
- **BEVELING MACHINE**
for Belts & Straps
- **END POINTING MACHINE**
- **POWER PRESS FOR DIE CUTTING**
- **HAND PRESS**
- **FOOT PRESS**
- **POLISHING MACHINE**
for Belt Ends and Open Edge Leather Goods
- **HOLE PUNCHING MACHINE**
- **CROWNING MACHINE**
Oval Cutting for Men's Belts
- **COMBINING MACHINES**
- **FOLDING MACHINES**
Light & Heavy Work
- **GLAZING & POLISHING MACHINES**
- **SOLE LEATHER SPLITTER**
- **WELTING MACHINERY**
Slitting, Notching, Combining
- **WEDGE CUTTING MACHINE**
Taps, Belt Loops
- **GLUEING MACHINES**
- **GUSSET CREASING**
for Brief Cases, etc.
- **COMBINED BEVELLING, DYEING AND POLISHING**
for Belts and Straps

Write for Descriptive Literature