

AMF

AMF Button Stitching Machine MK-80

Class/Division 84-4

**Instructions
and**

Parts Catalog

For Serial Numbers 1103 & Up

FIRST EDITION

April, 1980

AMF

APPAREL EQUIPMENT DIVISION

2115 W. Laburnum Avenue, Richmond, Virginia 23227 • 804-355-7961 • Télex 82-8316

AMF INCORPORATED

TRANSMISSION VERIFICATION REPORT

TIME: 05/30/1994 23:41
NAME: SUPERIOR SEWING
FAX : 4771116
TEL : 4775585

DATE, TIME	05/30 23:41
FAX NO./NAME	KANSTAR
DURATION	00:00:40
PAGE(S)	01
RESULT	OK
MODE	STANDARD

2

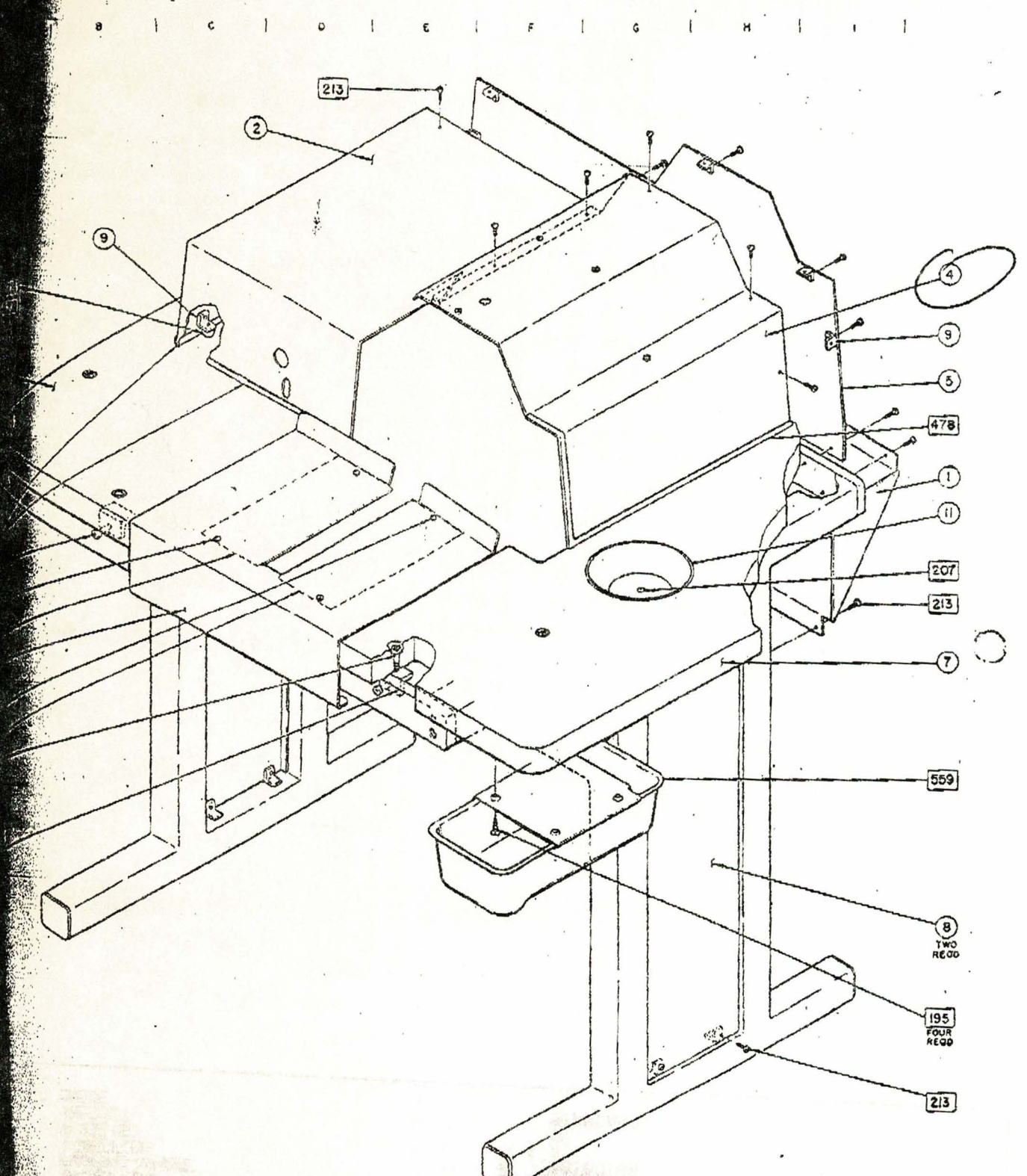

84-4 BUTTON STITCHING MACHINE
MK 80

COVERS & GUARDS

SERIAL NO. 1103 & UP

TRANSMISSION VERIFICATION REPORT

TIME: 05/30/1994 23:28
NAME: SUPERIOR SEWING
FAX : 4771116
TEL : 4775585

DATE, TIME	05/30 23:27
FAX NO./NAME	D G SEWING
DURATION	00:00:38
PAGE(S)	01
RESULT	OK
MODE	STANDARD

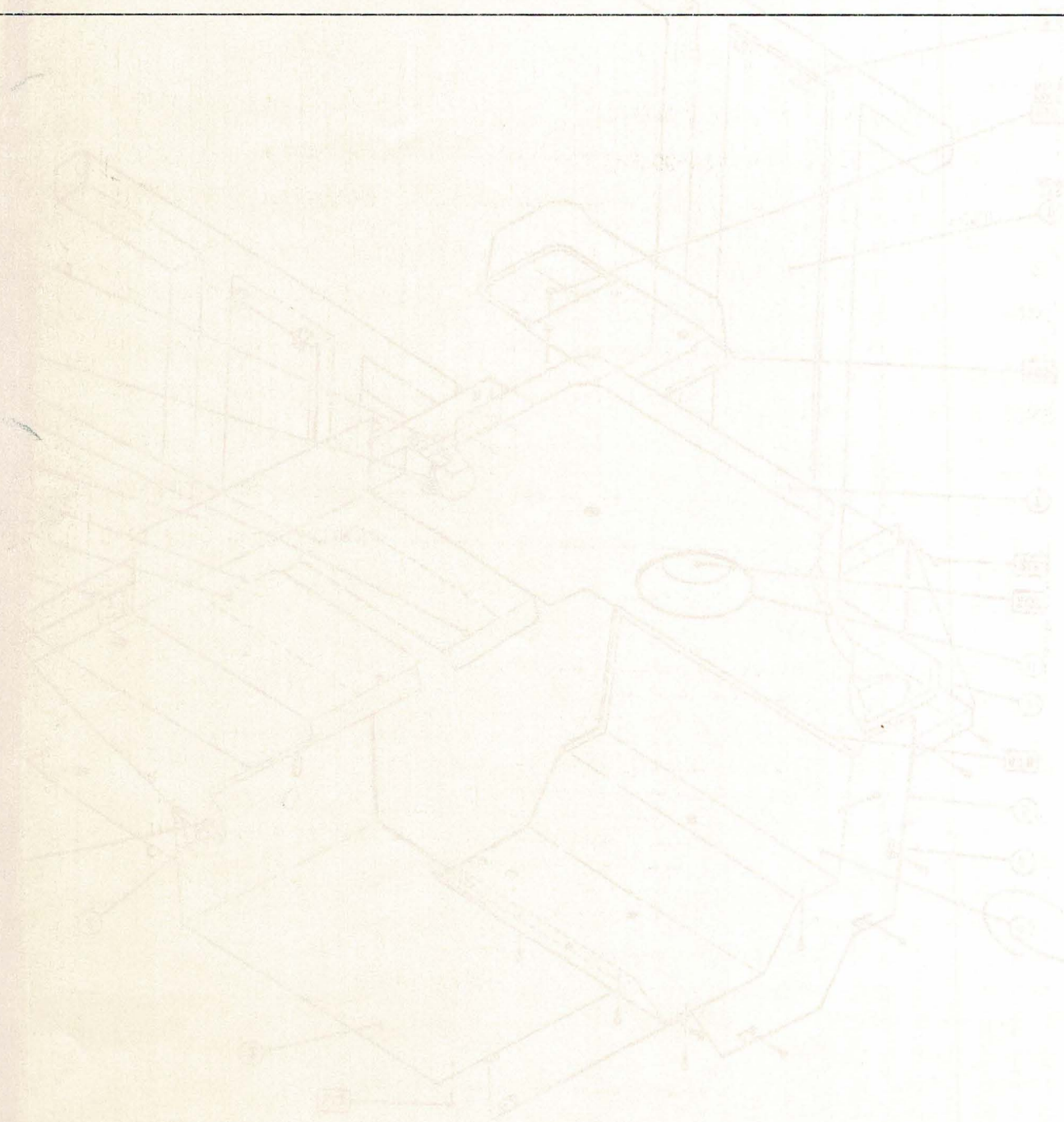

3

MF

AMF Button Stitching Machine - MK-80

PANEL EQUIPMENT

PARTS LIST

CLASS 84 - DIVISION 4

COVERS AND GUARDS
Metal No. 1103 & Up

ITEM NO.	DESCRIPTION	PART NO.
	Belt Cover-----	84-4-505A
	Worm Housing Cover-----	84-4-1310C6-12
	Table Cover-----	84-4-1400C2-14
	Needle Bar Head Cover-----	84-4-1450E1
	Rear Cover-----	84-4-1450F1
	Table Top - L.H.-----	84-4-32769-134
	Table Top - R.H.-----	84-4-32769-135
	Side Panel-----	84-4-34125-123 (2)
	Cover Mount Clip-----	84-4-34231-050 (7)
	Table Mount Clip-----	84-4-34231-051 (2)
	Button Dish-----	84-4-37152-053
	Hex. Soc. Button Head Screw-----	1/4-20 x 3/4 (2)
	Oval Flat Head Screw-----	1/4-20 x 2 (6)
	Flat Head Wood Screw-----	10 x 3/4 (4)
	Round Head Wood Screw-----	10 x 1/2
	Pan Head Screw-----	10-32 x 3/8 (38)
	Pan Head Screw-----	10-32 x 3/4 (2)
	Countersunk Finish Washer-----	1/4 (6)
	Black Sheet Rubber 1/16 Thick-----	4" x 9 1/2" (2)
	Gray PVC Edging Channel-----	1/16 Slot Width
30	"ATLANTIC" Rubber Bumper----- (22966-007)-----	#253
30	"SUPERIOR" Steel Drawer----- (27571-120)-----	#333 Gray

200LC2

1



750LA

			NO.	DESCRIPTION	PART NO.	
		84-4-500B	272	Spring Lockwasher-----	#8	(4)
2	Stop Arm-----	84-4-500C	273	Spring Lockwasher-----	#10	(10)
3	Pinion Shaft-----	84-4-500D	274	Spring Lockwasher-----	1/4	(4)
4	Pivot Bearing-----	84-4-500E				
5	Pivot Arm-----	84-4-500F	281	S.A.E. Flatwasher-----	#10	(11)
6	Gear-----	84-4-501A	287	U.S. Std. Flatwasher-----	#8	(4)
7	Retaining Block (4 hole)-----	84-4-501B-10				
	Retaining Block (2 hole)-optional-----	84-4-501B-11				
8	Spacer Ring (4 hole)-----	84-4-501C-10	296	Hex. Nut-----	10-32	(5)
	Spacer Ring (2 hole)-optional-----	84-4-501C-11	304	Hex. Locknut-----	1/4-28	(2)
9	Holding Pin-----	84-4-501D	(4) 325	"N.O." Ball Bearing----- (23231-045)	#77-R-4	
10	Torsion Spring-----	84-4-501E				
11	Spring Collar-----	84-4-501F	352	"OILITE" Bearing----- (23132-058)	#AA-304-2	
12	Chuck Latch Lever-----	84-4-502A	360	"OILITE" Bearing----- (23132-155)	#AA-507-2	
13	Pivot Cam-----	84-4-502B				
14	Mounting Bracket-----	84-4-502C	371	"OILITE" Bearing----- (23161-036)	#FF-520-5	(5)
15	Chuck Latch Bearing-----	84-4-502D				
16	Pinion-----	84-4-502E	381	"HEIM" Rod End Bearing-- (23912-020)	#HF-3C	
17	Cylinder Bracket-----	84-4-504A	383	"HEIM" Rod End Bearing-- (23912-033)	#HF-4C	(2)
18	Top Plate-----	84-4-504B				
104	Hex. Hd. Screw-----	10-32 x 3/4	(2)	424 "S.D.P." Spacer-----	#7x8-C08125	
				428 "S.D.P." Shoulder Screw (1/4x1/4)---	#9x25-0808	
132	Hex. Soc. Hd. Cap Screw-----	8-32 x 3/8	(4)	445 Hex. Soc. Shoulder Screw-----	1/4 Dia. x 1/2	
141	Hex. Soc. Hd. Cap Screw-----	10-32 x 3/8	(8)	449 Hex. Soc. Shoulder Screw-----	3/8 Dia. x 1 1/4	
142	Hex. Soc. Hd. Cap Screw-----	10-32 x 1/2		461 "WOODRUFF" Key-----	3/32 x 1/2	(3)
144	Hex. Soc. Hd. Cap Screw-----	10-32 x 3/4	(2)	471 "TRIARC" Ring----- (25379-220)	#5100-37	(2)
149	Hex. Soc. Hd. Cap Screw-----	1/4-20 x 5/8		479 "ATLANTIC" Bumper----- (22966-007)	#253	
150	Hex. Soc. Hd. Cap Screw-----	1/4-20 x 3/4	(4)	606 "BIMBA" Air Cylinder---- (25274-068)	#022-DXP	
151	Hex. Soc. Hd. Cap Screw-----	1/4-20 x 1		608 "BIMBA" Air Cylinder---- (25274-070)	#041-P	
158	Hex. Soc. Hd. Cap Screw-----	5/16-18 x 1	(2)	609 "BIMBA" Air Cylinder---- (25274-071)	#041-DP	
				612 "BIMBA" Pivot Bracket--- (25274-076)	#D12321-A	
176	Hex. Soc. Button Hd. Screw-----	10-32 x 3/8	(4)	613 "BIMBA" Pivot Bracket--- (25274-074)	#0-167	(2)
177	Hex. Soc. Button Hd. Screw-----	10-32 x 1/2	(2)	631 "IMPERIAL" Polyflow Tube-----	#44-P-1/4 Black	
205	Round Hd. Screw-----	10-32 x 1 1/4		636 "IMPERIAL" Connector---- (25527-101)	#268P-1/4x1/8	(3)
220	Hex. Soc. Set Screw-Cup Pt.-----	3/48 x 1/8	(4)	659 "CLIPPARD" Flow Control- (26112-D12)	#BFC-2	(2)
225	Hex. Soc. Set Screw-Cup Pt.-----	8-32 x 3/16				
229	Hex. Soc. Set Screw-Cup Pt.-----	10-32 x 1/4	(3)	664 "CLIPPARD" Coupling----- (25913-327)	#11999	(2)
240	Hex. Soc. Set Screw - Flat Pt. (Lockwell)-----	5-40 x 1/4	(4)			
241	Hex. Soc. Set Screw - Flat Pt.-----	10-32 x 3/4				
249	Hex. Soc. Set Screw - Oval Pt.-----	10-32 x 1				
257	Hex. Soc. Set Screw - Half Dog Pt.---	10-32 x 1/4	(2)			

Serial No. 1103 & up
BUTTON FEEDER

APPAREL EQUIPMENT

PARTS LIST

CLASS 84 • DIVISION 4

AMF

AMF Button Stitching Machine - MK-80

6

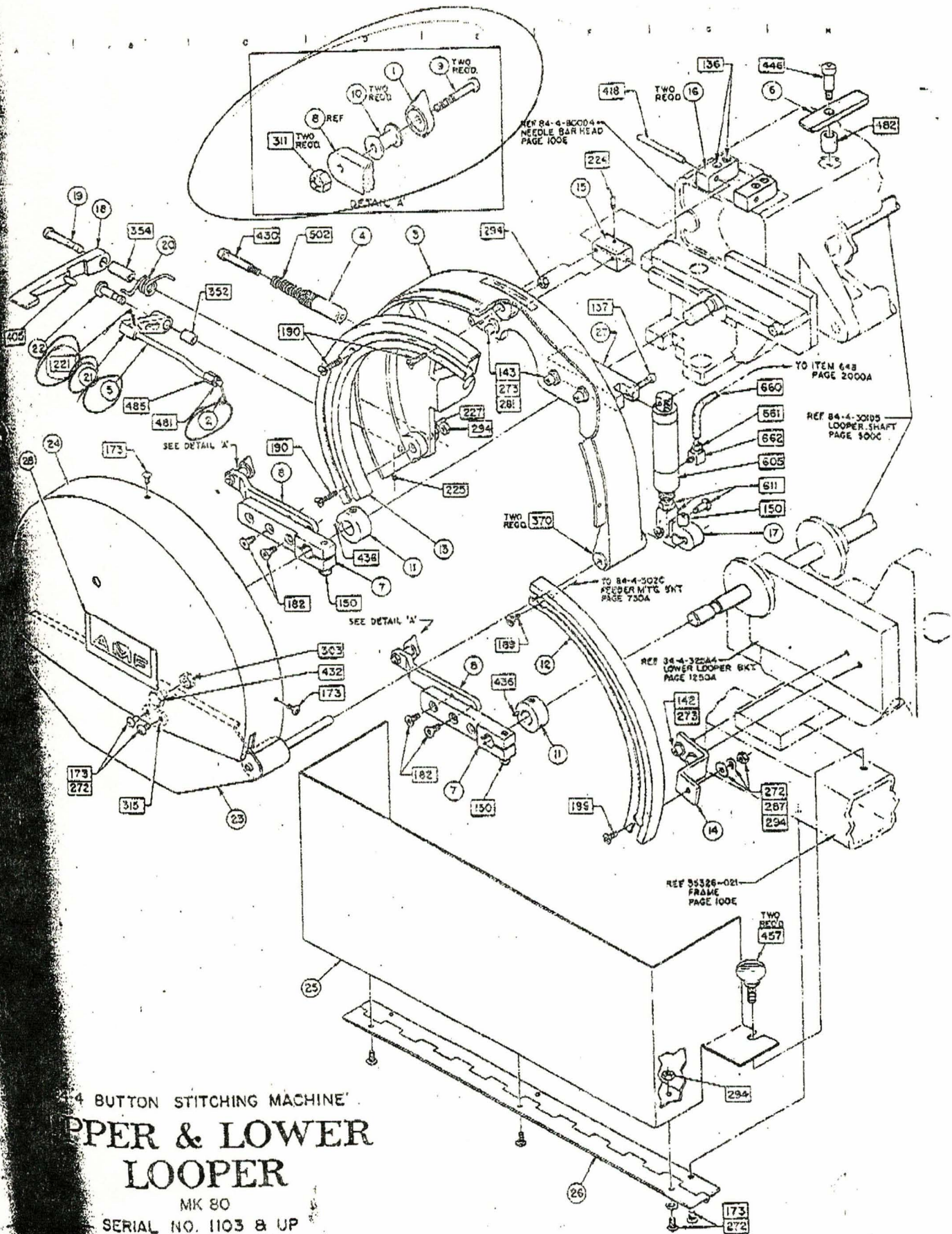

4 BUTTON STITCHING MACHINE
**UPPER & LOWER
 LOOPER**
 MK 80
 SERIAL NO. 1103 & UP



SERIAL NO. 1102 B UN
 MK 20
LOOPER
PER & FLOWER
 A BUTTON STITCHING MACHINE

7



AMF Button Stitching Machine - MK-80

APPAREL EQUIPMENT

PARTS LIST

CLASS 84 • DIVISION 4

NO. 1103 & Up

DESCRIPTION	PART NO.	ITEM NO.	DESCRIPTION	PART NO.
Upper Knife-----	59-78-111A1	(2)	315 "OHIO" Nutplate-----	#TP-1408
Needle Threader-----	59-83-1095F2		352 "OILITE" Bearing-----(23132-058)	#AA-304-2
Upper Looper Guard-----	84-4-302D6		354 "OILITE" Bearing-----(23132-061)	#AA-304-22
Upper Drum Lock-----	84-4-303D3			
Threader Rod-----	84-4-303F3-11		370 "OILITE" Bearing----- (23161-022)	#FF-312-2 (2)
Upper Guard Catch-----	84-4-312C3			
Upper Arm Bracket-----	84-4-314A5	(2)	405 "DANLY" Dowel (3/16 x 3/4)-----	#7-0612-1
Upper Arm-----	84-4-314B3	(2)		
Upper Stud-----	84-4-314D	(2)	418 "S.D.P." Dowel (3/16 x 2)-----	#9x31-0564
Upper Spacer-----	84-4-314E2	(2)	430 "S.D.P." Shoulderscrew-----	#9x25-0840
Upper Locating Collar-----	84-4-317A2	(2)	432 "S.D.P." Nylon Hex. Hd. Screw-----	#9M50-H12004
Upper Looper Tube-----	84-4-325B3			
Upper Looper Tube-----	84-4-325C3		436 "ESNA" Roll Pin-----	3/32 x 5/8 (2)
Upper Looper Tube Support-----	84-4-325D4		446 Hex. Soc. Shoulderscrew-----	1/4 x 5/8
Upper Looper Pivot-----	84-4-801A			
Upper Looper Pivot Lug-----	84-4-801B	(2)	457 Thumb Screw Type S-----	1/4-20 x 3/4 (2)
Upper Flap Lever-----	84-4-1409A2			
Upper Lever-----	84-4-1409E		481 "R.A.F." Spacer----- (27511-976)	#1153-10-S-1
Upper Lever Stud-----	84-4-1409F		482 "R.A.F." Spacer----- (27511-977)	#1220-25-S-1
Upper Lever Spring-----	84-4-1410A		485 "R.A.F." Spacer----- (27511-983)	#2168-1032-S-1
Upper Arm-----	84-4-1410B-11			
Upper Arm Stud-----	84-4-1410C		502 "LEE" Comp. Spring----- (24971-069)	#LC-032E-12
Upper Guard Flap-----	84-4-1410F1			
Upper Guard Cover-----	84-4-1411A2		605 "BIMBA" Air Cyl.----- (25274-037)	#021-DXP →
Upper Looper Guard-----	84-4-1411C2		611 "BIMBA" Rod Clevis----- (25274-077)	#D-850
Upper Looper Guard Hinge-----	84-4-1411D2			
Upper Flap Cylinder Bracket-----	84-4-1430A		660 "CLIPPARD" Urethane Hose-----	#3814-6 Blue
Upper Plate-----	84-4-37711-025		661 "CLIPPARD" Fitting----- (25913-321)	#11752-3
			662 "CLIPPARD" Fitting----- (25913-329)	#15002-1
Soc. Hd. Cap Screw-----	8-32 x 3/4	(4)		
Soc. Hd. Cap Screw-----	8-32 x 7/8			
Soc. Hd. Cap Screw-----	10-32 x 1/2	(2)		
Soc. Hd. Cap Screw-----	10-32 x 5/8	(4)		
Soc. Hd. Cap Screw-----	1/4-20 x 3/4	(3)		
Soc. Button Head Screw-----	8-32 x 1/4	(11)		
Soc. Flat Hd. Screw-----	10-32 x 3/8	(4)		
Hd. Screw-----	8-32 x 3/8	(2)		
Hd. Screw-----	8-32 x 3/4	(3)		
Soc. Hd. Set Screw-Cup Pt.-----	5-40 x 3/16			
Soc. Hd. Set Screw-Cup Pt.-----	6-32 x 3/8			
Soc. Hd. Set Screw-Cup Pt.-----	8-32 x 3/16			
Soc. Hd. Set Screw-Cup Pt.-----	8-32 x 1/2			
Washer Lockwasher-----	#8	(9)		
Washer Lockwasher-----	#10	(6)		
Washer Flatwasher-----	#10	(4)		
Washer Std. Flatwasher-----	#8			
Nut-----	8-32	(7)		
Locknut-----	1/4-20			
"LOC" Locknut (5-40)-----	#21FA-540	(2)		

AMF Button Stitching Machine - MK-80

PARTS LIST

PANEL EQUIPMENT

CLASS 80 - DIVISION 8

ITEM NO.	DESCRIPTION	PART NO.	QTY
101	1/2" Dia. Bolt	84-4-1010	1
102	1/2" Dia. Nut	84-4-1020	1
103	1/2" Dia. Washer	84-4-1030	1
104	1/2" Dia. Flat Washer	84-4-1040	1
105	1/2" Dia. Lock Washer	84-4-1050	1
106	1/2" Dia. Hex Nut	84-4-1060	1
107	1/2" Dia. Hex Bolt	84-4-1070	1
108	1/2" Dia. Hex Washer	84-4-1080	1
109	1/2" Dia. Hex Flat Washer	84-4-1090	1
110	1/2" Dia. Hex Lock Washer	84-4-1100	1
111	1/2" Dia. Hex Nut	84-4-1110	1
112	1/2" Dia. Hex Bolt	84-4-1120	1
113	1/2" Dia. Hex Washer	84-4-1130	1
114	1/2" Dia. Hex Flat Washer	84-4-1140	1
115	1/2" Dia. Hex Lock Washer	84-4-1150	1
116	1/2" Dia. Hex Nut	84-4-1160	1
117	1/2" Dia. Hex Bolt	84-4-1170	1
118	1/2" Dia. Hex Washer	84-4-1180	1
119	1/2" Dia. Hex Flat Washer	84-4-1190	1
120	1/2" Dia. Hex Lock Washer	84-4-1200	1
121	1/2" Dia. Hex Nut	84-4-1210	1
122	1/2" Dia. Hex Bolt	84-4-1220	1
123	1/2" Dia. Hex Washer	84-4-1230	1
124	1/2" Dia. Hex Flat Washer	84-4-1240	1
125	1/2" Dia. Hex Lock Washer	84-4-1250	1
126	1/2" Dia. Hex Nut	84-4-1260	1
127	1/2" Dia. Hex Bolt	84-4-1270	1
128	1/2" Dia. Hex Washer	84-4-1280	1
129	1/2" Dia. Hex Flat Washer	84-4-1290	1
130	1/2" Dia. Hex Lock Washer	84-4-1300	1
131	1/2" Dia. Hex Nut	84-4-1310	1
132	1/2" Dia. Hex Bolt	84-4-1320	1
133	1/2" Dia. Hex Washer	84-4-1330	1
134	1/2" Dia. Hex Flat Washer	84-4-1340	1
135	1/2" Dia. Hex Lock Washer	84-4-1350	1
136	1/2" Dia. Hex Nut	84-4-1360	1
137	1/2" Dia. Hex Bolt	84-4-1370	1
138	1/2" Dia. Hex Washer	84-4-1380	1
139	1/2" Dia. Hex Flat Washer	84-4-1390	1
140	1/2" Dia. Hex Lock Washer	84-4-1400	1
141	1/2" Dia. Hex Nut	84-4-1410	1
142	1/2" Dia. Hex Bolt	84-4-1420	1
143	1/2" Dia. Hex Washer	84-4-1430	1
144	1/2" Dia. Hex Flat Washer	84-4-1440	1
145	1/2" Dia. Hex Lock Washer	84-4-1450	1
146	1/2" Dia. Hex Nut	84-4-1460	1
147	1/2" Dia. Hex Bolt	84-4-1470	1
148	1/2" Dia. Hex Washer	84-4-1480	1
149	1/2" Dia. Hex Flat Washer	84-4-1490	1
150	1/2" Dia. Hex Lock Washer	84-4-1500	1

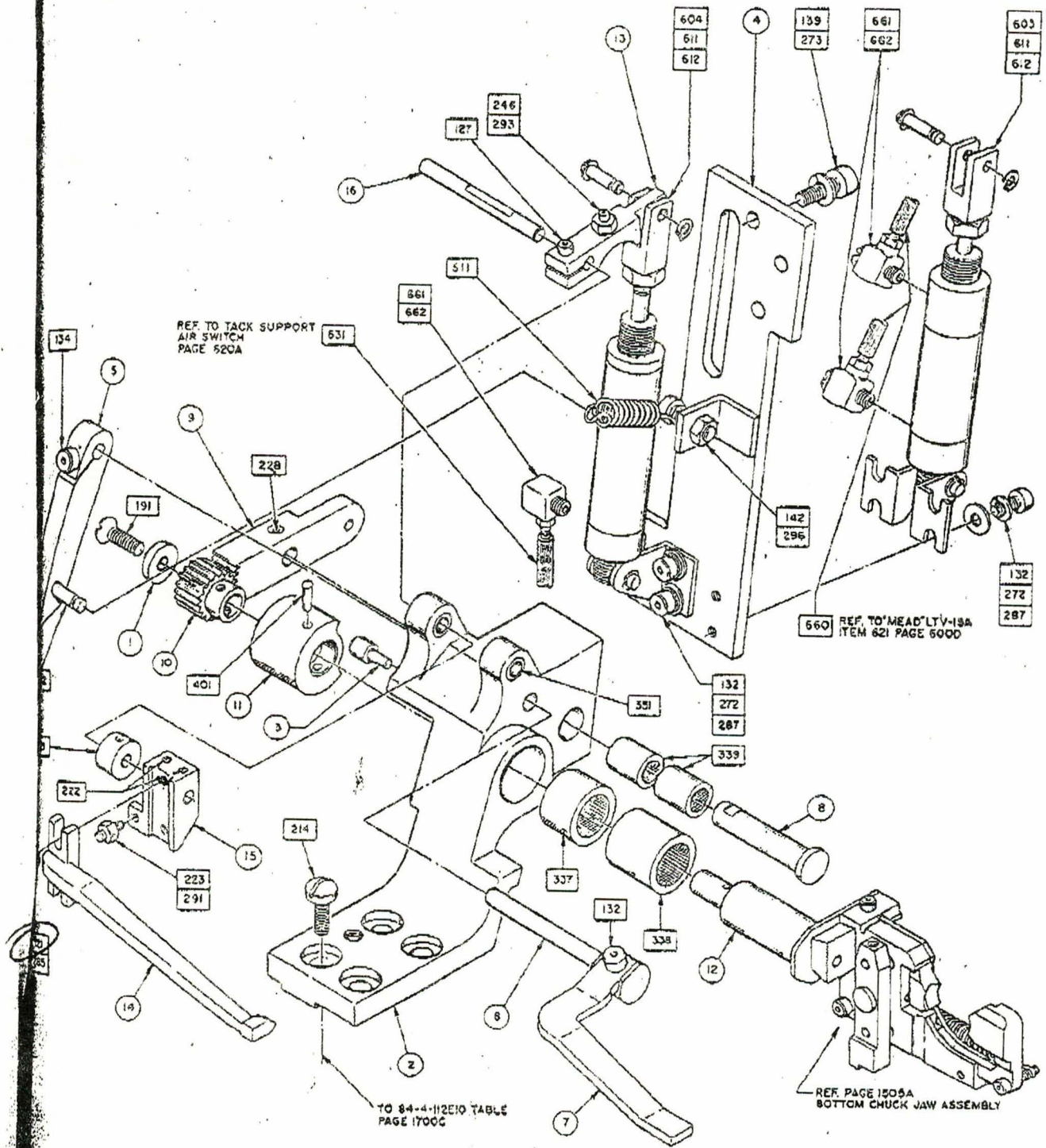

84-4 BUTTON STITCHING MACHINE BUTTON CHUCK

MK 80
SERIAL NO. 1103 & UP

BUTTON CHECK
64-4 BUTTON STITCHING MACHINE

SERIAL NO. 103 6 UP
MK 32



9



AMF Button Stitching Machine - MK-80

APPAREL EQUIPMENT

PARTS LIST

BUTTON CHUCK

CLASS 84 • DIVISION 4

Serial No. 1103 & Up

ITEM NO.	DESCRIPTION	PART NO.
1	Chuck Gear Washer-----	84-4-121C
2	Button Chuck Bracket-----	84-4-903A14
3	Stop Pin-----	84-4-903C2
4	Cylinder Plate-----	84-4-903E
5	Ironer Lever-----	84-4-910B3
6	Ironer Shaft-----	84-4-910C2
7	Work Ironer-----	84-4-910E2-12
8	Sector Pin-----	84-4-911B1
9	Sector Gear-----	84-4-911C4
10	Chuck Gear-----	84-4-912A1
11	Chuck Stop-----	84-4-912B1
12	Chuck Shank-----	84-4-921C6
13	Pivot Arm-----	84-4-923D2
14	Tacking Support-----	84-4-924A4
15	Adjusting Block-----	84-4-924D
16	Support Pivot-----	84-4-924F
21	Hex. Soc. Hd. Cap Screw-----	5-40 x 3/8 (2)
27	Hex. Soc. Hd. Cap Screw-----	6-40 x 3/8
32	Hex. Soc. Hd. Cap Screw-----	8-32 x 3/8 (9)
34	Hex. Soc. Hd. Cap Screw-----	8-32 x 1/2
39	Hex. Soc. Hd. Cap Screw-----	10-24 x 1/2 (3)
42	Hex. Soc. Hd. Cap Screw-----	10-32 x 1/2
91	Flat Hd. Screw-----	10-32 x 3/8
14	Binding Hd. Screw-----	10-32 x 1/2 (4)
222	Hex. Soc. Hd. Set Screw-Cup Pt.-----	5-40 x 1/4 (2)
223	Hex. Soc. Hd. Set Screw-Cup Pt.-----	5-40 x 1/2
228	Hex. Soc. Hd. Set Screw-Cup Pt.-----	10-32 x 3/16
246	Hex. Soc. Hd. Set Screw Oval Pt.-----	6-40 x 1/2
272	Spring Lockwasher-----	#8 (8)
273	Spring Lockwasher-----	#10
285	U.S. Std. Flatwasher-----	#5
287	U.S. Std. Flatwasher-----	#8 (8)
291	Hex. Nut-----	5-40
293	Hex. Nut-----	6-40
296	Hex. Nut-----	10-32
317	"TORRINGTON" Needle Bearing----- (23583-210)	#GB-98
338	"TORRINGTON" Needle Bearing----- (23583-230)	#GB912
339	"TORRINGTON" Needle Bearing----- (23583-185)	#GB-55 (2)
351	"OILITE" Sleeve Bearing----- (23132-024)	#AA-226-1 (2)
401	Taper Pin-----	#000 x 7/8
492	"GROOV-PIN" Spring Post (3/16 x 3/4)-----	#GP67-188 x.750-10
511	"LEE" Extension Spring----- (24973-036)	#LE037CD-5
521	"BOSTON" Set Collar (3/16)----- (24116-020)	#SC-18
543	"BIMBA" Air Cylinder----- (25274-064)	#020.5-DXP → 1
547	"BIMBA" Air Cylinder----- (25274-066)	#021-P → 1
548	"BIMBA" Rod Clevis----- (25274-077)	#D-850 (2)
549	"BIMBA" Pivot Bracket----- (25274-076)	#D-12321-A (2)
552	IMPERIAL-EASTMAN Polyflow Tubing-----	#4-P-1/4 (Black)
	"CLIPPARD" Hose (Urethane)-----	#3814-6 (Blue)
	"CLIPPARD" Hose Fitting----- (25913-321)	#11752-3 (3)
	"CLIPPARD" L-Fitting----- (25913-329)	#15002-1 (3)

AMF Button Stitching Machine - MK-80

AMF

PARTS LIST

APPAREL EQUIPMENT

CLASS 84 - DIVISION 4

WITON CHICK

Serial No. 1102 1. 10

PART NO.	DESCRIPTION	QTY
01-01-010	COVER REAR PLATE	1
01-01-011	COVER FRONT PLATE	1
01-01-012	WASHER	1
01-01-013	WASHER BRUSH	1
01-01-014	WASHER BRUSH BRACKET	1
01-01-015	WASHER BRUSH BRACKET BRACKET	1
01-01-016	WASHER BRUSH BRACKET BRACKET	1
01-01-017	WASHER BRUSH BRACKET BRACKET	1
01-01-018	WASHER BRUSH BRACKET BRACKET	1
01-01-019	WASHER BRUSH BRACKET BRACKET	1
01-01-020	WASHER BRUSH BRACKET BRACKET	1
01-01-021	WASHER BRUSH BRACKET BRACKET	1
01-01-022	WASHER BRUSH BRACKET BRACKET	1
01-01-023	WASHER BRUSH BRACKET BRACKET	1
01-01-024	WASHER BRUSH BRACKET BRACKET	1
01-01-025	WASHER BRUSH BRACKET BRACKET	1
01-01-026	WASHER BRUSH BRACKET BRACKET	1
01-01-027	WASHER BRUSH BRACKET BRACKET	1
01-01-028	WASHER BRUSH BRACKET BRACKET	1
01-01-029	WASHER BRUSH BRACKET BRACKET	1
01-01-030	WASHER BRUSH BRACKET BRACKET	1
01-01-031	WASHER BRUSH BRACKET BRACKET	1
01-01-032	WASHER BRUSH BRACKET BRACKET	1
01-01-033	WASHER BRUSH BRACKET BRACKET	1
01-01-034	WASHER BRUSH BRACKET BRACKET	1
01-01-035	WASHER BRUSH BRACKET BRACKET	1
01-01-036	WASHER BRUSH BRACKET BRACKET	1
01-01-037	WASHER BRUSH BRACKET BRACKET	1
01-01-038	WASHER BRUSH BRACKET BRACKET	1
01-01-039	WASHER BRUSH BRACKET BRACKET	1
01-01-040	WASHER BRUSH BRACKET BRACKET	1
01-01-041	WASHER BRUSH BRACKET BRACKET	1
01-01-042	WASHER BRUSH BRACKET BRACKET	1
01-01-043	WASHER BRUSH BRACKET BRACKET	1
01-01-044	WASHER BRUSH BRACKET BRACKET	1
01-01-045	WASHER BRUSH BRACKET BRACKET	1
01-01-046	WASHER BRUSH BRACKET BRACKET	1
01-01-047	WASHER BRUSH BRACKET BRACKET	1
01-01-048	WASHER BRUSH BRACKET BRACKET	1
01-01-049	WASHER BRUSH BRACKET BRACKET	1
01-01-050	WASHER BRUSH BRACKET BRACKET	1
01-01-051	WASHER BRUSH BRACKET BRACKET	1
01-01-052	WASHER BRUSH BRACKET BRACKET	1
01-01-053	WASHER BRUSH BRACKET BRACKET	1
01-01-054	WASHER BRUSH BRACKET BRACKET	1
01-01-055	WASHER BRUSH BRACKET BRACKET	1
01-01-056	WASHER BRUSH BRACKET BRACKET	1
01-01-057	WASHER BRUSH BRACKET BRACKET	1
01-01-058	WASHER BRUSH BRACKET BRACKET	1
01-01-059	WASHER BRUSH BRACKET BRACKET	1
01-01-060	WASHER BRUSH BRACKET BRACKET	1
01-01-061	WASHER BRUSH BRACKET BRACKET	1
01-01-062	WASHER BRUSH BRACKET BRACKET	1
01-01-063	WASHER BRUSH BRACKET BRACKET	1
01-01-064	WASHER BRUSH BRACKET BRACKET	1
01-01-065	WASHER BRUSH BRACKET BRACKET	1
01-01-066	WASHER BRUSH BRACKET BRACKET	1
01-01-067	WASHER BRUSH BRACKET BRACKET	1
01-01-068	WASHER BRUSH BRACKET BRACKET	1
01-01-069	WASHER BRUSH BRACKET BRACKET	1
01-01-070	WASHER BRUSH BRACKET BRACKET	1
01-01-071	WASHER BRUSH BRACKET BRACKET	1
01-01-072	WASHER BRUSH BRACKET BRACKET	1
01-01-073	WASHER BRUSH BRACKET BRACKET	1
01-01-074	WASHER BRUSH BRACKET BRACKET	1
01-01-075	WASHER BRUSH BRACKET BRACKET	1
01-01-076	WASHER BRUSH BRACKET BRACKET	1
01-01-077	WASHER BRUSH BRACKET BRACKET	1
01-01-078	WASHER BRUSH BRACKET BRACKET	1
01-01-079	WASHER BRUSH BRACKET BRACKET	1
01-01-080	WASHER BRUSH BRACKET BRACKET	1
01-01-081	WASHER BRUSH BRACKET BRACKET	1
01-01-082	WASHER BRUSH BRACKET BRACKET	1
01-01-083	WASHER BRUSH BRACKET BRACKET	1
01-01-084	WASHER BRUSH BRACKET BRACKET	1
01-01-085	WASHER BRUSH BRACKET BRACKET	1
01-01-086	WASHER BRUSH BRACKET BRACKET	1
01-01-087	WASHER BRUSH BRACKET BRACKET	1
01-01-088	WASHER BRUSH BRACKET BRACKET	1
01-01-089	WASHER BRUSH BRACKET BRACKET	1
01-01-090	WASHER BRUSH BRACKET BRACKET	1
01-01-091	WASHER BRUSH BRACKET BRACKET	1
01-01-092	WASHER BRUSH BRACKET BRACKET	1
01-01-093	WASHER BRUSH BRACKET BRACKET	1
01-01-094	WASHER BRUSH BRACKET BRACKET	1
01-01-095	WASHER BRUSH BRACKET BRACKET	1
01-01-096	WASHER BRUSH BRACKET BRACKET	1
01-01-097	WASHER BRUSH BRACKET BRACKET	1
01-01-098	WASHER BRUSH BRACKET BRACKET	1
01-01-099	WASHER BRUSH BRACKET BRACKET	1
01-01-100	WASHER BRUSH BRACKET BRACKET	1

10

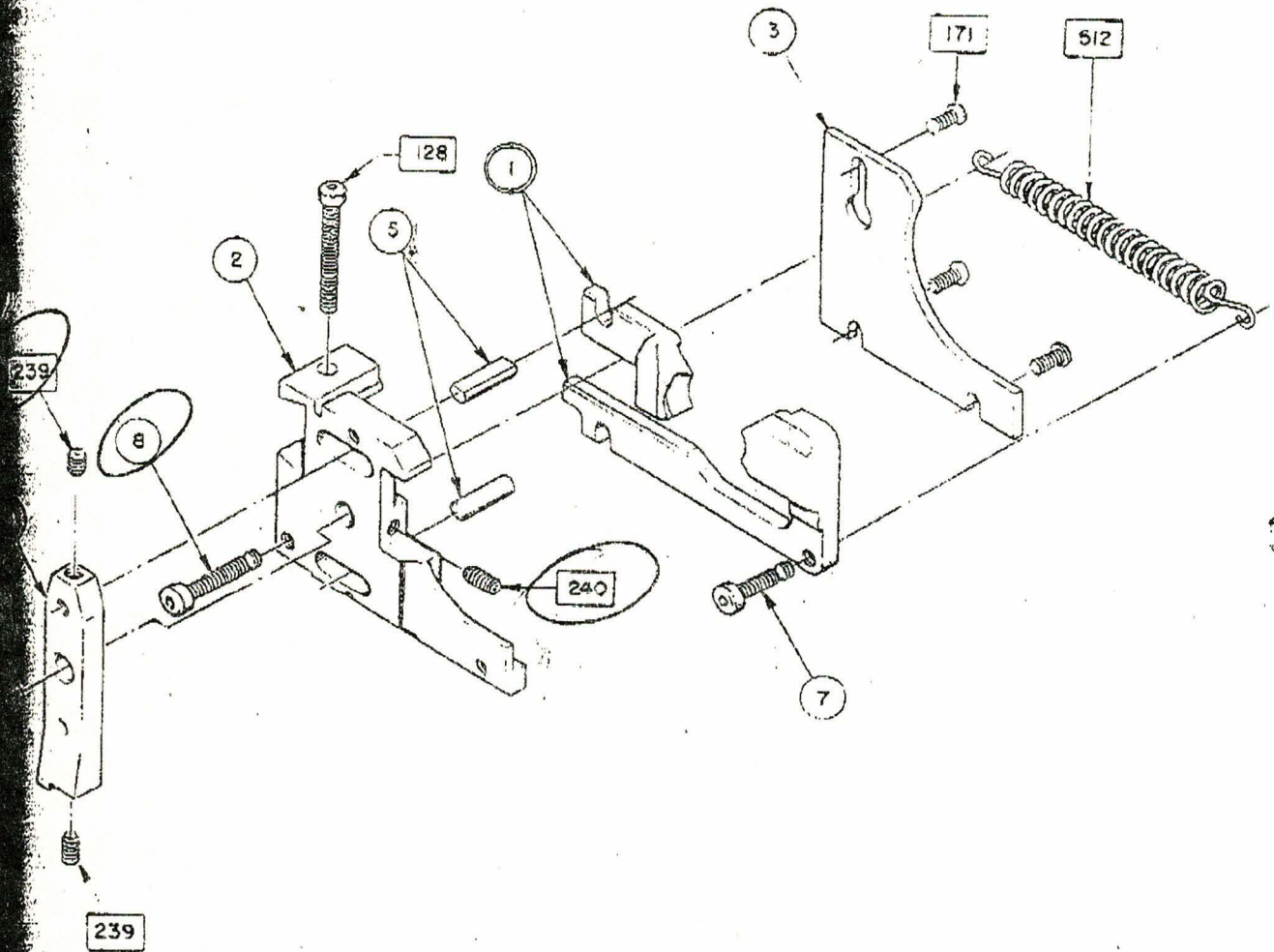

84-4 BUTTON STITCHING MACHINE
BUTTON CHUCK JAW ASSEMBLY

MK 80

SERIAL NO. 1103 & UP



2-4 BUTTON STITCHING MACHINE
BUTTON CHECK JAW ASSEMBLY

MR. 80

SERIAL NO. 103 B UP
90 8 201 JAW ASSEMBLY

110

AMF**AMF Button Stitching Machine - MK-80****APPAREL EQUIPMENT****PARTS LIST**BUTTON CHUCK JAW ASSEMBLY
Serial No. 1103 & Up

CLASS 84 • DIVISION 4

ITEM NO.	DESCRIPTION	PART NO.
1	Button Chuck Jaw (22-40 Ligne)-----	84-4-920C5-30
	Button Chuck Jaw (27-45 Ligne Heavy Mat.) Optional-----	84-4-920C5-31
	Button Chuck Jaw (20-38 Ligne) Optional-----	84-4-920C5-32
	Button Chuck Jaw (27-45 Ligne)-----	84-4-920C5-33
2	Chuck Body-----	84-4-921A6-12
3	Chuck Body Cover-----	84-4-921B3-12
4	Chuck Operating Lever-----	84-4-922A8-12
5	Chuck Operating Pin-----	84-4-922B2 (2)
6	Fulcrum Pin-----	84-4-922C2
7	Jaw Spring Post-----	84-4-925E-10 (2)
8	Body Spring Post-----	84-4-925E-11
28	Hex. Soc. Hd. Cap Screw-----	6-40 x 7/8
71	Hex. Soc. Button Hd. Screw-----	5-40 x 1/4 (3)
39	Hex. Soc. Set Screw--Flat Pt.-----	5-40 x 3/16 (2)
40	Hex. Soc. Set Screw--Flat Pt.-----	5-40 x 1/4
12	"LEE" Extension Spring---(24973-041)-----	#LE-041C-7

NOTE: Item 1 Button Chuck Jaw Consist of matched machined inner & outer Jaws and must be ordered as a set with Spring Post Item 7.

AMF Button Stitching Machine - MK-80



PARTS LIST

APPAREL EQUIPMENT

CLASS 88 - DIVISION 8

BUTTON CHUCK JAW ASSEMBLY
Serial No. 1103 & Up

PART NO.	DESCRIPTION	QTY
84-4-2507-30	Button Chuck Jaw (25-40 Line)	1
84-4-2508-31	Button Chuck Jaw (25-40 Line Heavy Mat.) (Optional)	1
84-4-2509-32	Button Chuck Jaw (25-35 Line) (Optional)	1
84-4-2510-33	Button Chuck Jaw (25-45 Line)	1
84-4-2511-10	Chuck Body	1
84-4-2512-10	Chuck Body Cover	1
84-4-2513-10	Chuck Operating Lever	1
84-4-2514-10	Chuck Operating Pin	1
84-4-2515-10	Chuck Pin	1
84-4-2516-10	Jaw Spring Post	1
84-4-2517-10	Body Spring Post	1
8-40 x 7/8	Hex. Soc. Hd. Cap Screw	(2)
8-40 x 7/8	Hex. Soc. Button Hd. Screw	(2)
8-40 x 3/16	Hex. Soc. Set Screw - Flat Pt.	(2)
8-40 x 1/4	Hex. Soc. Set Screw - Flat Pt.	(2)
8-E-0410-7	"LEE" Extension Spring - (2493-DAT)	1

NOTE: Item 1 Button Chuck Jaw consists of matched
retained inner & outer jaws and must be
ordered as a set with Spring Post Item 7.

12



AMF Button Stitching Machine - MK-80

CLOTHING APPAREL EQUIPMENT

CLASS 84 - DIVISION 4

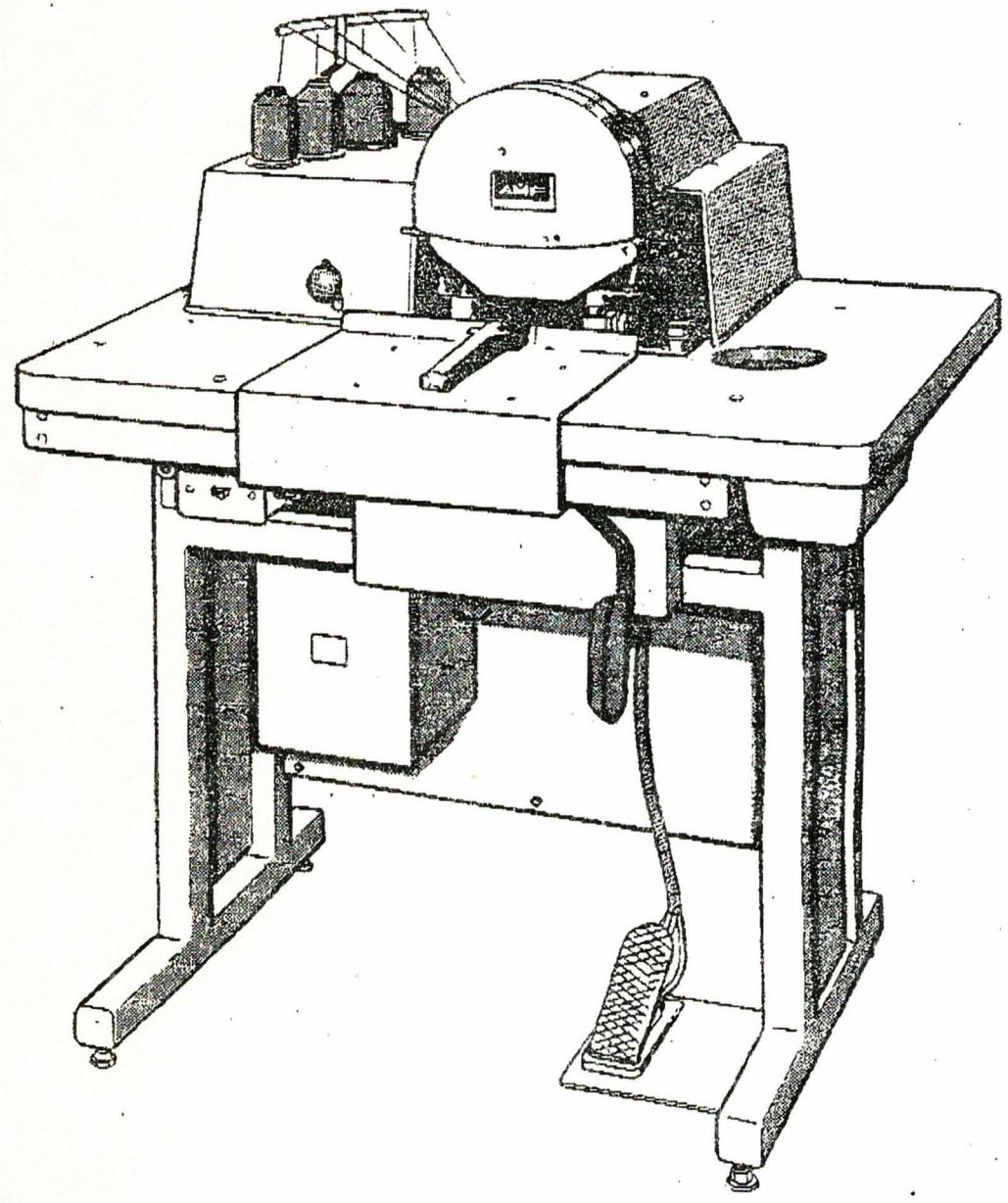

17

AMF Button Stitching Machine - MK-80

PARCEL EQUIPMENT

CLASS 84 - DIVISION A

