

FINEST QUALITY

Union Special®

LEWIS • COLUMBIA

INDUSTRIAL
SEWING
MACHINES

CLASS
61900

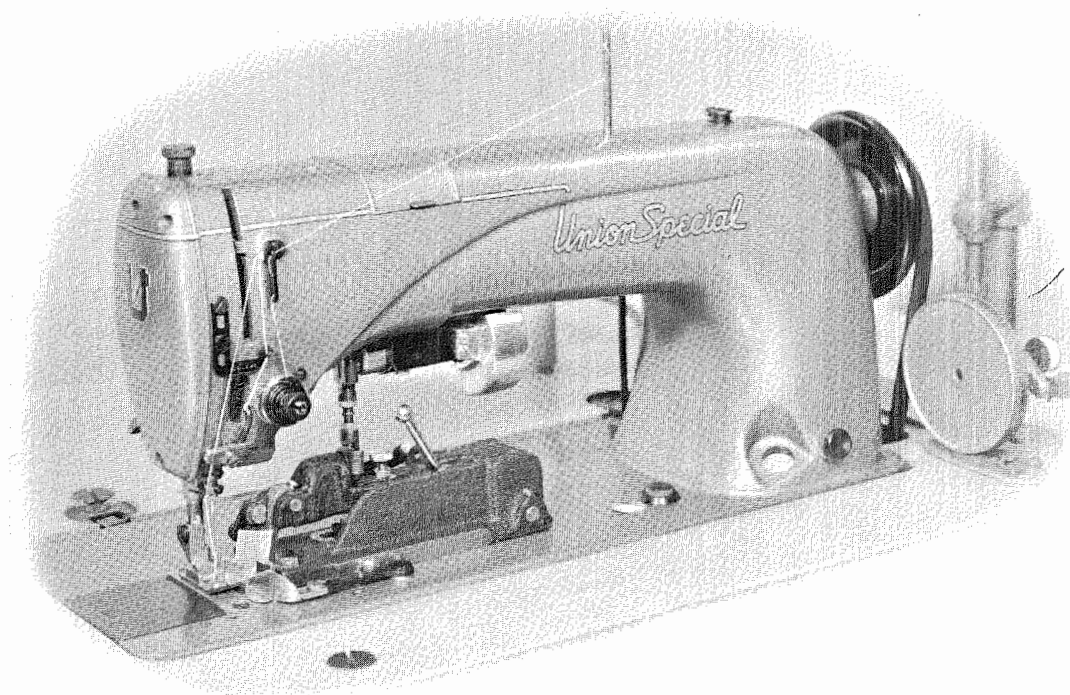

CATALOG
NO.
T108 N

LIST OF PARTS FOR STYLES

61900 N

61900 P

Union Special MACHINE COMPANY

CHICAGO

INDUSTRIAL SEWING MACHINES

...for Every Purpose!

Job requirements vary — that's why Union Special builds a wide variety of specially designed sewing machines. It is also the reason why Union Special field representatives make a careful study of requirements before giving you detailed recommendations on the kind of equipment to install. Plants equipped with modern, high speed Union Specials have an important advantage. Union Special machines are built to do the job faster . . . better . . . cheaper, and they stay on the job with minimum time out for repairs. You're ahead when you use Union Special.

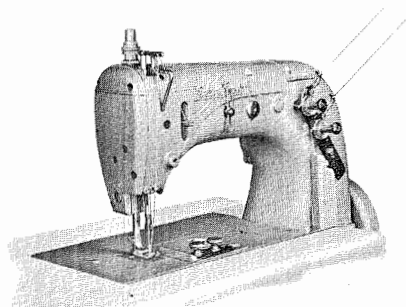

50000 SERIES MACHINES

The thousands of manufacturers using Union Special's new 50000 SERIES machines are finding these ultra-modern, streamlined models to be invaluable aids in cutting costs of operations and boosting production of a wide variety of products. Each of the many machines in the improved 50000 SERIES is specially designed to do a specific job efficiently, quickly, and economically!

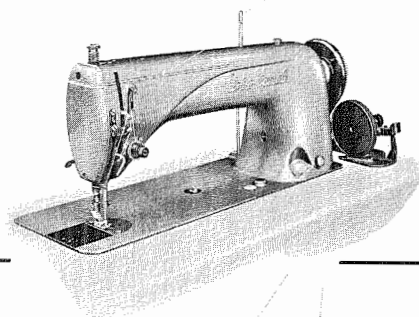

THE 61400 LOCKSTITCH

Never before has a general purpose Lockstitch machine been so thoroughly engineered for handling modern industrial sewing requirements! And never has a machine offered more than the new Union Special SIXTY-ONE-FOUR — a superior machine for light or heavy weight work . . . for short runs as well as long . . . for tacking and back stitching . . . for curved seams and straight runs.

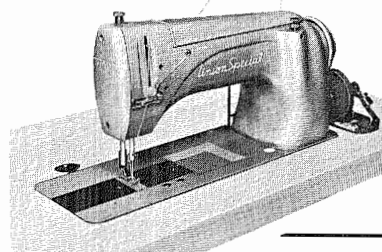

NEEDLE FEED LOCKSTITCH MACHINES

Latest improvements in engineering, manufacturing methods, and materials have been combined in Union Special Class 61800 and Class 62200 needle feed Lockstitch machines providing operators with smooth, streamlined, light-running machines that reduce fatigue and strain. It's no wonder that manufacturers in plants throughout the country are praising the superior performance of these ultra-modern machines!

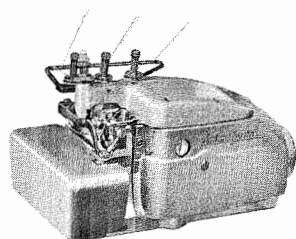

THE NEW CLASS 39500 OVEREDGER

This new development antiquates every machine presently on the market for use where a curved needle machine is recommended. From its handsome, dynamically functional, modern design to its innermost mechanism, the THIRTY-NINE-FIVE has been produced to accelerate quicker . . . run faster . . . operate more smoothly and quietly . . . with less maintenance . . . and yield a greater profit than any other like equipment available to users today.

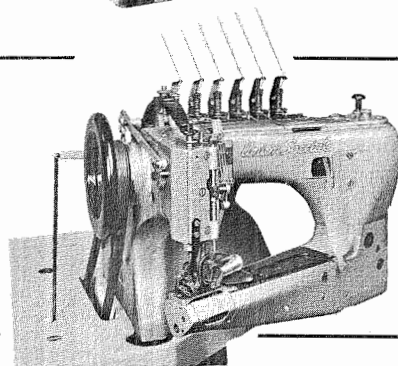

35700-35800 FEED-OFF-THE-ARM MACHINES

Union Special's popular feed-off-the-arm felling machines are light running, smooth operating machines that offer great advantages: sewing head of the latest type, new presser bar which practically eliminates feed marking, and presser foot which will lift at the lightest touch. Faster felling is certain with Union Special Class 35700-35800 feed-off-the-arm machines.

Catalog No. T108 N

LIST OF PARTS

CLASS 61900

Styles

61900 N

61900 P

The parts listed in this catalog are
furnished at list prices for repairs only.

First Edition

Copyright 1961
by
Union Special Machine Co.
Rights Reserved in All Countries

Union Special
MACHINE COMPANY
INDUSTRIAL SEWING MACHINES
CHICAGO

Printed in U.S.A.

IDENTIFICATION OF MACHINES

Each Union Special machine is identified by a Style number which is stamped into the name plate on the machine.

Machines similar in construction are grouped by a class number, which contains no letters. Example: "61900". Letters suffixed to a class number indicates the standard Style of a machine. Example: "61900 N". The letter "Z" is reserved as a suffix to the standard Style identification to specify machine is of "Special" construction. Example: "61900 NZ".

APPLICATION OF CATALOG

This catalog applies specifically to the standard styles of machines as listed herein. It can also be applied with discretion to some Special styles of machines in Class 61900. References to direction, such as right, left, front, back, etc., are taken from the operator's position while seated at the machine. Operating direction of handwheel is toward the operator.

STYLES OF MACHINES IN CLASS 61900

Streamlined Flat Bed Lockstitch Machine, Single Needle, Light Duty, Prepared for Pinking Attachment, Needle Feed and Drop Feed, Rotary Hook, Horizontal Hook Shaft, Push Button Stitch Regulator, One Reservoir Enclosed Automatic Lubricating System for Main Driving Mechanism, Separate Reservoir for Automatic Lubrication of Rotary Hook, Upper Left Head Mechanism Manually Lubricated, 1 9/64 Inch Needle Bar Travel.

61900 N For simultaneously seaming and pinking wash and wear fabrics and other light weight materials. Width of pink 5/16 inch and 3 rows of feed. Seam specification 301-SSa-1. Stitch range 9 to 18 per inch.

61900 P For simultaneously seaming and pinking wash and wear fabrics and other light weight materials. Width of pink 3/8 inch and 2 rows of feed. Seam specification 301-SSa-1. Stitch range 9 to 18 per inch.

NEEDLES

Each Union Special needle has both a type number and a size number. The type number denotes the kind of shank, point, length, groove, finish and other details. The size number, stamped on the needle shank, denotes the largest diameter of the blade measured in thousandths of an inch across the eye. Collectively, the type number and size number is the complete symbol.

To have orders promptly and accurately filled, forward the empty package, a sample needle, or the type and size number should be given. See description on packages. A complete order would read: "1000 Needles, Type 180 GXS, Size 036".

Standard needle for machine Style 61900 N or 61900 P is Type 180 GXS. It has a round shank, round point, lockstitch, short length, ball eye, single groove, wide angle groove, struck groove, deep spot, ball point, and is chromium plated. Available in sizes 028, 032, 036, 040, 044, 048, 054, 060.

Selection of proper needle size should be determined by size of thread used. Thread should pass freely through needle eye in order to produce a good stitch formation.

For best results, use only genuine Union Special needles in the operation of these machines. They are packaged under our brand name, *Union Special* which is backed by a reputation for producing highest quality needles for more than three-quarters of a century.

IDENTIFYING PARTS

Where the construction permits, each part is stamped with its part number. On some smaller parts, and on those where construction does not permit, an identification letter is stamped in to distinguish the part from similar ones.

Each part number represents the same part regardless of catalog in which it appears.

IMPORTANT! ON ALL ORDERS, PLEASE INCLUDE PART NAME AND THE STYLE OF MACHINE FOR WHICH PART IS ORDERED.

TERMS

Prices are strictly net cash and subject to change without notice. All shipments are forwarded at the buyer's risk f. o. b. shipping point. Parcel Post shipments are insured unless otherwise directed. A charge is made to cover the postage and insurance.

LUBRICATION

Before starting to operate, be sure to remove the vent hole plug from the right side of the hook shaft gear case. This plug is used during shipment only, to prevent oil leakage through the vent hole. Then, lubricate machine thoroughly in accordance with instructions and run slowly for several minutes to distribute the oil to the various parts. Full speed operation can then be expected without damage.

RECOMMENDED OILS

Use a straight mineral oil of a Saybolt viscosity of 200 to 250 seconds at 100° Fahrenheit in hook oil reservoir, feed driving shaft gear case, and hook shaft gear case. This is equivalent to Union Special oil specification No. 83.

Stainless water white straight mineral oil of the same viscosity as that described in the preceding paragraph, can be used in the hook oil reservoir. The stainless oil is Union Special specification No. 86.

Oils conforming to specification No. 83 or No. 86 may also be used in the manually oiled places.

Fill main reservoir through the oil cup (C) in the top of the machine. This oil level should be checked from time to time and kept between the lines on the gauge (D) in front of the machine.

With the needle bar at the top of its stroke, oil holes (A and B, Fig. 1) in the top of the machine twice daily.

The hook oil reservoir is drained when machine leaves factory and must be filled before starting to operate. It is filled at plug screw (E). Its level should be checked twice daily and kept between the lines of the gauge (F).

The hook shaft gear case is filled before shipment with a sufficient volume of oil to bring the level up to the plug screw hole (G, Fig. 2) in gear case cover when machine is tilted back against rest pin. Remove plug screw and check level of oil about every six months.

CAUTION! Do not use a compound oil in the hook oil reservoir, feeding drive shaft gear case, or hook shaft gear case, as these oils separate and froth.

Lubrication of the mechanism below the bed plate is automatically accomplished through the feed driving shaft which is tubular. Oil is introduced into the shaft at the gear end by means of an oil distributing plate (A, Fig. 3) which is secured to the large gear case cover (B) by means of two screws (C) and retaining block (D).

Should it ever become necessary to remove any of the parts from the gear case, it is imperative that the adjustment of the oil distributing plate be checked very carefully. This can be done by removing the large plug screw at right end of the gear housing and looking through the hole. The low point of the oil distributing plate must be even with or slightly below the center of the shaft (E) and just touching it. This is a very important adjustment, as the functioning of the automatic lubrication of the lower part of the machine depends upon it.

NOTE: All moving parts of the pinking attachment to be oiled once daily. Oil knife lever shaft front and rear, also oil two oil holes for lubricating both sides of lever bearings and knife holder shaft. Major oiling points are marked in red on attachment.

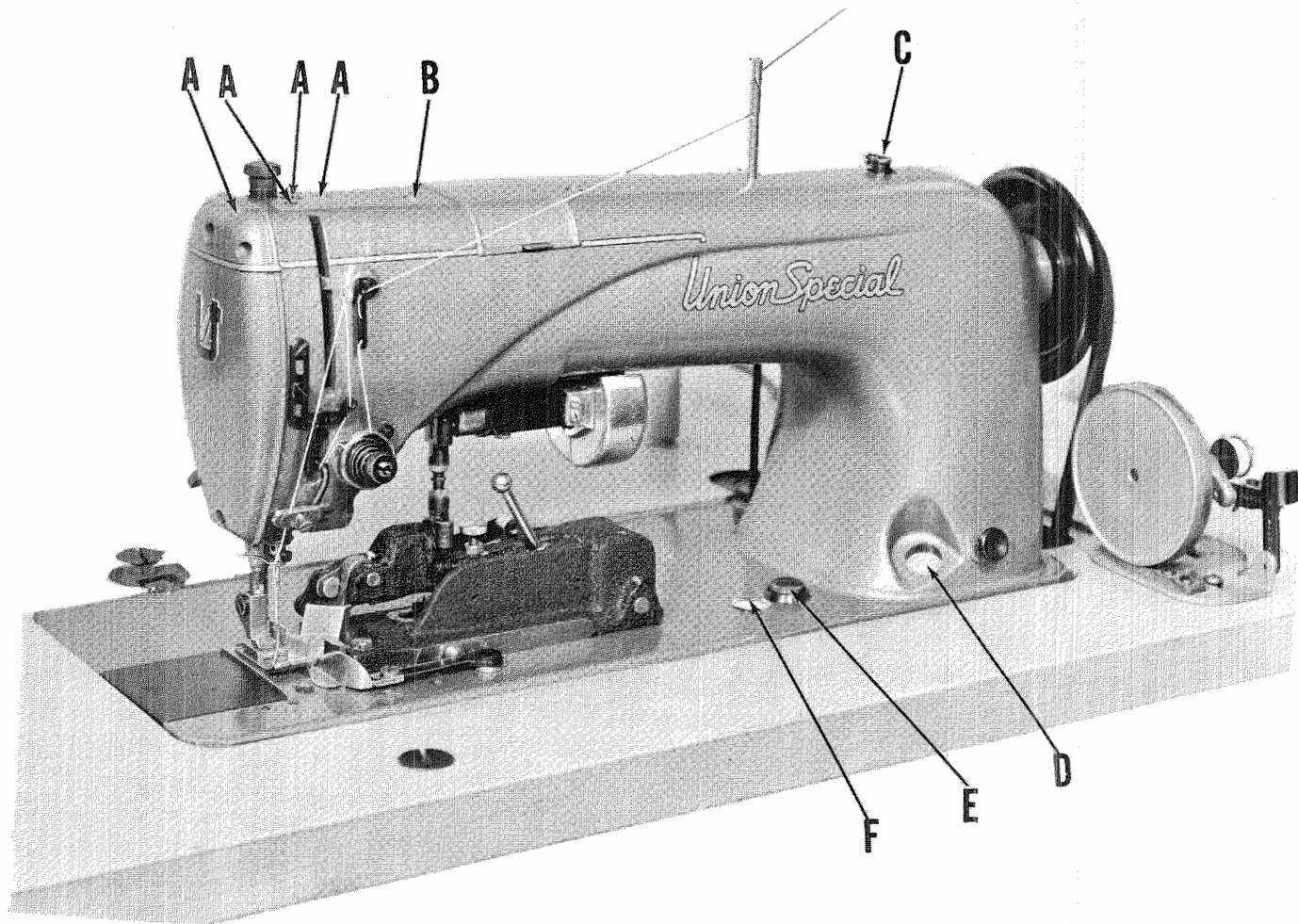

Fig. 1

NOTE: Manually oil pinker at oil holes which are painted red.

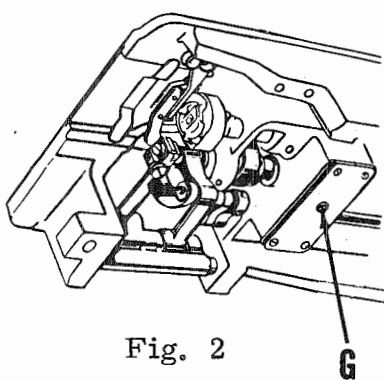

Fig. 2

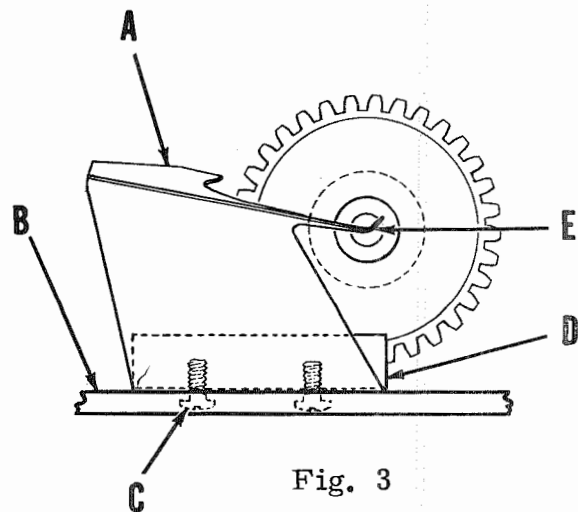

Fig. 3

The following is a numerical list of the parts used in this machine. Quantities, part numbers, and descriptions are given. Following the parts list are photographs of some of the major parts.

Amt.	Part No.	Description	Amt.	Part No.	Description	Amt.	Part No.	Description
1	3-46	Base for 29482 (18-547)	1	59-6	Wrench, for 5/16" or 7/16" hexagonal head screw	2	666-173	Oil Wick for 29126 CZ, 61255 H, 61322 B
1	8-66	Guard for 61927 P, 61927 N (22798)	1	59-11	Wrench, 3/32" hex, for Allen set screw	1	666-174	Felt Wick for 61994 B
1	8-86	Chip Guard for 61928 P	2	HA61 D	Screw for 61264	1	666-196	Felt Wick for 61993 D
1	14-171	Shaft for base (1003 L)	2	HA61 D	Screw for 61264 A	1	666-201	Felt Plug for siphon
1	14-172	Shaft for lever (18-178)	1	69 H	Washer for 22635 B-20	1	666-209	Felt Disc for siphon
1	14-178	Driven Gear Shaft (18-1043)	2	69 FD	Screw for 21661 D, 21664	1	666-213	Felt for head
1	18	Nut for 61984 C	2	69 FD	Screw for 21665	1	719	Screw for 61437 C
1	18-71	Screw for 45-248	1	71-52	Connecting Rod (869 L, 1012 L)	2	810 L	Screw for 27-68
1	18-178	Screw for 14-172	2	73 A	Screw for 8-86	1	810 L	Screw for 99-329 (21210 A)
1	18-321	Screw for 50-277	2	74 E	Plug Screw for 61982	1	869 L	Nut for 71-52
1	18-353	Screw for 99-329 (40-86)	1	76-18	Knife Throw-out Handle	1	1003 L	Screw for 14-171
4	18-355	Screw for 32-81, 32-82	1	88	Screw for 161	2	1003 L	Screw for 50-277
1	18-422	Screw for 475-68	2	88	Screw for 61242	1	1012 L	Nut for 18-547
1	18-497	Screw for 50-277 (40-148)	1	88 B	Set Screw for 61438 A	1	1012 L	Nut for 71-52
1	18-501	Attaching Screw for 29482 (40-46)	1	88 D	Screw for 61439 A	2	1025 L	Screw for 27-164
1	18-544	Screw for 119-25	2	89	Spot Screw for 61244	1	1025 L	Screw for 107-16
1	18-547	Screw for 3-46 (1012 L)	1	89	Spot Screw for 61434	1	1160 L	Nut for 18-844
2	18-558	Screw for lower knife	2	90	Spot Screw for 61492	2	1776 L	Screw for 46-108
1	18-844	Screw for 45-247 (1160 L)	1	91 A	Screw for 61336 Y	1	4124-32	Ball Joint, upper
1	18-1043	Screw for 14-178	2	93	Screw for 61273	1	4124-33	Ball Joint, lower (CS331)
1	PI-18	Pin for 666-201	1	93 A	Screw for 61414 A	1	6042 A	Thrust Washer for 61377 J
1	20	Washer for 61984 C	1	95	Screw for 61246 A	2	8372 A	Washer for 61391 C
2	21-309	Flat Spring for 99-134	2	95	Screw for 61949	1	9937	Nut for 22874 F
1	27-68	Driven Gear for 29482 (810 L)	1	96	Screw for 61984	1	15037 A	Nut for 22845 D
1	27-164	Pinking Driving Gear (1025 L)	1	96 A	Screw for 61984 A	1	15872 F	Spring for 61466 A
4	30-56 Blk.	Wood Plug for 61432	1	99-134	Spot Screw for 61949	1	21210 A	Washer for 810 L
1	32-81	Cover, front, for 27-68 (18-355)	2	99-143	Screw for 61341 C	2	21212	Oil Siphon Connection Locking Ring for 51294 N
1	32-82	Cover, rear, for 27-68 (18-355)	1	107-16	Holder for upper knife	1	21388	Wrench
1	34-26	Cam Throw-out for upper knife (40-101, CS231)	2	109	Edge Guide Holder	1	21393 F	Oil Drain Clamp Spring
1	40-46	Washer for 18-501	1	119-24	Holder for 99-143 (18-353, 40-86)	1	21393 T	Drip Pan
1	40-57	Washer for 4124-33	1	119-25	Flange Driven Gear (1025 L)	1	21660 C	Knee Lifter Assembly
1	40-86	Washer for 18-353	1	138	Tension Disc for 29475 AC	1	21661 D	Knee Lifter Rocker Shaft Stop (69 FD)
1	40-101	Washer for 34-26	1	161	Tension Disc for 61477	1	21661 P	Knee Lifter Rocker Shaft
1	40-148	Washer for 18-497	1	164-37	Lower Knife (18-558)	2	21662 C	Knee Lifter Hanger
1	45-247	Pinker Arm (18-844)	1	226	Upper Knife (18-544)	1	21663 C	Knee Lifter Plate Rod
1	45-248	Lever for throw-out (18-71)	1	CS231	Screw for 62282 B	1	21664	Knee Lifter Plate (69 FD)
1	45-249	Lever for knife throw-out cam	2	CS331	Collar for 61445 (88)	2	21665	Knee Lifter Rocker Shaft Connection (69 FD)
1	46-108	Link for knife throw-out (1776 L)	1	376	Shim for 50-277	1	21665 C	Knee Lifter Rocker Shaft Connection Arm
1	50-277	Bracket for arm (CS331, 18-321, 18-497, 1003 L)	1	475-68	Screw for 61430 BB	2	22504 D	Screw for 61985 D (15037 A)
1	50-552 Blk.	Plug for feed driving shaft	1	531	Nut for 34-26	1	22528	Screw for 61439
1	50-558 Blk.	Plug for bed	1	643-194	Screw for throat plate	2	22537	Screw for 61421 A
1	50-567 Blk.	Oil Sight Gauge for 61394 AJ	1	652 B-20	Edge Guide (18-422)	1	22539 D	Plug Screw for base
1	50-568 Blk.	Oil Sight Gauge	1	660-142	Screw for 61248 H	1	22562 B	Screw for 61255
1	50-692 Blk.	Air Vent for feed drive shaft	1	660-168	Oil Tube for 61982	3	22564 B	Screw for 61437 C
1	57 WB	Nipper Spring Plate	1	660-205	Lock Washer for 61368 A	1	22564 B	Screw for 62271 F
1	57 WC	Nipper Spring	1	660-225	Spring Collar Pin for 61368 A	2	22564 E	Screw for 61414 C, 61415
1	57 WD	Nipper Spring Screw	1	660-226	Knee Pad for 21664	1	22564 F	Screw for 61413 G
					Retaining Ring for 61251 D	2	22569 B	Screw for 61982
					Needle Bearing for 61438 A	3	22569 C	Screw for 61394 Z
					Needle Bearing for 61984 B	3	22569 H	Set Screw for 61208 B
					Washer for 22730	1	22570 A	Screw for 61271
					Oil Wick for head cover	4	22570 A	Screw for 61282 A
					Oil Wick for main shaft bushing housing	6	22570 A	Screw for 61382 J
					Oil Wick for 61293	2	22570 A	Screw for 61394 Q
					Oil Wick for 61393 C	1	22570 B	Set Screw for 61391 C
					Oil Wick for 61985	3	22574	Screw for 61321 J
					Oil Drain Jar (21393 F)	2	22585 A	Screw for 61351 J
						2	22596 D	Adjusting Screw for 61391 C
						1	22597 A	Screw for 61445
						1	22597 A	Screw for 62262
						1	22597 A	Screw for 61251 D
						1	22597 E	Set Screw for 61492 A
						1	22635 B-20	Screw for 61377 W

Amt.	Part No.	Description	Amt.	Part No.	Description	Amt.	Part No.	Description
1	22712 F	Screw for 61368 F	1	61210 B	Hook Thread	1	61341 G	Hook Shaft Oil Seal
4	22716 A	Screw for 61210 B			Deflector (22716 A)			Washer
1	22716 B	Screw for 61414 C	1	61212	Bobbin for 29474 G	2	61341 J	Thrust Washer for
3	22716 H	Screw for 61411 A	1	61216	Bobbin Case Latch			61244
1	22729 A	Screw for 61377 N			Hinge Pin	1	61348 A	Stitch Regulating Shaft
1	22730	Plug Screw for hook	1	61216 N	Bobbin Case Latch	1	61351 C	Thrust Washer for
		shaft gear case			Spring			61351 Q
		(660-257)	1	61233 N	Feed Lift Link	1	61351 J	Frame Take-up
1	22738	Plug Screw for head	2	61235	Feed Bar Shaft			Thread Eyelet
1	22738	Screw for oil siphon	1	61236	Feed Rocker			(22585 A)
1	22742	Screw for 61414 A	1	61236 G	Feed Rocker Shaft	38	61351 K	Needle Bearing
1	22743	Plug Screw for			(22894 E)			Rollers
		61432	1	61242	Hook Shaft Collar (88)	1	61351 Q	Take-up Lever
1	22757 C	Screw for 61255 H	1	61244	Hook Shaft Pinion			Assembly
1	22758 B	Screw for 61267			Gear (89)	1	61356	Presser Spring
1	22760 A	Screw for 61477 B	1	61245 G	Stitch Regulating	1	61360	Main Shaft Driving
1	22764 B	Time Spot Screw			Plunger Locking			Gear (22884)
		for 61437 A	1	61246 A	Insert	1	61360 G	Feed Driving Shaft
2	22768	Screw for feed dog			Stitch Regulating			Collar (22884)
1	22768 A	Needle Set Screw			Plunger Lever (93 A)	1	61368 A	Lifter Lever Extension
1	22768 B	Screw for 61959	2	61248 H	Stitch Regulating			Stud and Lifter
1	22775	Screw for presser			Shaft Collar (531)			Lever Connecting
		foot	1	61251 D	Take-up Lever Pin			Rod, complete
1	22775 A	Screw for feed dog			(660-205, 22597 A)			(652 B-20, 660-142)
		height adjustment	1	61252	Take-up Lever Link	1	61368 F	Lifter Lever Bell
2	22798	Screw for 8-66	1	61252 J	Take-up Lever Crank			Crank Roller
1	22799 M	Hand Lifter Screw			Pin			(22712 F)
		Pin for 61265	1	61255	Needle Bar Connec-	1	61374	Machine Hinge Plate,
1	22802 A	Screw for 61449 F			tion (22562 B)			right (22846 Q-16)
1	22817 A	Stud for 61468	1	61255 H	Needle Bar Link	1	61374 A	Machine Hinge Plate,
1	22839	Screw for 61985 F			(22757 C)			left (22846 Q-16)
1	22845 D	Feed Link Stud	1	61256 G	Presser Spring	2	61375	Machine Hinge Stud
1	22845 G	Screw for 61449 E			Washer	4	61376 G	Felt Pads for table
2	22846 M-		1	61260 A	Feed Driving Shaft			tops
12		Screw for 61477			Gear (22884)	1	61377 A	Base for 61477
2	22846 Q-		1	61261 A	Feed Driving Shaft	1	61377 J	Bobbin Winder Pulley
16		Screw for 61374,			Intermediate Gear			Shaft (22878)
		61374 A	1	61263	Bushing for 61261 A	1	61377 N	Bobbin Winder Trip
1	22863 B	Adjusting Screw	1	61264	Intermediate Gear			Latch (22729 A)
		for 29475 AC			Shaft Collar, right	1	61377 W	Bobbin Winder Pulley
1	22874 F	Screw for 61468			(HA61 D)			Brake, leather
		(9937)	1	61264 A	Intermediate Gear			(22635 B-20)
1	22875	Screw for 61477 C			Shaft Collar, left	1	61377 Y	Bobbin Winder Pulley
1	22878	Screw for 61377 Y			(HA61 D)	1	61378	Machine Rest Pin
1	22880	Screw for 61449 E	1	61265	Hand Lifter (22799 M)	1	61382 J	Feed Driving Gear
1	22880	Spot Screw for	1	61267	Lifter Lever Link			Housing Cover
		61391 C			(22758 B)			(22570 A)
2	22884	Screw for 61260 A	1	61267 G	Lifter Lever Spring	1	61391 C	Main Shaft Counter-
2	22884	Screw for 61360			Pin			weight (22570 B,
2	22884	Screw for 61360 G	1	61271	Frame Needle Thread			22880, 22894 V)
1	22890	Screw, left thread,			Eyelet (22570 A)	1	61392 F-	
		for 61466 A	1	61272	Needle Thread Guide	9		Tension Spring for
1	22892	Screw for 61458			Pin			29475 AC
2	22894 E	Screw for 61236 G	1	61273	Bed Slide Spring for	1	61392 F-	
1	22894 E	Screw for 61985 A			29475 AJ (91 A)	14		Tension Spring for
2	22894 J	Screw for 61443	1	61282 A	Hook Shaft Gear Hous-			61477
2	22894 V	Set Screw for			ing Cover (22570 A)	1	61393 C	Oil Tube for take-up
		61391 C	1	61282 D	Gasket for 61382 J			lever (666-127)
1	22894 W	Set Screw for 61959	1	61282 E	Gasket for 61282 A	1	61394 L	Oil Reservoir Secur-
1	29126 BS	Feed Drive	1	61292 C	Nut for 29475 AC			ing Screw (61494 U)
		Eccentric Assembly	1	61292 C	Nut for 61477	1	61394 M	Gasket for 61394 AC
1	29126 CZ	Needle Feed Drive	1	61292 G	Tension Release Pin	1	61394 P	Oil Distributing Plate
		Eccentric Assembly	1	61292 H	Tension Release	1	61394 Q	Oil Distributing Plate
1	29474 G	Rotating Hook			Washer for 29475 AC			Retaining Block
		Assembly (22569 H)	1	61293	Oil Tube (666-126)			(22570 A, 61394 R)
1	29475 AC	Tension Post	2	61293 N	Plug for bed	1	61394 R	Gasket for 61394 Q
		Assembly	1	61321 J	Handwheel for 61421	1	61394 R	Gasket for 61994 A
1	29475 AJ	Bed Slide Assembly			(22574)	1	61394 Z	Hook Oil Reservoir
1	29475 AP	Take-up Thread	1	61321 L	Hub Washer for 61421			End Cover (22569 C)
		Wire Assembly	1	61322 B	Main Shaft	1	61394 AA	Gasket for 61394 Z
1	29482	Pinking Attachment,	1	61330 B-		1	61394 AC	Hook Oil Reservoir
		complete (18-501)	31		Hinge Pin for 61927 P			Filler Hole Plug
1	39536 AD	Spring Washer for	1	61330 B-				Screw (61394 M)
		76-18	35		Hinge Pin for 61927 N	1	61394 AE	Main Reservoir Oil
1	51242 M	Washer for 22802 A	2	61336 U	Feed Rocker Shaft			Filler Cup
1	51294 N	Oil Siphon Connec-			Bushing	2	61394 AF	Hook Oil Reservoir
		tion (21212)	1	61336 Y	Feed Rocker Oil			Gasket, left
1	51773	Collar for 61985 B			Wick (90)	1	61394 AJ	Hook Oil Reservoir
		(88 B)	1	61340 C	Hook Shaft	1	61396 F	Hook Shaft Oil
1	60038 G	Bearing Sleeve for	1	61341 C	Hook Shaft Bushing,			Metering Insert
		61984 C			left (96 A)	1	61407 B	Hook, Thread
1	61208 B	Rotating Hook for	1	61341 D	Hook Shaft Bushing,			Retainer and Thread
		29474 G (22569 H)			right			Deflector Assembly

Amt.	Part No.	Description	Amt.	Part No.	Description	Amt.	Part No.	Description
1	61411 A	Hook Thread Retainer for 29474 G (22716 H)	1	61449	Stitch Regulating Eccentric for 29126 BS (61449 A)	1	61928 P	Throat Plate for 61900 P (376)
1	61413 E	Bobbin Case Assembly for 29474 G	1	61449 A	Cork Friction Disc for 61449	1	61930 F	Bottom for 61927 N
1	61413 F	Bobbin Case for 61413 E	1	61449 B	Stitch Regulating Thrust Spring for 29126 BS	1	61930 G	Shank for 61927 N, 61927 P
1	61413 G	Bobbin Case Eyelet (22564 F)	1	61449 E	Stitch Regulating Pawl Collar (22845 G, 22880)	1	61930 H	Bottom for 61927 P
1	61414	Bobbin Case Holder for 29474 G	1	61449 F	Stitch Regulating Pawl (22802 A, 51242 M)	1	61949	Stitch Length Indicator (95, 96)
1	61414 A	Bobbin Case Holder Positioning Finger (93, 22742)	1	61449 H	Stitch Length Indicator Window	1	61953 A	Thread Take-up Wire for 29475 AP
1	61414 C	Tension Spring for 61413 E (22716 B, 22564 E)	1	61451 C	Thrust Washer for take-up lever	1	61959	Presser Bar Guide for 29475 AP (22768 B, 22894 W)
1	61415	Bobbin Case Latch (22564 E)	1	61453	Tension Take-up Spring for 29475 AC	1	61982	Head Cover (74 E, 643-194, 22569 B)
1	61415 A	Bobbin Case Latch Lever (61216)	1	61457	Presser Bar	1	61982 B	Top Cover
1	61421	Handwheel, complete for #1 "V" or round belt (22537)	1	61457 B	Presser Spring Regulator	2	61982 C	Top Cover Hinge
1	61421 A	Pulley Hub (22537)	1	61457 C	Bushing, Presser Bar, lower	4	61982 D	Top Cover Hinge Pin
1	61430 BB	Spring for 61927 N or 61927 P (226)	1	61458	Presser Bar Connection (22892)	1	61984	Needle Feed Drive Eccen., 136" throw, for 29126 CZ (95)
1	61432	Feed Driving Shaft (22743)	1	61466 A	Lifter Lever (15872 F, 22890)	1	61984 A	Needle Bearing Retaining Collar (95)
1	61432 B	Feed Driving Shaft Bushing, right	1	61468	Lifter Lever Bell Crank (22817 A, 22874 F)	1	61984 B	Needle Feed Drive Eccentric Bearing for 29126 CZ
1	61432 C	Feed Driving Shaft Bushing, left	1	61470	Needle Thread Guide	1	61984 C	Needle Feed Drive Eccentric Connecting Stud (18, 20)
1	61432 D	Feed Driving Shaft Oil Retaining Bushing, right	1	61477	Bobbin Winder Assembly, complete (22846 M-12)	1	61985	Needle Bar Frame (666-139)
1	61432 E	Feed Driving Shaft Oiling Retaining Bushing, left	1	61477 A	Bobbin Winder Frame Assembly	1	61985 A	Needle Bar Frame Pivot Stud (22894 E)
1	61434	Feed Bar (89, 22775 A, 22845 D)	1	61477 B	Trip Latch Assembly for 61477 (22760 A)	1	61985 B	Needle Bar Frame Rock Shaft
1	61434 G	Washer for feed bar link stud	1	61477 C	Tension Bracket for 61477 (22875)	1	61985 D	Needle Bar Frame Rock Shaft Connecting Link (22504 D)
1	61437 A	Feed Driving Eccentric Timing Collar for 29126 BS (22764 B)	1	61477 D	Hinge Pin for 61477	1	61985 F	Needle Bar Frame Rock Shaft Driving Lever (22839)
1	61437 B	Feed Driving Eccentric Pivot Pin for 29126 BS	1	61477 E	Spring for 61477	1	61985 G	Bushing for needle bar frame rocker shaft, left
1	61437 C	Feed Driving Eccentric Retaining Housing for 29126 BS (719, 22564 B)	1	61490	Main Shaft Bushing and Housing, right	1	61985 H	Bushing for needle bar frame rocker shaft, right
1	61438 A	Feed Driving Eccentric Connection Rod for 29126 BS (88, 22564 B)	1	61490 A	Main Shaft Bushing for 61490	1	61985 J	Needle Bar Frame Pivot Adjusting Bushing
1	61439	Feed Dog Holder (22528)	1	61490 A	Main Shaft Bushing, left	1	61993 B	Oil Tube for main shaft bushing, left
1	61439 A	Feed Dog Holder Support (88 D)	1	61492	Tension Post for 29475 AC (89)	1	61993 D	Oil Tube for needle bar and take-up lever (666-196)
1	61443	Hook Shaft Driving Gear (22894 J)	1	61492 A	Tension Post Socket for 29475 AC (22597 E, 22863 B)	1	61994	Oil Siphon
1	61445	Stitch Regulating Plunger (22597 A)	1	61494 N	Priming Tube Grommet	1	61994 A	Oil Siphon Bracket
1	61447	Stitch Regulating Plunger Lever Spring	1	61494 U	Washer for 61394 L	1	61994 B	Oil Siphon Tube (666-174)
			1	61902	Bed Slide for 29475 AJ	1	62262	Intermediate Gear Shaft (22597 A)
			1	61917	Needle Bar (22768 A)	1	62271 F	Needle Thread Nipper Base
			1	61926 N	Feed Dog for 61900 N (22768)	1	62282 B	Spring for 61982 B (138)
			1	61926 P	Feed Dog for 61900 P (22768)	1	63494 B	Plastic Plug for bed
			1	61927 N	Presser Foot for 61900 N (22775)			
			1	61927 P	Presser Foot for 61900 P (22775)			
			1	61928 N	Throat Plate for 61900 N (376)			

NOTE: Numbers in parenthesis following parts description indicate the screws, nuts, etc., used to attach or hold these parts. For a more detailed description on the presser feet, throat plates, feed dogs and pinking attachments, refer to the copy opposite the picture plate showing these items.

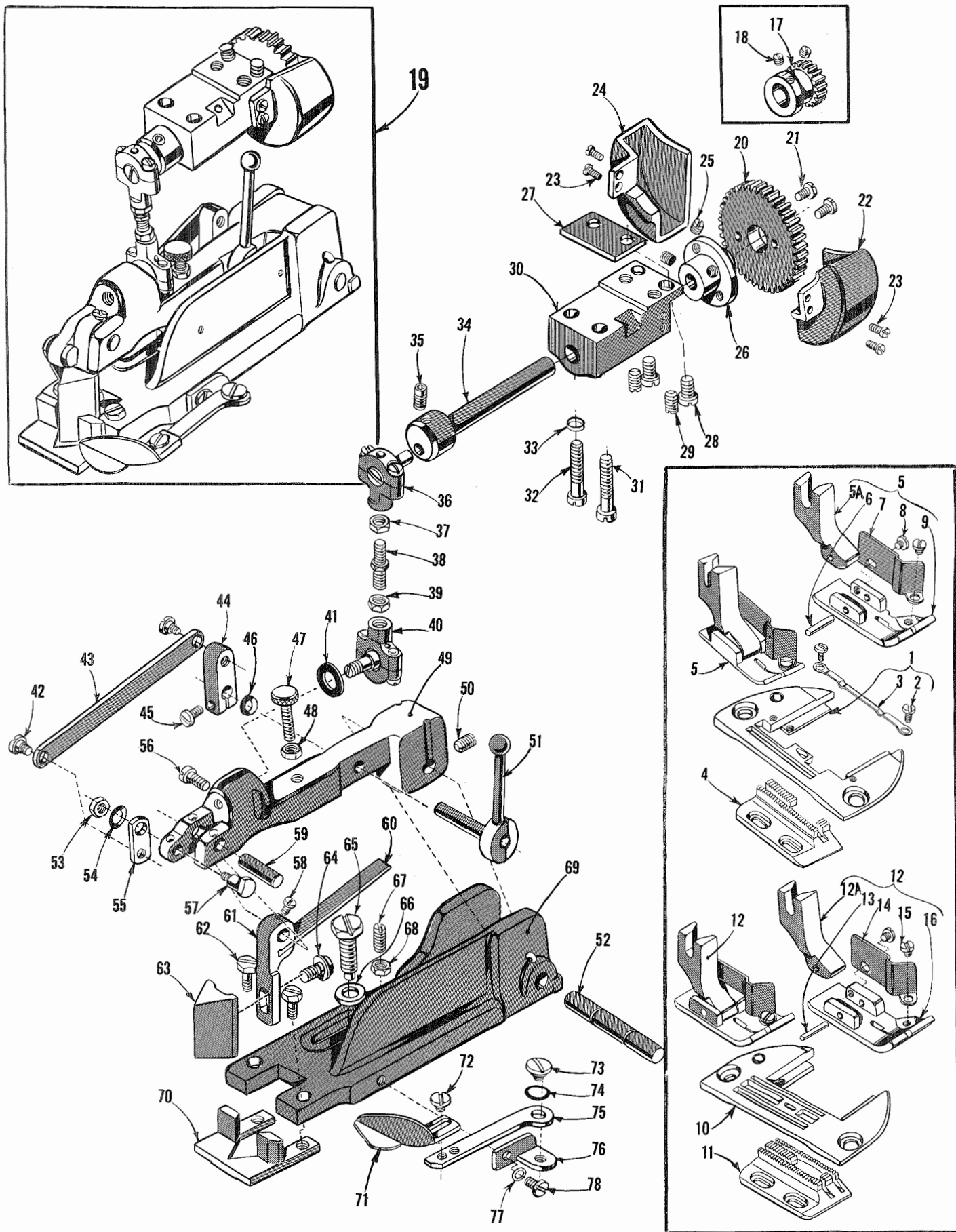

The parts illustrated on the preceding page and described on this page represent the throat plate, feed dog, presser foot and pinking attachment used on Styles 61900 N or 61900 P

Ref. No.	Part No.	Description	Amt. Req.
1	61928 P	Throat Plate, for Style 61900 P -----	1
2	73 A	Screw -----	2
3	8-86	Chip Guard -----	1
4	61926 P	Feed Dog, 22 teeth per inch, for Style 61900 P -----	1
5	61927 P	Presser Foot, for Style 61900 P -----	1
5A	61930 G	Shank -----	1
6	61330 B-31	Hinge Pin-----	1
7	8-66	Presser Foot Guard -----	1
8	22798	Screw -----	2
9	61930 H	Bottom -----	1
10	61928 N	Throat Plate, for Style 61900 N -----	1
11	61926 N	Feed Dog, 22 teeth per inch, for Style 61900 N -----	1
12	61927 N	Presser Foot, for Style 61900 N -----	1
12A	61930 G	Shank -----	1
13	61330 B-35	Hinge Pin-----	1
14	8-66	Presser Foot Guard -----	1
15	22798	Screw -----	2
16	61930 F	Bottom -----	1
17	27-164	Pinker Driving Gear -----	1
18	1025 L	Screw -----	2
19	29482	Pinking Attachment, complete -----	1
20	27-68	Driven Gear -----	1
21	810 L	Screw -----	2
22	32-81	Cover, front -----	1
23	18-355	Screw -----	4
24	32-82	Cover, rear -----	1
25	1025 L	Screw -----	2
26	107-16	Flange Driven Gear-----	1
27	164-37	Shim for 50-277 -----	1
28	CS331	Screw -----	2
29	1003 L	Screw -----	2
30	50-277	Bracket, for arm-----	1
31	18-321	Screw -----	1
32	18-497	Screw -----	1
33	40-148	Washer-----	1
34	14-178	Driven Gear Shaft -----	1
35	18-1043	Screw -----	1
36	4124-32	Ball Joint, upper -----	1
37	1012 L	Nut, right hand thread -----	1
38	71-52	Connecting Rod-----	1
39	869 L	Nut, left hand thread-----	1
40	4124-33	Ball Joint, lower -----	1
41	40-57	Washer-----	1
42	1776 L	Screw -----	2
43	46-108	Link, for knife throw-out-----	1
44	45-248	Lever, for throw-out -----	1
45	18-71	Screw -----	1
46	39536 AD	Spring Washer -----	1
47	18-844	Screw -----	1
48	1160 L	Nut -----	1
49	45-247	Pinker Arm-----	1
50	1003 L	Screw, for 14-171 -----	1
51	76-18	Handle, complete, for knife throw-out -----	1
52	14-171	Shaft, for base -----	1
53	CS231	Nut, for 34-26 -----	1
54	40-101	Washer-----	1
55	45-249	Lever, for knife throw-out cam -----	1
56	CS331	Screw, for 4124-33 -----	1
57	34-26	Cam Throw-out, for upper knife -----	1
58	18-178	Screw, for 14-172 -----	1
59	14-172	Shaft, for lever -----	1
60	21-309	Flat Spring -----	2
61	99-134	Holder, for upper knife -----	1
62	18-558	Screw, for lower knife -----	2
63	119-25	Upper Knife-----	1
64	18-544	Screw, for upper knife -----	1
65	18-501	Attaching Screw, for 29482 -----	1
66	40-46	Washer-----	1
67	18-547	Screw -----	1
68	1012 L	Nut -----	1
69	3-46	Base -----	1
70	119-24	Lower Knife -----	1
71	475-68	Edge Guide -----	1
72	18-422	Screw -----	1
73	18-353	Screw -----	1
74	40-86	Washer-----	1
75	99-143	Edge Guide Holder-----	1
76	99-329	Holder -----	1
77	21210 A	Washer-----	1
78	810 L	Screw -----	1

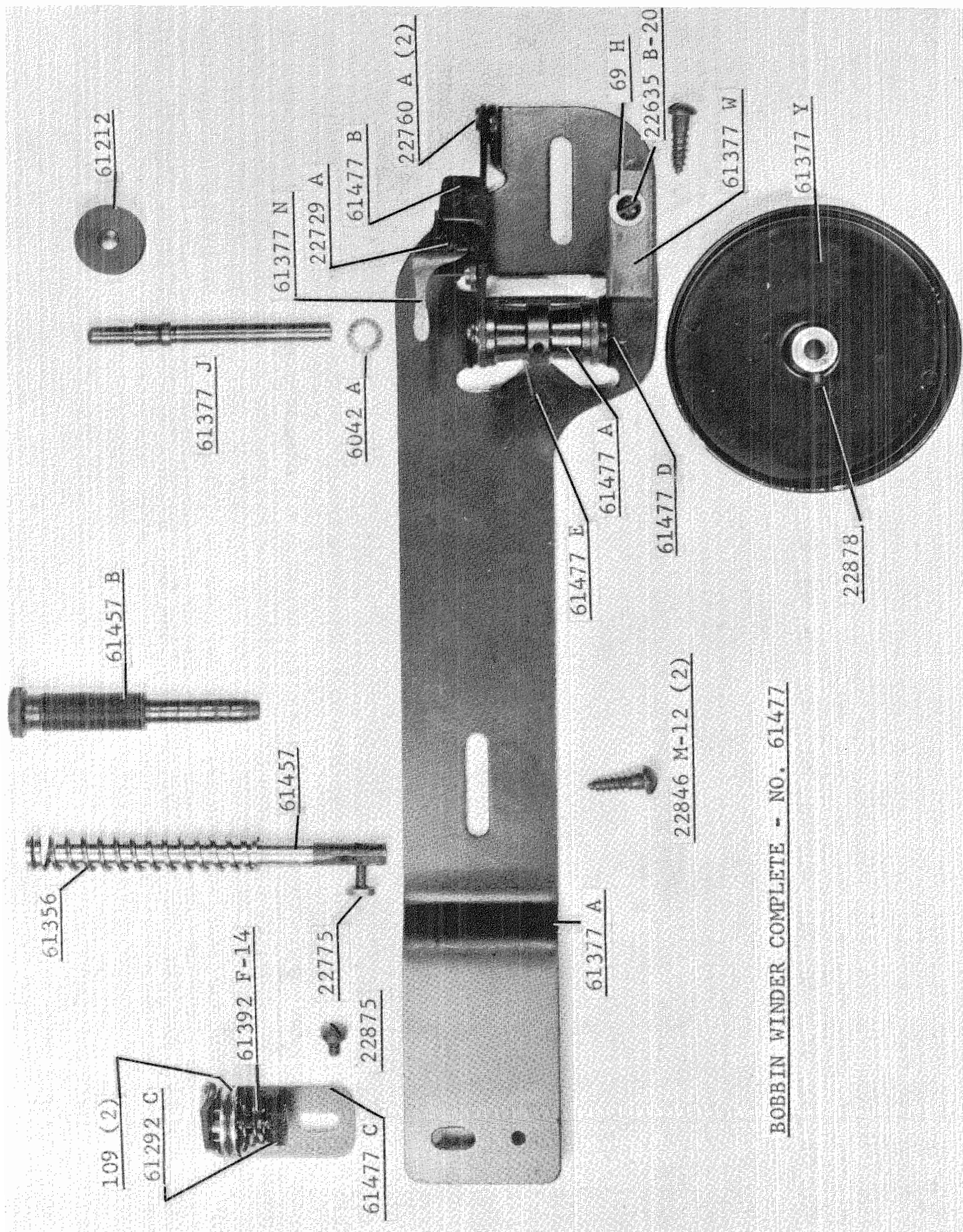

BOBBIN WINDER COMPLETE - NO. 61477

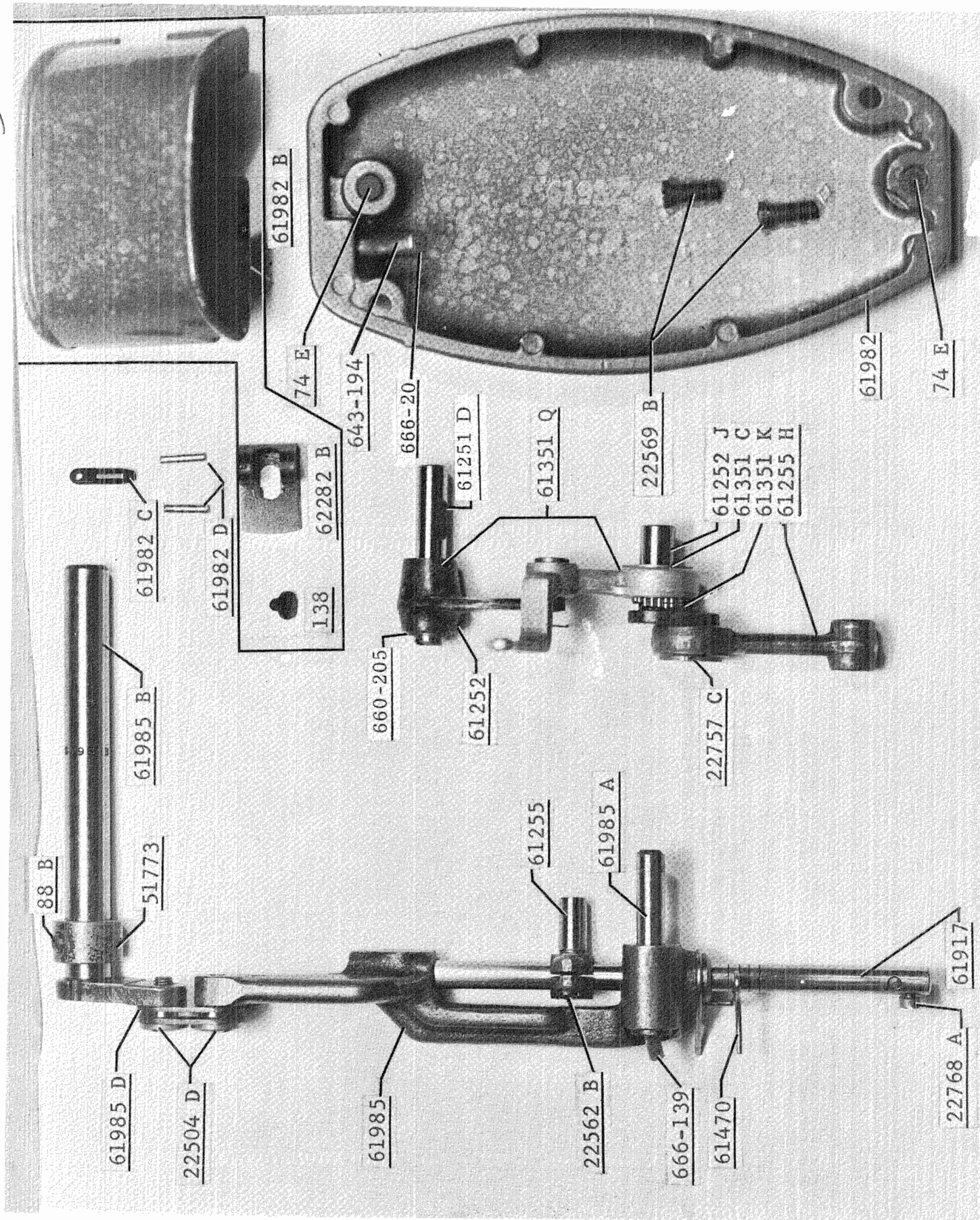

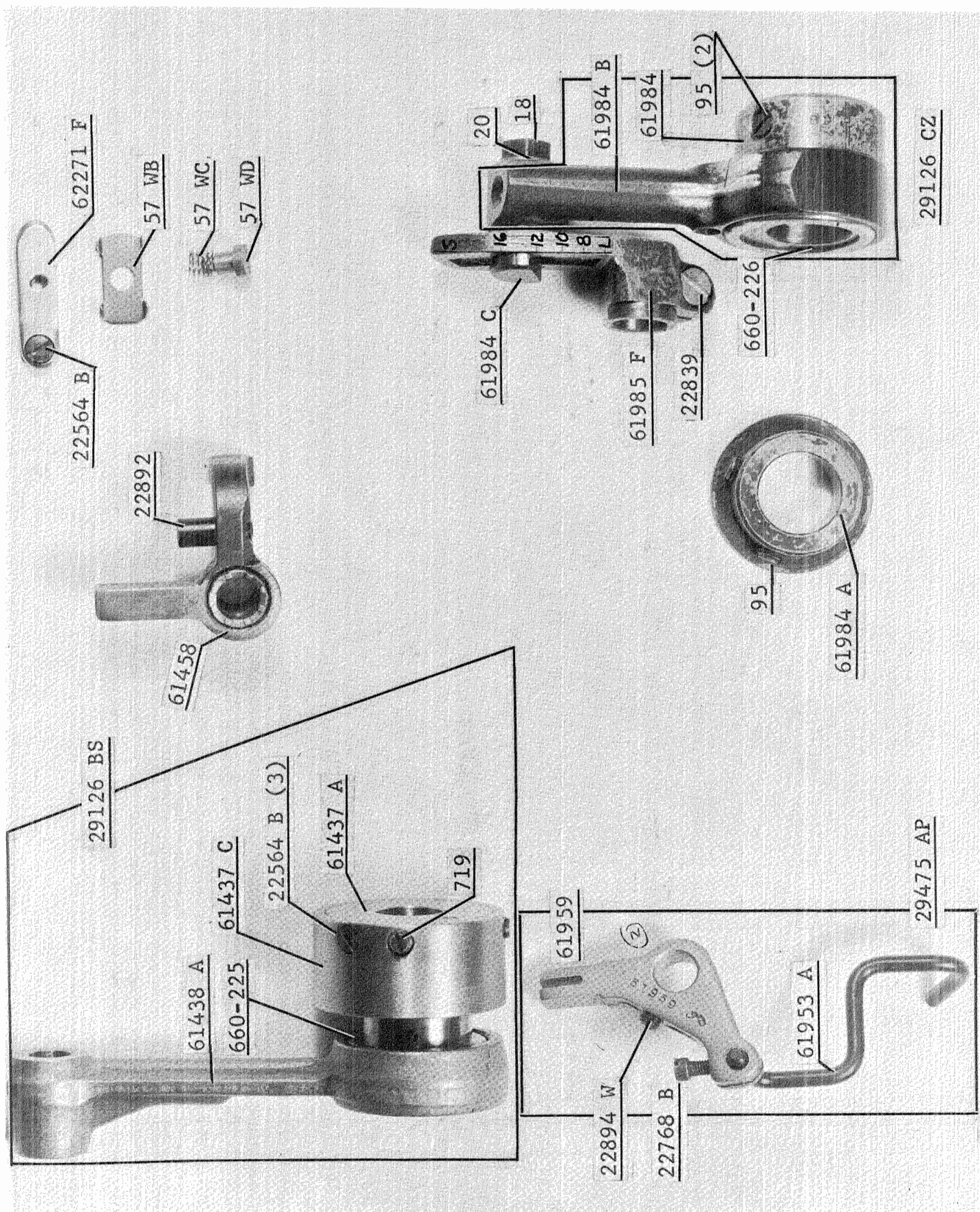

**Sales Agents For UNION SPECIAL Machines;
Also Agent for (L) LEWIS and (C) COLUMBIA where marked.**

AFRICA

(TEXTILE & BAG MAKING MACHINES) Berzack Bros., Ltd. REPUBLIC OF SOUTH AFRICA—JOHANNESBURG 135/7 Pritchard St. CAPETOWN—78 Darling St. DURBAN—72/74 Commercial Road. PORT ELIZABETH—125 Queen Street. SOUTHERN RHODESIA, FEDERATION OF RHODESIA & NYASALAND—BULAWAYO—16-14th Ave. SALISBURY—102 Sinioa St. (L)
(BAG CLOSING MACHINES) South African Scale Co. Pty., Ltd. REPUBLIC OF SOUTH AFRICA—JOHANNESBURG—32 Van Brandis St. BLOMFONTEIN—53 Zastron St. CAPETOWN—Wales and Bree Sts. DURBAN—22 Aliwal St. EAST LONDON—38 Argyle St., LADYSMITH, Natal—355 Murchison. PORT ELIZABETH—Box 611. Also at PIETERMARITZBURG, PRETORIA, VEREENING and WORCESTER. SOUTHERN RHODESIA, FEDERATION OF RHODESIA & NYASALAND BULAWAYO—2 Leander House, Rhodesia Street. SALISBURY—95 Victoria Street. NORTHERN RHODESIA—KITWE—Blantyre Road.
ETHIOPIA, ASMARA—S.A. Calderoni Africa, Avenue P. Astaka Woosen (L & C)
IVORY COAST—ABIDJAN—Ets. Jean Abile-Gal, Box 1798. (L & C)
KENYA, NAIROBI—Transcandia, Ltd., College House, Sadler St. (P.O. Box 5933) (L & C) (Also Uganda, Tanganyika and Zanzibar)
MALAGASY REPUBLIC—TANANARIVE—Soc. Ind. Et Com. De L'Emyrne, Boite Postale 1078, 17 Rue Clemenceau (L & C)
MAURITIUS, PORT LOUIS—(Bag Closing & Bag Making Machines) Hall, Geneve, Langlois, Ltd., 42 Sir William Newton St.
MOROCCO, CASABLANCA—R. Geissmann & Fils, Rue El Idrissi Es Sakali (L)
NIGERIA, APAPA, LAGOS—Sunfog Knitting Mills (Nigeria) Ltd. 9 Warehouse Road.
SUDAN, KHARTOUM—Franco Pinto (Sudan) Ltd., P.O. Box 305. (L & C)
TUNISIA TUNIS—Comptoir Industriel & Menager, 8 Rue ru 18 Janvier 1952 (L)

ASIA

CAMBODIA, PHOM-PENH—Dennis Freres, 219 P.B. Sisowath, P.O. Box 48. (L & C)
INDIA, CALCUTTA—Parrot Sewing Machine (P.) Ltd. 9/1 Sovaram Bysack 57. (L & C)
JAPAN, OSAKA—Kondo Sewing Machine Co. 163. Umegao-cho Kita-ku. (L) Branch—Tokyo 6-3 Ginza, Chao-Ku. Also at: Ashikaga, Fukui, Nagoya, Niigata, and Okayama.
KOREA, SEOUL—Uebersee-Handel A.G., Rm. 604, Bando Bldg. 180 1-ka Uchiro; Chung-Ku, Int. P.O. Box 1268. (L)
LAOS, VIETIANE—Dennis Freres, P.O. Box 133. (C & L)
PAKISTAN, (WEST) KARACHI—2—Universal Trading Corp., 29 Zenat Mansion, McLeod Road. (EAST) (Bag closing and bag making machines) Thomas C. Keay, Ltd., 15 Baltic Street, Dundee, Scotland.
REPUBLIC OF CHINA, HONGKONG—G. R. Coleman Co. (Hongkong) Ltd., Rm. 305 Wing Ting Bldg., 7-13 Wellington St. (L & C) TAIWAN, TAIPEI—G. R. Coleman Co. (Hongkong) Ltd., 16 Nan Yang St. (L & C)
THAILAND, BANGKOK—Yip In Tsai & Co., Ltd., P.O. Box 23. (L & C)
VIETNAM, SAIGON—S.A. Pour Le Riz et L'Industrie (Sari)—147 Trinh Minn-Tha (Fr. P. 444) (C & L)

AUSTRALIA

SOLE DISTRIBUTORS: Capron, Carter Pty., Ltd., 86 Liverpool Street, SYDNEY. Branches at: BRISBANE—454 Brunswick St., Valley, N.I. MELBOURNE—154 A'Beckett St. AGENTS: ADELAIDE—Topp & Farmer, Ltd., 177 Hindley St. PERTH—Thomson, Ltd., 789 Hay St. TASMANIA, LAUNCESTON—Sew Knit Pty. Ltd., 72-74 George St. (L & C)

EUROPE

AUSTRIA, VIENNA—Firma Nähschuster, Mariahilferstr. 51. (L)
BELGIUM, BRUSSELS—Union Special Machine Corporation of America, 90 Rue de la Caserne, Henry Deloaf, Mgr. (C)
DENMARK, COPENHAGEN—Rathenborg Specialmaskiner for Sy-Industrien A/S, Nikolaj Plads 23. Offices at: AARBORG, HERNING, KOLDING, ODENSE, RISSKOV-AARHUS AND SILKEBORG. (L & C)
FINLAND, HELSINKI—LAUTTASAAARI—Suomen Koneleike O/Y, Valtuunienkatu 13. Branches at TAMPERE—Pienteeilisuostalo. TURKU, Tilapitankatu 16. (L & C)
FRANCE, PARIS—Cie. des Machines Union Special de France, 91 Ave. de la Republique—Thos. de Semlyen, Directeur. Branch at: ROUBAIX (NORD)—50 Ave. J. Lebas. LYON, VILLEURBANNE (RHONE) 58 rue Alexandre Bouthin.
GERMANY, STUTTGART—Union Special Maschinenfabrik, G.m.b.H., Schwabstr. 33—A. W. Krieger, Managing Director. Th. M. Baanstra, Director of Sales, BRANCHES AT: BIELEFELD, EMBINGEN, FRANKFURT, HAMBURG, KOLN, MÜNCHEN. (C & L Button Sewers)
GREAT BRITAIN—(Textile Machines)—ENGLAND, LEICESTER, Union Special Machine Co., Ltd., 25 Bede Street, Braunstone Gate, A. B. Fitzpatrick, Manager. BRANCHES: BRISTOL, J. R. Rockingham, 54 Clarendon Road, Redland. LEEDS, C. Waters, 60 Merrion St. LONDON, E. C. 1, H. O. Hall, 108 City Road. IRELAND—Belfast 14—W. F. Maxwell, 50 Glenbryn Park. SCOTLAND—Milngavie (Glasgow) Derrick R. Robinson, 48 Clachbar Ave. SUB-AGENTS: LONDON—W 1—G. Johnson & Son (Sewing Machinery) Ltd., 53 Great Titchfield St. MANCHESTER 19, S. A. Smith (Manchester) Ltd., Park Grove Works, Levenshulme. NORTHERN IRELAND, NEWTOWNABBIE, GLENGORMLEY, COUNTY ANTRIM, Wilson Coulter, Ltd., Ferbro Bldgs., 335 Antrim Road, SCOTLAND, GLASGOW, S. E. Allardice & Co., 9 Stevenson Street. (C) (Bag Closing and Bag Making Machines) SCOTLAND, DUNDEE—Thomas C. Keay, Ltd., 15 Baltic Street—Agent for entire British Isles.
GREECE, ATHENS—Georges Yannakouras-Dimalis, 30 Petraki St. (L & C)
ICELAND, REYKJAVIK—Magnus Thorgerisson, Sklavardustig 1a (L & C)
IRELAND, DUBLIN—(Textile Machines) W. Blythman, 224 Parnell Street (L) (Bag Closing and Bag Making Machines) Thomas C. Keay, Ltd., 15 Baltic St., Dundee, Scotland.
ITALY, MILANO—Giovanni Conti & Nipoti, Via Varese 18. (L & C)
MALTA, VALLETTA—A. C. Wismayer & Co., Ltd., 62 Old Bakery Street. (L & C)
THE NETHERLANDS, AMSTERDAM—N. V. Machinehandel C. & H. Verbeek, Kloveniersburgwal 77. Offices at: ARNHEM, ENSCHEDE, GRONINGEN, ROTTERDAM, SITTARD, TILBURG. (L & C)
NORWAY, MÅNGLERUD—Jac. Jacobsen A/S, Enebakkeveien 117, BERGEN—Bjørnsønst 24. (C)
PORTUGAL, OPORTO—Rost & Janus, Succs. Lda., Rua Barao de Forrester, 914. (L)
SPAIN, BARCELONA—Rapida, S.A., Via Layetana 37 (L)
SWEDEN, BORAS—Rud. Nyström & Co., A/B, Lilla Brannerigatan 6. Branches at OREBRO—Slojdgatan 37-39, MALMO, S. Forstadsgratan 16. Sub-Agent STOCKHOLM, A/B Forsberg & Kato, Tomtebergsgatan 38.
SWITZERLAND, URDORF (ZH)—Bourquin & Cie., Vogelaustr. (Postfach). (L-Button Sewer)

LATIN AMERICA

Union Special International, Inc.
ARGENTINA, BUENOS AIRES—IROMAC S.A.C., Division Pamaca Costura, S.A., San Jose 350. (Union Special Machine Company). (L & C)
BRAZIL, SAO PAULO—Poncostura S.A.—Industria e Comercio, Rua Aurora 59A-71. Branches at PORTO ALEGRE—Rua Voluntarios da Patria 533; RECIFE—Rua Princesa Isabel 105; RIO DE JANEIRO—Rua Alexandre MacKenzie 117. (C & L)
CHILE, SANTIAGO—Lowenstein & Stewart, S.A.C., Calle Santa Domingo 1140. (L & C)
COLOMBIA, BOGOTA—Macalzado, Ltda., Calle 30 #12-29. (L) Branches at BARRANQUILLA—Calle 37 #39-51. BUCARAMANGA—Calle 34 #17-45. CALI—Carrera 1A #22-50. MANIZALES—E. Breslau, Carrera 22 #18-44. MEDELLIN—Carrera 51, (Bolívar) #41-180. PERELRA—Leopoldo Gutierrez M. Carrera 8 #22-12. (L)
COSTA RICA, SAN JOSE—Enrique Rodriguez S., P.O. Box 1949. (L & C)

DOMINICAN REPUBLIC, SANTA DOMINGO—Roberto Dominquez, G., Calle Dr. Pedro Urena 19. (L & C)
ECUADOR, GUAYAQUIL—Distribuidora Richard O. Custer S.A., Malecon Simon Bolivar #2308. Branch at QUITO—Carrera Benalcazar 659.
EL SALVADOR, SAN SALVADOR—Vairo Hermanos, Colonia Vairo. (L)
GUATEMALA, GUATEMALA—Compania Agro Comercial, S.A., 8a Avenida Sur Zona 1. (L & C)
HONDURAS, SAN PEDRO SULA—Jacoba E. Handel, P.O. Box 559.
MEXICO, MONTERREY, N.L.—Talleres Perez Zozaya, S.A. de C.V., Cuauhtemoc Norte 335. Branches at: GUADALAJARA, JAL.—Hidalgo 45 y 47; MEXICO, D.F.—Distribuidora Union Especial, S.A. de C.V., Ave., Pino Suarez 99-c (Apartada 28070); SAN LUIS POTOSI, S.L.P.—J. de las Reves 80. (L)
NICARAGUA, MANAGUA—Casa Hentgen, 3A Calle N.O. #303. (L)
PANAMA, PANAMA—Agencias Hogus, S.A., Ave. 7A Espana #45.
PERU, LIMA, Breña—United Agencies, S.A. (Agusana) Ave. Bolivia 1034. (L & C)
PUERTO RICO, SAN JUAN—Abarca Warehouse Corp., P.O. Box 2352. (L & C)
SURINAM, PARAMARIBO—Kipalan's, Ltd., 17-27 Maagden St. (L & C)
URUGUAY, MONTEVIDEO—Storer & Cia., S.A., Uruguay, Mercedes 1312. (L)
VENEZUELA, CARACAS—H. Blohm, S.A., Dr. Paul A. Chorro 29. (L)

NEAR EAST

CYPRUS, NICOSIA—Christodoulides Bros. & Co., 94 Tri-coupsis St. (L)
IRAN, TEHRAN—Sava Trading Cora., Ave. Bozariemehri 881, Seray Saadivah. (L & C)
IRAQ, BAGHDAD—Sons of O. O. Agopian, P.O. Box 121. (L & C)
ISRAEL, TEL AVIV—L. Taube, Ltd., 15 Liffenblom St. (L)
LEBANON, BEIRUT—Son of O. O. Agopian, P.O. Box 1165. (L & C)
SYRIA, DAMAS—Elias Aroctingi & Fils, Sidi Amond. (L & C)
TURKEY, ISTANBUL—M. Benmayor, Mahmutpasa Abut Efendi Han Nr. 46-47 (Textile, L & C) David ve Leon Vorber ve Seriki, Hamdi Bey Gecidi 36, 38, 40, Posta Kutusu 385. (Bag Closing & Bag Making Only)
U.A.R., Cairo—Misr Import & Export Co., 6 Rue Adly—Tech. Sub-Agent—A. Kovaldian, S.A.R.L., 200 Sharia Shubro. (L & C)

NEW ZEALAND

SOLE DISTRIBUTOR: H. A. Tuck & Co., Ltd., 171 Albert St. AUCKLAND. BRANCH AT: WELLINGTON, Lees Bldg., Nelson St. (L) SUB-AGENTS: Glendernid, Ltd., CHRISTCHURCH—90 Orbell St. DUNEDIN—192-196 Castle St., P.O. Box 40. (C)

PACIFIC ISLANDS

HAWAII, HONOLULU—(Textile Machines) Territorial Sales Co., 508 Atkinson Drive. (L) (Bag Closing and Bag Making Machines) H. S. Gray Co., 759 Puuloa Rd.
PHILIPPINE ISLANDS, MAKATI, RIZAL—Aikins, Krill & Co., Inc., 313 Malagay Street, (Buendia Extension). Branch at CEBU. (L & C)

WEST INDIES FEDERATION, JAMAICA

Union Special International, Inc.
JAMAICA, KINGSTON—Morris E. Parkin, 96 King St. (L)
TRINIDAD, PORT OF SPAIN—Ackrill & Co., 17 Henry St. (L & C)

Additional Sales Agents for (L) LEWIS and (C) COLUMBIA Machines

12-64

AUSTRIA IV, VIENNA—Franz Karpert, Wiednerhaupt Str. 36. (C)
BELGIUM, BRUSSELS—N. V. Machinehandel C & H Verbeek, Kruidtuinlaan 57a, Buyl Bldg. (L)
COLOMBIA, BOGOTA—L. Koenig, Ave. Caracas 12-48. (C)
FRANCE, PARIS—Societe G. Arnou & Cie., 14 Rue Commines (L)—Aspe-Dumont & Cie., 13 Rue de la Fontaine-Au-Roi. (C)
GERMANY, BIELEFELD—Durkoppwerke A/G (Also all their branches). (L except button sewer) KREFELD—Herbert Jannsen, Alte Linnerstr. 104 (C. Tie mach.)
GREAT BRITAIN—ENGLAND—Eastman Machine Co., Ltd., 89 Beddington Lane, CROYDON, Surrey. LONDON, E.C. 1—15-17 City Road (Showroom and Shop). LEEDS—60 Merrion St. MANCHESTER—60-62 Corporation St. (L). REPUBLIC OF IRELAND—DUBLIN—W. Blythman, 224 Parnell Street. NORTHERN IRELAND—Belfast—14—W. F. Maxwell, 50 Glensten Park. SCOTLAND, GLASGOW, S-2—Hugh Sweeney, 11 Drumreach Place. (L)

IRELAND, DUBLIN—Machines, Ltd., 24 Upper Abbey St. (C)
ISRAEL, TEL AVIV—Israel Sewing Machine Co., 22 Yehuda Halevy St. (C)
MEXICO, MEXICO, D.F.—Casa Diaz de Maquinas de Coser, Av. Republic Del Salvador 89-93 (C)
MOROCCO, CASABLANCA—Durkopp Coudreux, 25 Rue Bascunana. (C)
NORWAY, OSLO—J. A. Johansen A/S, Torvgatan 10. (L)
REPUBLIC OF SOUTH AFRICA, JOHANNESBURG—African Sewing Machine Company (Pty.) Ltd., 118 President Street. Branches at: CAPE TOWN—110 Plain St.; DURBAN—9 Nieuw Miester Lane (C)

SOUTHERN RHODESIA, FEDERATION OF RHODESIA & NYASALAND, BULAWAYO—African Sewing Machine Company (Rhodesia) (Pvt.) Ltd., 2 Leonidas House, 138 Rhodes Ave.
SPAIN, BARCELONA—Arbis Maquinaria Y. Suministros Textiles, Girona 63. (C)
SWEDEN, BORAS—Husvarvna, Industrismaskiner A/B—Kungsgatan 28. Branches: GÖTEBORG—Stigbergsgatan 1 MALMO—Isak Slaktaregatan 9—OREBRO—Stortorget 19—STOCKHOLM—Brunnsgatan 6-8. Agents—ULRICEHAM—Firma Hjalmar Svensson, Tingshusgatan 2—BERTILS—Maskinservice, Stadsaga 427. (C)
SWEDEN, A/B, A. C. Gustafson, Kungsgatan 28, Boras. Branches: MALMO—Stora Kvernsgatan 29. STOCKHOLM—Kungsgatan 18. (L)
SWITZERLAND, ZÜRICH—Fritz Zellweger & Sahne, Sel-naustr. 27. (L except Button Sewer) Guttinger A.G., Sihlstrasse 37. (C)
URUGUAY, MONTEVIDEO—C. Brandes & Cia., S.A., Calle Rincan 658. (C)

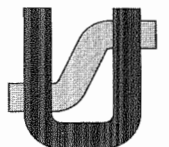

FINEST QUALITY

Union Special®

LEWIS and COLUMBIA



INDUSTRIAL SEWING MACHINES

SALES OFFICES AND REPRESENTATIVES

†Handle Union Special and Columbia only.

‡Handle Lewis and Columbia only.

All others handle Union Special, Lewis and Columbia with certain exceptions.

UNITED STATES

ALABAMA, BIRMINGHAM, 732-84th Street, South, Lloyd D. Baldwin, Tel. 833-9904.

ALABAMA, MONTGOMERY 7, 1959 Amelia Drive, Garnet H. Hamlet, Tel. 265-0942.

ARKANSAS, LITTLE ROCK, P.O. Box 1783, James T. Taylor.

CALIFORNIA, LA PUENTE, 1527 Channelwood Drive, Bill Bayless, Tel. 330-3043.

★CALIFORNIA, LOS ANGELES 21, 1100 E. Pico Blvd., Paul M. Mason, Mgr., Tel. Madison 5-5828.

CALIFORNIA, SAN FRANCISCO 7, 1275 Mission St., Robert J. Vail, Tel. Underhill 1-1580.

‡CALIFORNIA, SAN FRANCISCO 3, Apparel City Sewing Machine Co., 1155 Mission St., Tel. MArket 1-6660.

COLORADO, ARVADA, Casey's Sewing Machine Service, 5719 Reed St., Tel. 424-6630 (Textile Machines).

COLORADO, DENVER 10, 1801 South Marion St., Louis E. Carter, Tel. 777-7060. (Bag Closing Machines)

CONNECTICUT, DANBURY, 22 Barnum Road, Robert W. Gaines, Tel. 746-3652.

FLORIDA, NORTH MIAMI BEACH, 985 N.E. 176th St., Gus M. Buckley, Tel. 949-1215.

FLORIDA, PLANT CITY, 506 N. Gordon St., James C. Morgan, Tel. 752-1829.

★GEORGIA, ATLANTA, 2120 Plasters Bridge Road, N.E., Merritt M. Ambrose, Mgr., Tel. 875-9237.

GEORGIA, COMMERCE, Lakeview Drive, J. Tom Hanley, Tel. 335-4061.

GEORGIA, DECATUR, 1713 Coventry Road, Joe V. Parker, Tel. 377-5559.

GEORGIA, DUBLIN, 1615 Knox St., John W. Jones, Tel. 272-4663.

★ILLINOIS, CHICAGO 10, 400 N. Franklin St., Orville A. Ullrick, Mgr., Tel. 644-6920.

KANSAS, PRAIRIE VILLAGE, 7351 Rosewood, Cleo C. Smith, Tel. HE 2-1705.

KENTUCKY, LOUISVILLE 7, P.O. Box 7261, Raymond E. Hinton, Tel. 587-0042.

LOUISIANA, METAIRIE, 707 Trudeau Drive, Charles Wicks, Tel. 729-4115.

MARYLAND, BALTIMORE 15, P.O. Box 2505, Ralph B. Foster, Tel. 727-8499.

MARYLAND, BALTIMORE 1, J. Doshe, Inc., 417 W. Baltimore St., Tel. LExington 9-1838.

MASSACHUSETTS, AUBURN, 4 Mount View Avenue, Larry Kelson, Tel. 832-3672.

★MASSACHUSETTS, BOSTON 11, 179 Lincoln St., William E. Palm, Mgr., Tel. Liberty 2-0147.

‡MASSACHUSETTS, BOSTON 11, Zalkind Sewing Machine & Supply Co., 205 Lincoln St., Tel. HANcock 6-5588.

†MASSACHUSETTS, CANTON, York St., RFD, Roy T. Pedersen, Tel. 828-1412.

‡MASSACHUSETTS, FALL RIVER, Zalkind Sewing Machine & Supply Co., 1059 S. Main St., Tel. OSborne 5-7847.

†MASSACHUSETTS, TAUNTON, P.O. Box #2 Raynham, Walter P. Godek, Tel. VanDyke 2-6149.

MICHIGAN, DEARBORN 6, 5747 Evergreen Road, John F. Lux, Tel. 584-4210.

MINNESOTA, MINNEAPOLIS, 2800 Texas Ave., St. Louis Park 26, Minn., Leonard W. Koehler, Tel. 644-6236.

MISSISSIPPI, JACKSON 3, 327 Eastview St., Jamie A. Boyette, Tel. Fleetwood 5-1976.

MISSISSIPPI, TUPLO, 606 Racove Drive, Bill Haywood, Tel. VI 2-5848.

‡MISSOURI, KANSAS CITY 5, Textile Machinery Co., 915 Broadway, Tel. Victor 2-9558.

MISSOURI, ST. LOUIS 34, 9860 Guthrie Ave., Carl E. McLaughlin, Tel. Chestnut 1-2368.

†NEW HAMPSHIRE, NASHUA, P.O. Box 257, Herman E. Hoberman Jr., Tel. Tuxedo 2-9698.

†NEW JERSEY, NORTH ARLINGTON, 8 Rutherford Place, Joseph Loglisci, Tel. 991-8211.

†NEW JERSEY, RUTHERFORD, 246 Sylvan St., Richard W. Whitson, Tel. Geneva 8-2178.

NEW JERSEY, WEST BERLIN, P.O. Box 26, Frank A. Neff, Tel. 767-4350.

NEW YORK, LATHAM, 57 Sylvan Ave., Clarence A. Wheeler, Tel. State 5-6371.

★NEW YORK, NEW YORK 1, 370 7th Ave., (Penn Terminal Bldg.) Clarence L. Rosenquist, Mgr., Tel. Chickering 4-8800.

‡NEW YORK, ROCHESTER 9, A. J. Adams Co., 1051 Culver Rd., Tel. BÜtler 8-7250.

NEW YORK, UNIONDALE, 873 Henry St., Anthony Candell, Tel. Ivanhoe 3-7477.

NORTH CAROLINA, GREENSBORO, P.O. Box 226, William D. Harrod, Tel. 299-9367. 4216 Pennydole Dr., Harold E. Miller, Tel. 296-0734.

OHIO, CLEVELAND 3, 6020 Euclid Ave., Hirsch Garment Equipment Corporation, Tel. Express 1-8811.

OHIO, COLUMBUS, P.O. Box 874, Jerry Smith, Tel. AXminster 1-1222.

OKLAHOMA, OKLAHOMA CITY 19, 2226 Southwest 53rd St., G. B. Wiley, Tel. 685-2836.

PENNSYLVANIA, ALLENTOWN, P.O. Box 542, Luther D. Cassell, Tel. 797-2111.

PENNSYLVANIA, BLOOMSBURG, P.O. Box 361, Irvin H. Kendig, Tel. 784-7864.

PENNSYLVANIA, CLARKS SUMMIT, 428 West Grove Ave., John J. Lafer, Tel. JUNiper 7-2820.

PENNSYLVANIA, EGYPT, 628 Main Street, Bernard Sagano-wich, Tel. 262-2125.

PENNSYLVANIA, LANSDALE, 330 Greenwood Road, Donald McFadden, Tel. UL 5-8858.

★PENNSYLVANIA, PHILADELPHIA 24, 4234 Macalester Ave., Ben W. Merz, Mgr., Tel. Gladstone 5-9800.

†PENNSYLVANIA, PITTSBURGH (Irwin), 100 Arona Road, W. Dale Speer, Tel. (Pittsburgh) 563-3589.

PENNSYLVANIA, REAMSTOWN, P.O. Box 176, David M. Bender, Tel. 267-6109.

PENNSYLVANIA, YORK, P.O. Box 884, Harding T. Powell, 854-8040.

SOUTH CAROLINA, COLUMBIA, 2039 Winsor Hills Drive, Virlyn R. Crisler, Tel. Sunset 7-0863.

SOUTH CAROLINA, GREENVILLE, 25 Sir Abbot St., Orville W. Gregory, Tel. Cedar 9-5539.

TENNESSEE, KNOXVILLE 19, 3905 Greenleaf Ave., Horace E. Clinard, Tel. 588-1865.

TENNESSEE, MEMPHIS 17, 4695 Dunn Rd., Richard J. Lindhorst, Tel. Mutual 5-6750.

TENNESSEE, NASHVILLE 12, 1602 South Observatory Drive, William J. Brauch, Tel. Cypress 2-5123. 2517 Woodberry Drive, F. M. Blunkall, Tel. 883-3352.

★TEXAS, DALLAS 19, 4200 Hines Blvd., P.O. Box 6727, Zack X. Bennett, Mgr., Tel. Lakeside 6-8369.

TEXAS, DENTON, 2415 West Oak St., John D. Troeger, Tel. 387-5007.

TEXAS, EL PASO, P.O. Box 9573, Edward E. Smith, Tel. 598-2928.

TEXAS, SAN ANTONIO, Jerry Gregory, P.O. Box 13126, Tel. DI 2-5924.

UTAH, SALT LAKE CITY, 1215 E. 13th South St., Larry F. Rosvall, Tel. IN 7-6931.

VIRGINIA, LURAY, P.O. Box 401, Gordon Rickard, Tel. RI 3-5271.

VIRGINIA, LYNCHBURG, P.O. Box 1075, Tom Traylor, Tel. 239-5904.

CANADA

Union Special Machine Co. of Canada, Ltd.

BRITISH COLUMBIA, VANCOUVER, Lawrence F. Kay, 792 E. 15th Ave., Tel. 874-1910.

MANITOBA, WINNIPEG, Frank Thierman, Rm. 201, Whitla Bldg., 70 Arthur St., Tel. Whitehall 3-4933.

★ONTARIO, TORONTO 28, Les Yates, Mgr.-Rep., 355 King St. West, Tel. Empire 6-2939.

★QUEBEC, MONTREAL 10, John Caschetto, Mgr.-Rep., 40 Maliere St., Tel. 276-2575.

**FINEST
QUALITY
WORK**

**HIGHEST
PRODUCTION
RATES**

**LOWEST
MAINTENANCE
COSTS**

12-64